

Materials Key:

- Paving - Existing York stone paving reused where possible and relaid. See note below, any new paving required to match existing where possible.
- Brick Kerb (11300m): Reclaimed brick from demolished walls reused or to match.
- Brick Wall to planter (7100m): Reclaimed brick from demolished walls reused or to match, 4 courses high.
- Grass / Turf
- Aco Drain - Galvanised (100mm x 100mm, 150mm deep channel) at level threshold.
- BBQ TBC. Joinery to be designed to fit.

Notes:

- Existing heritage pavement to be carefully removed and stored.
- Levels of ground underneath modified to create level threshold. Garden to be leveled and compacted generally.
- Paving to be carefully cleaned prior to relaying. Slabs to be relaid to fall towards existing gully at end.
- Level threshold between all surfaces to minimise trip hazards.
- Aco Drain connected to existing corner gully.
- All other existing raised beds and paving to be removed.
- Sub-base details and design to be confirmed by Landscaper.
- All levels tbc by Civil Engineer.
- Soft landscaping and plants to be specified as native species, local where possible.

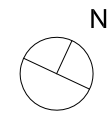

Project Name:
14 Endsleigh Street

Drawing Title:
Proposed Landscape Layout SK-001.01

| | |
|----------------------------|----------------------------------|
| Scale: 1:50 @ A3 | Revision: Tender/Planning. 01 |
| | Date: 19/08/20 |

Note: These drawings are for planning purposes only.

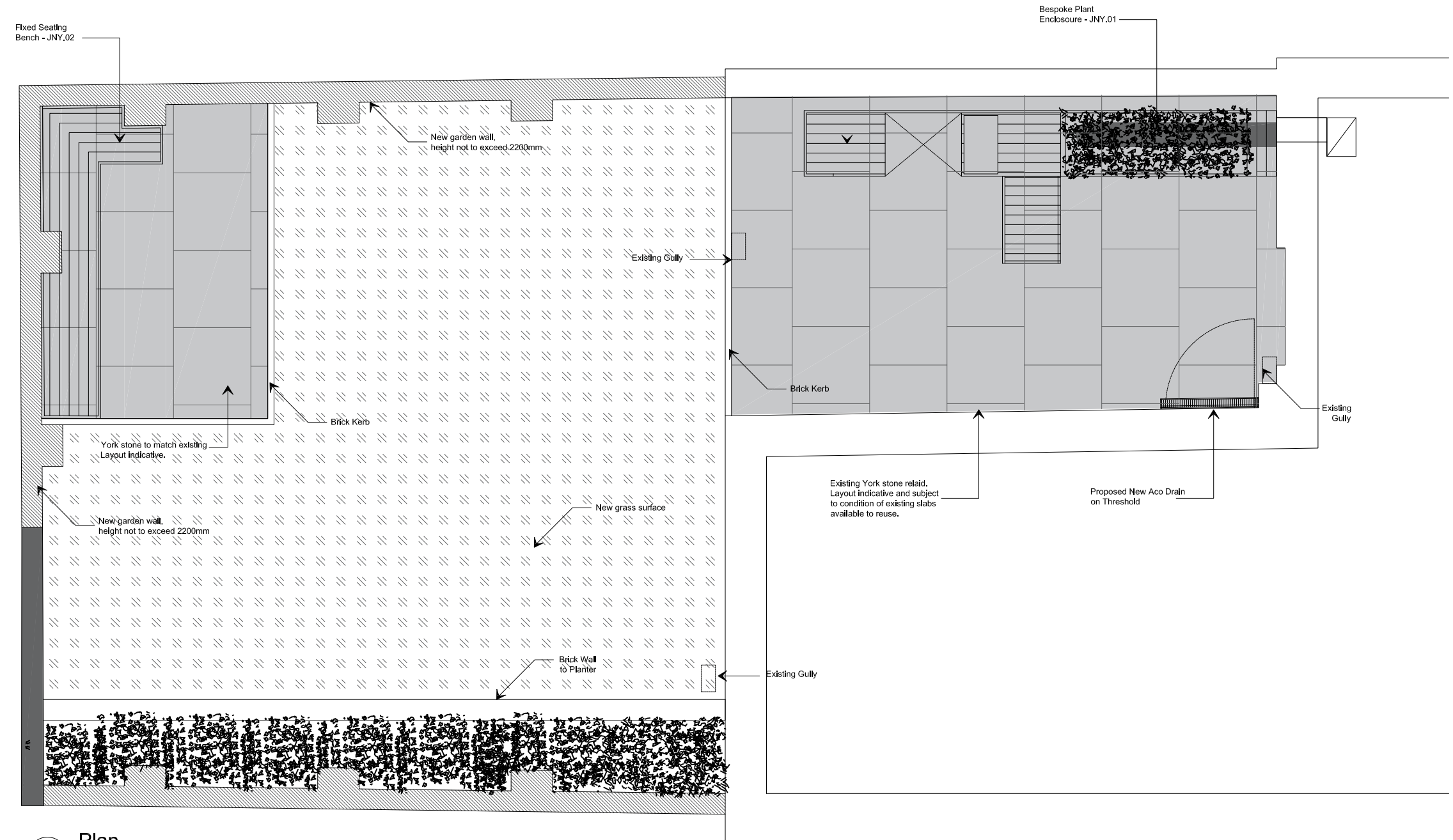

01 Plan

