

# ELLERDALE ROAD - LAYOUT PLAN

## NOTES

A resin bound permeable surface is used throughout to help with draining water away. Any surface water that does not soak away will be collected in an underground holding tank and be used for the irrigation system.

An extended surface on the wall adjacent to the house is included to protect the existing tree root, which is currently exposed. A cavity will be created by constructing a blockwork surround (clad in porcelain tiles) and backfilled with multi-purpose compost to protect the root.

The planting scheme has year round interest and includes several plants from the RHS Perfect for Pollinators list, to support pollinators and increase biodiversity (refer to Planting Plan).

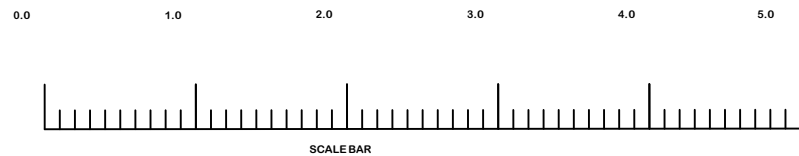
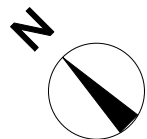
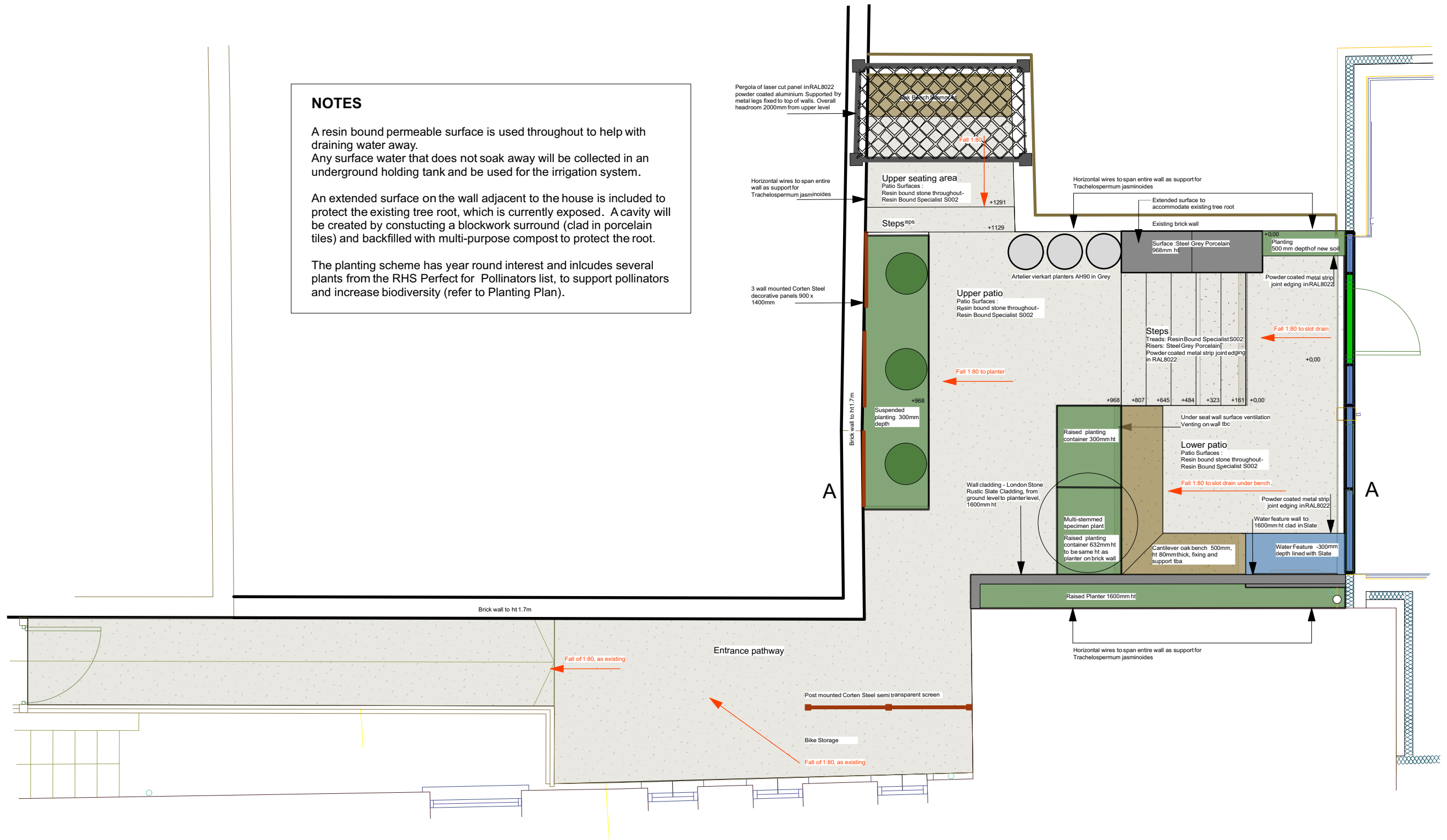

To be read in conjunction with:

Setting Out Plan  
Section Drawing  
Planting Plan

## Jilayne Rickards

Contemporary Garden Design  
26 Ringwood Avenue, London N2 9NS  
T: 07801 946878  
E: Studio@jilaynerickards.com  
W: www.jilaynerickards.com

Client: Jon McElroy  
Site: 1 Ellerdale Road, Hampstead  
London NW3 6BA  
Drawing: Layout Plan v2  
Scale: 1:50 @ A2  
Date: 5 November 2020