

# Tree Constraints Plan

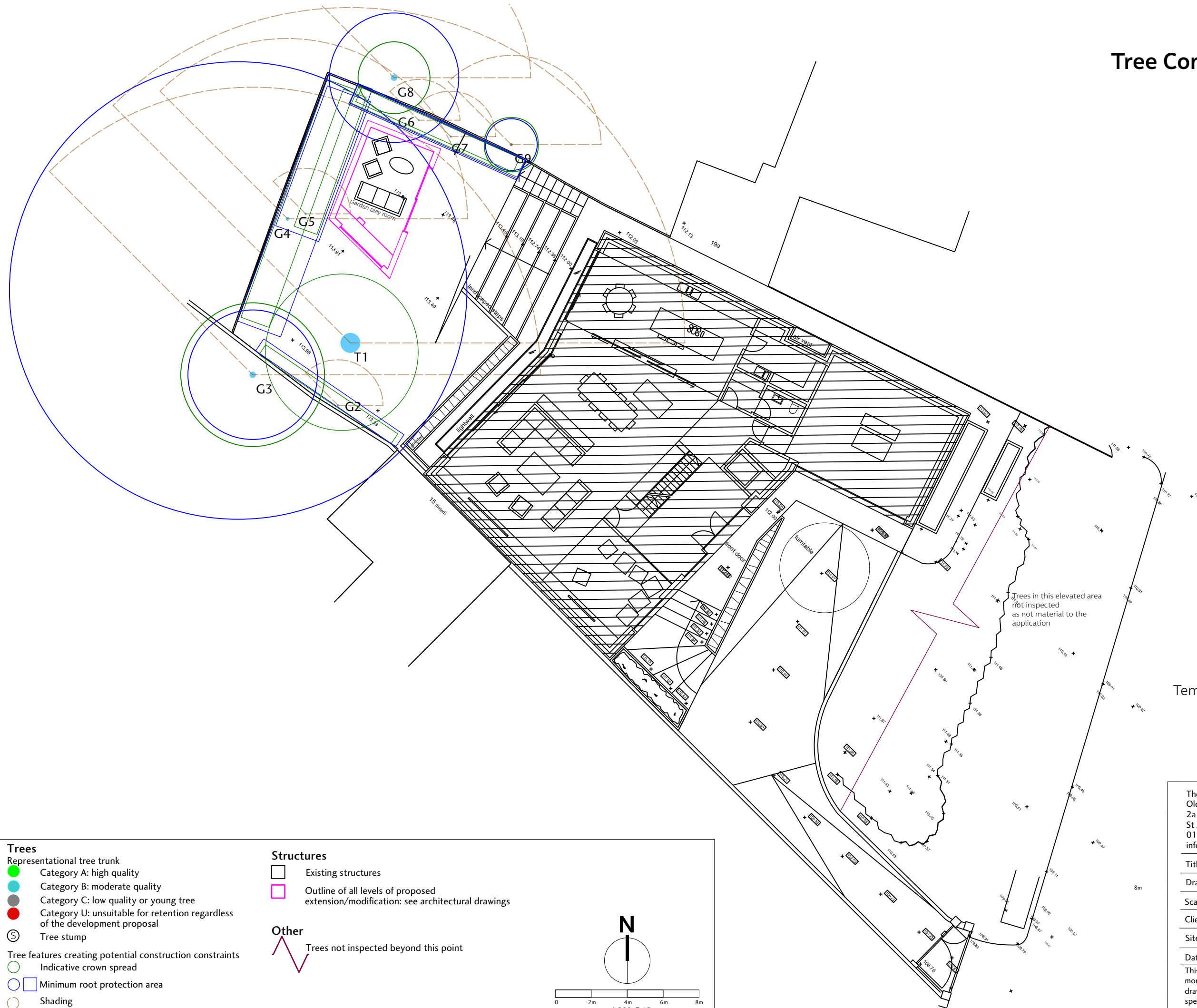

Templewood Avenue

**Trees**

- Representational tree trunk
- Category A: high quality
- Category B: moderate quality
- Category C: low quality or young tree
- Category U: unsuitable for retention regardless of the development proposal
- Tree stump

**Tree features creating potential construction constraints**

- Indicative crown spread
- Minimum root protection area
- Shading

**Structures**

- Existing structures
- Outline of all levels of proposed extension/modification: see architectural drawings

**Other**

- Trees not inspected beyond this point

0 2m 4m 6m 8m  
1:200 @ A3

The Tree Bureau  
 Old Warwick Studio  
 2a Warwick Road  
 St Albans Herts AL1 4DL  
 01727 855006  
 info@thetreebureau.co.uk

---

Title: Tree Constraints Plan

---

Drawing reference: TCP 7598

---

Scale 1:200 @ A3

---

Client: Stuart Peters

---

Site: 17 Templewood Avenue, Hampstead, London NW3 7UY

---

Date: 06 11 20

This drawing is in colour and no reliance should be placed on a monochrome copy. The drawing is based, with permission, on supplied drawings. For all non-arboricultural detail, please refer to the appropriate specialists' drawing. Do not scale from this drawing. Use the dimensions shown in mm.

© The Tree Bureau 2020