

[01] PROPOSED SECOND FLOOR PLAN @1:100

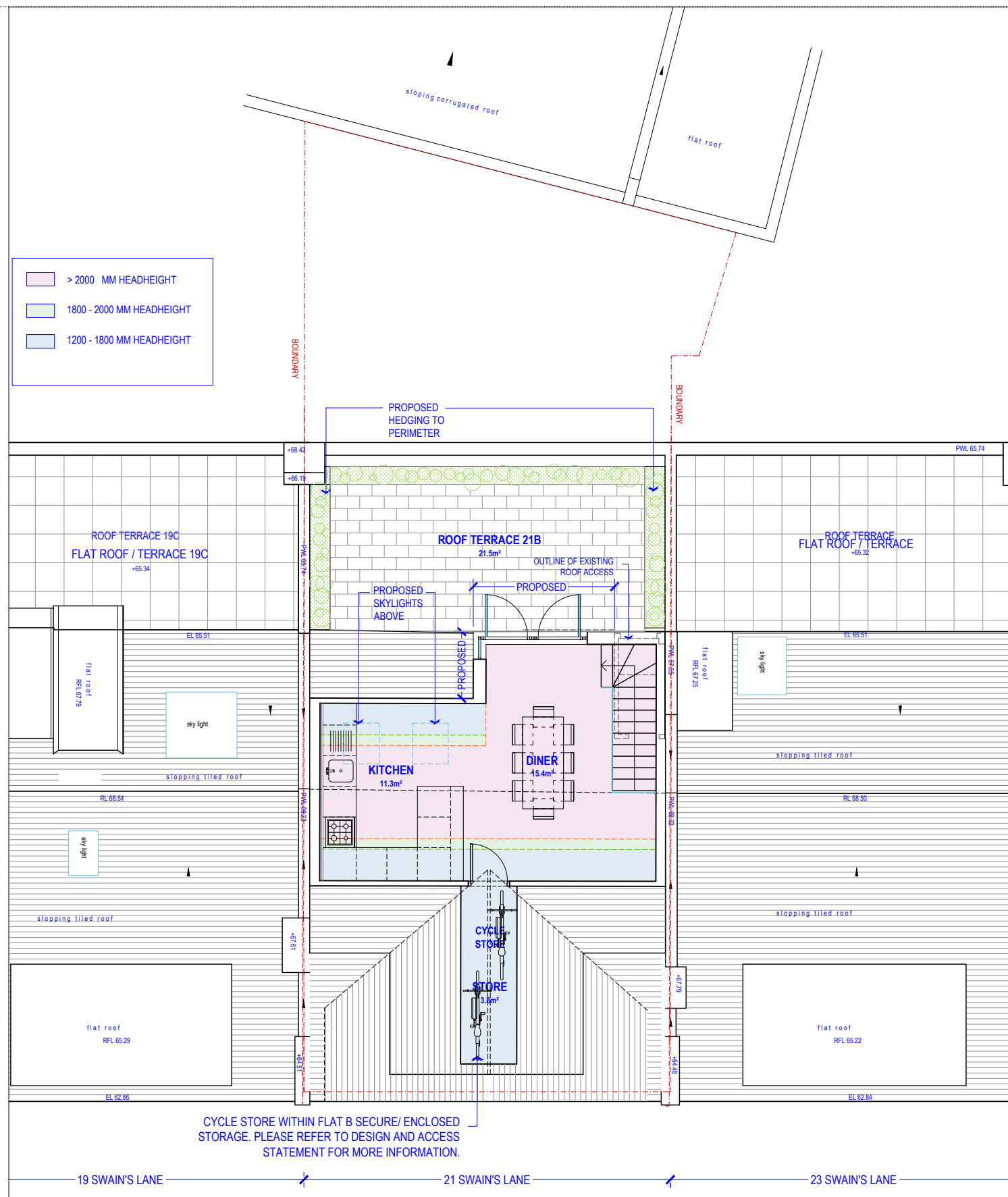

[02] PROPOSED THIRD FLOOR/LOFT PLAN @1:100

NOTE:
DO NOT SCALE FROM DRAWINGS - EXCEPT FOR PLANNING PURPOSES.
ALL DISCREPANCIES TO BE REPORTED TO ARCHITECT IMMEDIATELY.
ALL DIMENSIONS TO BE VERIFIED BY CONTRACTOR ON SITE PRIOR TO THE COMMENCEMENT OF ANY WORKS.

P1 26/10/20 Planning Application Issue

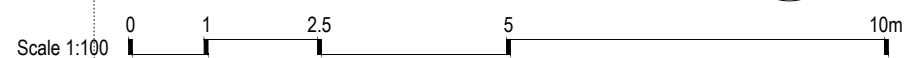
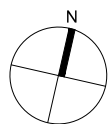

VIVENDI ARCHITECTS LTD
Unit E3U, Bounds Green Industrial Estate, Ringway, London N11 2UD
Tel/Fax +44 (0)20 3232 4000 - email: info@vivendiarchitects.com
© VIVENDI ARCHITECTS LTD 2009
All rights reserved, including but not limited to The Copyright, Designs and Patents Act 1988

ISO-A3
PROJECT TITLE:
21B Swain's Lane, London N6 6QX
DRAWING TITLE:
Proposed Second & Third Floor/Loft Plans

CLIENT:
LXE Investments Ltd.

DRAWN:
SM / AW
CHECKED:
GK
ISSUED BY:
GK

STATUS:
PLA
SCALE AT A3:
1:100
REVISION:
P1

JOB AND DRAWING NO.:

1803-P02-00