

ELEVATION 1

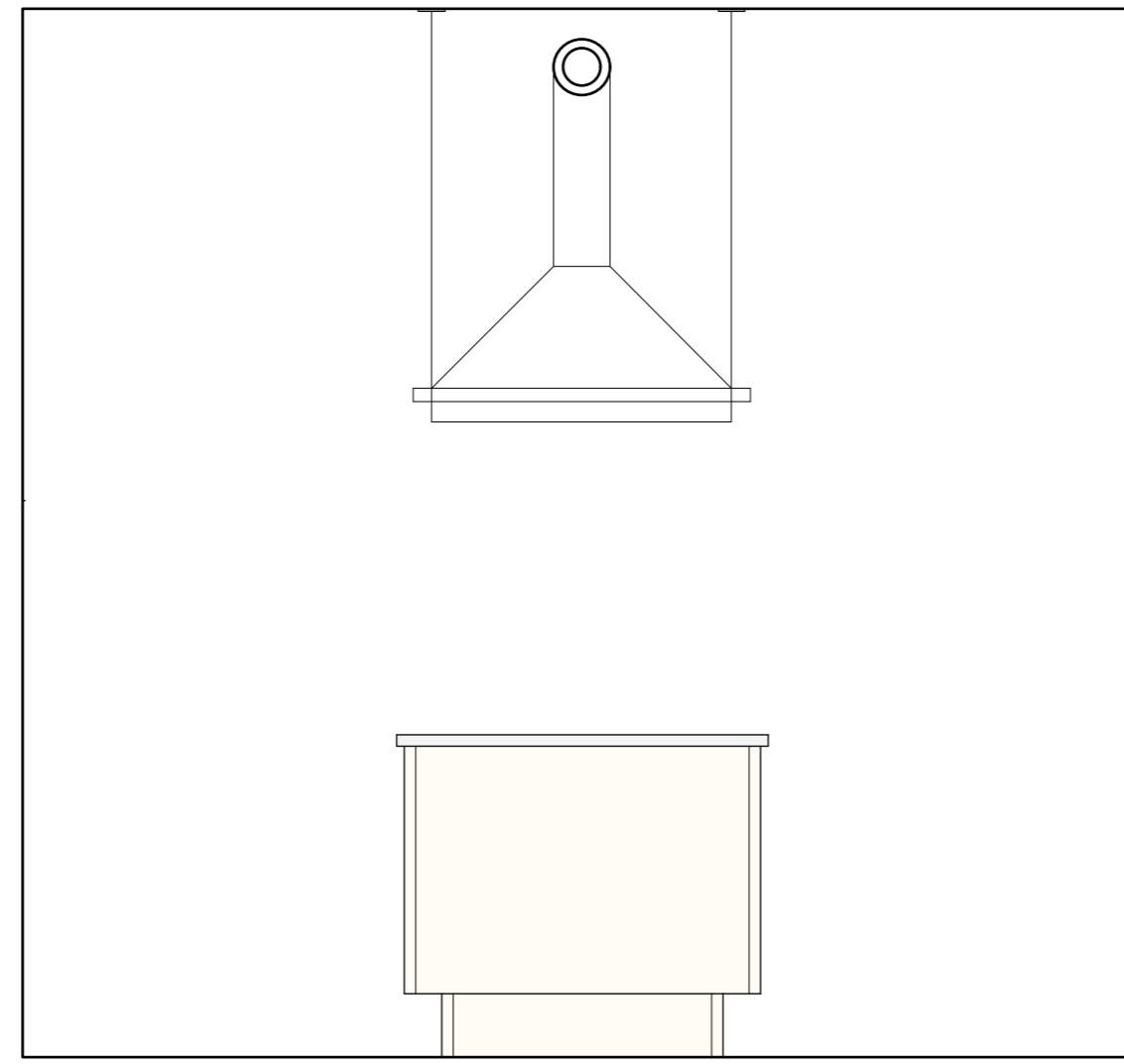

ELEVATION 2

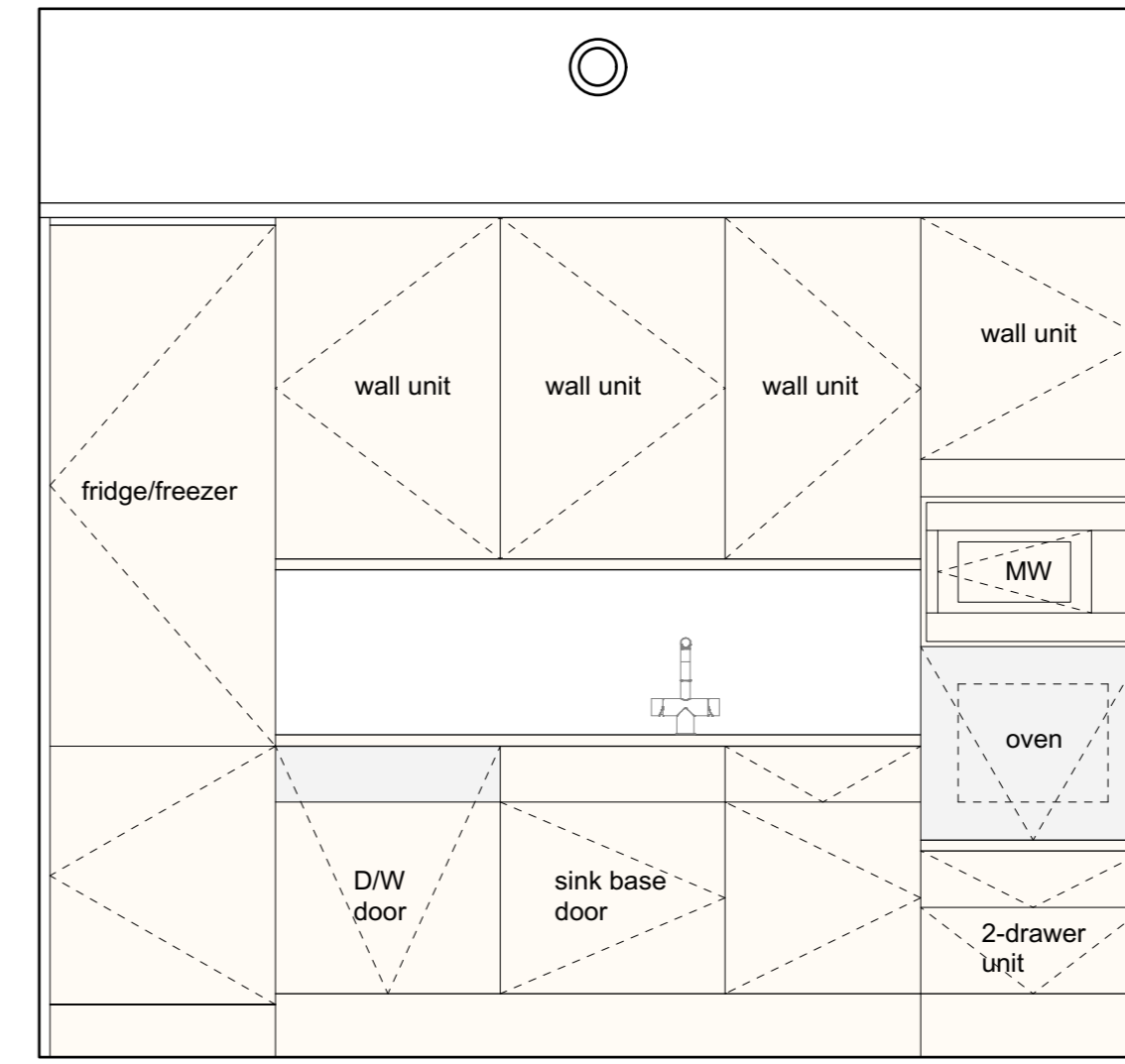

ELEVATION 3

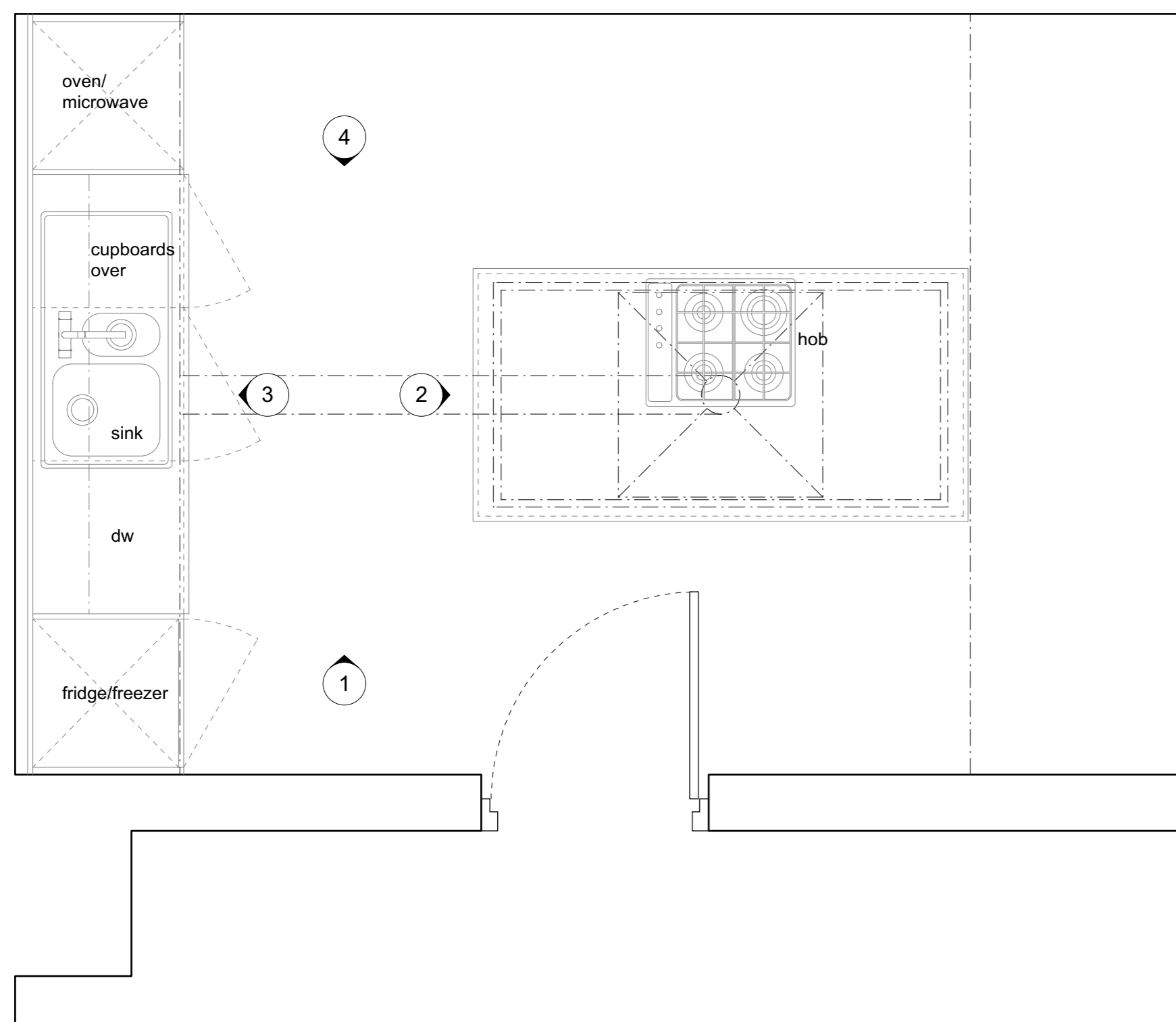

PLAN

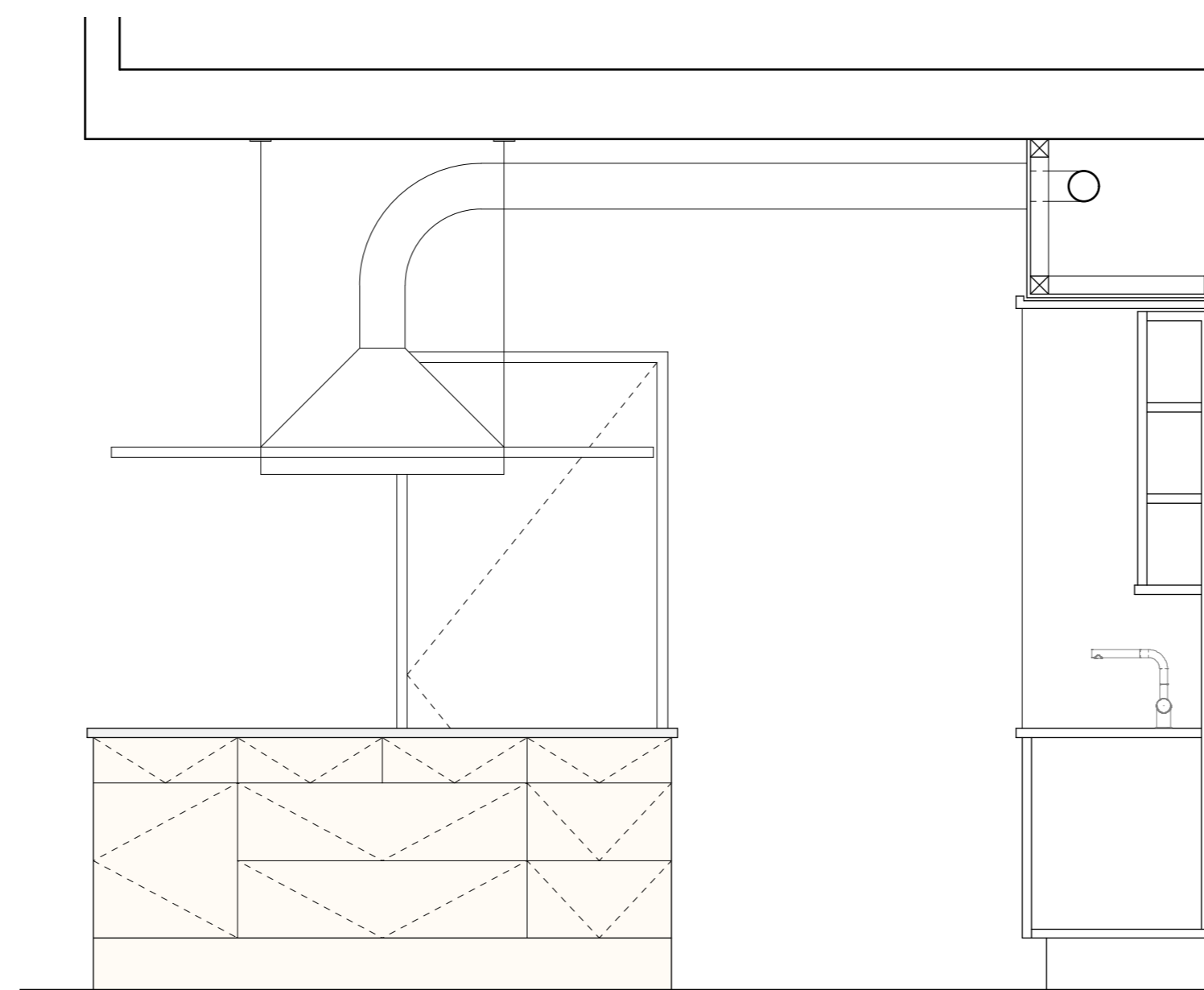

ELEVATION 4

The existing kitchen layout, though appearing simple, is not providing the ergonomically optimal nor most space saving solution. The centrally positioned island in particular causes unnecessarily long journeys between the different appliances and surfaces and makes access to the under counter cupboards and drawers awkward.

It is therefore proposed to re-arrange the kitchen into a more user-friendly C-shape, which would still be clearly defined within the allocated space underneath the gallery. One might argue that the new arrangement provides an even clearer definition of different zones than the current one. The existing main feature of the room, the kitchen extract hood, is proposed to be retained and only re-positioned slightly above the new hob, but keeping the strong symmetry of the room.

The existing non-original appliances, and partially original joinery items are worn out and in some areas damaged - please refer to the photographs on drawing GUW10-E151.

They are proposed to be removed and to be replaced in a sympathetic style - please refer to drawing GUW10-P143 for details and specification references and to submitted samples for finishes.

**General Notes**  
 - Do not scale from this drawing  
 - All dimensions to be verified on site  
 - To be read in conjunction with all relevant documents  
 - In the event of discrepancy notify the Architect immediately  
 - All steel structural elements to be finished with intumescent coating, 30 minutes fire resistance. For all structural elements and connections see SE drawings  
 - This document is copyright of Hugh Cullum Architects Ltd

**Issue Status**  
 SK Sketch E Existing Condition  
 D Design P Permissions  
 T Tender C Contract

( ): Issued for Planning

23.10.20 /TS/TS)

**HUGH CULLUM**  
 ARCHITECTS LTD  
 Bloomsbury Design  
 61b Judd Street  
 London WC1H 9QT  
 t 020 7383 7647  
 f 020 7387 7645  
 mail@hughcullum.com

**10 Grand Union Walk**  
 Existing  
 Kitchen Details  
 1:20@A1 Oct 2020  
 Drawn: TS Checked: TS  
**GUW10-E143( )**



Existing\_Kitchen