

General note:
Replace all face fixed pipework and wiring with pipework and wiring concealed in walls and floors, as per the original design;
tidy and clean up interior to re-instate original high-tech appearance where possible

General Notes
Do not scale from this drawing
All dimensions to be verified on site
To be read in conjunction with all relevant documents
In the event of discrepancy notify the Architect immediately
This document is copyright of Hugh Cullum Architects Ltd

Issue Status

SK	Sketch	E	Existing Condition
D	Design	P	Permissions
T	Tender	C	Contract

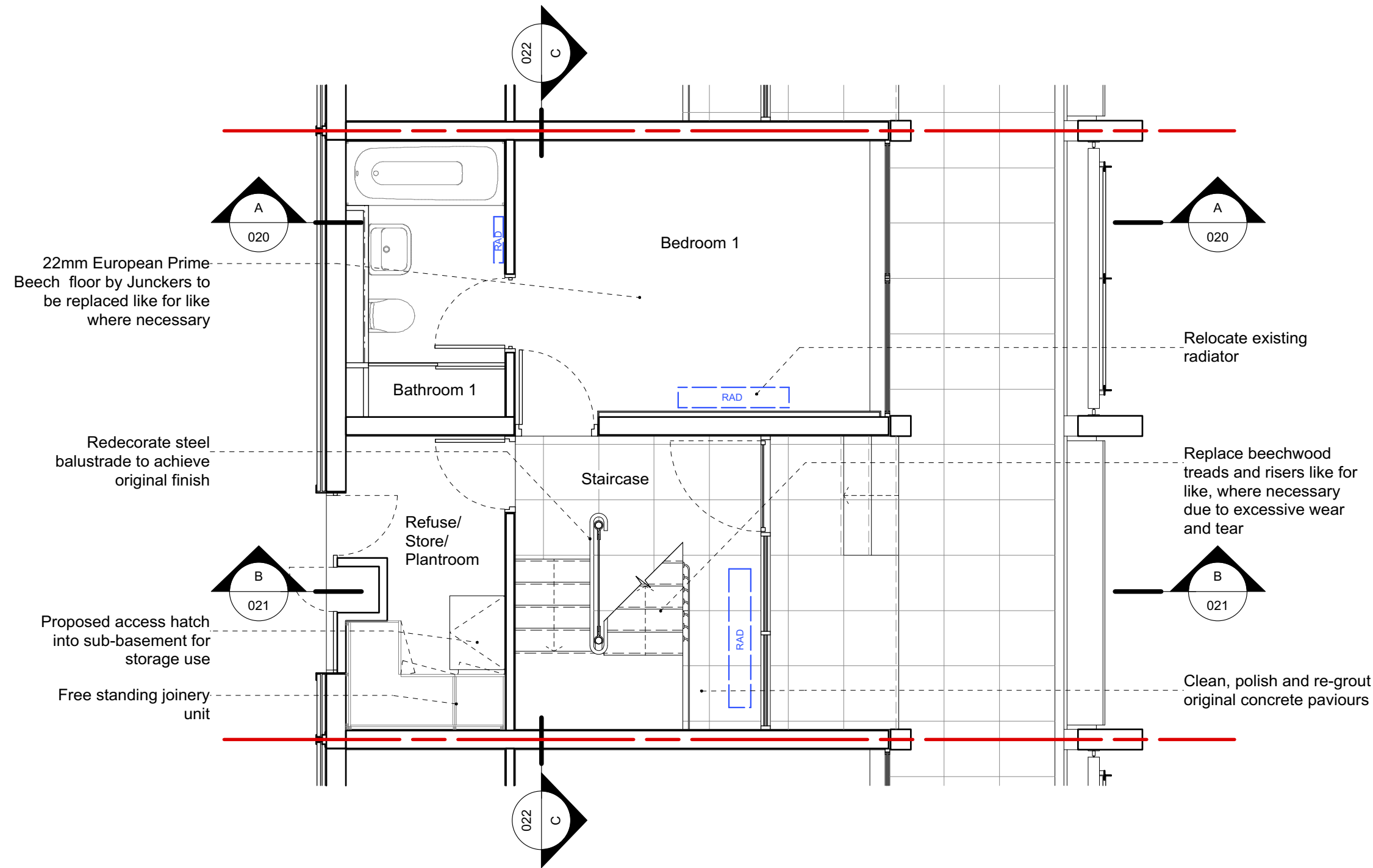

(B): Bathroom layout retained; stair balustrade added; plant room layout revised; annotations amended 29.06.20 /TS/TS)

(A): Annotations revised; additional information to plant room 12.05.20 /TS/TS)

(): Revision Information 10.01.20 /TS/TS)

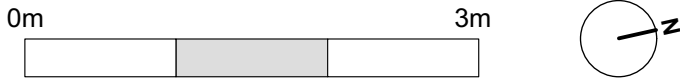

Proposed_Ground Floor Plan

HUGH CULLUM
ARCHITECTS LTD
Bloomsbury Design
61b Judd Street
London WC1H 9QT
t 020 7383 7647
f 020 7387 7645
mail@hughcullum.com

10 Grand Union Walk
Proposed
Ground Floor Plan
1:50@A3 Jan 2020
Drawn: TS Checked: TS
GUW10-P010(B)