

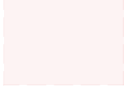

General Notes
 Do not scale from this drawing
 All dimensions to be verified on site
 To be read in conjunction with all relevant documents
 In the event of discrepancy notify the Architect immediately
 This document is copyright of Hugh Cullum Architects Ltd

Issue Status

SK	Sketch	E	Existing Condition
D	Design	P	Permissions
T	Tender	C	Contract

(): Issued for Planning 23.10.20 /TS/TS)

 Indicates surfaces to be demolished

 Indicates fixtures to be demolished

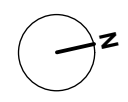
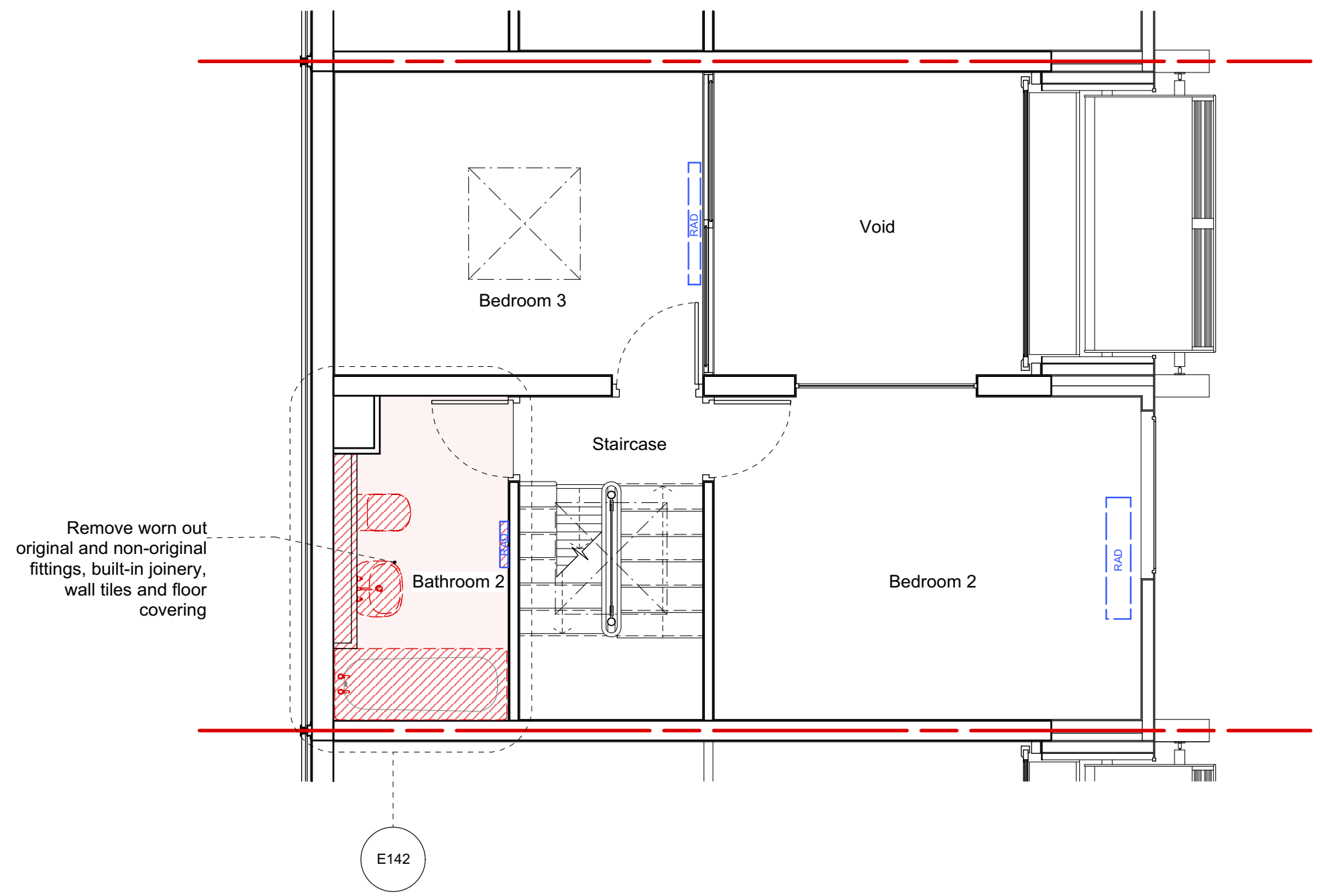

As Existing_Second Floor Plan

HUGH CULLUM ARCHITECTS LTD
 Bloomsbury Design
 61b Judd Street
 London WC1H 9QT
 t 020 7383 7647
 f 020 7387 7645
 mail@hughcullum.com

10 Grand Union Walk
 As Existing
 Second Floor Plan
 1:50@A3 Oct 2020
 Drawn: TS Checked: TS
GUW10-E112()