

- LEGEND**
- EXISTING FOUL SEWER
 - EXISTING MANHOLE
 - EXG — EXISTING GULLY
 - S1 — PROPOSED SURFACE WATER MANHOLE
 - ST1 — PROPOSED SW SLIP TRAP MANHOLE
 - FWMH — PROPOSED FOUL WATER MANHOLE
 - G — PROPOSED GULLY CONNECTED TO SURFACE WATER SYSTEM
 - YG — PROPOSED YARD GULLY CONNECTED TO SURFACE WATER SYSTEM
 - ACO M150 — PROPOSED DRAINAGE CHANNEL
 - SU — PROPOSED DRAINAGE CHANNEL SUMP
 - 150ø @ 1:150 — DENOTES BELOW GROUND SURFACE WATER DRAINAGE
 - 150ø @ 1:150 — DENOTES BELOW GROUND FOUL DRAINAGE
 - SIC — PROPOSED SURFACE WATER INSPECTION CHAMBER (450mm DIA)
 - SAC — PROPOSED SURFACE WATER ACCESS CHAMBER (250mm DIA)
 - FIC — PROPOSED FOUL WATER INSPECTION CHAMBER (450mm DIA)
 - FAC — PROPOSED FOUL WATER ACCESS CHAMBER (250mm DIA)
 - RE — DENOTES RODDING EYE
 - RWP — DENOTES VERTICAL RAIN WATER STACK TO GROUND
 - RWP(RA) — DENOTES VERTICAL RAIN WATER STACK TO GROUND WITH RODDABLE ACCESS
 - SVP — DENOTES VERTICAL FOUL STACK TO GROUND
 - FG — PROPOSED GULLY CONNECTED TO FOUL DRAINAGE SYSTEM
 - SITE BOUNDARY

RISK SCHEDULE

ITEM	DESCRIPTION OF RISK OF ACTION
⚠	SPECIFIC HEALTH AND SAFETY RISKS ASSOCIATED WITH THESE WORKS ARE HIGHLIGHTED WITH THE CAUTION SYMBOL ADJACENT TO THE ITEM OF RISK. PLEASE REFER TO RISK SCHEDULE CONTAINED ON INDIVIDUAL DRAWINGS.
	UNLESS HIGHLIGHTED THERE ARE NO SPECIFIC HEALTH AND SAFETY RISKS ASSOCIATED WITH THESE WORKS, AS A DIRECT RESULT OF OUR DESIGN, APART FROM THE COMMON ISSUES ASSOCIATED WITH CONSTRUCTION THAT WILL NEED TO BE ASSESSED BY A COMPETENT CONTRACTOR PRIOR TO THE UNDERTAKING OF ANY WORKS.
⚠	THE CONTRACTOR SHOULD BE AWARE OF DEEP EXCAVATIONS FOR SEWERS
⚠	THE CONTRACTOR SHOULD BE AWARE OF THE EXISTING HIGHWAYS ADJACENT TO THE SITE.
⚠	THE CONTRACTOR SHOULD BE AWARE OF EXISTING SERVICES REMAIN LIVE DURING CONSTRUCTION

HEALTH & SAFETY:

ALL WORKS TO BE CARRIED OUT BY A CONTRACTOR COMPETENT TO UNDERTAKE THE CONSTRUCTION OF WORKS AS INDICATED ON THIS DRAWING. THIS DRAWING IS TO BE READ IN CONJUNCTION WITH THE JOB SPECIFIC RISK ASSESSMENT. THE HAZARDS NOTED ARE IN ADDITION TO THE NORMAL HAZARDS AND RISKS FACED BY A COMPETENT CONTRACTOR WHEN DEALING WITH THE TYPE OF WORKS DETAILED ON THIS DRAWING.

- LINKED MODEL SCHEDULE**
- NOTES**
- THIS DRAWING IS COPYRIGHT.
 - THE CONTRACTOR AND HIS SUBCONTRACTOR ARE TO VERIFY ALL DIMENSIONS ON SITE PRIOR TO MAKING SHOP DRAWINGS OR COMMENCING MANUFACTURE.
 - DO NOT SCALE THIS DRAWING. THE CONTRACTOR IS TO BRING TO THE NOTICE OF THE ENGINEER ANY DISCREPANCIES CONTAINED IN THIS DRAWING PRIOR TO WORK COMMENCEMENT.
 - ALL 150mm AND 225mm DIAMETER PIPES TO BE EXTRA STRENGTH VITRIFIED CLAY PIPES (SEE NOTE 15).
 - ALL PIPES OF 300mm DIAMETER OR GREATER TO BE CLASS M CONCRETE.
 - ALL PIPE MATERIALS TO BE CONSISTENT BETWEEN MANHOLES.
 - ALL WORK IS TO BE CARRIED OUT IN ACCORDANCE WITH SEWERS FOR ADOPTION 7TH EDITION, THE SPECIFICATION FOR HIGHWAY WORKS 1998 AND ALL SUBSEQUENT, AMENDMENTS AND LOCAL AUTHORITIES DESIGN GUIDE. WHERE THERE IS CONFLICT BETWEEN THESE DOCUMENTS THE MATTER SHALL BE REFERRED TO THE ENGINEER.
 - FOR CONSTRUCTION DETAILS OF MANHOLES AND SEWERS REFER TO SEWERS FOR ADOPTION AND UNTHAKERS STANDARD DETAILS WHICH CAN BE OBTAINED FROM THE LOCAL OFFICE.
 - INVERT LEVELS OF EXISTING SEWERS TO BE CONFIRMED ON SITE BEFORE ANY SEWER WORKS UNDERTAKEN. ANY DISCREPANCIES FOUND SHOULD BE NOTIFIED TO ENGINEERS.
 - WHERE SEWERS HAVE LESS THAN 1.2m OF COVER UNDER ROADS AND 0.9m COVER ELSEWHERE PIPES ARE TO HAVE A 150mm CONCRETE BED AND SURROUND.
 - PLASTIC CHAMBERS AND RINGS SHALL COMPLY WITH BS EN 13598-1 AND BS EN 13598-2 OR HAVE EQUIVALENT INDEPENDENT APPROVAL, TO TABLE 11 OF APPROVED DOCUMENT H1 OF THE BUILDING REGULATIONS 2010.
 - WHERE HOUSE DRAINAGE IS TAKEN THROUGH BLOCK CARE IS TO BE TAKEN THAT FOUNDATION LEVELS AND DRAINAGE RUNS DO NOT CLASH.
 - ALL ADAPTABLE MANHOLES TO HAVE A MINIMUM CLEAR OPENING OF 675mmx675mm AND GRADE D400 UNO.
 - ALL BELOW GROUND DRAINAGE TO BE 100mmø UNLESS OTHERWISE INDICATED WITH A MIN. GRADIENT AS FOLLOWS:-
S.W : 100mm Dia. 1:100
S.W : 150mm Dia. 1:150
F.W : 100mm Dia. 1:80
F.W : 150mm Dia. 1:150
 - ALL ADAPTABLE DRAINAGE MATERIALS SHOULD COMPLY WITH THE REQUIREMENTS OF PART E CIVIL ENGINEERING SPECIFICATION INCLUDED WITH SEWERS FOR ADOPTION 7TH EDITION WHICH IS DRAWN FROM CESWI 7TH EDITION BUT IS NOT A FULL REPRODUCTION.

STATUS	REV	DATE	DESCRIPTION	DSG	DRW	CHK	APP
	S1	P5	29.05.20	BUILDING FND'S UPDATED			MPD
	S0	P4	27.04.20	LANDSCAPING UPDATE			MJH
	S0	P3	28.02.20	LAND DRAIN ADDED TO REAR OF AC			MJH
	S0	P2	07.02.20	DRAINAGE OPTIMISED			MJH
	S0	P1	31.01.20	PRELIMINARY ISSUE			MJH

ALL REVISIONS

MAIN CONTRACTOR

Bouygues UK
Becket House
1 Lambeth Palace Rd
Lambeth, London SE1 7EU
Tel: 020 7401 0020

CLIENT LOGO

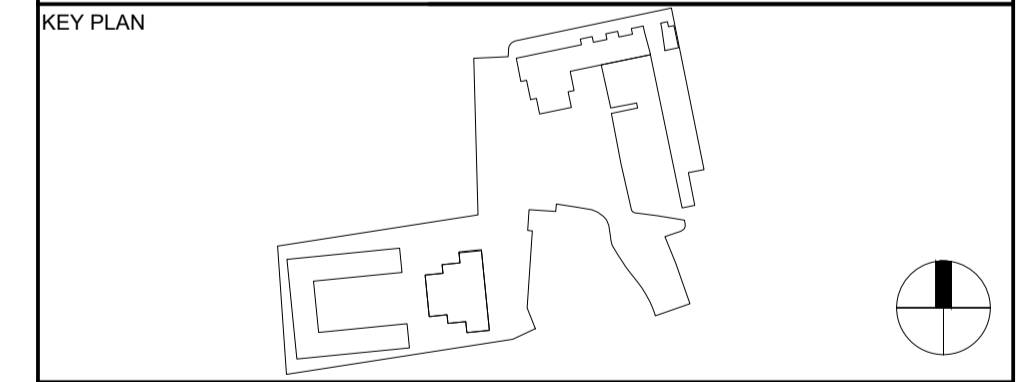

ORIGINATOR

Hampshire Office:
Dewey House, 55 High Street,
Ringwood, Hampshire BH124 1AE
Telephone: 01425 484400
Facsimile: 01425 484499
Email: admin@reuby-stagg.co.uk

PROJECT NAME
MAITLAND PARK REDEVELOPMENT

DRAWING TITLE
ASPEN COURT AND VILLAS
DRAINAGE LAYOUT

SCALE @ A1	MODEL FILE NAME - REVISION						
1:200	MPR-RAS-ALL-XX-IE-CIV-000250 - P03						
FIRST ISSUE DATE	PROJECT STAGE	STATUS CODE					
28/02/2020	Stage 4	S1 - Suitable for Coordination					
PROJECT	ORIGINATOR	VOLUME	LEVEL	TYPE	ROLE	NUMBER	REV
MPR	RAS	ZZ	XX	GA	C	000250	P05

END OF STAGE 4
FINAL TENDER