

SCALE BAR (METRES)

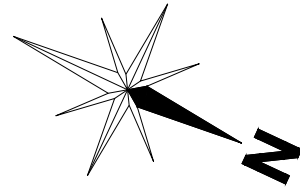

APPROX. AREAS

BASEMENT

CUSTOMER AREA - 28m²

BACK OF HOUSE AREA - 9m²

GROUND FLOOR

CUSTOMER AREA - 14m²

BACK OF HOUSE AREA - 49m²

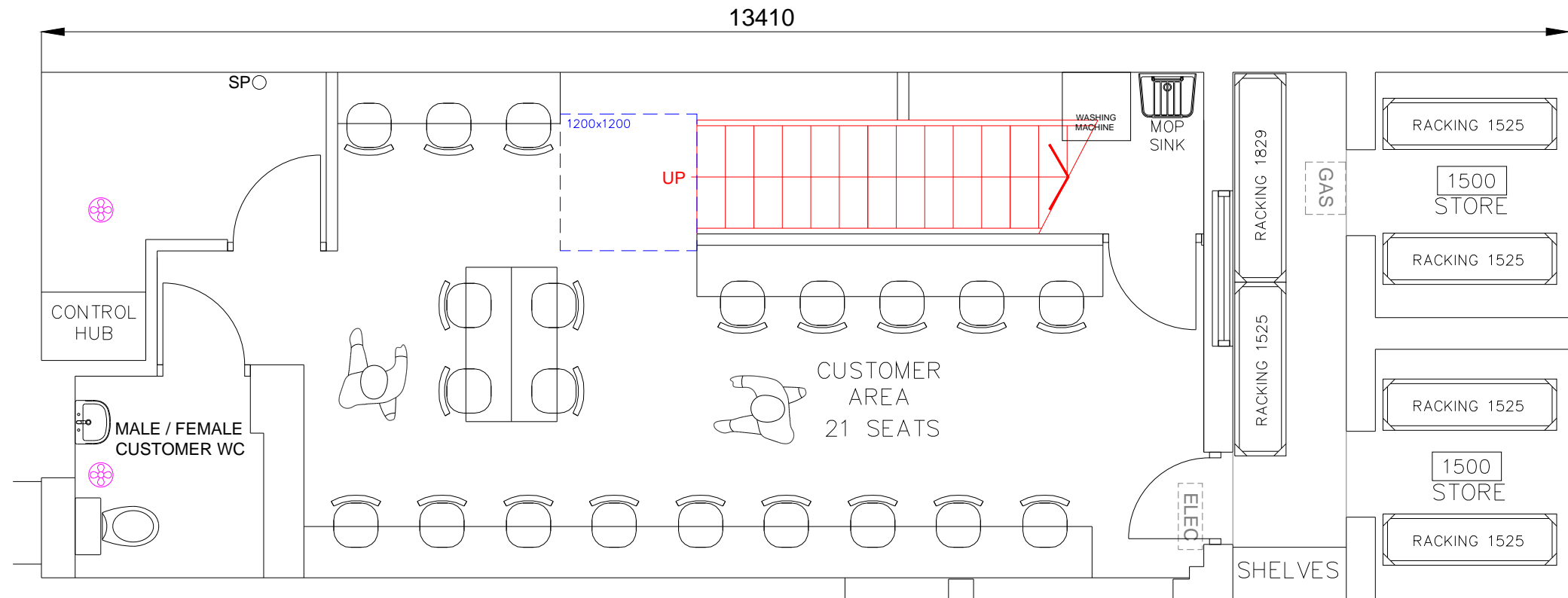

PROPOSED BASEMENT 59m²

FORM NEW STAIRCASE DOWN TO BASEMENT

- STAIR WIDTH = MIN 1200mm HANDRAIL REQUIRED TO BOTH SIDES (STAIR CAN REDUCE TO MIN WIDTH OF 1000mm BETWEEN HANDRAILS). HANDRAILS SHOULD BE POSITIONED 900 TO 1000mm ABOVE THE PITCH LINE.
- RISERS BETWEEN 150 AND 170mm & TREADS BETWEEN 250 AND 400mm
- MAX PITCH 42 DEGREES
- 1200mm SQUARE LANDINGS AT THE TOP AND BOTTOM OF THE STAIR (ENTRANCE DOOR PROPOSED ENCROACHES INTO THE LANDING SPACE)

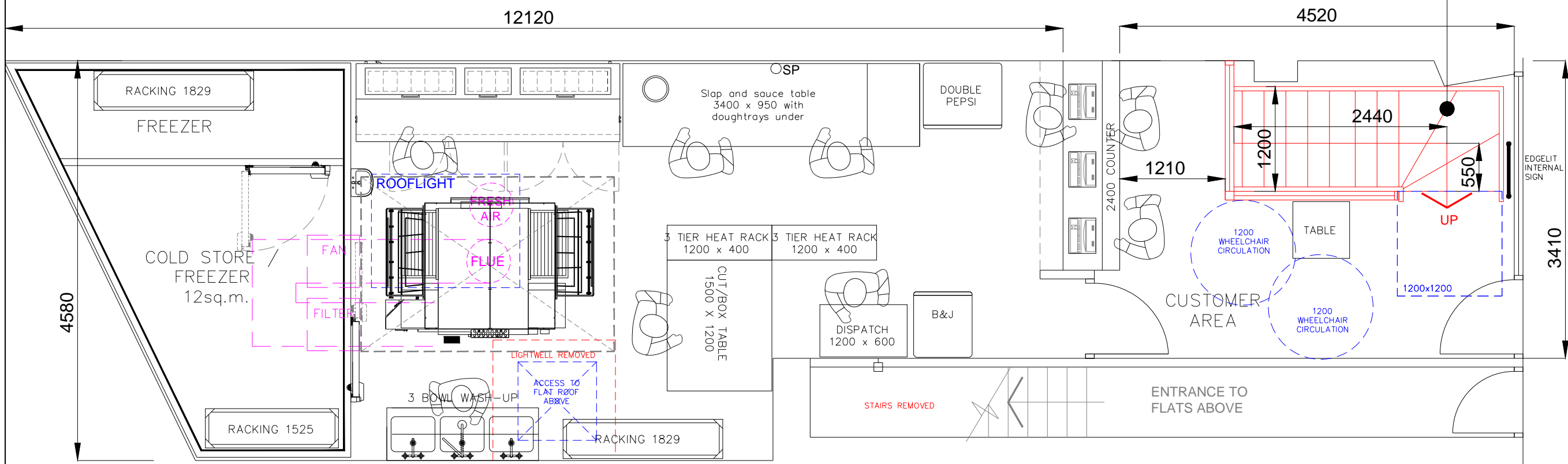

PROPOSED GROUND FLOOR 61m²

N	DRAWING REVISED	15.09.20	MAS
M	DRAWING REVISED	10.09.20	MAS
L	DRAWING REVISED	08.09.20	MAS
K	DRAWING REVISED	08.09.20	MAS
J	DRAWING REVISED	17.08.20	MAS
I	DRAWING REVISED	30.07.20	MAS
H	DRAWING REVISED	28.07.20	MAS
G	DRAWING REVISED	04.03.20	MAS
F	DRAWING REVISED	23.02.20	MAS
E	DRAWING REVISED	19.02.20	MAS
D	DRAWING REVISED	09.02.20	MAS
C	DRAWING REVISED	19.12.19	MAS
B			
A			

REV	AMENDMENT	DATE	CHKD
MA DESIGN MARTIN ANTHONY DESIGN LIMITED			
CLIENT			

PROJECT
43 THEOBALDS ROAD
HOLBORN
WC1X 8SP

DRAWING TITLE
PROPOSED PLANS

SCALE 1:50@A3	DRAWN BY MAS	CHECKED -	DATE DEC'19
DRAWING NUMBER 19119-10		REVISION N	