

Copyright Hawkins\Brown Architects
 No implied licence exists. This drawing should not be used to calculate areas for the purposes of valuation. Do not scale this drawing. All dimensions to be checked on the site by the contractor and such dimensions to be their responsibility. All work must comply with relevant British Standards and Building Regulations requirements. Drawing errors and omissions to be reported to the architect. To be read in conjunction with Architect's specification and other consultant information.

Rev	Description	Date
P1	Plot 1 drawing update: 01 footprint updated (NE corner)	14.08.20

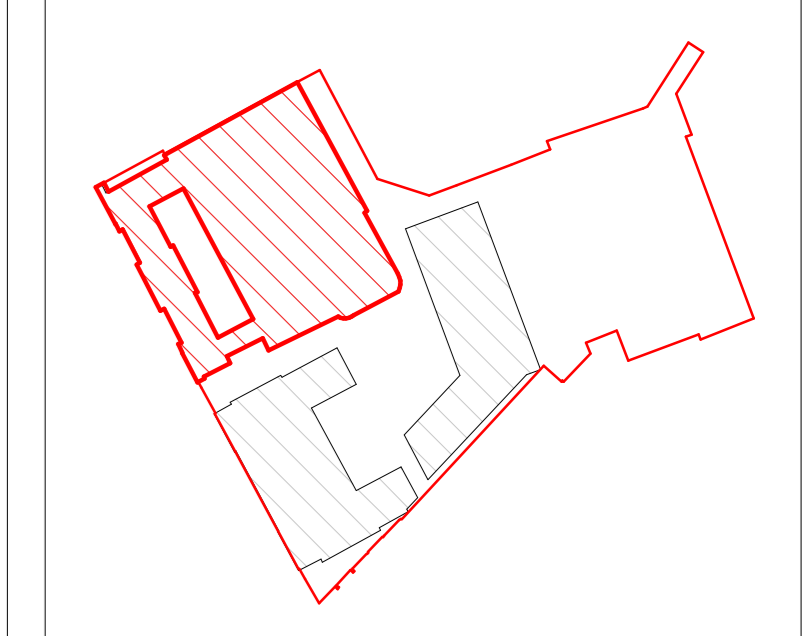

Site Plan: NTS

Planning Boundary

Note: Site boundary shown for information purposes only and does not represent a legal site demise. Boundary line is approximate and existing boundary condition / restraints unknown - to be confirmed on site.

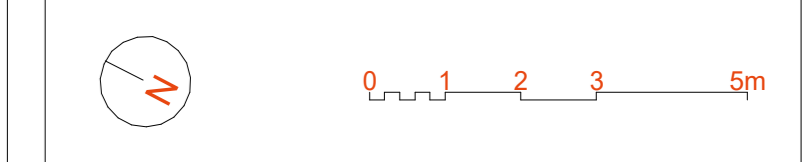

159 St John Street
 London EC1V 4GJ
 mail@hawkinsbrown.com
 hawkinsbrown.com

Hawkins\Brown

Project
 IoN/DRI Redevelopment Project
 256 Grays Inn Road

Drawing
 Plot 1 Level B1 GA Plan - Proposed

Scale @ A0
 1 : 100
 Date
 August 2020

Drawn By
 Checked By

Job Number
 17056
 Status
 P1
 Purpose of Issue
 Planning

Drawing No.
 BEMP-HBA-P1-B1-DR-A-20-1101
 Rev
 P1