

**SITE LOCATION**  
(Scale 1:50000)

Ordnance Survey map extract based upon Landranger map series with the permission of the controller of Her Majesty's Stationery Office Licence No. 0100023487 Crown copyright.

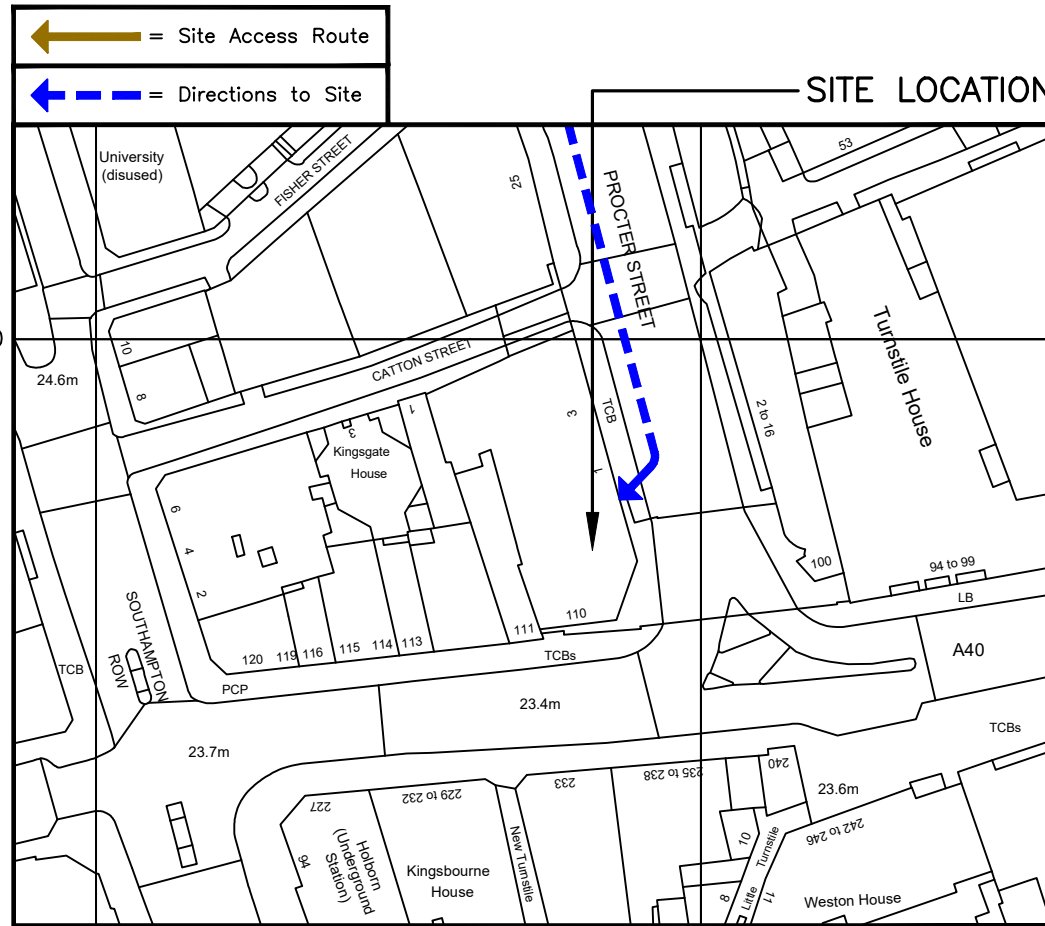

**SITE PHOTOGRAPH**

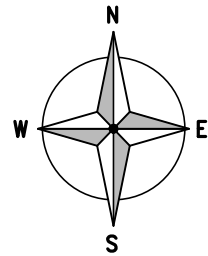

181600

530500

530600

**DETAILED SITE LOCATION**  
(Scale 1:1250)

Based upon Ordnance Survey map extract with the permission of the Controller of Her Majesty's Stationery Office. Crown copyright. Licence No. 100020449

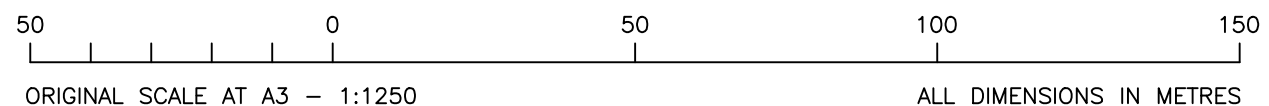

ORIGINAL SCALE AT A3 - 1:1250

ALL DIMENSIONS IN METRES

ALL DIMENSIONS ARE IN mm UNLESS NOTED OTHERWISE

N.G.R | E: 530566 N: 181574

CONCESSION REQUIRED | YES

**DIRECTIONS TO SITE:**  
FOLLOW M1 INTO LONDON AND KEEP LEFT ONTO A406, THEN IMMEDIATELY TAKE THE RAMP TO CENTRE LONDON WEST. AT THE ROUNDABOUT TAKE THE 3rd EXIT TOWARDS CENTRAL LONDON/KILBURN ON THE A41. CONTINUE ON THE A41 FOR 3 MILES THEN CONTINUE ONTO B525 FOR 0.6 MILE. TURN LEFT ONTO OUTER CIRCLE THEN AFTER 0.7 MILE TURN LEFT ONTO GLOUCESTER GATE. TURN FIRST RIGHT ONTO ALBANY ST/A4201 THEN AFTER 1 MILE TURN LEFT ONTO EUSTON ROAD/A501. TURN RIGHT ONTO A4200 AND CONTINUE FOR 0.7 MILE, TURN FIRST RIGHT ONTO DRAKE STREET THEN FIND SITE LOCATED ON UPPER ROOF OF 110 HIGH HOLBORN

NOTES:

A	Issued for Construction	LH	UP	15.09.20
REV	MODIFICATION	BY	CH	DATE



Great British Communications  
Lapwing House, Block 3 Forward Point,  
Tan House Lane, Widnes, Cheshire. WAB OSL  
t. 44 (0)151 420 4128  
www.gbcservices.co.uk



CTIL - LONDON

Cell Name		Opt.
110 HIGH HOLBORN		-
Cell ID No		
CTIL	TEF	VF
E331092	73447	N/A
150763_21		

**Site Address / Contact Details**

110 HIGH HOLBORN  
HOLBORN  
LONDON  
WC1V 6EU

Drawing Title: **SITE LOCATION MAPS**

Purpose of issue: **CONSTRUCTION**

Drawing Number: **100**

Scale: AS SHOWN	Sheet Size: A3	Drawn: MW	Date: 25.10.19	Pack Issue:
Checked: MNH	Date: 25.10.19	Approved: MNH	Date: 25.10.19	B

THESE DRAWINGS COMPLY WITH **STANDARD**  
TELEFONICA / VODAFONE ICNIRP DESIGN GUIDELINES



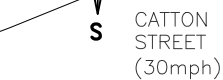
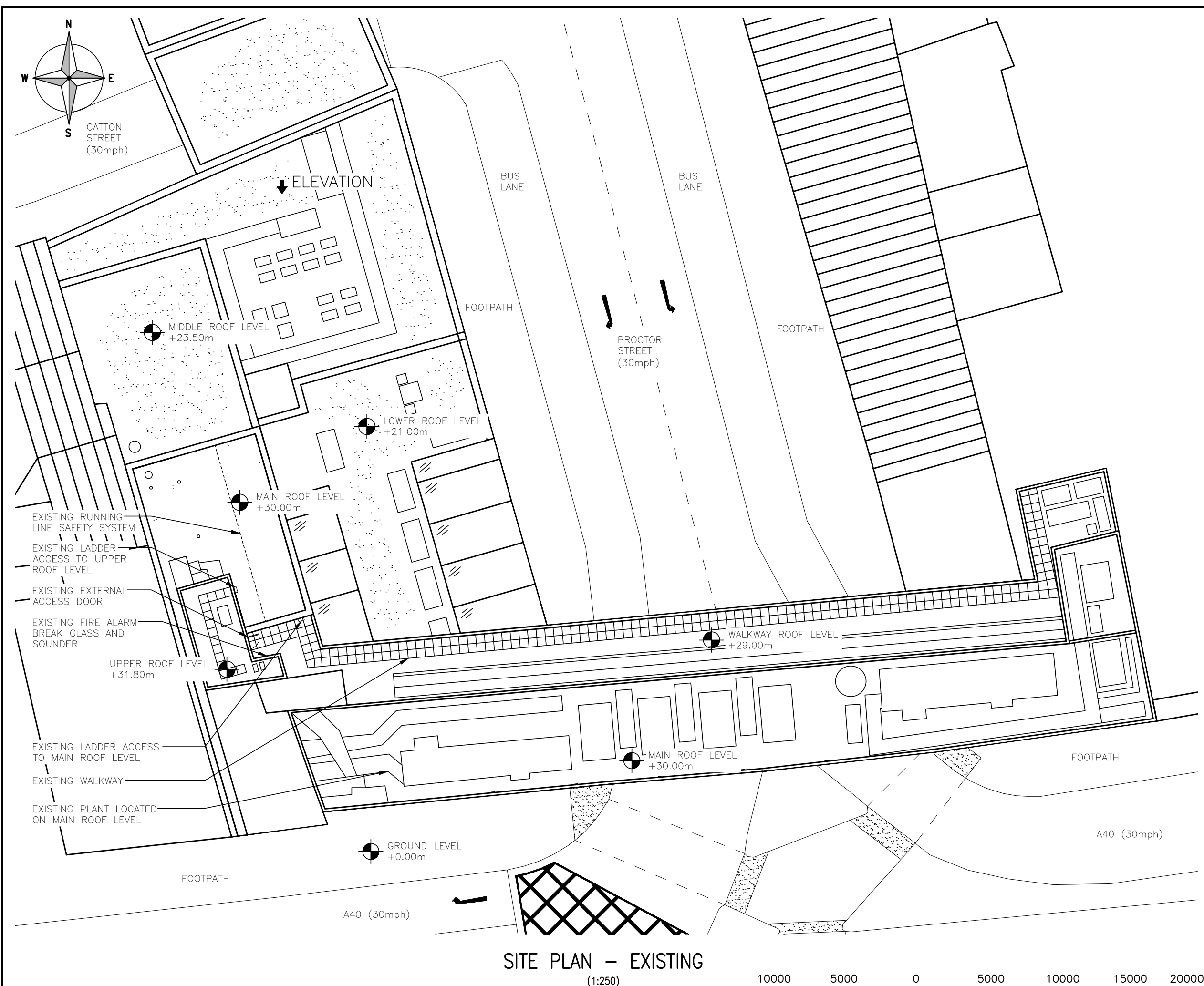

CATTON STREET (30mph)

ELEVATION

BUS LANE

BUS LANE

FOOTPATH

FOOTPATH

PROCTOR STREET (30mph)

MIDDLE ROOF LEVEL +23.50m

LOWER ROOF LEVEL +21.00m

MAIN ROOF LEVEL +30.00m

WALKWAY ROOF LEVEL +29.00m

UPPER ROOF LEVEL +31.80m

MAIN ROOF LEVEL +30.00m

GROUND LEVEL +0.00m

A40 (30mph)

A40 (30mph)

- EXISTING RUNNING LINE SAFETY SYSTEM
- EXISTING LADDER ACCESS TO UPPER ROOF LEVEL
- EXISTING EXTERNAL ACCESS DOOR
- EXISTING FIRE ALARM BREAK GLASS AND SOUNDER

- EXISTING LADDER ACCESS TO MAIN ROOF LEVEL
- EXISTING WALKWAY
- EXISTING PLANT LOCATED ON MAIN ROOF LEVEL

SITE PLAN – EXISTING  
(1:250)

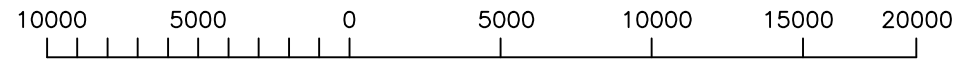

ORIGINAL SCALE AT A3 – 1:250 ALL DIMENSIONS IN MILLIMETRES

THESE DRAWINGS COMPLY WITH STANDARD TELEFONICA / VODAFONE ICNIRP DESIGN GUIDELINES

ALL DIMENSIONS ARE IN mm UNLESS NOTED OTHERWISE

N.G.R	E: 530566	N: 181574
CONCESSION REQUIRED		YES

NOTES:

A	Issued for Construction	LH	UP	15.09.20
REV	MODIFICATION	BY	CH	DATE

Great British Communications  
Lapwing House, Block 3 Forward Point,  
Tan House Lane, Widnes, Cheshire. WAB 0SL  
t. 44 (0)151 420 4128  
www.gbcservices.co.uk

CTIL - LONDON

Cell Name	Opt.
110 HIGH HOLBORN	-

Cell ID No		
CTIL	TEF	VF
E331092	73447	N/A
150763_21		

Site Address / Contact Details		
110 HIGH HOLBORN HOLBORN LONDON WC1V 6EU		

Drawing Title: SITE PLAN – EXISTING

Purpose of issue:	CONSTRUCTION	Dwg Rev:
-------------------	--------------	----------

Drawing Number:	200	A
-----------------	-----	---

Scale:	Sheet Size:	Drawn:	Date:	Pack Issue:
AS SHOWN	A3	MW	25.10.19	B
Checked:	Date:	Approved:	Date:	
MNH	25.10.19	MNH	25.10.19	

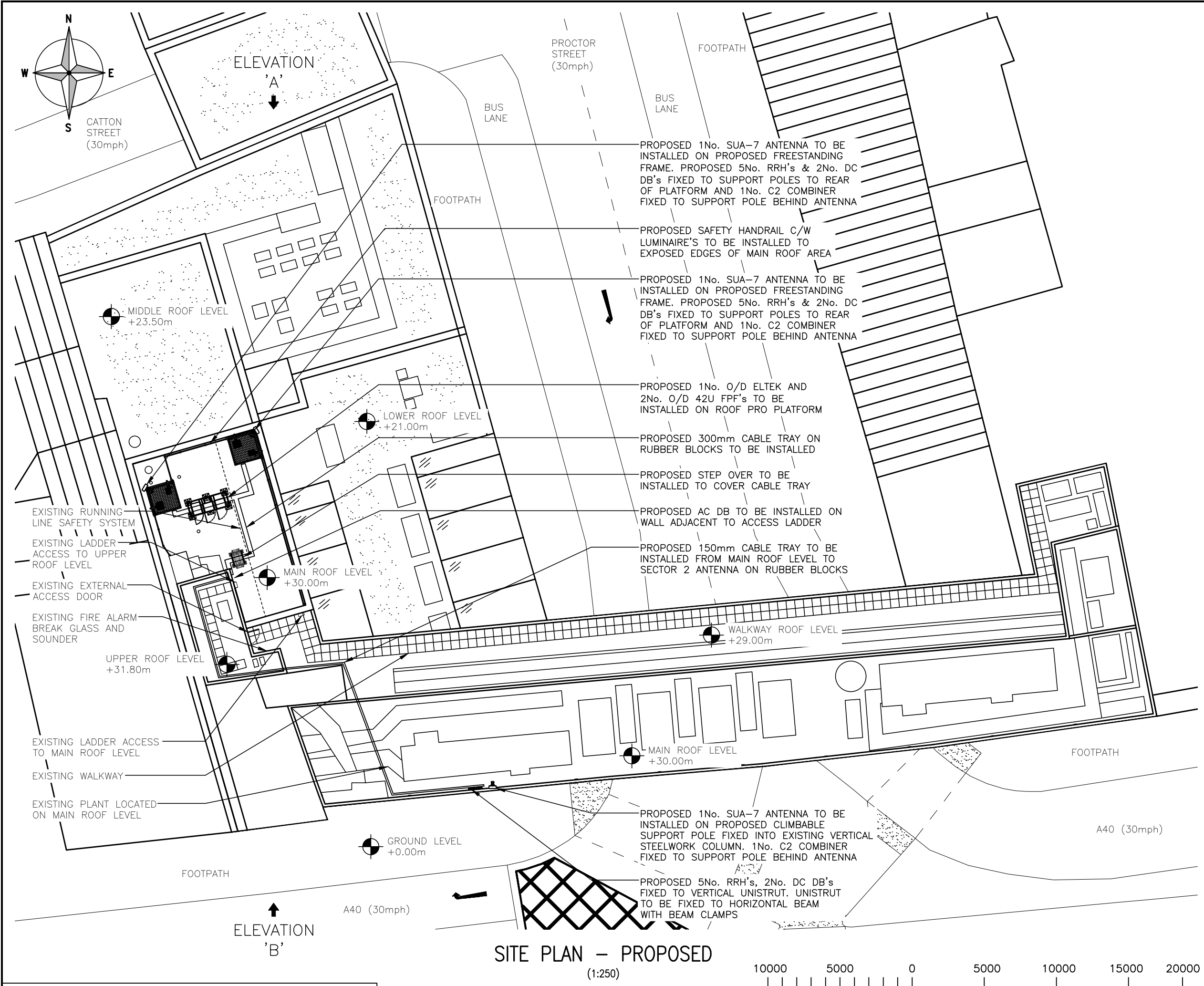

**SITE PLAN – PROPOSED**  
(1:250)

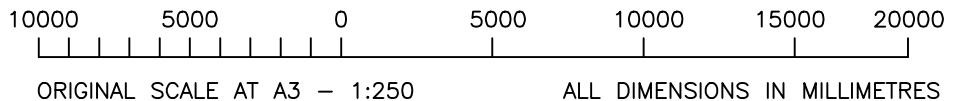

THESE DRAWINGS COMPLY WITH **STANDARD TELEFONICA / VODAFONE ICNIRP DESIGN GUIDELINES**

ALL DIMENSIONS ARE IN mm UNLESS NOTED OTHERWISE

N.G.R	E: 530566	N: 181574
CONCESSION REQUIRED	YES	
NOTES: STRUCTURAL ANALYSIS OF BUILDING REQUIRED TO CONFIRM INSTALLATION		

B	Proposed Antennas Revised	TR	GBC	29.09.20
A	Issued for Construction	LH	UP	15.09.20
REV	MODIFICATION	BY	CH	DATE

**Great British Communications**  
Lapping House, Block 3 Forward Point,  
Tan House Lane, Widnes, Cheshire. WAB 0SL  
t. 44 (0)151 420 4128  
www.gbcservices.co.uk

**CTIL - LONDON**

Cell Name	Opt.	
110 HIGH HOLBORN	-	
Cell ID No		
CTIL	TEF	VF
E331092	73447	N/A
150763_21		

**Site Address / Contact Details**

110 HIGH HOLBORN  
HOLBORN  
LONDON  
WC1V 6EU

Drawing Title:	SITE PLAN – PROPOSED		
Purpose of issue:	CONSTRUCTION		
Drawing Number:	201	Dwg Rev:	B
Scale:	AS SHOWN	Sheet Size:	A3
Drawn:	MW	Date:	25.10.19
Checked:	MNH	Approved:	MNH
Date:	25.10.19	Date:	25.10.19
Pack Issue:	B		

ALL DIMENSIONS ARE IN mm UNLESS NOTED OTHERWISE

N.G.R | E: 530566 | N: 181574

CONCESSION REQUIRED | YES

NOTES:

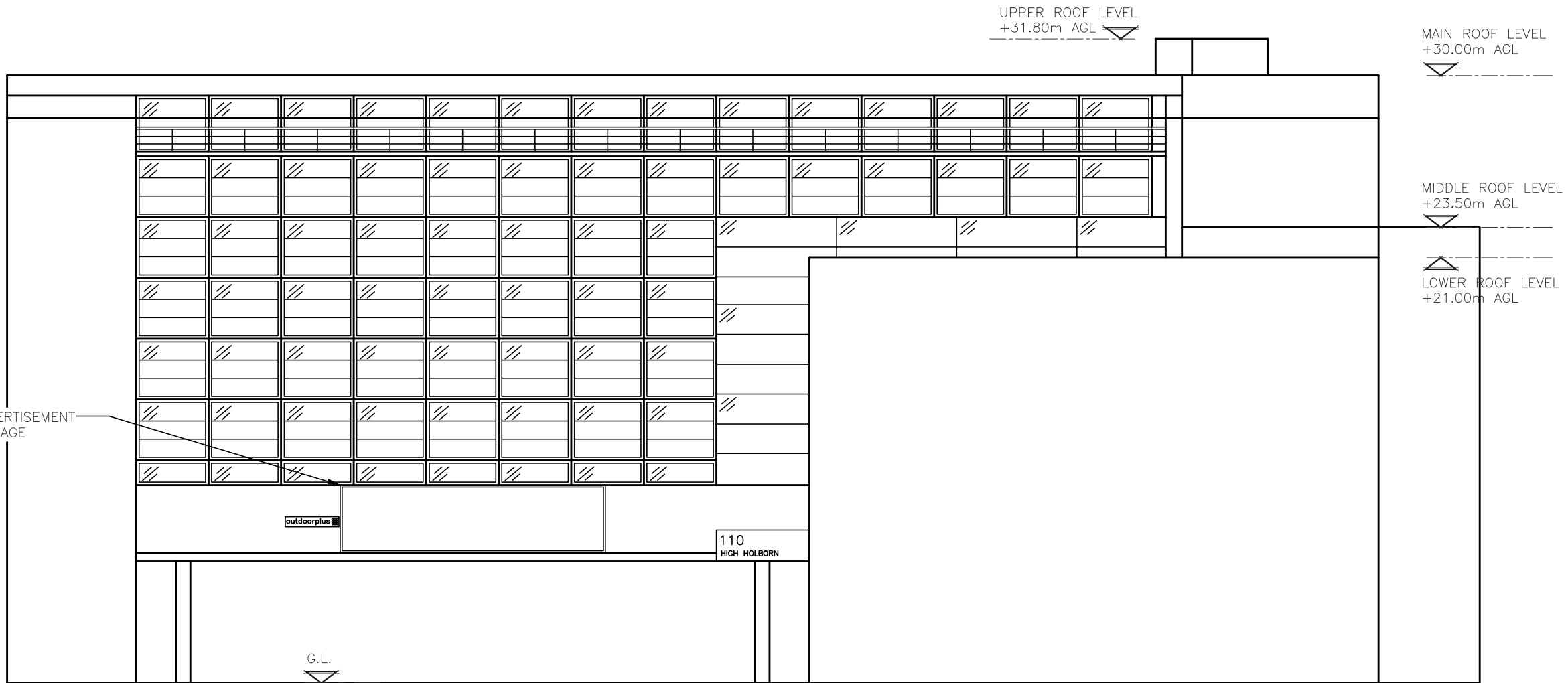

SITE ELEVATION – EXISTING  
(1:250)

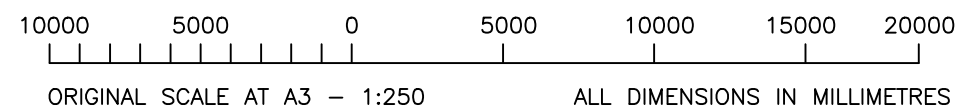

THESE DRAWINGS COMPLY WITH **STANDARD**  
TELEFONICA / VODAFONE ICNIRP DESIGN GUIDELINES

A	Issued for Construction	LH	UP	15.09.20
REV	MODIFICATION	BY	CH	DATE

**GBC**  
Great British Communications  
Lapwing House, Block 3 Forward Point,  
Tan House Lane, Widnes, Cheshire. WAB 0SL  
t. 44 (0)151 420 4128  
www.gbcservices.co.uk

**O<sub>2</sub>**  
CTIL - LONDON

Cell Name	Opt.
110 HIGH HOLBORN	-

Cell ID No		
CTIL	TEF	VF
E331092	73447	N/A
150763_21		

Site Address / Contact Details

110 HIGH HOLBORN  
HOLBORN  
LONDON  
WC1V 6EU

Drawing Title:  
SITE ELEVATION – EXISTING

Purpose of issue:  
**CONSTRUCTION**

Drawing Number:  
300

Scale: AS SHOWN	Sheet Size: A3	Drawn: MW	Date: 25.10.19	Pack Issue:
Checked: MNH	Date: 25.10.19	Approved: MNH	Date: 25.10.19	B

PROPOSED 5No. RRH's & 2No. DC DB's  
FIXED TO VERTICAL UNISTRUT. UNISTRUT  
TO BE FIXED TO HORIZONTAL BEAM WITH  
BEAM CLAMPS (HIDDEN FROM VIEW)

PROPOSED 1No. SUA-7 ANTENNA TO BE  
INSTALLED ON PROPOSED CLIMBABLE  
SUPPORT POLE FIXED INTO EXISTING VERTICAL  
STEELWORK COLUMN. 1No. C2 COMBINER  
FIXED TO SUPPORT POLE BEHIND ANTENNA

PROPOSED AC DB TO BE INSTALLED  
ON WALL ADJACENT TO ACCESS  
LADDER (HIDDEN FROM VIEW)

PROPOSED 1No. SUA-7 ANTENNA TO BE  
INSTALLED ON PROPOSED FREESTANDING  
FRAME. PROPOSED 5No. RRH's & 2No.  
DC DB's FIXED TO SUPPORT POLES TO  
REAR OF PLATFORM AND 1No. C2  
COMBINER FIXED TO SUPPORT POLE  
BEHIND ANTENNA

PROPOSED GPS MODULE

PROPOSED 1No. O/D ELTEK AND  
2No. O/D 42U FPF's TO BE  
INSTALLED ON ROOF PRO PLATFORM

PROPOSED SAFETY HANDRAIL C/W  
LUMINAIRES TO BE INSTALLED TO  
EXPOSED EDGES OF MAIN ROOF AREA

TOP OF PROPOSED ANTENNAS  
+33.00m AGL

UPPER ROOF LEVEL  
+31.80m AGL

TOP OF PROPOSED ANTENNAS  
+33.30m AGL

U/S OF PROPOSED ANTENNAS  
+31.20m AGL

U/S OF PROPOSED ANTENNAS  
+30.90m AGL

MAIN ROOF LEVEL  
+30.00m AGL

MIDDLE ROOF LEVEL  
+23.50m AGL

LOWER ROOF LEVEL  
+21.00m AGL

ADVERTISEMENT  
SIGNAGE

outdoorplus

110  
HIGH HOLBORN

G.L.

NORTH ELEVATION – PROPOSED

(1:250)

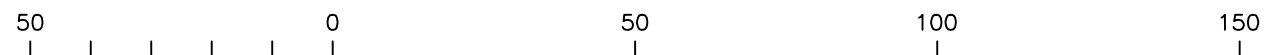

ORIGINAL SCALE AT A3 – 1:1250

ALL DIMENSIONS IN METRES

THESE DRAWINGS COMPLY WITH **STANDARD**  
TELEFONICA / VODAFONE ICNIRP DESIGN GUIDELINES

ALL DIMENSIONS ARE IN mm UNLESS NOTED OTHERWISE

N.G.R | E: 530566 N: 181574

CONCESSION REQUIRED | YES

NOTES:  
STRUCTURAL ANALYSIS OF BUILDING REQUIRED  
TO CONFIRM INSTALLATION

B	Proposed Antennas Revised	TR	GBC	29.09.20
A	Issued for Construction	LH	UP	15.09.20
REV	MODIFICATION	BY	CH	DATE



Great British Communications  
Lapwing House, Block 3 Forward Point,  
Tan House Lane, Widnes, Cheshire. WAB 0SL  
t. 44 (0)151 420 4128  
www.gbcservices.co.uk



CTIL - LONDON

Cell Name | Opt.

110 HIGH HOLBORN | -

Cell ID No

CTIL	TEF	VF
E331092	73447	N/A
150763_21		

Site Address / Contact Details

110 HIGH HOLBORN  
HOLBORN  
LONDON  
WC1V 6EU

Drawing Title:  
SITE ELEVATION – PROPOSED (1)

Purpose of issue: **CONSTRUCTION** | Dwg Rev:

Drawing Number: 301 | B

Scale: AS SHOWN	Sheet Size: A3	Drawn: MW	Date: 25.10.19	Pack Issue:
Checked: MNH	Date: 25.10.19	Approved: MNH	Date: 25.10.19	B



PROPOSED AC DB TO BE INSTALLED ON WALL ADJACENT TO ACCESS LADDER (HIDDEN FROM VIEW)

PROPOSED 1No. SUA-7 ANTENNA TO BE INSTALLED ON PROPOSED FREESTANDING FRAME. PROPOSED 5No. RRH's & 2No. DC DB's FIXED TO SUPPORT POLES TO REAR OF PLATFORM AND 1No. C2 COMBINER FIXED TO SUPPORT POLE BEHIND ANTENNA

PROPOSED GPS MODULE

PROPOSED 1No. O/D ELTEK AND 2No. O/D 42U FPF's TO BE INSTALLED ON ROOF PRO PLATFORM

PROPOSED SAFETY HANDRAIL C/W LUMINAIRES TO BE INSTALLED TO EXPOSED EDGES OF MAIN ROOF AREA

TOP OF PROPOSED ANTENNAS +33.30

U/S OF PROPOSED ANTENNAS +31.20

MAIN ROOF LEVEL +30.00m AGL

MIDDLE ROOF LEVEL +23.50m AGL

LOWER ROOF LEVEL +21.00m AGL

G.L.

PROPOSED 5No. RRH's & 2No. DC DB's FIXED TO VERTICAL UNISTRUT. UNISTRUT TO BE FIXED TO HORIZONTAL BEAM WITH BEAM CLAMPS (HIDDEN FROM VIEW)

PROPOSED 1No. SUA-7 ANTENNA TO BE INSTALLED ON PROPOSED CLIMBABLE SUPPORT POLE FIXED INTO EXISTING VERTICAL STEELWORK COLUMN. 1No. C2 COMBINER FIXED TO SUPPORT POLE BEHIND ANTENNA

TOP OF PROPOSED ANTENNAS +33.00m AGL

UPPER ROOF LEVEL +31.80m AGL

U/S OF PROPOSED ANTENNAS +30.90m AGL

110 HIGH HOLBORN

SOUTH ELEVATION - PROPOSED

(1:250)

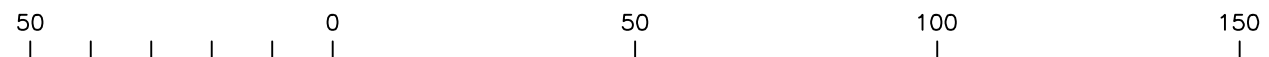

ORIGINAL SCALE AT A3 - 1:1250

ALL DIMENSIONS IN METRES

THESE DRAWINGS COMPLY WITH STANDARD TELEFONICA / VODAFONE ICNIRP DESIGN GUIDELINES

ALL DIMENSIONS ARE IN mm UNLESS NOTED OTHERWISE

N.G.R E: 530566 N: 181574

CONCESSION REQUIRED YES

NOTES:  
STRUCTURAL ANALYSIS OF BUILDING REQUIRED TO CONFIRM INSTALLATION

B	Proposed Antennas Revised	TR	GBC	29.09.20
A	Issued for Construction	LH	UP	15.09.20
REV	MODIFICATION	BY	CH	DATE



Great British Communications  
Lapwing House, Block 3 Forward Point,  
Tan House Lane, Widnes, Cheshire. WAB 0SL  
t. 44 (0)151 420 4128  
www.gbcservices.co.uk



CTIL - LONDON

Cell Name		Opt.
110 HIGH HOLBORN		-
Cell ID No		
CTIL	TEF	VF
E331092	73447	N/A
150763_21		

Site Address / Contact Details

110 HIGH HOLBORN  
HOLBORN  
LONDON  
WC1V 6EU

Drawing Title:  
SITE ELEVATION - PROPOSED (2)

Purpose of issue: CONSTRUCTION Dwg Rev:

Drawing Number: 302 B

Scale: AS SHOWN	Sheet Size: A3	Drawn: MW	Date: 25.10.19	Pack Issue:
Checked: MNH	Date: 25.10.19	Approved: MNH	Date: 25.10.19	B