

1 Communal Bike and Bin Store Section - West
1 : 25

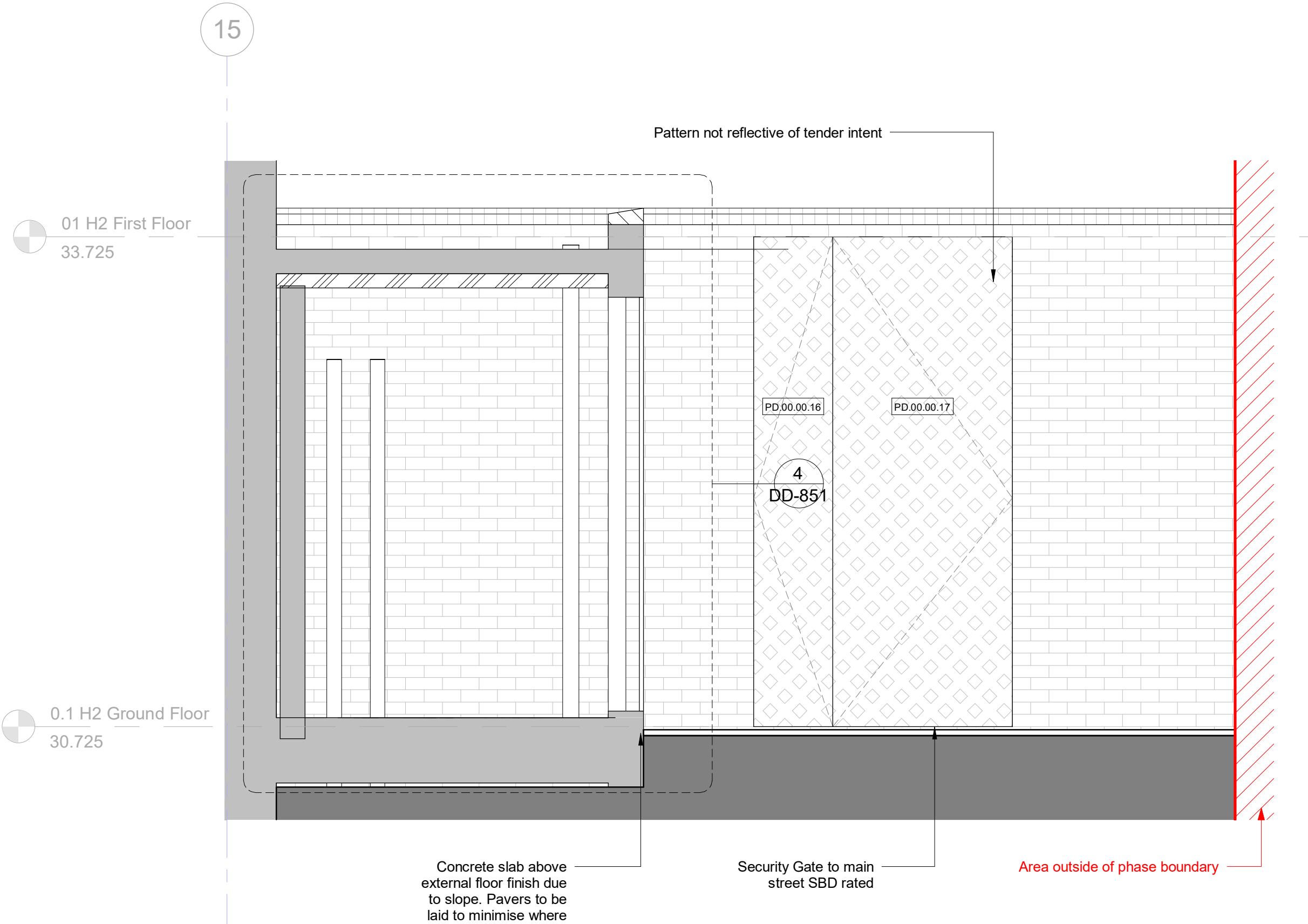

3 Communal Bike Store and Store Section - East
1 : 25

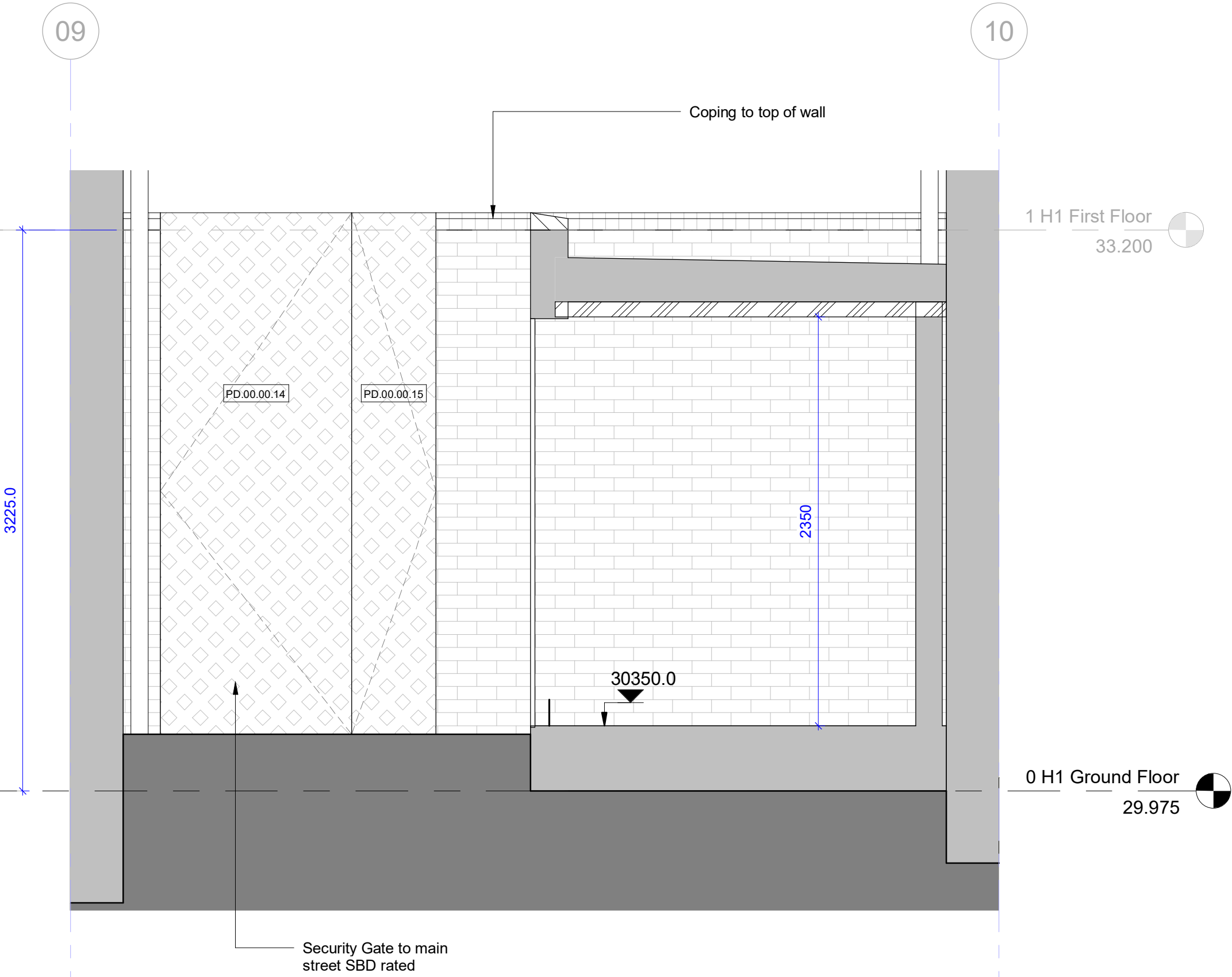

2 Wall Between West and East Block - Elevation
1 : 25

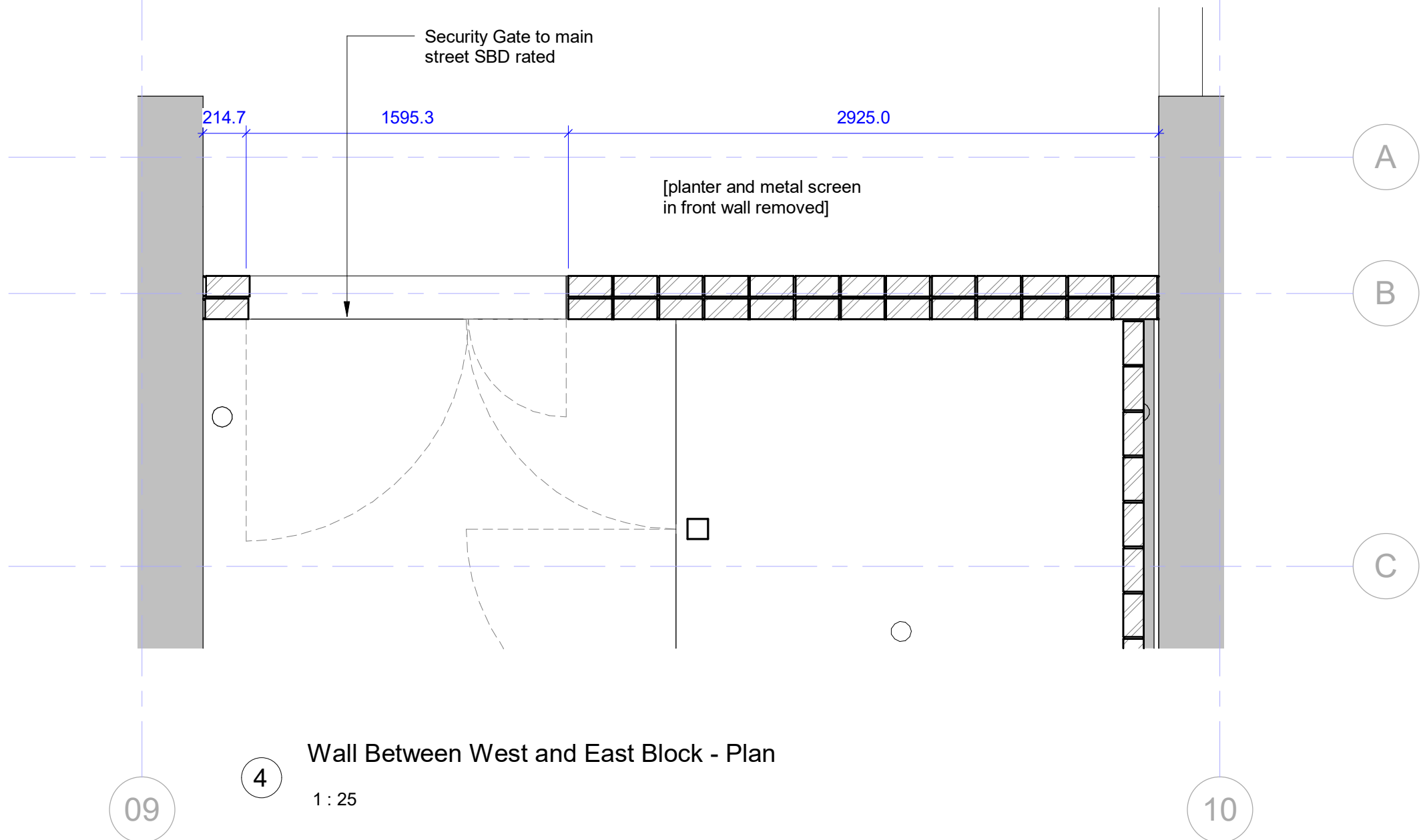

4 Wall Between West and East Block - Plan
1 : 25

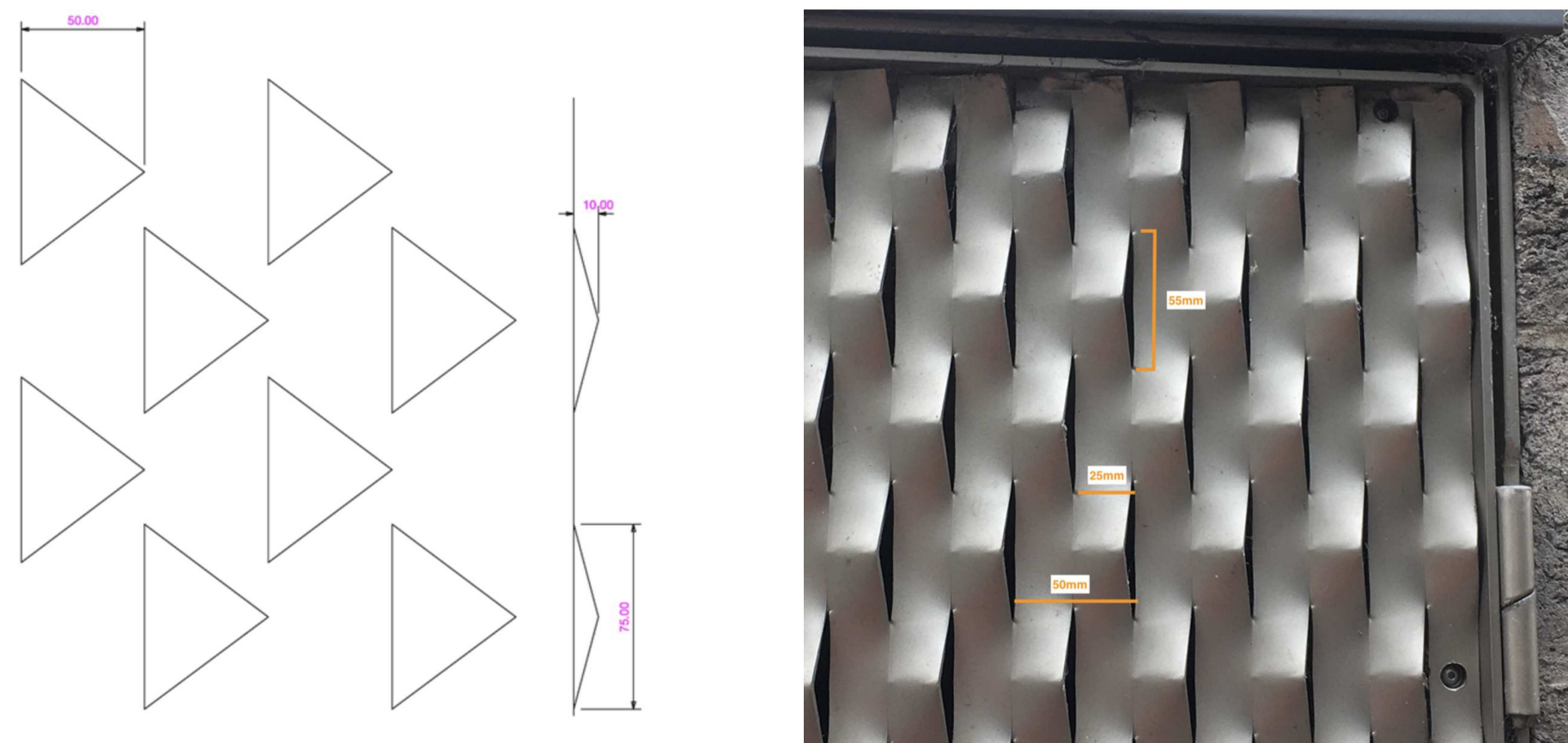

Notes

This drawing is © Architype Ltd.
Check this drawing is the latest revision.
Do not use the information on this drawing without checking all dimensions on site.
Do not use any areas indicated for either valuation, purchase, sale or any other form of legally binding contract.
Do not reproduce any part of this drawing without prior written consent.
Report any discrepancies on this document to Architype.
Read this drawing in conjunction with the associated models, specifications and related consultant's documents.
Equivalent products / materials may be Approved where the Employer's Requirements, Thermal Performance, Airtightness and any other specified performance requirements are met. Subject to Architype "Acceptance".
All materials to be certified to comply with BS 14001/or BES6001 or be able to provide a Chain of Custody certificate in order to comply Code for Sustainable Homes. All timber species and sources used in this development are not to be listed on the CITES appendices for endangered or threatened species
Designers Hazard Identification
It is assumed that all works will be undertaken by a competent contractor working, where appropriate, to an approved method statement. In addition to the hazards typically associated with the types of construction detailed on this drawing, any known abnormal hazards specific to this drawing have been identified.

Communal Bin and Bike Store VE Intent

Bin store doors - variation from fully punched to cut and folded holes.
Note, frame of door to be masked by unperforated border to facing metal sheet.

VE Item 9
Subcontractor to confirm VE solution with HPL

Amend SBD security rated painted purpose made self closing and locking cast iron gates and frames comprising metal panel faced with open pattern panel as Maeit.30/550 to alternative similar gate construction with singular regular perforations

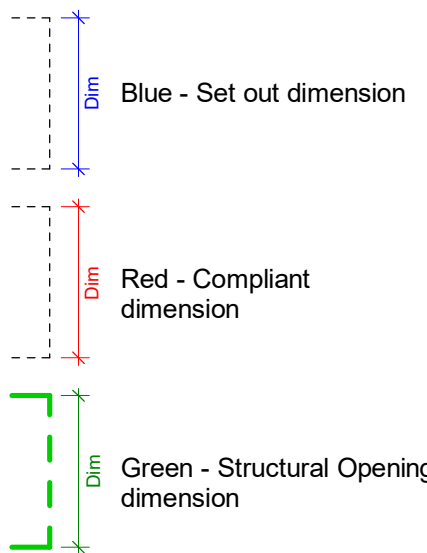

| Rev | Date | Description | Drawn | Checked |
|-----|----------|-------------------------------|-------|---------|
| 2 | 02.10.20 | Bike + Bin Store amends (NMA) | CC | AMF |
| 1 | 15.12.17 | First Construction Issue | CK | AMF |

Revision Schedule

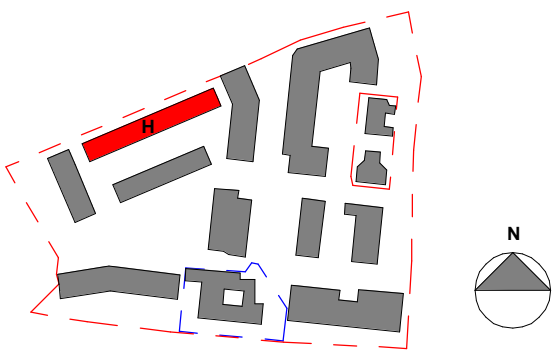

LONDON: 020 7403 2880 WWW.ARCHITYPE.CO.UK HEREFORD: 01981 542 111

Client: Hill Partnership Ltd for Camden Council

Project: Agar Grove Block H

Drawing Title: External Walls and Gates To Main Street

Project: T14011 - ART - DR - A - 1b H 00 - DD-852

Status: A Issued For Construction

Revision: C2 Construction Issue

Scale: As indicated @ A1 Date: 26 Apr 17

Drawn by: LM Checked by: AMF

Internal Project Ref: 8575 Model Ref: AG-RAC2015-A-H