

2 Ground Floor Refuse Storage - West
1 : 50

5,420L total
West store

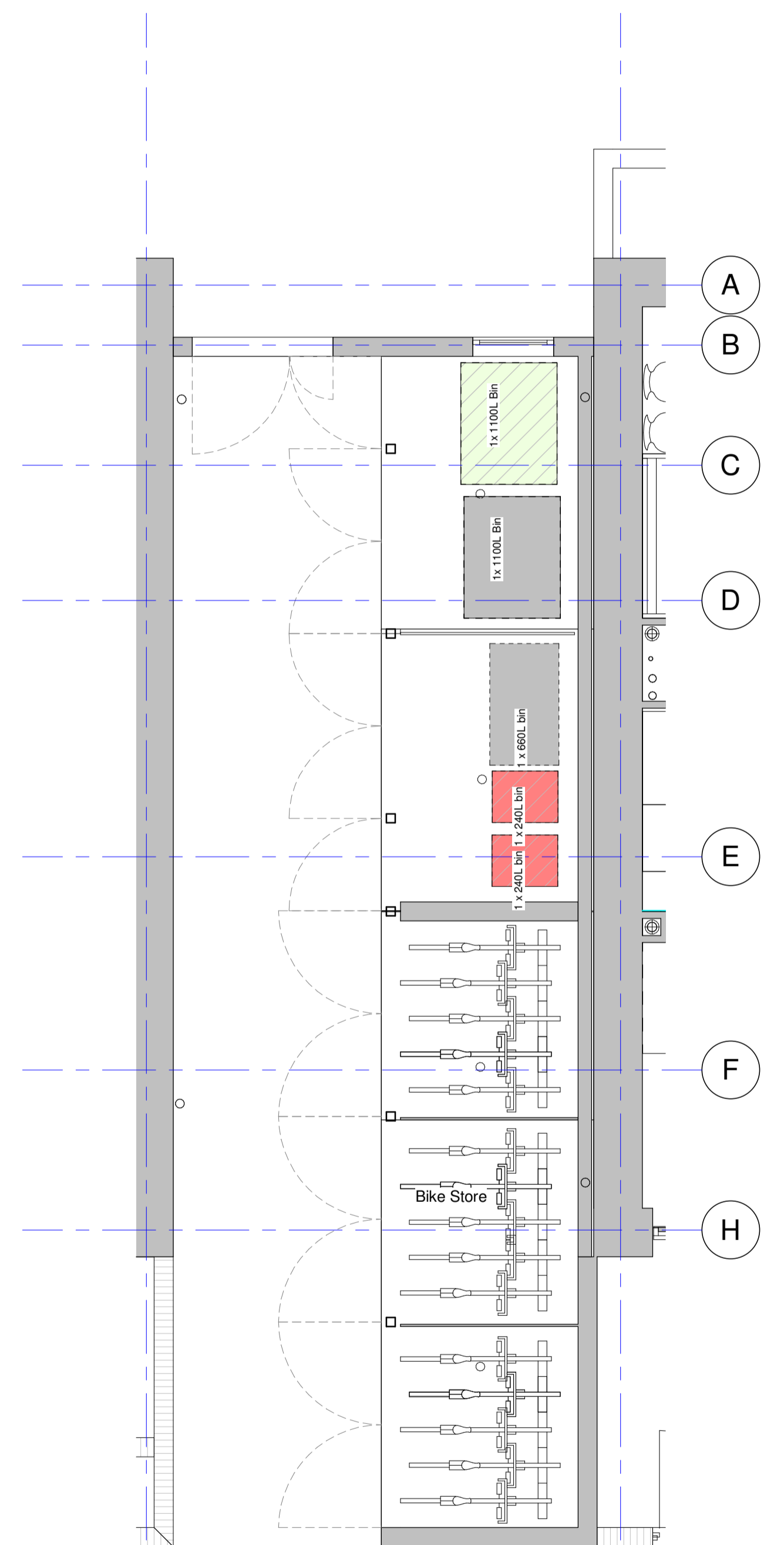

3 Ground Floor Refuse Storage - Central
1 : 50

3,340L total
Central store

GRAND TOTAL 8,760L
(Block H)

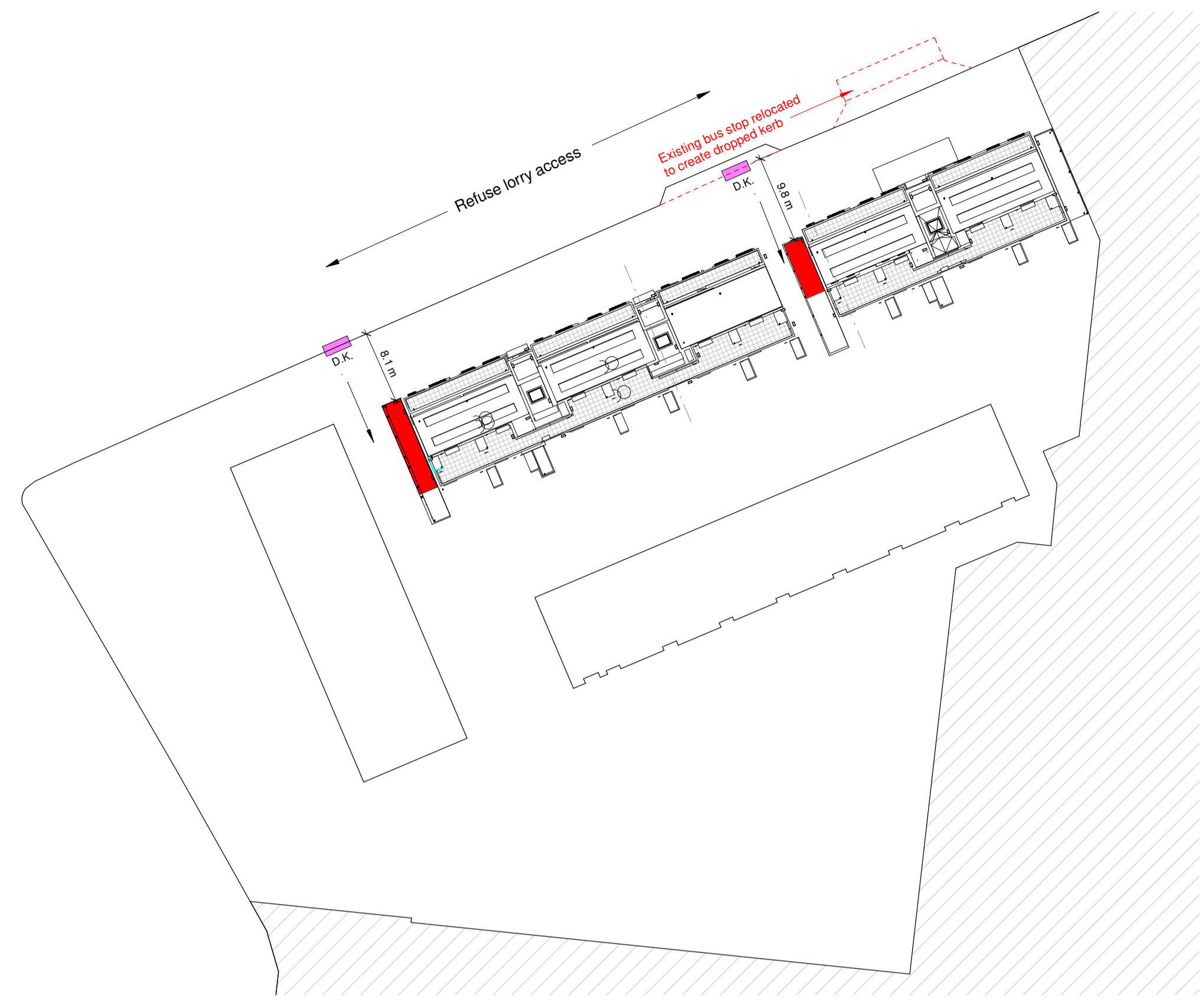

1 GA Site Plan
1 : 500

Refuse storage
New dropped kerb

Notes
 This drawing is © Architype Ltd.
 Check this drawing is the latest revision.
 Do not use the information on this drawing without checking all dimensions on site.
 Do not use any areas indicated for either valuation, purchase, sale or any other form of legally binding contract.
 Do not reproduce any part of this drawing without prior written consent.
 Report any discrepancies on this document to Architype.
 Read this drawing in conjunction with the associated models, specifications and related consultant's documents.
 Equivalent products / materials may be Approved where the Employer's Requirements, Thermal Performance, Airtightness and any other specified performance requirements are met. Subject to Architype "Acceptance".
 All materials to be certified to comply with BS 14001 or BES6001 or be able to provide a Chain of Custody certificate in order to comply Code for Sustainable Homes. All timber species and sources used in this development are not to be listed on the CITES appendices for endangered or threatened species (appendix I, II or III)

- Bin store to comply with BS 5906:2005
- Roof FR60
 - Height min 2m
 - Ventilation of roof less than 0.2m2
 - + others design requirements as per BS standards

Rev	Date	Description	Drawn	Checked
3	02.10.20	Bike + Bin Store amends (NMA)	CC	AMF
2	24.03.18	Second Construction Issue	CRMF	AMF
1	15.02.18	First Construction Issue	MF	AMF

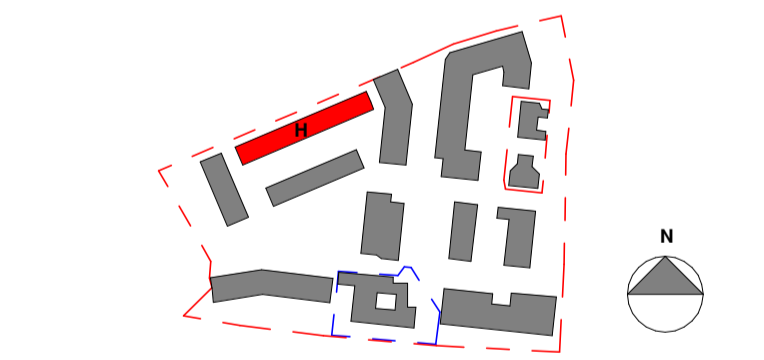

Client: Hill Partnership Ltd for Camden Council
 Project: Agar Grove Block H
 Drawing Title: Refuse Strategy

Project	Originator	Type	Role	Phase	Block	Unit	Unique ID
T14011	ART	-	A	-	1b	H	GA-062

Status: Code Suitability Description
 A Issue for C
 Revision: Code Revision Description
 C3 Construction Issue

Scale: As indicated @ A1 Date: 02/09/18
 Drawn by: MF Checked by: AMF
 Internal Project Ref: 8575 Model Ref: AG-RAC2015-A-G