

4004 HSLI CHAPEL EXTERIOR

Luminaire Datasheets

R4 FINAL 200828

4004\_LD\_v2

MANUFACTURER: GREAT BRITISH LIGHTING  
LUMINAIRE: WINDSOR LANTERN  
FINISH: BLACK





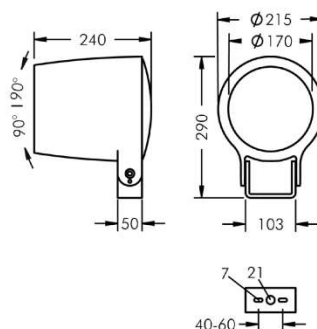

### Monospot 4

8 904 046 148

70 W, 5760 lm, 3000 K warm white, DALI,  
medium wide beam 36°

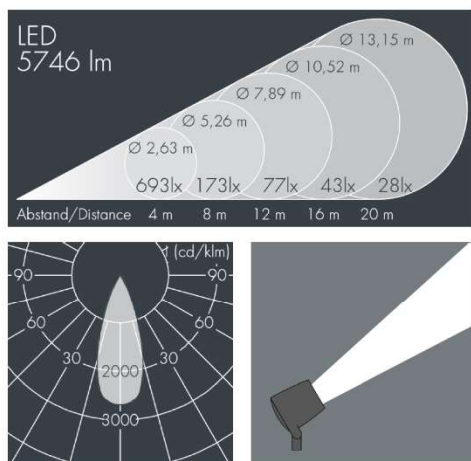

Customized solutions and modifications are possible: Special RAL, DB or NCS colours as polyester powder coat, luminaires in 2700 K and other colour temperatures and versions for high ambient temperature.

### Specification text

housing made of corrosion-resistant die-cast aluminum AlSi12, polyester powder coated by high-quality and UV-stabilized coating process, Colour: black RAL 7021, all exterior parts are stainless steel, tempered safety glass, anti-reflective coating from 1 side, dark screenprint, silicon gasket, closure with 3 stainless steel screws, bracket: 2 long holes Ø 7 mm, spacing 40-60 mm, 1 centre hole Ø 21 mm, tilt range: 180°, cable gland: M20, connecting terminal: 5 pole, highly efficient faceted rotationally symmetrical reflector, integral, dimmable driver (DALI), CRI > 80, max 2 SDCM, service life L90/B10 > 50.000 h, Beam angle (FWHM): 36°, luminous flux: 5760 lm, wattage: 70 W, delivered lumens 83 lm/W, protection type IP67, protection class I, impact resistance IK08, windage area 0,075 m², weight 4.8 kg

The modular luminaire design makes the replacement of components possible. The product meets the demands of the applicable EU guidelines and product safety regulations and bears the CE and ENEC marks.



### Specification

Wattage	70 W	Beam angle (FWHM)	36°
Delivered lumens	83 lm/W	Housing colour	black RAL 7021
Light source	LED 3000 K	Power supply cable	Ø 6 – 11 mm
Color Rendering Index	CRI > 80	Protection type	IP67
Colour tolerance	max 2 SDCM	Protection class	I
Lifetime to 25° C	L90/B10 > 50.000 h	Impact resistance	IK08
Control gear	DALI	Windage area	0,075m²
Input voltage AC	220 – 240 V	Weight	4,80 kg
Input voltage DC	195 – 255 V	Max. ambient temperature ta	35°
Voltage protection	2 kV L/N   4 kV L/PE	Energy efficiency class	A++, A+, A
Luminaires per B16A / C16A	10 / 16		

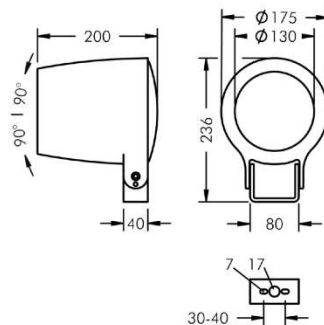

### Monospot 3

8 903 046 178

36 W, 2603 lm, 3000 K warm white, DALI, linear, rotatable 36° / 9°

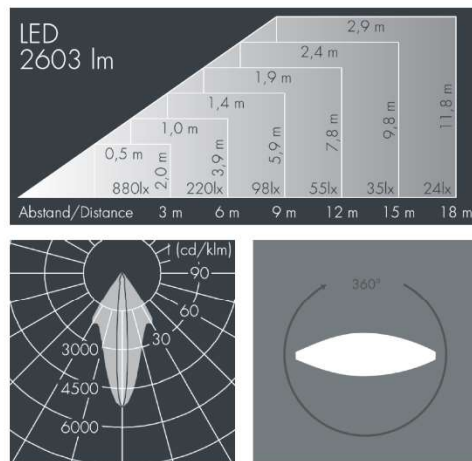

Customized solutions and modifications are possible: Special RAL, DB or NCS colours as polyester powder coat, luminaires in 2700 K and other colour temperatures and versions for high ambient temperature.

### Specification text

housing made of corrosion-resistant die-cast aluminum AlSi12, polyester powder coated by high-quality and UV-stabilized coating process, Colour: black RAL 7021, all exterior parts are stainless steel, tempered safety glass, anti-reflective coating from 1 side, silicon gasket, closure with 3 stainless steel screws, bracket: 2 long holes Ø 7 mm, spacing 30-40 mm, 1 centre hole Ø 17 mm, tilt range: 180°, cable gland: M20, connecting terminal: 5 pole, highly efficient faceted rotationally symmetrical reflector, integral, dimmable driver (DALI), CRI > 80, max 2 SDCM, service life L90/B10 > 50.000 h, Beam angle (FWHM): 36° / 9°, luminous flux: 2603 lm, wattage: 36 W, delivered lumens 72 lm/W, protection type IP67, protection class I, impact resistance IK08, windage area 0,049 m², dimensions: Ø 175 mm, width 200 mm, weight 3,2 kg

The modular luminaire design makes the replacement of components possible. The product meets the demands of the applicable EU guidelines and product safety regulations and bears the CE and ENEC marks.



### Specification

Wattage	36 W	Beam angle (FWHM)	36° / 9°
Delivered lumens	72 lm/W	Housing colour	black RAL 7021
Light source	LED 3000 K	Power supply cable	Ø 6 – 11 mm
Color Rendering Index	CRI > 80	Protection type	IP67
Colour tolerance	max 2 SDCM	Protection class	I
Lifetime ta 25° C	L90/B10 > 50.000 h	Impact resistance	IK08
Control gear	DALI	Windage area	0,049m²
Input voltage AC	110 – 240 V	Dimensions	Ø 175 mm, width 200 mm
Input voltage DC	190 – 250 V	Weight	3,20 kg
Voltage protection	4 kV L/N   5 kV L/PE	Max. ambient temperature ta	35°
Luminaires per B16A / C16A	30 / 51	Energy efficiency class	A++, A+, A

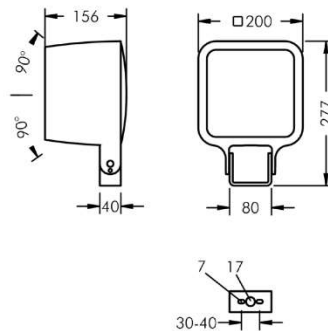

### Monofood 3

8 203 046 118

9 × 5,9 W, 3586 lm, 3000 K warm white, DALI, narrow beam 5°

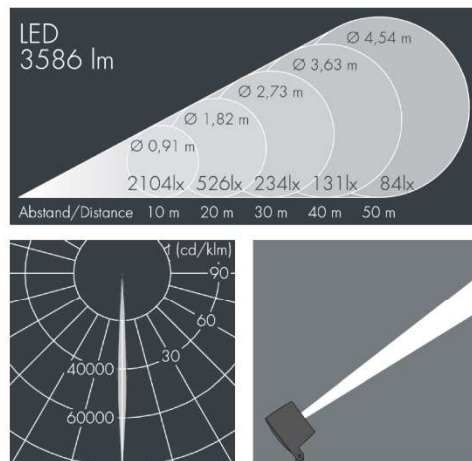

Customized solutions and modifications are possible: Special RAL, DB or NCS colours as polyester powder coat, luminaires in 2700 K and other colour temperatures and versions for high ambient temperature.

### Specification text

housing made of corrosion-resistant die-cast aluminum AlSi12, polyester powder coated by high-quality and UV-stabilized coating process, Colour: black RAL 7021, all exterior parts are stainless steel, tempered safety glass, anti-reflective coating from 1 side, dark screenprint, silicon gasket, closure with 4 stainless steel screws, mounting bracket: 2 drilled holes Ø 7 mm, spacing 30 - 40 mm, 1 centre hole Ø 17 mm, tilt range: 180°, cable gland: M20, connecting terminal: 5 pole, precise PMMA optics, integral driver (DALI), CRI > 80, max 2 SDCM, service life L90/B10 > 50.000 h, Beam angle (FWHM): 5°, luminous flux: 3586 lm, wattage: 53 W, delivered lumens 68 lm/W, protection type IP65, protection class I, impact resistance IK08, windage area 0,032 m², dimensions (L×H×W): 200 × 156 × 200 mm, weight 4.5 kg

The modular luminaire design makes the replacement of components possible. The product meets the demands of the applicable EU guidelines and product safety regulations and bears the CE mark.



IP65 IK08

### Specification

Wattage	53 W	Beam angle (FWHM)	5°
Delivered lumens	68 lm/W	Housing colour	black RAL 7021
Light source	LED 3000 K	Power supply cable	Ø 6 – 11 mm
Color Rendering Index	CRI > 80	Protection type	IP65
Colour tolerance	max 2 SDCM	Protection class	I
Lifetime to 25° C	L90/B10 > 50.000 h	Impact resistance	IK08
Control gear	DALI	Windage area	0,032 m²
Input voltage AC	220 – 240 V	Dimensions	200 × 156 × 200 mm
Input voltage DC	220 – 240 V	Weight	4,50 kg
Voltage protection	2 kV L/N   4 kV L/PE	Max. ambient temperature to	35°
Luminaires per B16A / C16A	10 / 16	Energy efficiency class	A++, A+, A



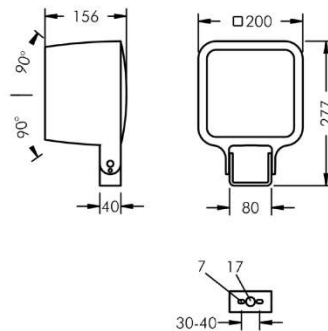

### Monofood 3

8 203 046 198

53 W, 4792 lm, 3000 K warm white, DALI, asymmetrical beam 56°

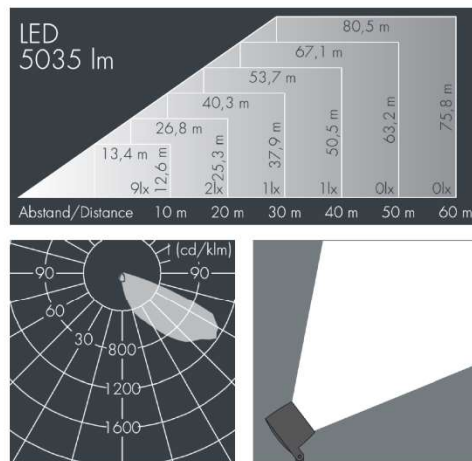

Customized solutions and modifications are possible: Special RAL, DB or NCS colours as polyester powder coat, luminaires in 2700 K and other colour temperatures and versions for high ambient temperature.

### Specification text

housing made of corrosion-resistant die-cast aluminum AlSi12, polyester powder coated by high-quality and UV-stabilized coating process, Colour: black RAL 7021, all exterior parts are stainless steel, tempered safety glass, anti-reflective coating from 1 side, dark screenprint, silicon gasket, closure with 4 stainless steel screws, mounting bracket: 2 drilled holes Ø 7 mm, spacing 30 - 40 mm, 1 centre hole Ø 17 mm, tilt range: 180°, cable gland: M20, connecting terminal: 5 pole, highly efficient aluminum reflector, integral driver (DALI), CRI > 80, 2 SCDM, service life L90/B10 > 50.000 h, Main beam angle: 56°, luminous flux: 4792 lm, wattage: 53 W, delivered lumens 90 lm/W, protection type IP65, protection class I, impact resistance IK08, windage area 0,032 m², dimensions (L×H×W): 200 × 156 × 200 mm, weight 4.2 kg

The modular luminaire design makes the replacement of components possible. The product meets the demands of the applicable EU guidelines and product safety regulations and bears the CE mark.



IP65 IK08

### Specification

Wattage	53 W	Main beam angle	56°
Delivered lumens	90 lm/W	Housing colour	black RAL 7021
Light source	LED 3000 K	Power supply cable	Ø 6 – 11 mm
Color Rendering Index	CRI > 80	Protection type	IP65
Colour tolerance	2 SCDM	Protection class	I
Lifetime ta 25° C	L90/B10 > 50.000 h	Impact resistance	IK08
Control gear	DALI	Windage area	0,032 m²
Input voltage AC	220 – 240 V	Dimensions	200 × 156 × 200 mm
Input voltage DC	220 – 240 V	Weight	4,20 kg
Voltage protection	3 kV L/N   4 kV L/PE	Max. ambient temperature ta	30°
Luminaires per B16A / C16A	30 / 51	Energy efficiency class	A++, A+, A

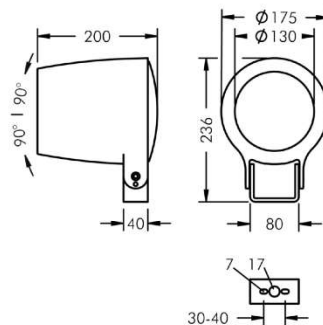

### Monospot 3

8 903 046 148

36 W, 3283 lm, 3000 K warm white, DALI, medium wide beam 30°

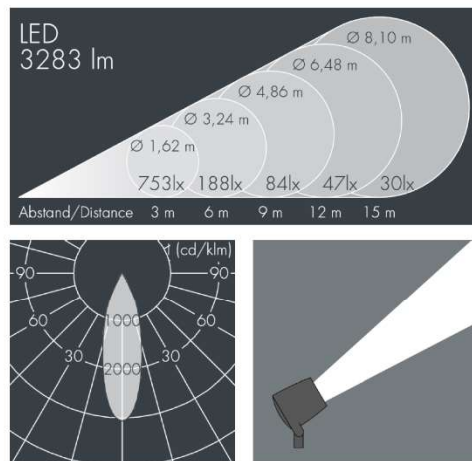

Customized solutions and modifications are possible: Special RAL, DB or NCS colours as polyester powder coat, luminaires in 2700 K and other colour temperatures and versions for high ambient temperature.

### Specification text

housing made of corrosion-resistant die-cast aluminum AlSi12, polyester powder coated by high-quality and UV-stabilized coating process, Colour: black RAL 7021, all exterior parts are stainless steel, tempered safety glass, anti-reflective coating from 1 side, dark screenprint, silicon gasket, closure with 3 stainless steel screws, bracket: 2 long holes Ø 7 mm, spacing 30-40 mm, 1 centre hole Ø 17 mm, tilt range: 180°, cable gland: M20, connecting terminal: 5 pole, highly efficient faceted rotationally symmetrical reflector, integral, dimmable driver (DALI), CRI > 80, max 2 SDCM, service life L90/B10 > 50.000 h, Beam angle (FWHM): 30°, luminous flux: 3283 lm, wattage: 36 W, delivered lumens 91 lm/W, protection type IP67, protection class I, impact resistance IK08, windage area 0,049 m², dimensions: Ø 175 mm, width 200 mm, weight 3 kg

The modular luminaire design makes the replacement of components possible. The product meets the demands of the applicable EU guidelines and product safety regulations and bears the CE and ENEC marks.



### Specification

Wattage	36 W	Beam angle (FWHM)	30°
Delivered lumens	91 lm/W	Housing colour	black RAL 7021
Light source	LED 3000 K	Power supply cable	Ø 6 – 11 mm
Color Rendering Index	CRI > 80	Protection type	IP67
Colour tolerance	max 2 SDCM	Protection class	I
Lifetime ta 25° C	L90/B10 > 50.000 h	Impact resistance	IK08
Control gear	DALI	Windage area	0,049m²
Input voltage AC	110 – 240 V	Dimensions	Ø 175 mm, width 200 mm
Input voltage DC	190 – 250 V	Weight	3,00 kg
Voltage protection	4 kV L/N   5 kV L/PE	Max. ambient temperature ta	35°
Luminaires per B16A / C16A	30 / 51	Energy efficiency class	A++, A+, A



100176119

Product Sheet

**ares**  
 THE OUTDOOR BY FLOS

 ARES s.r.l - Socio Unico  
 v.le dell'Artigianato n.24 - 20881 Bernareggio - MB (Italy)  
 www.aresill.net - flos.outdoor@flos.com

## Tapioca

Square or round luminaire - for installation in wall, ceiling or ground - recessed.  
 Configuration: die-cast aluminium structure, EN AB-47100 alloy (low copper content).  
 Anodized aluminium frame - only round. Glass diffuser: transparent or sandblasted, fixed to the aluminium body through a robotic gluing system. Double layer coating for high resistance to corrosion: the aluminium components are painted with a double coat using powders which are compliant with QUALICOAT standards: a first layer of epoxy powder (with excellent chemical and mechanical resistance) and a second finishing layer of polyester powder (resistant to UV rays and atmospheric agents). The entire painting process of the aluminium fitting starts from components which have been sandblasted in advance to make the surface more porous and increase the adherence of the paint. Ares effects alkaline and acid washing to clean the surfaces completely, then rinses with demineralised water to remove any residue particles, subsequently a chemical conversion treatment is done to protect against rusting. Protection rating: IP67 In compliance with EN 60598-1 standards Class of insulation: III Installation: the luminaire is equipped with a piece of cable for an easy-to-make connection and an H2O STOP device. Tapioca 24V is equipped with a dc/dc highly efficient resin-coated converter that removes electromagnetic interference and allows parallel wiring. The luminaire is protected against polarity reversal and sudden voltage peak. Installation requires a dedicated box to be ordered separately. It is important to provide a >200mm gravel layer or a drain system (for concrete surface) to ensure good drainage and to avoid water stagnation. We recommend the use of a connection system with a protection degree greater than or equal to the protection degree of the luminaire

Tapioca Power LED / Ø 55mm - Anodized Aluminium Frame - Transparent Glass - Narrow Beam 10°

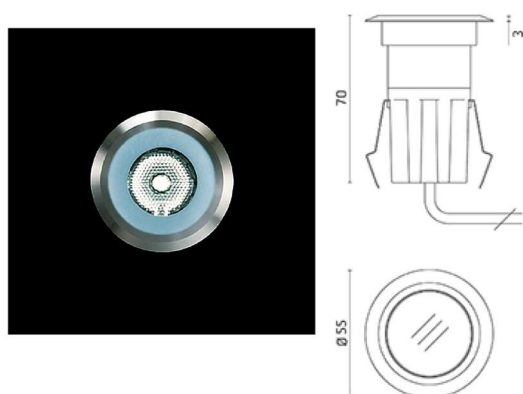

### Product Code Details

100176119

Light Source



WARM WHITE 3000K POWER LED 1,6W/12÷24Vdc  
 Total power 2,3W  
 LED lm 180 ÷ OUTPUT lm 127  
 CRI >80  
 Remote electronic power supply to be ordered



IP67

### Available Colors for this Version



8. anodized aluminium

### Warnings

#### Ground Recessed



Recessed ground fitting



Installation requires a 20 cm water drainage layer (gravel)

 Static load: 500Kg walk over (version without frame)  
 Static load: 2000Kg walk over (version with frame)

Pre-wired with approx 200mm of cable



Glass surface temperature



Do not install in hollow areas



Protection against water ingress from the cable. (not for RGB versions)

 Protection against impact.  
 IK 08 - 5,00 joule  
 IK 06 - 1,00 joule\*  
 \*(only version Ø 55 mm)

Remote device required

#### Wall Recessed



Protection against water ingress from the cable. (not for RGB versions)



Recessed wall fitting



Remote device required

 Protection against impact.  
 IK 08 - 5,00 joule  
 IK 06 - 1,00 joule\*  
 \*(only version Ø 55 mm)

Pre-wired with approx 200mm of cable

#### Ceiling Recessed



Protection against water ingress from the cable. (not for RGB versions)



Installation in concrete ceiling: box for installation required.



Remote device required

 Protection against impact.  
 IK 08 - 5,00 joule  
 IK 06 - 1,00 joule\*  
 \*(only version Ø 55 mm)

Pre-wired with approx 200mm of cable

### Light Flux, Placement



## Accessories

---



Code: 98  
Box for installation  
Ø 75 H 90 mm



Code: 150  
Supported n. of lamps: 1  
Power supply dual function  
Vout 24Vdc: 8W/100÷240V  
Iout 350mA: 6X1W/100÷240V  
IP20 CLASS II SELV EQ.



Code: 106  
Supported n. of lamps: 1  
Power supply dual function  
Vout 24Vdc: 8W/100÷240V  
Iout 350mA: 6X1W/100÷240V - IP65 CLASS II SELV EQ.



Code: 87  
Supported n. of lamps: 4  
Power supply  
10W/110÷240V - 24Vdc  
IP20 CLASS II SELV.



Code: 175  
Supported n. of lamps: 4  
Power supply  
10W/110÷240V - 24Vdc  
IP67 CLASS II SELV.



Code: 147  
Supported n. of lamps: 5  
Power supply  
20W/220÷240V - 24Vdc  
IP67 CLASS II SELV.



Code: 155  
Supported n. of lamps: 14  
Power supply  
50W/120÷240V - 24Vdc  
IP67 CLASS II SELV.



Code: 110  
Supported n. of lamps: 29  
Power supply  
70W/220÷240V - 24Vdc  
IP67 CLASS II SELV EQ.