

2. Planning - LEVEL 04 - Proposed Ceiling Types
1 : 100

CEILINGS LEGEND

- Extent of repairs to existing cornice
- Omit Cornice due to layout change
- Extent of repair to ceiling
- Cornice where applicable:
- Existing Cornice (types vary)

- Existing ceiling rose / ceiling decoration to be retained and restored where necessary
- Proposed Feature Lighting based on Thorlux Hi-Bar (TBC with Engineer) - for other lighting layouts refer to engineer's drawing

Proposed ceilings type:

- Existing / Repaired Lathe and Plaster Ceiling
- Existing Acoustic Ceiling
- Existing Ceiling - Unknown Finish
- Existing Exposed Soffit
- Existing Fabric Ceiling
- n/a
- Out of Scope
- Proposed Acoustic Ceiling
- Proposed Exposed Painted Soffit
- Proposed Exposed Painted Soffit with Rafts
- Proposed Moisture Resistant Plasterboard Ceiling
- Proposed Plasterboard
- Proposed Plasterboard / Repair Original (TBC)
- Proposed Plasterboard with Rafts

- Note:**
- Drawing to be read in conjunction with 15 series demolition RCPs
 - Where repairs are noted this is a high level review of each room using the AHR TrueView model, further interrogations will be needed to be made relating to the removal of minor elements such as conduits, wiring, lighting etc as repairs will be required in these locations also.
 - Existing / Repaired Lathe and Plaster Ceiling - where applicable cornice to be repaired as shown and where necessary paint stripped back to cornice and repaired as noted in the specification
 - Exposed original stair soffits to be repaired as necessary. For proposed stair soffit information refer to 24 series.

Relevant SKA Requirements (refer to NBS and Gordon Square (4620) SKA assessment (Design Stage) report:
D20 - responsibly sourced timber
D22 - low GWP insulation
D29 - acoustic design in accordance with BB93 etc.
M04 - insulation
M10 - ceiling materials

Extent of area of acoustic absorption - refer to acoustician's report - raft areas to to be added to applicable areas and coordinated with lighting

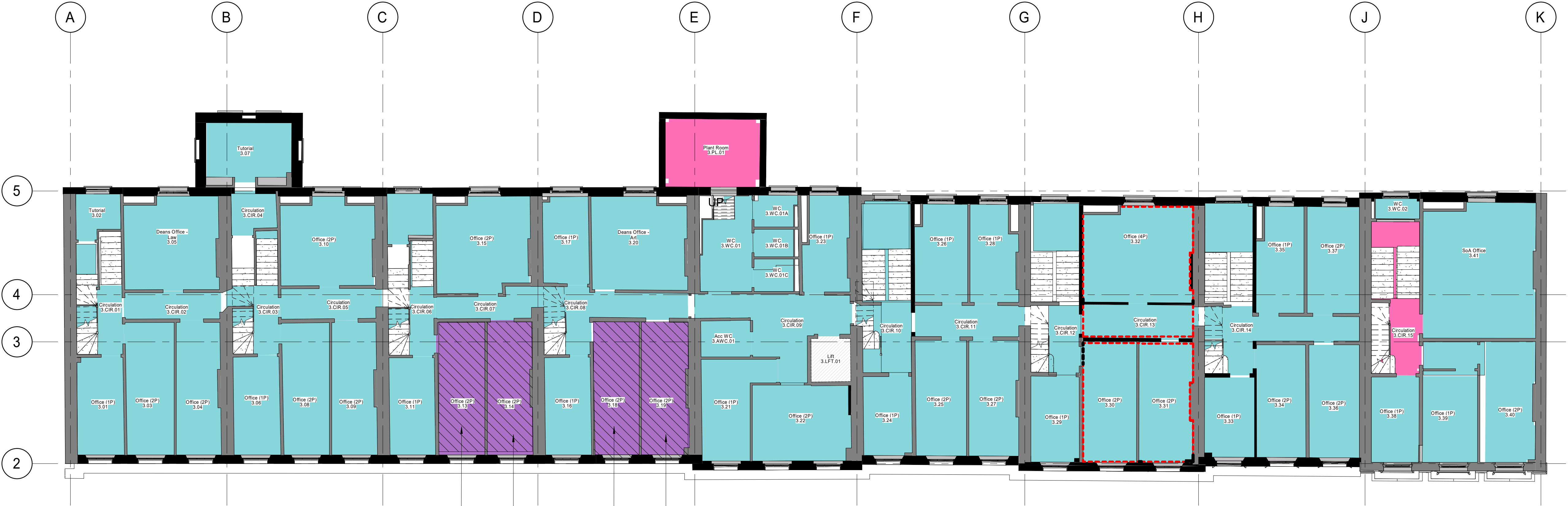

1. Planning - LEVEL 03 - Proposed Ceiling Types
1 : 100

P02	(P1) Planning Submission	22.09.2020	AM	GO
P01	(S3) Pre planning application issue for client sign approvalPre planning application issue for client sign approval	21.07.2020	AM	HT
Rev	Description	Date	Dr by	App by
original by		date created		approved by
HB		07/16/20		HB

AHR
AHR Architects Ltd
Vintny Building
Wine Street
Bristol
BS1 2BD
United Kingdom

T +44(0)117 9299146
E bristol@ahr.co.uk
www.ahr.co.uk

client name	Birkbeck University of London		
project	Gordon Square, London		
drawing	Planning - Level 03 & 04 - Reflected Ceiling Plan		
computer file	C:\Revit Projects\BRK-AHR-GS-ZZ-DR-A-Central_ame.mcd	plot date	
project number	2019.00916.000	scale	1 : 100 @A1
drawing number	BRK-AHR-GS-ZZ-DR-A-35-052	rev	P02
		issue status	P1
This drawing is to be read in conjunction with all related drawings. All dimensions must be checked and verified on site before commencing any work or producing shop drawings. The originator should be notified immediately of any discrepancy. This drawing is copyright and remains the property of AHR.			