

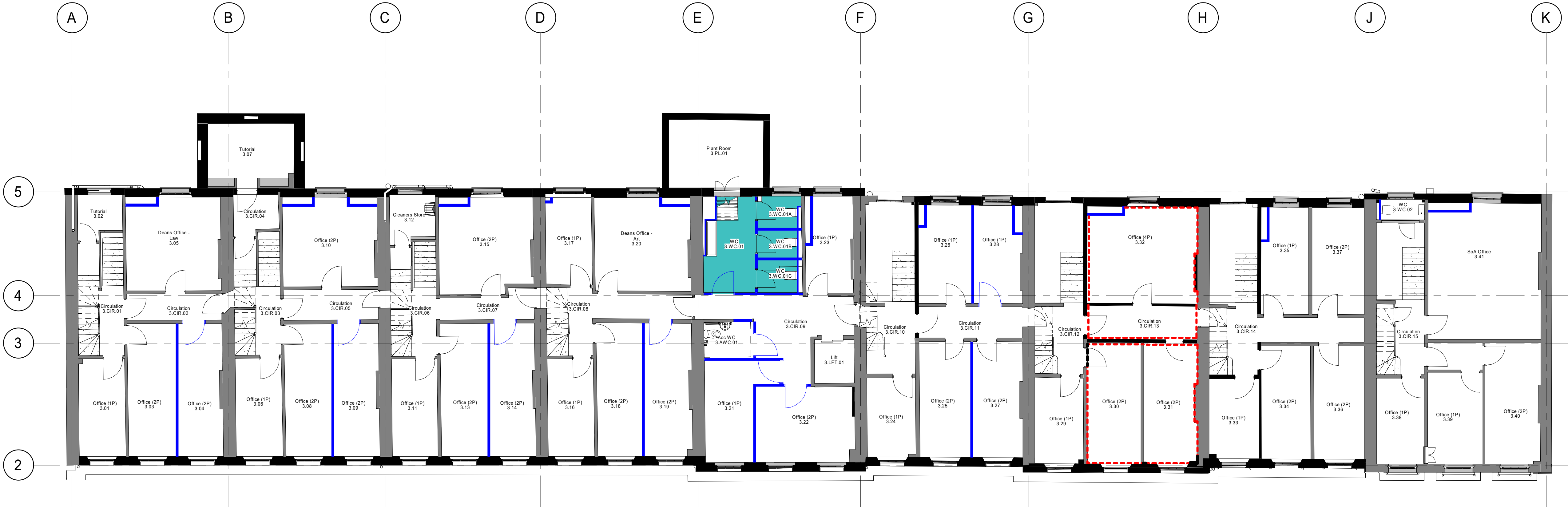

- KEY:**
- Existing fabric
  - Proposed elements
  - Roof replaced - existing roof is in disrepair, to be remove and replaced with English slate tiles
  - Asphalt roof removed & replaced with green roof
  - Paving relaid where unsecure and replaced where damaged or missing
  - Balconies repaired and resurfaced
  - Lightwells cleaned and decorated. Planting to the walls to create greater wellbeing benefits for the occupants of the basement rooms
  - Modern stair removed & new floor installed in same place as original
  - Original plan form restored
  - Out of Scope
  - Existing external metal railings:  
To be stripped to bare metal, treated, repaired and redecorated.
  - Existing corning  
Existing corning to be stripped of excessive paint to reveal detail and redecorated.
  - New corning  
New corning to be formed where existing has either been damaged or has been removed or is missing. Corning to match that of the room in which it is situated.
- NOTE:**
- Proposals to the building that take place in all places and provide heritage benefits, that are not shown on this drawing, include the following:
- All floor finishes removed and replaced with new flooring
  - All modern light fittings removed and replaced with light fittings that are inkeeping with the heritage asset and compliment the existing features including corning and ceiling roses
  - Existing Mechanical and Electrical equipment which visually detracts from the heritage asset are proposed to be removed. A new distribution route is proposed with routes and access locations designed with the heritage asset as a priority.
  - Existing sash windows repaired
  - Front facade brickwork cleaned - refer to external work drawings for further details.

## 2. Planning - LEVEL 04 - Proposed Heritage Impact

1 : 100



P02	(P1) Planning Submission	22.09.2020	AM	GO
P01	(S3) Pre planning application issue for client sign approval	21.07.2020	AM	HT
Rev	Description	Date	Dr by	App by
AM		06/25/20	GO	

**AHR** AHR Architects Ltd  
Vintory Building  
Wine Street  
Bristol  
BS1 2BD  
United Kingdom

T +44(0)117 9299146  
E bristol@ahr.co.uk  
www.ahr.co.uk

client name  
**Birkbeck University of London**

project  
**Gordon Square, London**

drawing  
**Planning - Level 03 & 04 - Proposed Heritage Impact Plan**

computer file  
C:\Revit Projects\BRK-AHR-GS-XX-M3-A-Central\_ame.mccabes.rvt

plot date

project number  
**2019.00916.000**

scale  
**1 : 100 @A1**

drawing number  
**BRK-AHR-GS-ZZ-DR-A-10-054**

rev  
**P02**

issue status  
**P1**

This drawing is to be read in conjunction with all related drawings. All dimensions must be checked and verified on site before commencing any work or producing shop drawings. The originator should be notified immediately of any discrepancy. This drawing is copyright and remains the property of AHR.

## 1. Planning - LEVEL 03 - Proposed Heritage Impact

1 : 100