

VERTICAL SECTION E-E

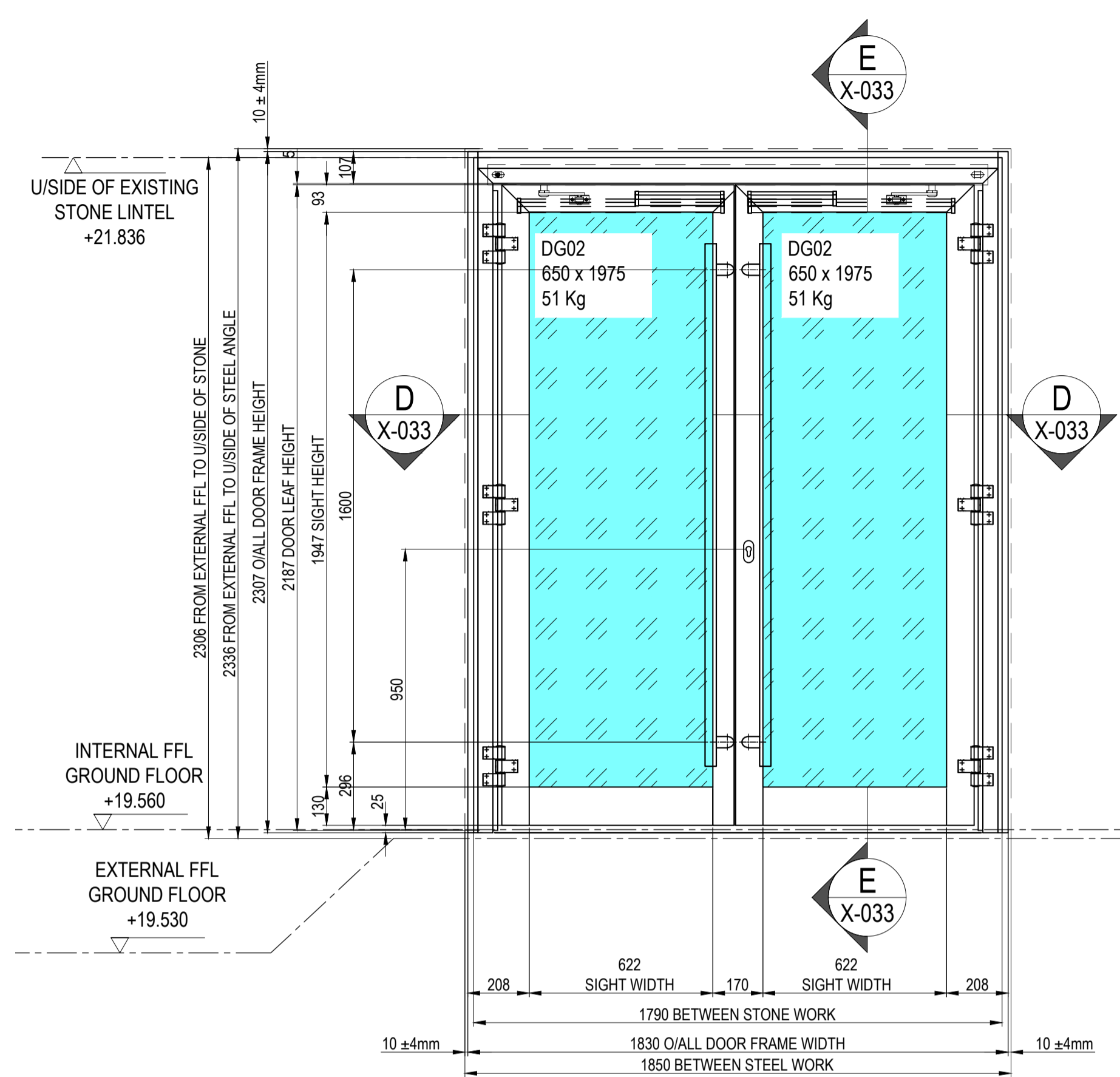

ELEVATION -DG-EX-09
VIEW FROM OUT SIDE

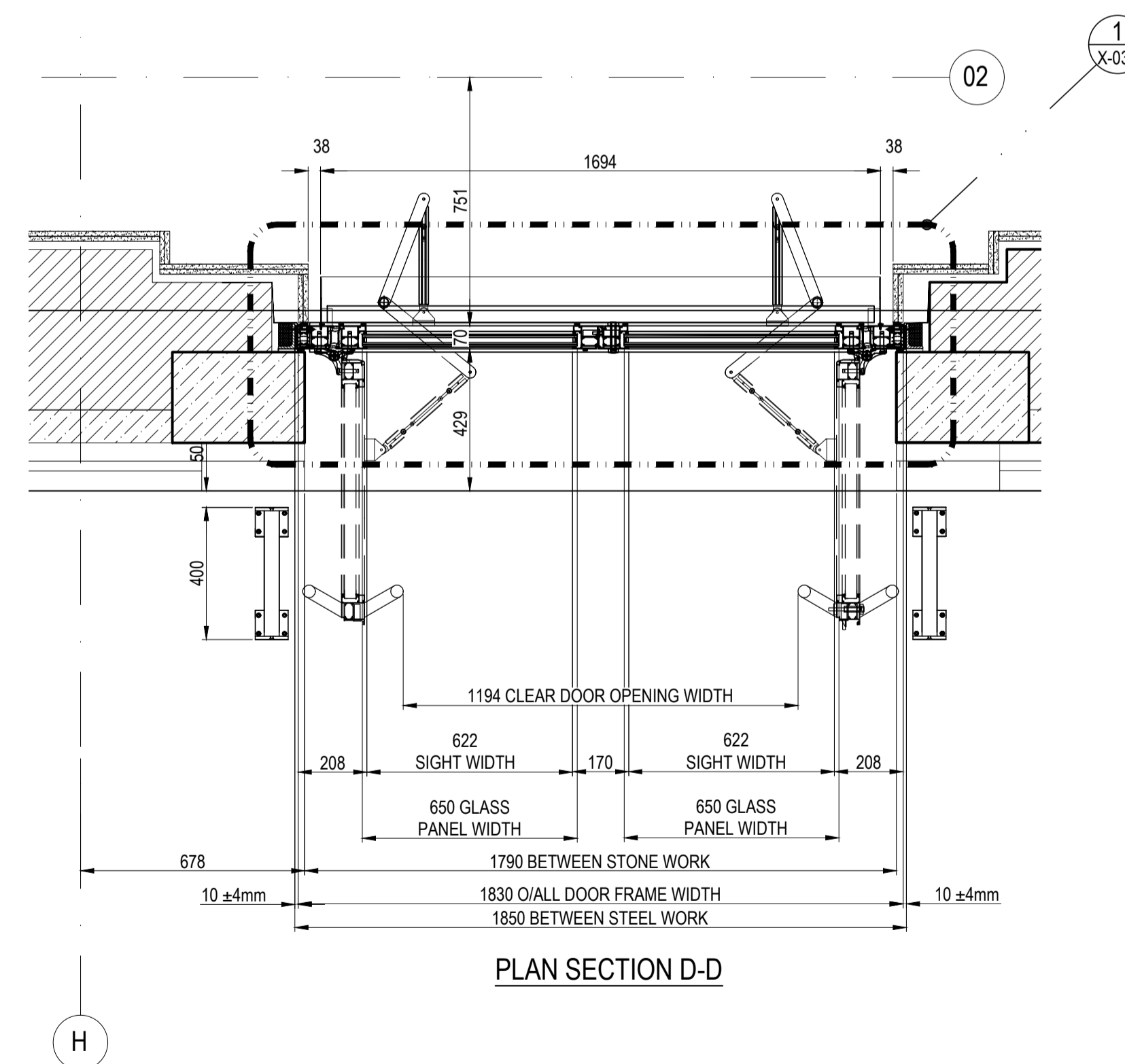

PLAN SECTION D-D

SPECIFICATION

DOOR SYSTEM

DOOR SYSTEM - ALUPROF MB-70 CASEMENT STANDARD ALUMINIUM DOORS SYSTEM IN ACCORDANCE WITH ALUPROF TEST DATA & SPECIFICATIONS TO CURRENT BS & EN STANDARDS.

IRONMONGERY -

- 1924231G ALUPROF - LINE rosette Stainless Steel
- 80004316 Cylinder inset 3550 mm
- 80009401 FUHR - 3-point latch and hook lock U24x6x1790 mm
- 80009414 FUHR - One-piece striker U24x5, right
- 80009431 FUHR - Roll latch
- 80009434 FUHR - Slave leaf shootbolt
- 80009436 FUHR - Round rod
- 80009437 FUHR - Striker with guide
- 80009438 FUHR - Rod latch, top
- 80009895 WALA - Floor keep
- 80105468 WALA - 3-leaf hinge WK, spacing 92 mm Unytical 7016
- 80105491 WALA - Mounting set for 3-leaf hinge; dowel 47 mm
- 80462104 Slide block 70x28 mm
- 80462112 Insert with a rod guide
- 8712307 Bolt M5x15.4 mm

- 4SAFE ON SW SAFETY SENSORS ON BOTH SIDES
- ASSA ABLOY SW300 SWING DOOR OPERATOR
- DEAD LOCK KEY OPERATION IN/OUT SIDE
- HANDLE - FINISH STAINLESS STEEL (ASH123.38 1600.SS F1.120)
- SAFETY GLASS BARRIER

OPERATION -

- SIDE HUNG OPEN OUT
- AUTOMATIC OPENING

GLAZING -

GLASS SPEC. DG 02 - 35mm THICK DOUBLE GLAZED UNIT COMPRISING:

OUTER: 4mm PLANICLEAR CLEAR HEAT STRENGTHENED GLASS
1.52mm PVB INTERLAYER
4mm PLANICLEAR CLEAR HEAT STRENGTHENED GLASS WITH COOL LITE SKIN 165 II HIGH PERFORMANCE TO FACE 4

CAVITY: 16mm BLACK TO SPACER, 80% ARGON FILLED DUAL POLYSULPHIDE EDGE SEAL CONSTRUCTION.

INNER: 4mm PLANICLEAR CLEAR HEAT STRENGTHENED GLASS
1.52mm PVB INTERLAYER
4mm PLANICLEAR CLEAR HEAT STRENGTHENED GLASS

WEIGHT = 43 Kg/m² U-VALUE = 1.0W/m²K LT-VALUE = 58%
G-VALUE = 0.32

FINISHES -

- PROFILES -

EXTERNAL - ALL VISIBLE SURFACES TO BE FINISHED TO QUALICOAT CLASS 2, PPC RAL 7016 MATT (30% GLOSS) 60 MICRONS INTERPON D 2525 TO CURRENT BS & EN STANDARDS

INTERNAL - ALL VISIBLE SURFACES TO BE FINISHED TO QUALICOAT CLASS 2, PPC RAL 7016 MATT (30% GLOSS) 60 MICRONS INTERPON D 2525 TO CURRENT BS & EN STANDARDS

- GASKETS - BLACK

Issued 07/11 of August 2020 For APPROVAL

PLEASE REMOVE AND REINSTATE ALL INTERNAL AND EXTERNAL FINISHES AND FIXTURES TO ALLOW STRUCTURE TO CARRY OUT WORKS TO THE CURTAIN WALLING TO AGREED DETAILS. Lendlease TO MAKE GOOD AS NECESSARY, IF REQUIRED STRUCTURAL OPENINGS AND INTERNAL FINISHES TO THE EMPLOYER'S REQUIREMENTS.

ANY NEW SUPPORTING STRUCTURES AND STEEL WORK OR ANY BUILDERS WORK OUTSIDE OF STRUCTURA'S REMIT IS TO BE CARRIED OUT BY Lendlease.

PROTECTION AND FINAL BUILDERS CLEAN IS TO BE CARRIED OUT BY Lendlease.

UNLESS ITEMS/ELEMENTS ARE NOTED BY SUKL, THEY WILL BE BY OTHERS.

REV	DATE	REVISION	INT

Structura UK Ltd
Unit 1, Oakwood Road,
Chessington, Surrey, KT19 1RH
Tel: 020 8397 4361
Fax: 020 8911 5805
E-Mail: info@structura.co.uk

Location	CAMDEN TOWN HALL (CTH) LONDON WC1H 9JF		
Title	BIDBOROUGH STREET AUTOMATIC DOOR DG-EX-09 ELEVATION, VERTICAL AND PLAN SECTION		
Client	LENDLEASE 20 TRITON ST, REGENT S PLACE, LONDON NW1 3BP		
Drawn	MC	Date	07.08.2020
Checked	AF	Scale	NTS@A1
Drawn No	CTH-SUK-G0-DR-25-X-033		
Structura's Ref No	24067-E-131	Rev	P00
Reason for Issue	APPROVAL		

PLEASE NOTE:
OUR WINDOWS, DOORS AND CURTAIN WALL, RAINSCREEN CLADDING SYSTEMS INCLUDING THEIR ANCILLARY ITEMS COMPLY TO THE APPROPRIATE CURRENT BS EN STANDARDS HOWEVER THE PRODUCTS AND SYSTEMS WE USE IN SOME CASES WILL INCORPORATE SOME LIMITED COMBUSTIBLE MATERIALS PERMISSIBLE IN CURRENT APPROVED H M GOVERNMENT DOCUMENT B : 2013 AND GUIDANCE NOTES PUBLISHED BY THE CWCT REFERENCE TNS8.

IT WILL DEEMED UNLESS AGREED IN WRITING THAT THE RESPONSIBILITY REST WITH THE CLIENT, ARCHITECTS, CDM DESIGNERS, FACADE CONSULTANTS OR THE FIRE CONSULTANTS TO MAKE SURE OUR PRODUCTS AND SYSTEMS COMPLY WITH THE EMPLOYERS REQUIREMENTS AND OR LOCAL BUILDING CONTROL APPROVALS. THE SAME CAN BE SAID FOR ANY FIRE RATED GLAZING INTERNALLY OR EXTERNALLY INCLUDING ANY FIRE RATED DOORS IN ANY ROUTE OF ESCAPE.

DRAWINGS, SPECIFICATIONS AND CALCULATIONS ARE SUBMITTED BY SUKL IN ACCORDANCE WITH RELEVANT CLAUSE OF THE SUBCONTRACT FOR COMMENT AND OR APPROVAL AS REQUIRED BY THE SUBCONTRACT AND DEFINED BY THE MAIN CONTRACT. ANY COMMENT OR APPROVAL OF THE DRAWINGS RETURNED TO SUKL DOES NOT RELIEVE SUKL OF HIS RESPONSIBILITIES UNDER THE SUBCONTRACT.

NOTE:
MINIMUM STRUCTURAL OPENING REQUIRED TO ACCOMMODATE THE SW300 OPERATOR

DOOR PROTOCOL -

- DOUBLE LEAF SWING DOOR OPEN OUTWARD.
- IN CASE OF POWER CUT / FIRE ALARM ACTIVATION THE DOOR WILL REVERT TO MANUAL - OCCUPANT WILL HAVE PUSH THE DOOR IN ORDER TO ESCAPE BUILDING.
- THE DOORS WILL BE ACTIVATED BY PUSH BUTTON INSIDE AND OUTSIDE DURING NORMAL HOURS.
- THE DOOR CAN BE LOCKED WITH USING KEYS FROM INSIDE OR OUTSIDE DEPENDING ON CLIENTS NEEDS.

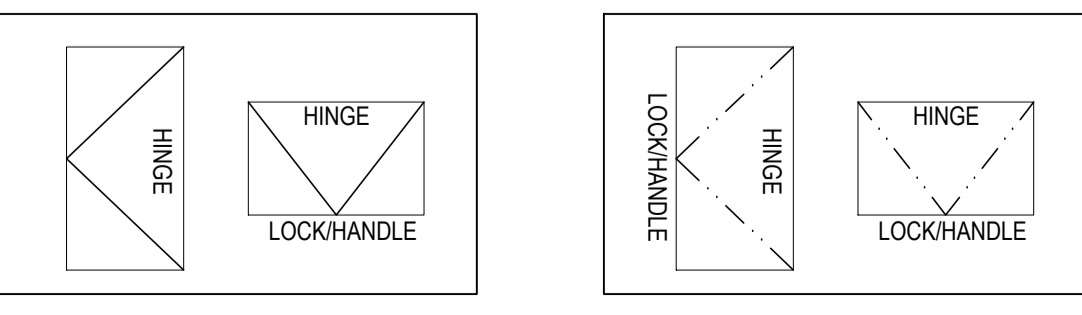

HINGE LOCATION "OPEN OUT" HINGE LOCATION "OPEN IN"

01 - INDICATES DETAIL REFERENCE
102 - INDICATES DRAWING NUMBER (###-###)