

VERTICAL SECTION B-B  
THROUGH MAG LOCK

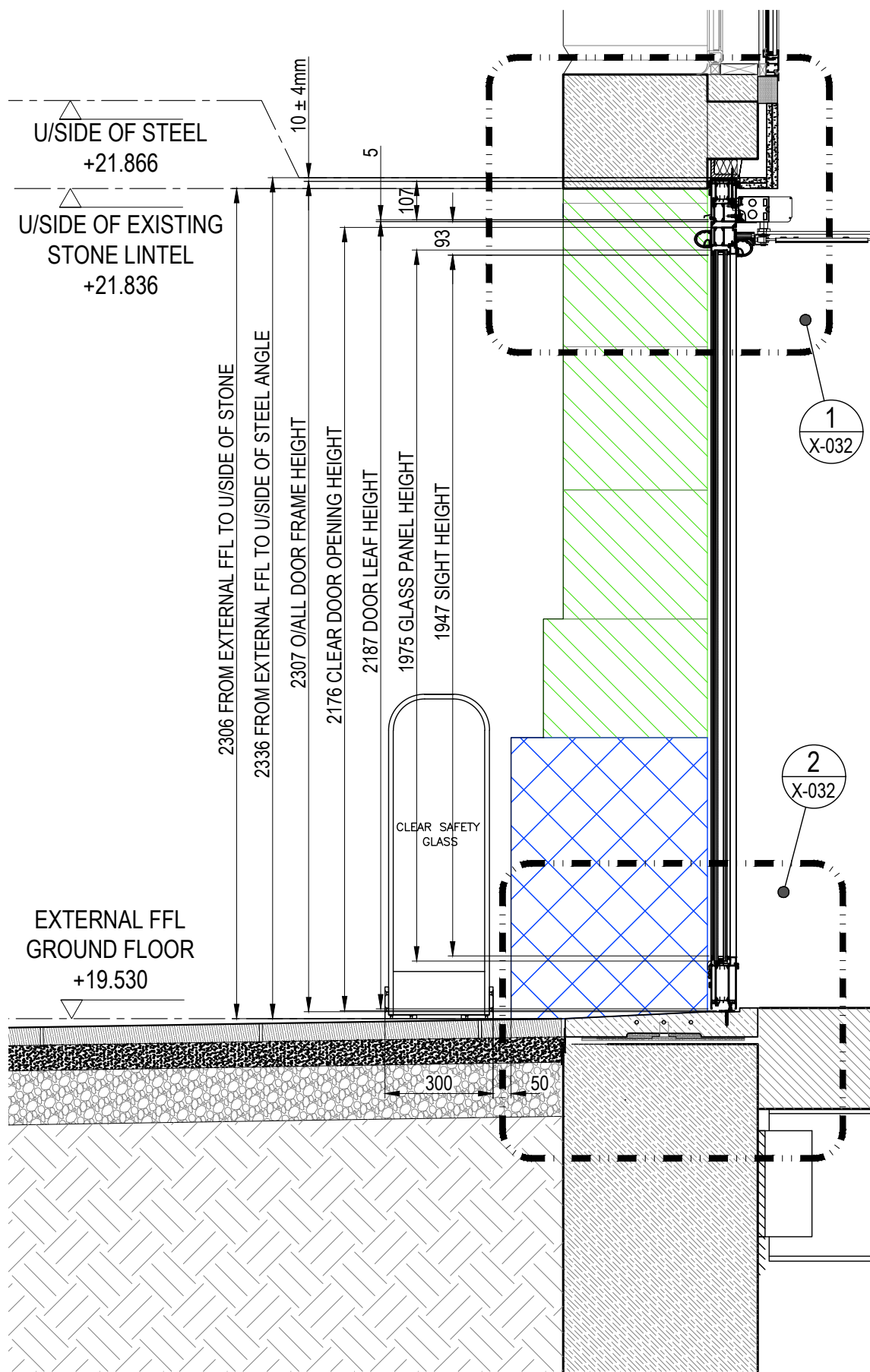

VERTICAL SECTION C-C  
THROUGH DOOR OPERATOR

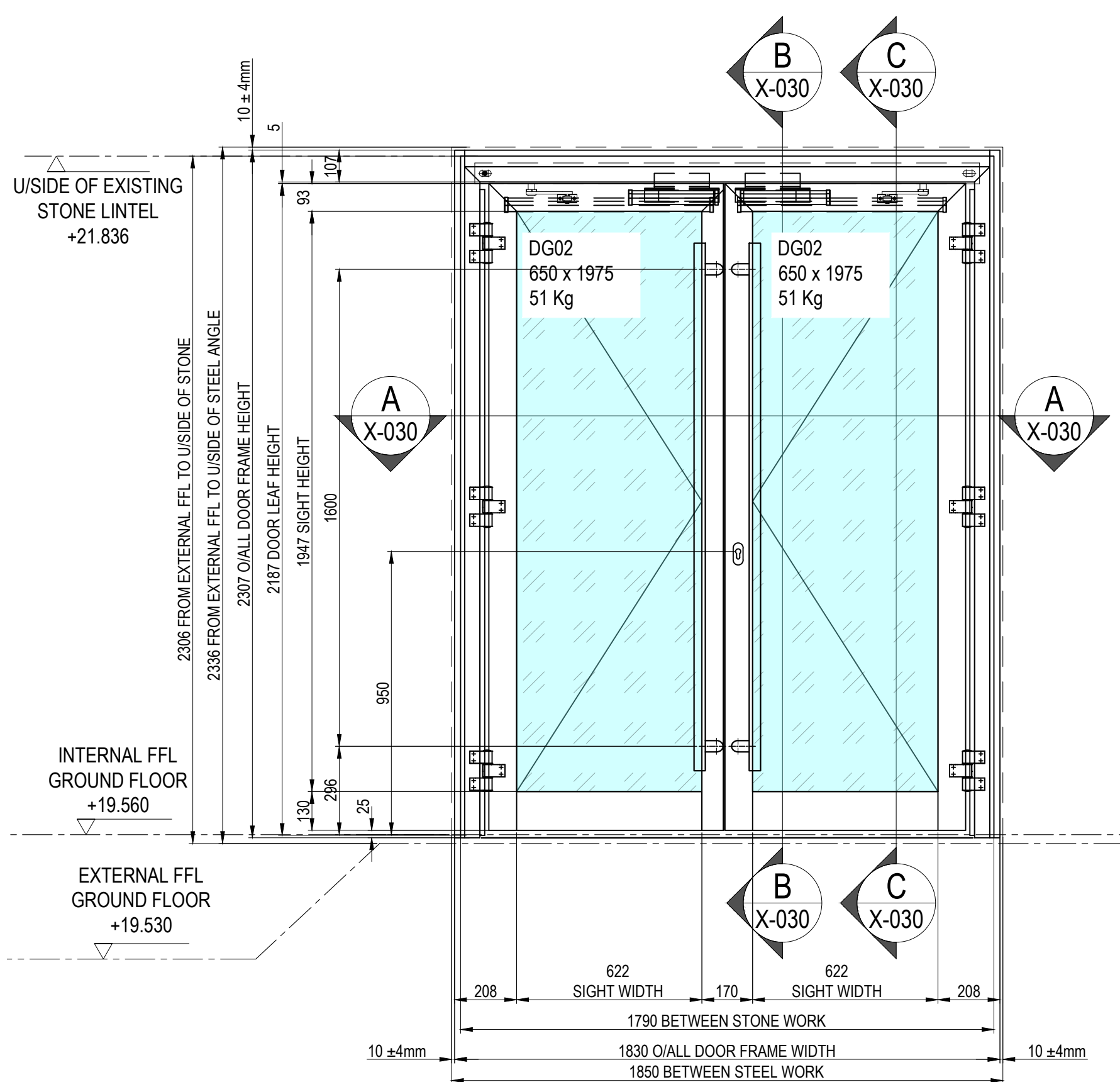

ELEVATION -DG-EX-10  
VIEW FROM OUT SIDE

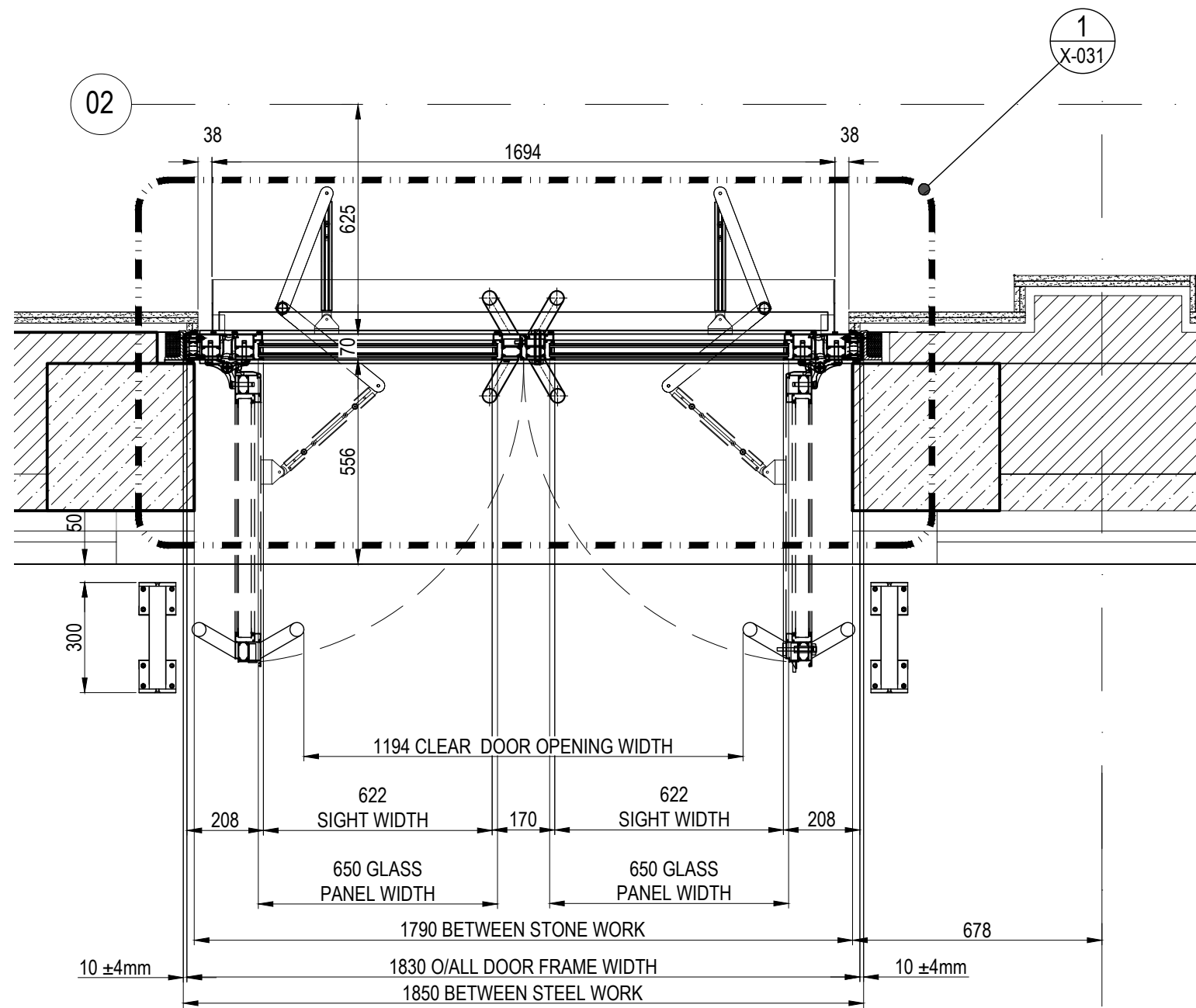

PLAN SECTION A-A

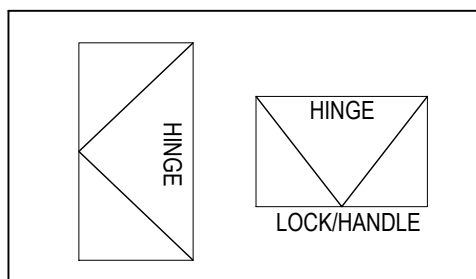

HINGE LOCATION "OPEN OUT"

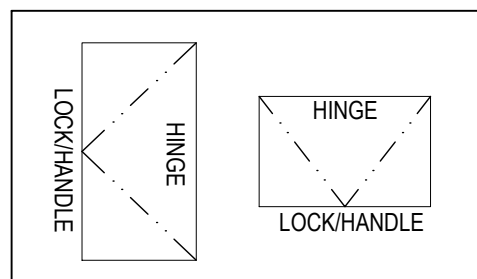

HINGE LOCATION "OPEN IN"

01 - INDICATES DETAIL REFERENCE  
02 - INDICATES DRAWING NUMBER  
(###-###)

**NOTE-**  
MINIMUM STRUCTURAL OPENING REQUIRED TO ACCOMMODATE THE SW300 OPERATOR

**DOOR PROTOCOL -**

- AUTOMATIC DOUBLE LEAF SWING DOOR OPEN OUTWARD.
- THE DOOR WILL BE ACTIVATED FROM INSIDE WITH A PUSH BUTTON BY OTHERS AND WILL BE ACTIVATE FROM OUTSIDE WITH TOKEN READER BY OTHERS. THE DOOR CAN BE LOCK WITH A KEY FROM EITHER INSIDE AND OUTSIDE DEPENDING ON CLIENT NEEDS.

**SPECIFICATION**

**DOOR SYSTEM**

DOOR SYSTEM - ALUPROF MB-70 CASEMENT STANDARD ALUMINIUM DOORS SYSTEM IN ACCORDANCE WITH ALUPROF TEST DATA & SPECIFICATIONS TO CURRENT BS & EN STANDARDS.

**IRONMONGERY -**

- 19102020 GU-3-point latch and deadbolt lock U24x6 mm D35, Hs=2000 m
- 19102134 GU-One-piece striker 24x3 mm, top (galvanized)
- 19102135 GU-One-piece striker 24x3 mm, bottom (galvanized)
- 19102181 GU - Main striking plate 24x3 mm, right (galvanized)
- 19102230 GU - Roll latch
- 19102251 GU - Cover
- 19102252 GU - Cover
- 19242210 ALUPROF - LINE rosette Stainless steel
- 80004316 Cylinder insert 35/60 mm
- 80009434 FUHR - Slave leaf shootbolt
- 80009436 FUHR - Round rod
- 80009437 FUHR - Striker with guide
- 80009438 FUHR - Rod latch, top
- 80009505 WALA - Flap keep
- 8010546R WALA - 3-leaf hinge WX, spacing 92 mm Untypical 7016
- 80105491 WALA - Mounting set for 3-leaf hinge: dowel 47 mm
- 80462104 Slide block 70x28 mm
- 80462212 Insert with a rod guide
- 87122307 Bolt M5x15.4 mm
- 4SAFE ON SW SAFETY SENSORS ON BOTH SIDES
- ASSA ABLOY SW300 SWING DOOR OPERATOR
- DEAD LOCK KEY OPERATION IN/OUT SIDE
- HANDLE - FINISH STAINLESS STEEL (ASH123.38.1600.SS.F1.120)
- MAG LOCK MINI MAGNET 3000N
- UNIVERSAL MOUNTING BRACKET MAGAC-U300
- GLASS SAFETY BARRIER

**OPERATION -**

- SIDE HUNG OPEN OUT
- AUTOMATIC OPENING

**GLAZING -**

GLASS SPEC. DG 02 - 35mm THICK DOUBLE GLAZED UNIT COMPRISING:

OUTER: 4mm PLAIN/CLEAR CLEAR HEAT STRENGTHENED GLASS  
1.52mm PVB INTERLAYER  
4mm PLAIN/CLEAR CLEAR HEAT STRENGTHENED GLASS WITH COOL LITE SKN 165 II HIGH PERFORMANCE TO FACE 4  
CAVITY: 16mm BLACK TGI SPACER, 90% ARGON FILLED DUAL POLYSULPHIDE EDGE SEAL CONSTRUCTION  
INNER: 4mm PLAIN/CLEAR CLEAR HEAT STRENGTHENED GLASS  
1.52mm PVB INTERLAYER  
4mm PLAIN/CLEAR CLEAR HEAT STRENGTHENED GLASS

WEIGHT = 43 Kg/m² U-VALUE = 1.0W/m²K LT-VALUE = 58%  
G-VALUE = 0.32

**FINISHES -**

- PROFILES -

EXTERNAL - ALL VISIBLE SURFACES TO BE FINISHED TO QUALICOAT CLASS 2, PPC RAL 7016 MATT (30% GLOSS) 60 MICRONS INTERPON D 2525 TO CURRENT BS & EN STANDARDS

INTERNAL - ALL VISIBLE SURFACES TO BE FINISHED TO QUALICOAT CLASS 2, PPC RAL 7016 MATT (30% GLOSS) 60 MICRONS INTERPON D 2525 TO CURRENT BS & EN STANDARDS

- GASKETS - BLACK

Issued 07th of August 2020 For  
**APPROVAL**

Lendlease TO REMOVE AND REINSTATE ALL INTERNAL AND EXTERNAL FINISHES AND FIXTURES TO ALLOW STRUCTURA TO CARRY OUT WORKS TO THE CURTAIN WALLING TO AGREED DETAILS. Lendlease TO MAKE GOOD AS NECESSARY, IF REQUIRED, STRUCTURAL OPENINGS AND INTERNAL FINISHES TO THE EMPLOYER'S REQUIREMENTS.

ANY NEW SUPPORTING STRUCTURES AND STEEL WORK OR ANY BUILDERS WORK OUTSIDE OF STRUCTURA'S REMIT IS TO BE CARRIED OUT BY Lendlease

PROTECTION AND FINAL BUILDERS CLEAN IS TO BE CARRIED OUT BY Lendlease

UNLESS ITEMS/ELEMENTS ARE NOTED BY SUKL, THEY WILL BE BY OTHERS.

REV	DATE	REVISION	INT

**STRUCTURA**  
Unit 1, Oakcroft road,  
Chesham, Surrey, KT9 1RH  
Tel: 020 8397 4961  
Fax: 020 8391 5865  
E Mail: @structura.co.uk

Location CAMDEN TOWN HALL (CTH)  
LONDON WC1H 9UE

Title BIDBOROUGH STREET  
AUTOMATIC DOOR DG-EX-10 ELEVATION, VERTICAL AND PLAN SECTION

Client LENDLEASE  
20 TRITON ST, REGENT'S PLACE, LONDON NW1 3BF

Drawn MC Date 07.08.2023 Checked AF Scale NTS@A1  
Dwg No CTH-SUK-G0-DR-25-X-030

Structura's Ref No 24067-E-130  
Reason for Issue APPROVAL

Unit 1, Oakcroft road,  
Chesham, Surrey, KT9 1RH  
Tel: 020 8397 4961  
Fax: 020 8391 5865  
E Mail: @structura.co.uk

PLEASE NOTE:  
OUR WINDOWS, DOORS AND CURTAIN WALL, RAINSCREEN CLADDING SYSTEMS INCLUDING THEIR ANCILLARY ITEMS COMPLY TO THE APPROPRIATE CURRENT BSEN STANDARDS HOWEVER THE PRODUCTS AND SYSTEMS WE USE IN SOME CASES WILL INCORPORATE SOME LIMITED COMBUSTIBLE MATERIALS PERMISSIBLE IN CURRENT APPROVED H M GOVERNMENT DOCUMENT B : 2013 AND GUIDANCE NOTES PUBLISHED BY THE CWCT REFERENCE T98.

IT WILL BE DEEMED UNLESS AGREED IN WRITING THAT THE RESPONSIBILITY REST WITH THE CLIENT, ARCHITECTS, CDM DESIGNERS, FACADE CONSULTANTS OR THE FIRE CONSULTANTS TO MAKE SURE OUR PRODUCTS AND SYSTEMS COMPLY WITH THE EMPLOYERS REQUIREMENTS AND OR LOCAL BUILDING CONTROL APPROVALS. THE SAME CAN BE SAID FOR ANY FIRE RATED GLAZING INTERNALLY OR EXTERNALLY INCLUDING ANY FIRE RATED DOORS IN ANY ROUTE OF ESCAPE.

DRAWINGS, SPECIFICATIONS AND CALCULATIONS ARE SUBMITTED BY SUKL IN ACCORDANCE WITH RELEVANT CLAUSE OF THE SUBCONTRACT FOR COMMENT AND OR APPROVAL AS REQUIRED BY THE SUBCONTRACT AND DEFINED BY THE MAIN CONTRACT. ANY COMMENT OR APPROVAL OF THE DRAWINGS RETURNED TO SUKL DOES NOT RELIEVE SUKL OF HIS RESPONSIBILITIES UNDER THE SUBCONTRACT.