

VERTICAL SECTION A-A

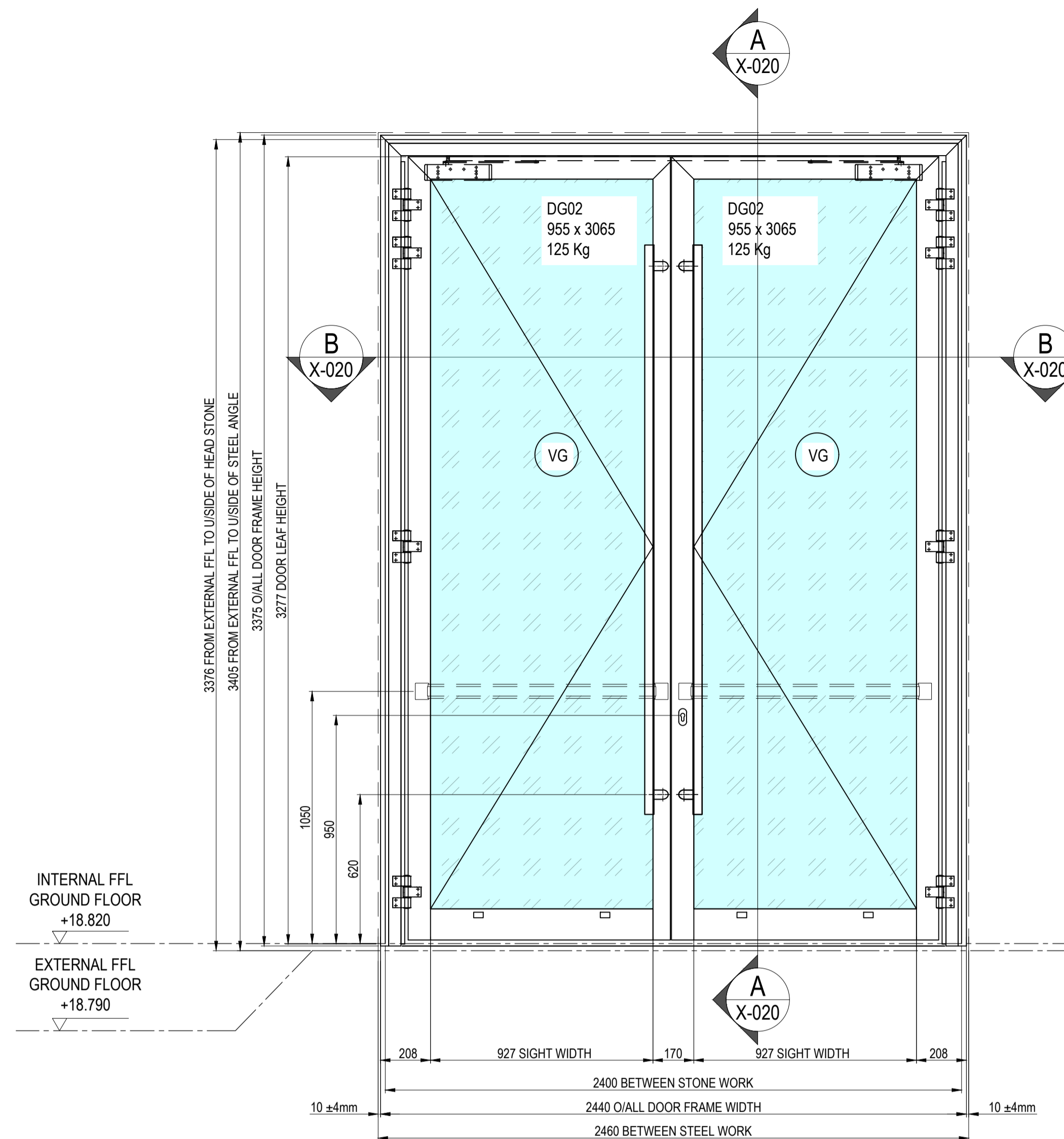

ELEVATION -DG-EX-20
VIEW FROM OUT SIDE

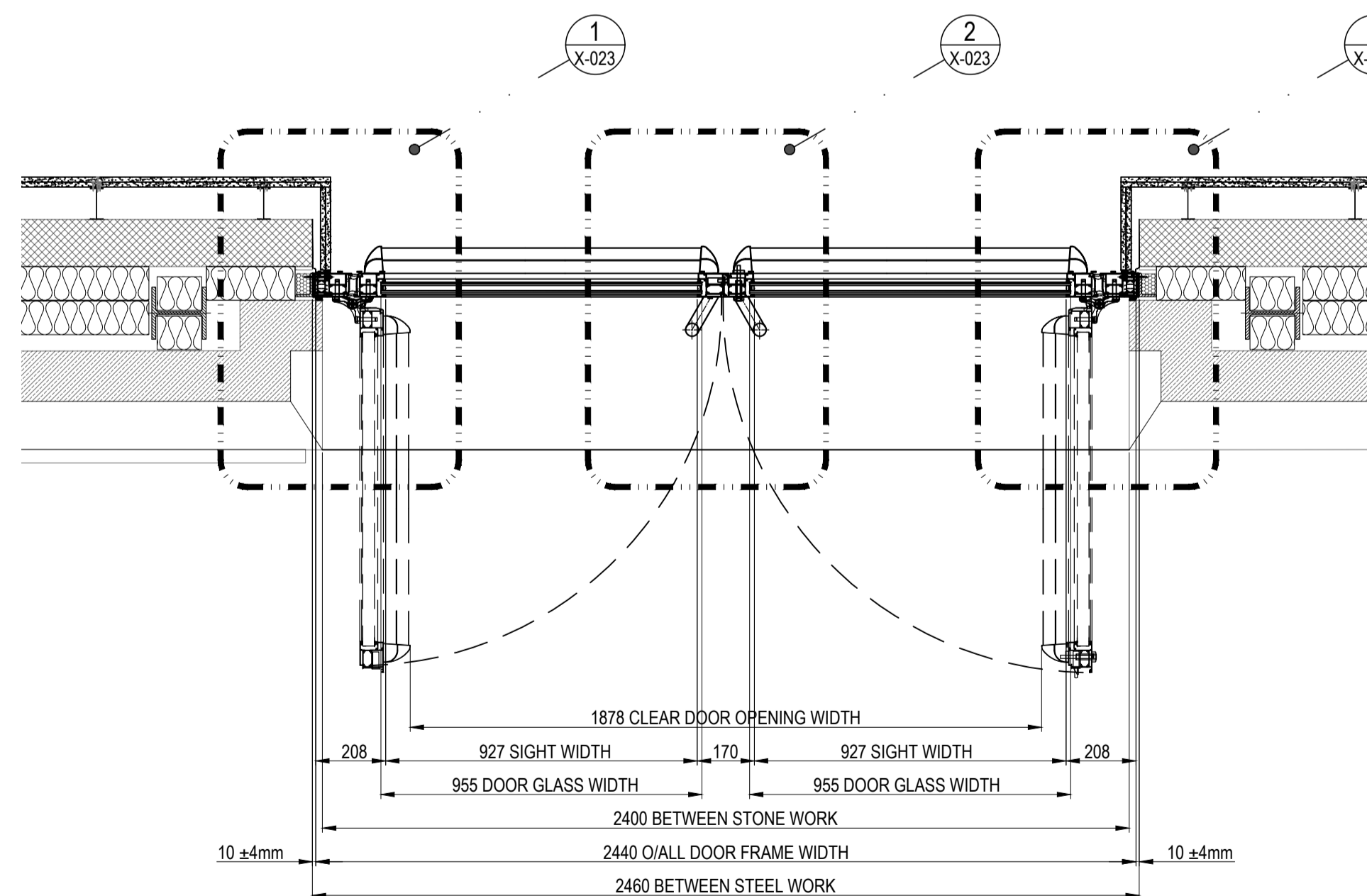

PLAN SECTION B-B

SPECIFICATION

DOOR SYSTEM

DOOR SYSTEM - ALUPROF MB-TO CASEMENT STANDARD ALUMINIUM DOORS SYSTEM IN ACCORDANCE WITH ALUPROF TEST DATA & SPECIFICATIONS TO CURRENT BS & EN STANDARDS.

IRONMONGERY

- 1924231G ALUPROF - LINE rosette Stainless Steel
- 80004316 Cylinder insert 3500 mm
- 80004417 WILKA - 2-point Antipanic lock 666Z - function E
- 80004423 WILKA - Round rod 2400 mm
- 80004424 WILKA - Striker with guide
- 80004425 WILKA - Top rod
- 80009448 FUHR - Carry bar
- 80009511 WILKA - Part 24x2-245 mm
- 80009523 WILKA - Panic keep P24x3 mm
- 80009524 WILKA - Rod latch, top
- 80009525 WILKA - Panic door shootbolt guide - top
- 80009526 WILKA - Floor keep
- 80009528 WILKA - Bottom rod
- 80009592 WILKA - Part 24x3 mm
- 8000967G ECO SCHULTE - Rosette Stainless Steel
- 8000992G ECO SCHULTE - Touch bar 1250 mm Stainless Steel
- 80009994 Runge wedge
- 8010546R WALA - 3-leaf hinge WX, spacing 92 mm Unypical 7016
- 80105491 WALA - Mounting set for 3-leaf hinge: dowel 47 mm
- 80462104 Slide block 70x29 mm
- 80462212 Insert with a rod guide
- 87122119 Bolt M6x25 mm
- DORMA TS 93 G CONTUR DOOR CLOSER
- SLIDE RAILS FOR DORMA TS 93 CONTUR
- ECO EPN 2000 II PANIC BAR

OPERATION

- SIDE HUNG OPEN OUT
- MECHANICAL OPENING

GLAZING

GLASS SPEC. DG 02 - 35mm THICK DOUBLE GLAZED UNIT COMPRISING:

OUTER: 4mm PLANICLEAR CLEAR HEAT STRENGTHENED GLASS
1.52mm PVB INTERLAYER
4mm PLANICLEAR CLEAR HEAT STRENGTHENED GLASS WITH COOL LITE SKN 185 II HIGH PERFORMANCE TO FACE 4

CAVITY: 16mm BLACK TO SPACER, 90% ARGON FILLED DUAL POLYSULPHIDE EDGE SEAL CONSTRUCTION.

INNER: 4mm PLANICLEAR CLEAR HEAT STRENGTHENED GLASS
1.52mm PVB INTERLAYER
4mm PLANICLEAR CLEAR HEAT STRENGTHENED GLASS

WEIGHT = 43 Kg/m² U-VALUE = 1.0W/m²K LT-VALUE = 58% G-VALUE = 0.32

FINISHES

- PROFILES -
- EXTERNAL - ALL VISIBLE SURFACES TO BE FINISHED TO QUALICOAT CLASS 2, PPC RAL 7016 MATT (30% GLOSS) 60 MICRONS INTERPON D 2525 TO CURRENT BS & EN STANDARDS.
- INTERNAL - ALL VISIBLE SURFACES TO BE FINISHED TO QUALICOAT CLASS 2, PPC RAL 7016 MATT (30% GLOSS) 60 MICRONS INTERPON D 2525 TO CURRENT BS & EN STANDARDS.
- GASKETS - BLACK
- HANDLE - FINISH STAINLESS STEEL (ASH123.38.12200.SS.F1.120)

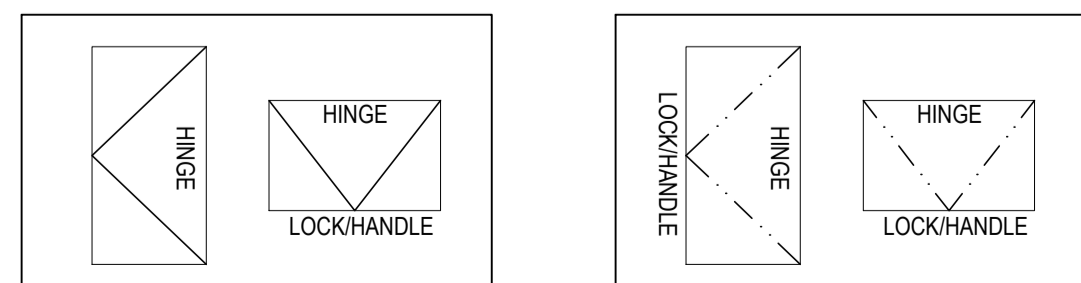

DOOR PROTOCOL -

- DOUBLE LEAF SWING DOOR OPEN OUTWARD.
- THE DOOR CAN ALWAYS BE OPENED FROM THE INSIDE IN THE DIRECTION OF ESCAPE. THE DOOR CAN ONLY BE OPENED FROM OUTSIDE USING THE KEY, WHEREBY THE LATCH AND BOLT ARE PULLED BACK.

PLEASE NOTE

OUR WINDOWS, DOORS AND CURTAIN WALL, RAINSCREEN CLADDING SYSTEMS INCLUDING THEIR ANCILLARY ITEMS COMPLY TO THE APPROPRIATE CURRENT BS EN STANDARDS HOWEVER THE PRODUCTS AND SYSTEMS WE USE IN SOME CASES WILL INCORPORATE SOME LIMITED COMBUSTIBLE MATERIALS PERMISSIBLE IN CURRENT APPROVED HM GOVERNMENT DOCUMENT B: 2013 AND GUIDANCE NOTES PUBLISHED BY THE CWCT REFERENCE TN8.

IT WILL BE DEEMED UNLESS AGREED IN WRITING THAT THE RESPONSIBILITY RESTS WITH THE CLIENT, ARCHITECTS, CDM DESIGNERS, FACADE CONSULTANTS OR THE FIRE CONSULTANTS TO MAKE SURE OUR PRODUCTS AND SYSTEMS COMPLY WITH THE EMPLOYERS REQUIREMENTS AND OR LOCAL BUILDING CONTROL APPROVALS. THE SAME CAN BE SAID FOR ANY FIRE RATED GLAZING INTERNALLY OR EXTERNALLY INCLUDING ANY FIRE RATED DOORS IN ANY ROUTE OF ESCAPE.

DRAWINGS, SPECIFICATIONS AND CALCULATIONS ARE SUBMITTED BY SUKL IN ACCORDANCE WITH RELEVANT CLAUSE OF THE SUBCONTRACT FOR COMMENT AND OR APPROVAL AS REQUIRED BY THE SUBCONTRACT AND DEFINED BY THE MAIN CONTRACT. ANY COMMENT OR APPROVAL OF THE DRAWINGS RETURNED TO SUKL DOES NOT RELIEVE SUKL OF HIS RESPONSIBILITIES UNDER THE SUBCONTRACT.

PLEASE REMOVE AND REINSTATE ALL INTERNAL AND EXTERNAL FINISHES AND FIXTURES TO ALLOW STRUCTURA TO CARRY OUT WORKS TO THE CURTAIN WALLING TO AGREED DETAILS. Lendlease TO MAKE GOOD AS NECESSARY, IF REQUIRED STRUCTURAL OPENINGS AND INTERNAL FINISHES TO THE EMPLOYER'S REQUIREMENTS.

ANY NEW SUPPORTING STRUCTURES AND STEEL WORK OR ANY BUILDERS WORK OUTSIDE OF STRUCTURA'S REMIT IS TO BE CARRIED OUT BY Lendlease.

PROTECTION AND FINAL BUILDERS CLEAN IS TO BE CARRIED OUT BY Lendlease.

UNLESS ITEMS/ELEMENTS ARE NOTED BY SUKL, THEY WILL BE BY OTHERS.

REV	DATE	REVISION	INT

STRUCTURA UK Ltd
Unit 1, Oakcroft Road, Chessington, Surrey, KT9 1RH
Tel: 020 8397 6961 Fax: 020 8391 5865 E-Mail: info@structura.co.uk

Location: CAMDEN TOWN HALL (CTH) LONDON WC1H 9UE

Title: TONBRIDGE WALK ELEVATION MANUAL DOOR DG-EX-20 ELEVATION, VERTICAL AND PLAN SECTION

Client: LENDLEASE 20 TRITON ST, REGENT'S PLACE, LONDON NW1 3BF

Drawn: MC Date: 31.07.2023 Checked: AF Scale: NTS@A1

Dwg No: CTH-SUK-G0-DR-25-X-020

Structura's Ref No: 24067-E-120 Rev: P00

Reason for issue: APPROVAL

Issued 31st of July 2023 For APPROVAL