

section AA

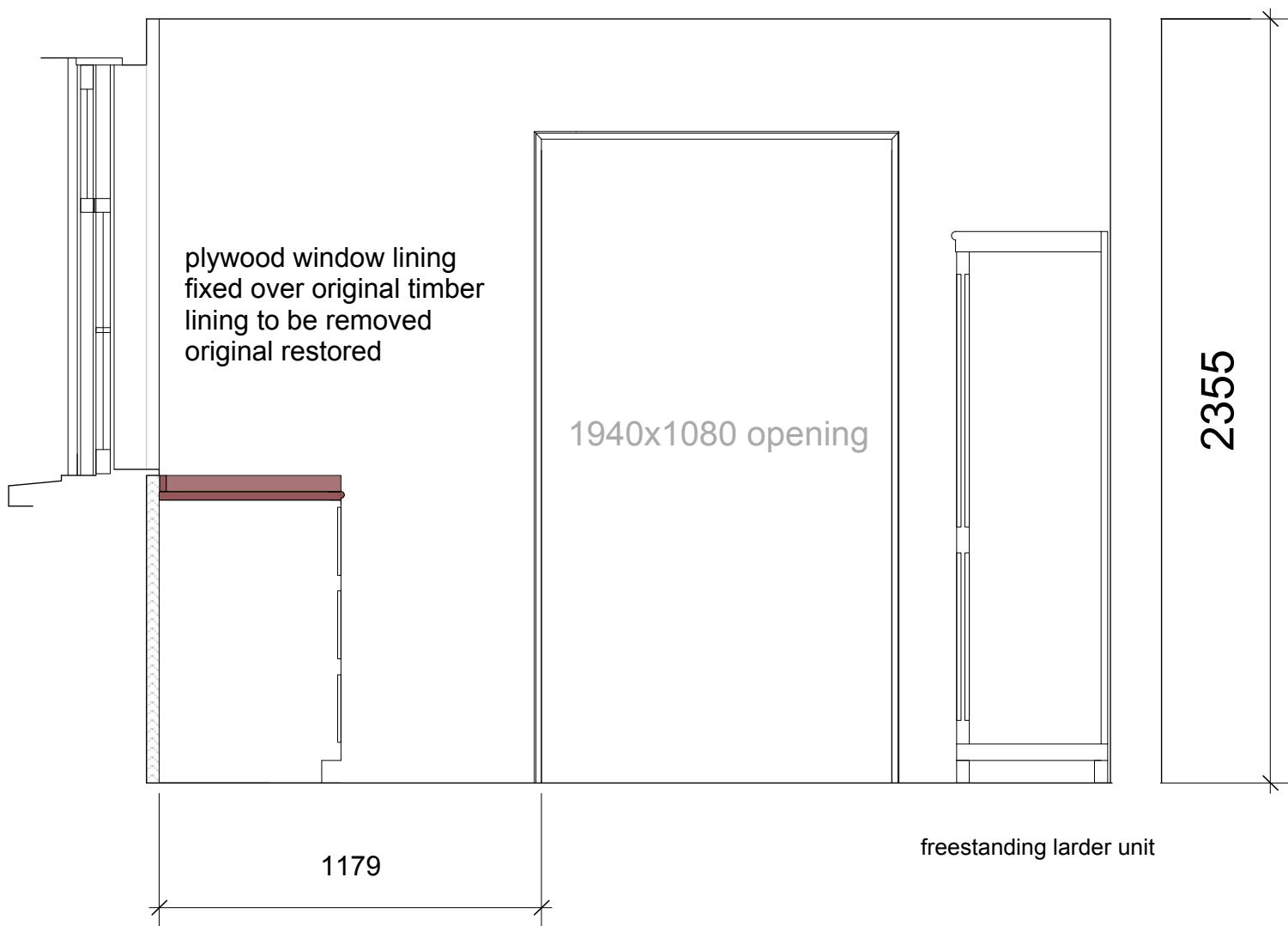

elevation A

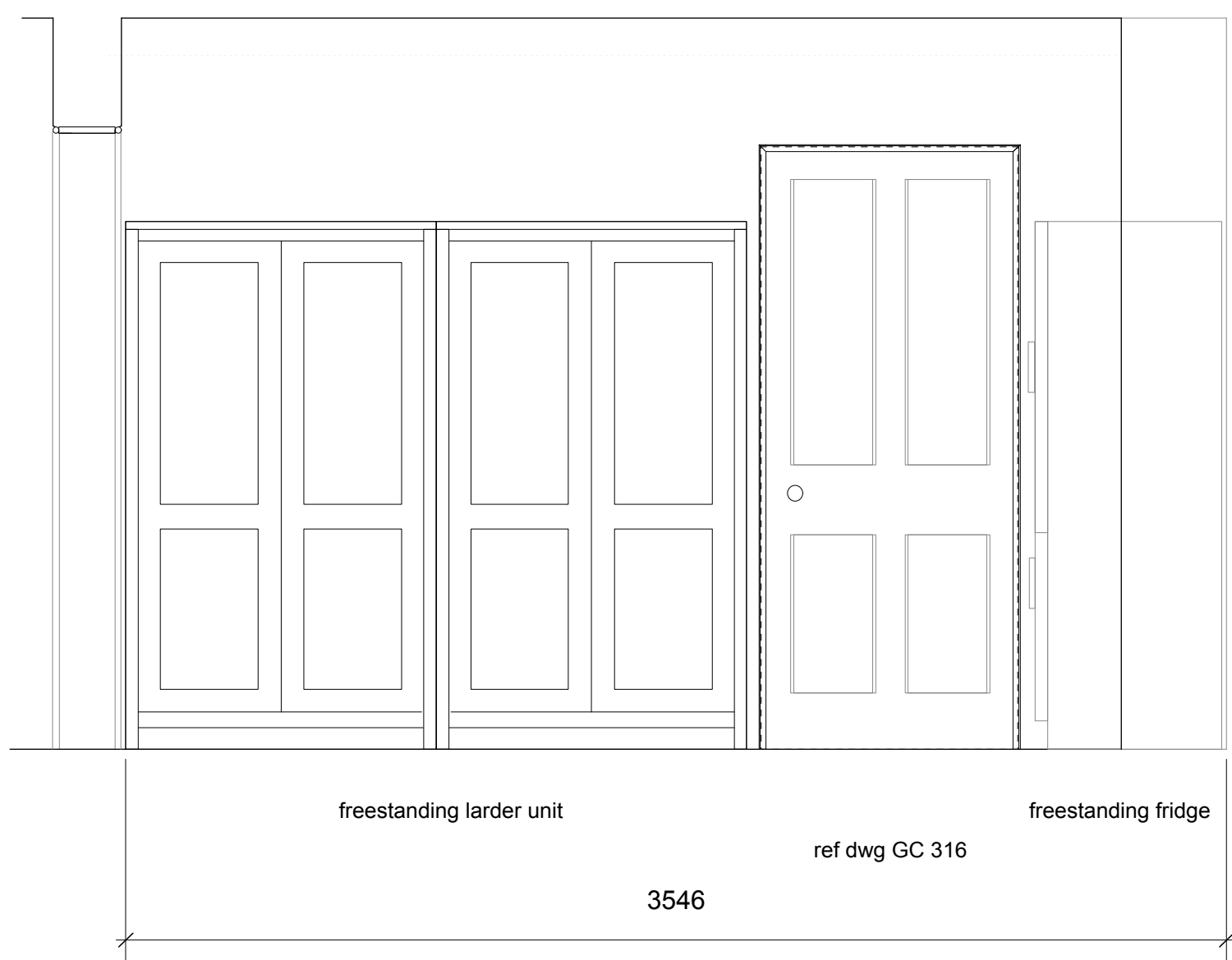

elevation B



elevation C

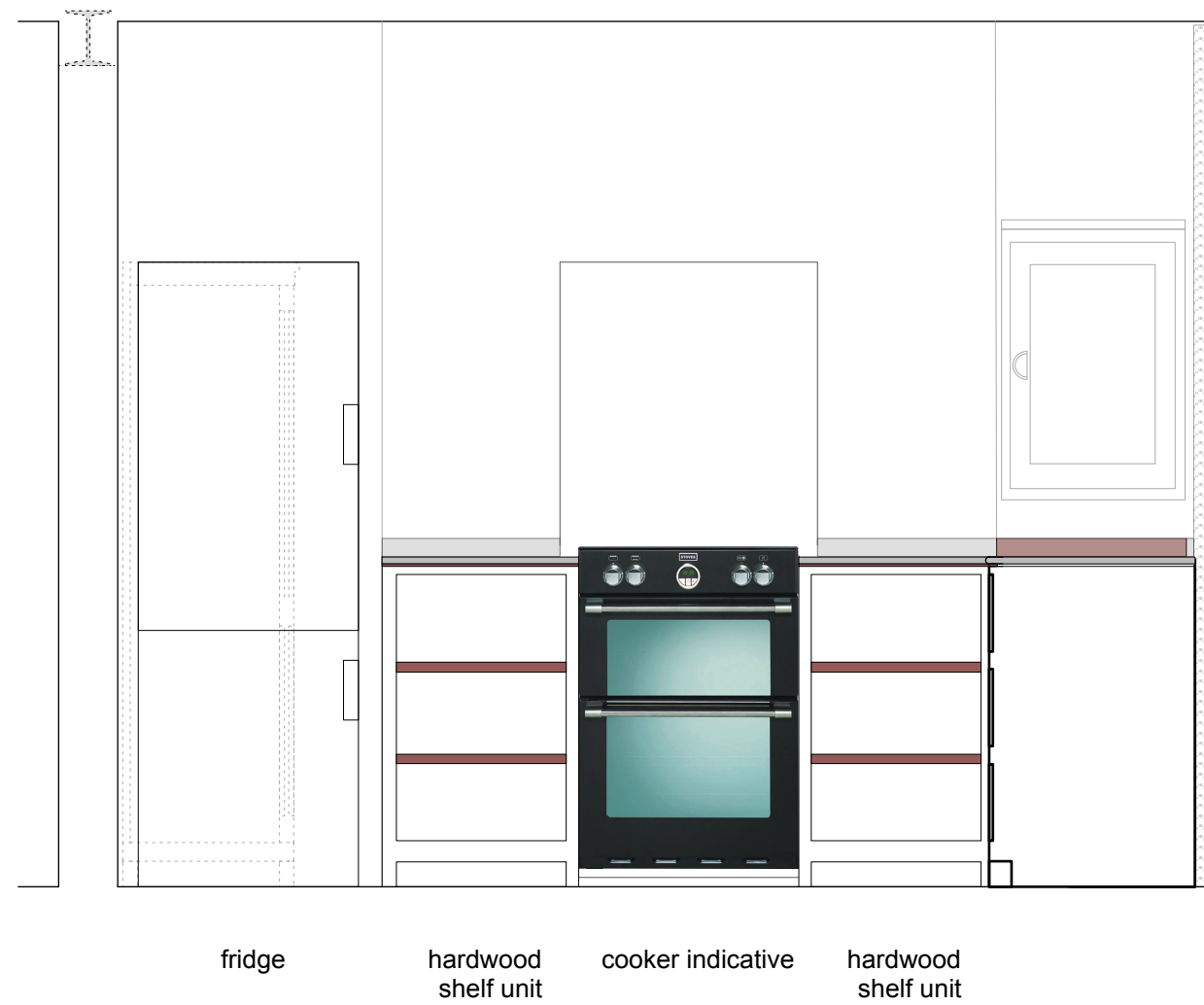

joinery items use single panel doors following precedent

worktop material salvaged by Bennett for the 1969 kitchen
re-used to maintain continuity of appearance and usefulness

original 1850's window surround under plywood to be restored

new masonry spine wall
fire rated stud wall to
stairway under retained
steel RSJ

hardwood and Carrera marble reclaimed material from original kitchen

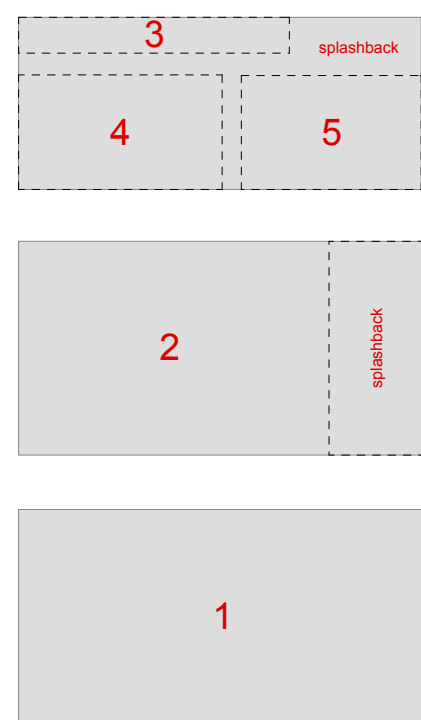

3x recalimed Carrera marble slabs

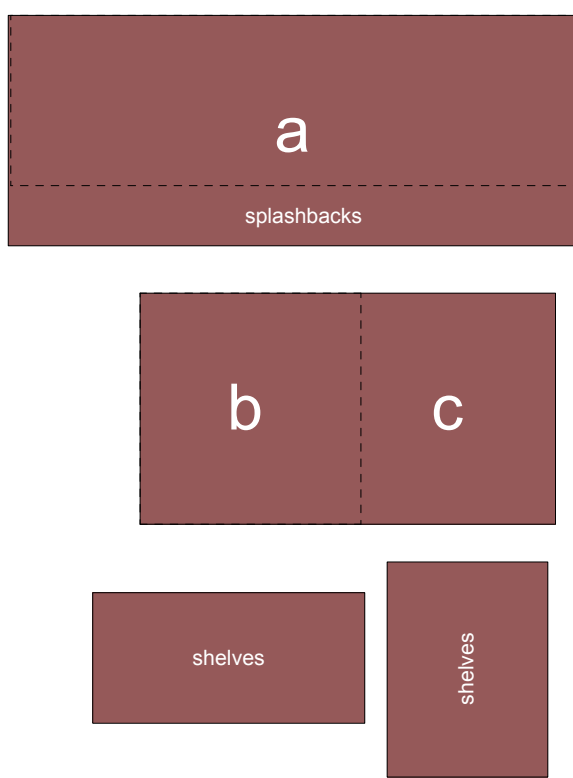

4x reclaimed hardwood worktop sections

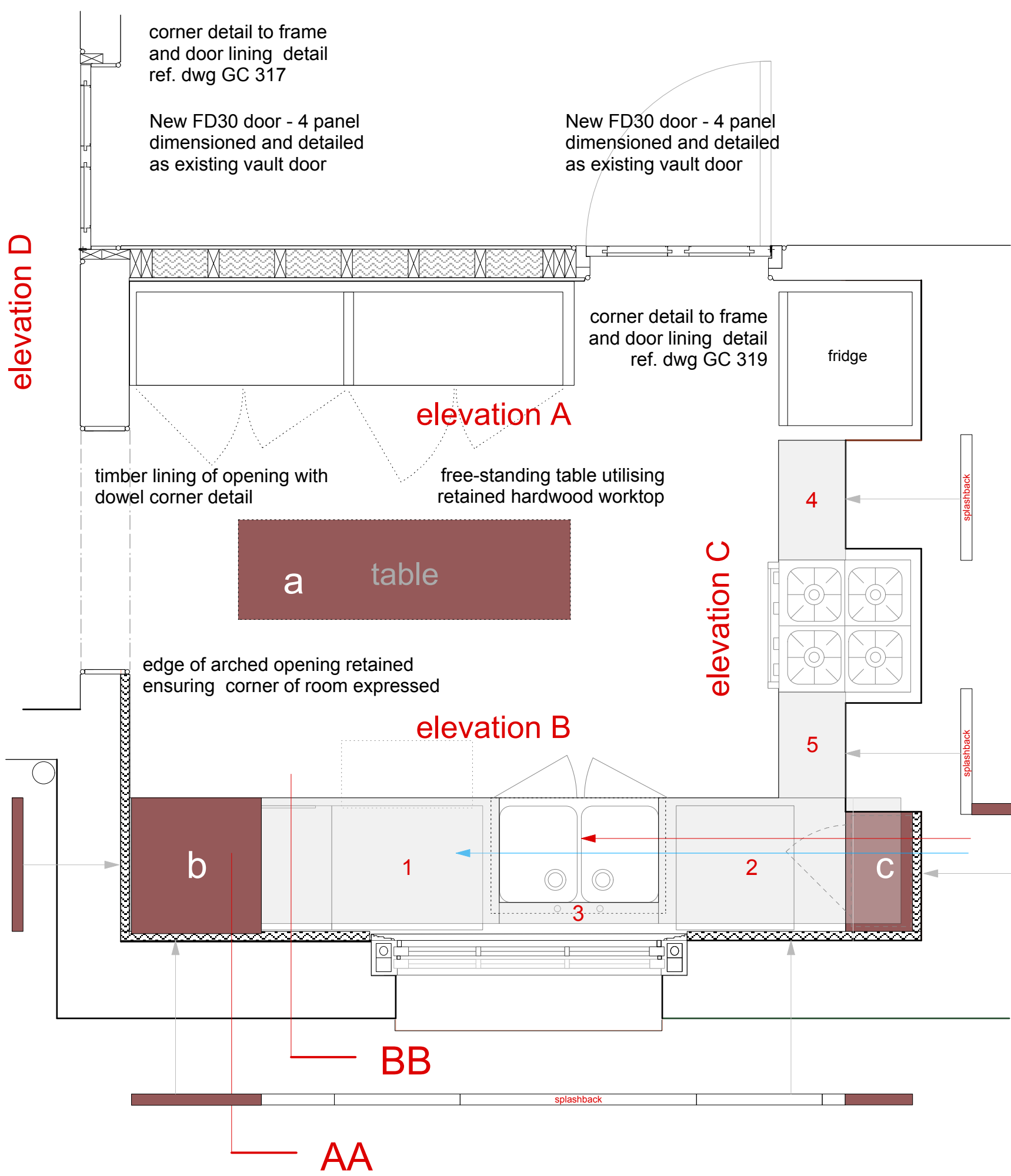

worktop edge detail shaped to
follow existing marble edge detail

section detail AA 1:1 worktop

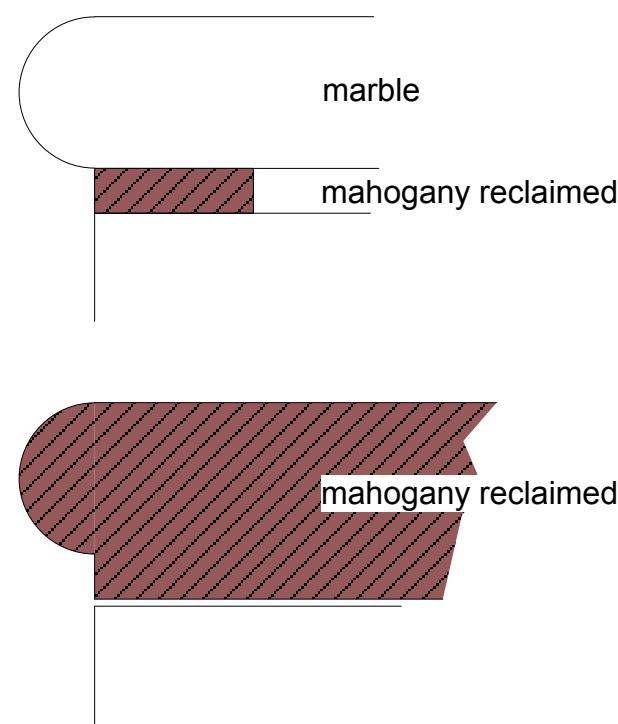

section detail BB 1:1 worktop

splashback material marble or mahogany
aligned to worktop material adjacent

elevation D



ref dwg GC 317

20 diameter timber
dowel corner detail
to doorway and opening
170x20mm softwood
square edged skirting
dowel corners run onto
top edge of skirting
timber linings to doorways

