

section AA

elevation A

elevation B

elevation C

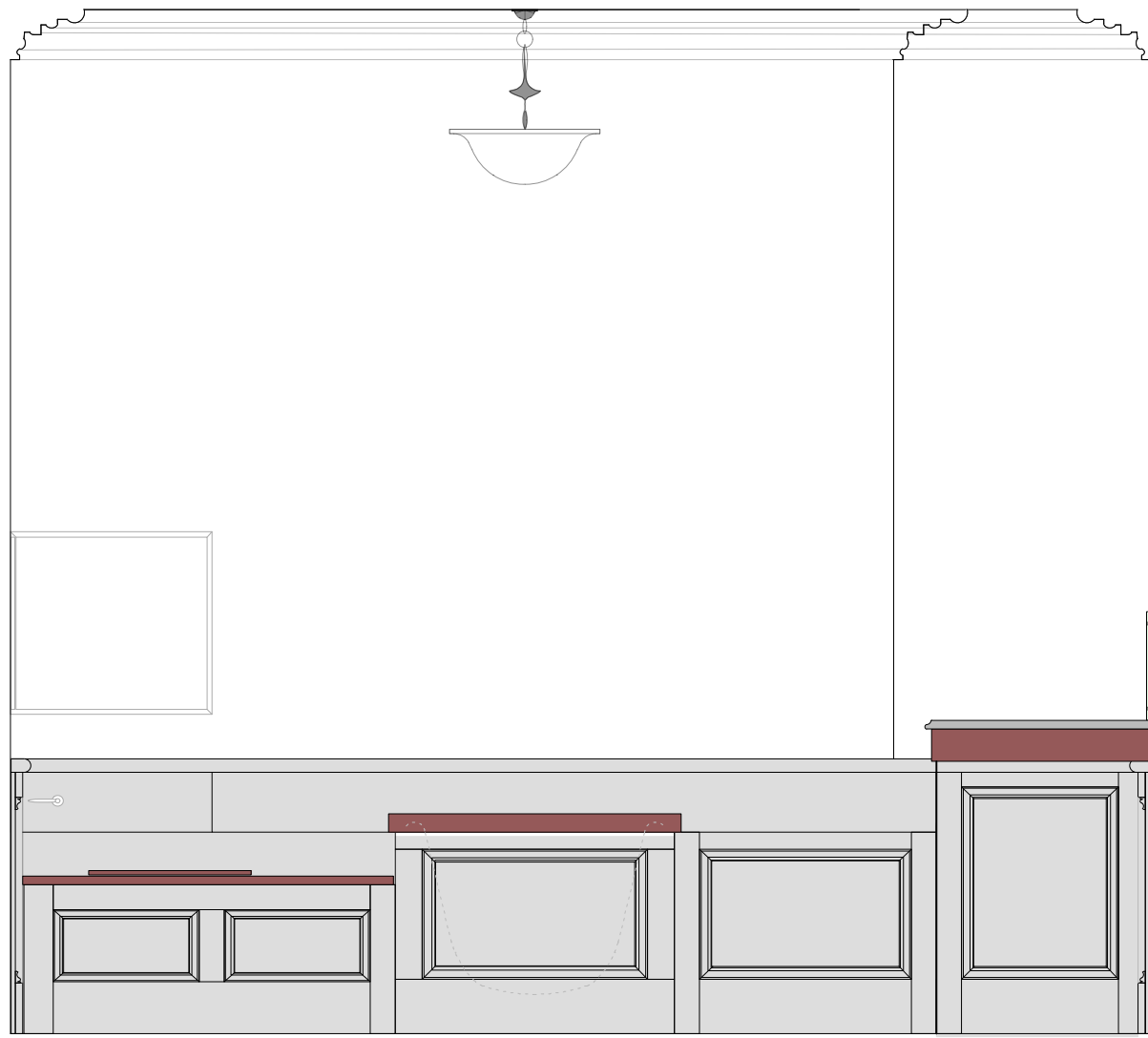
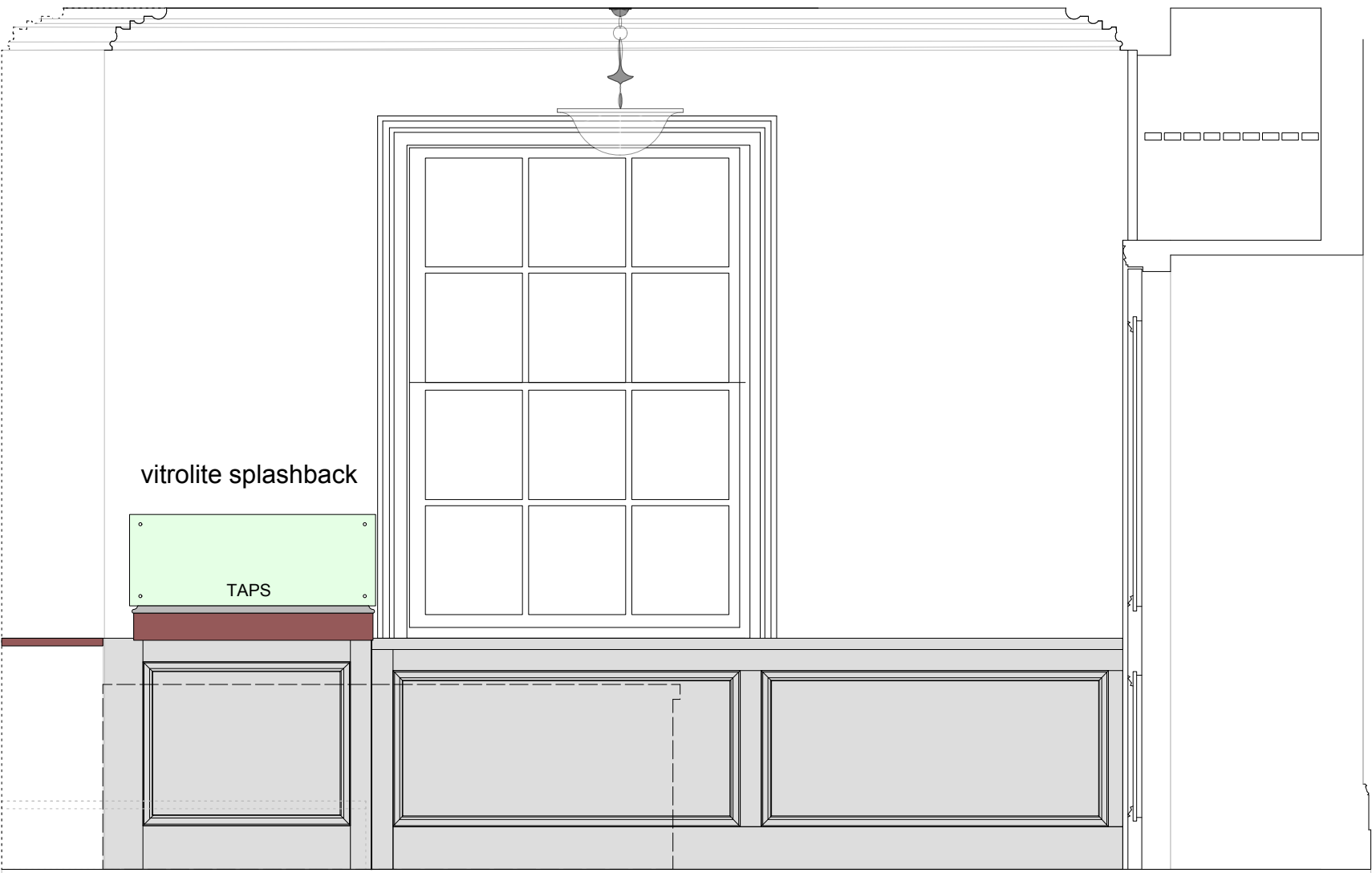
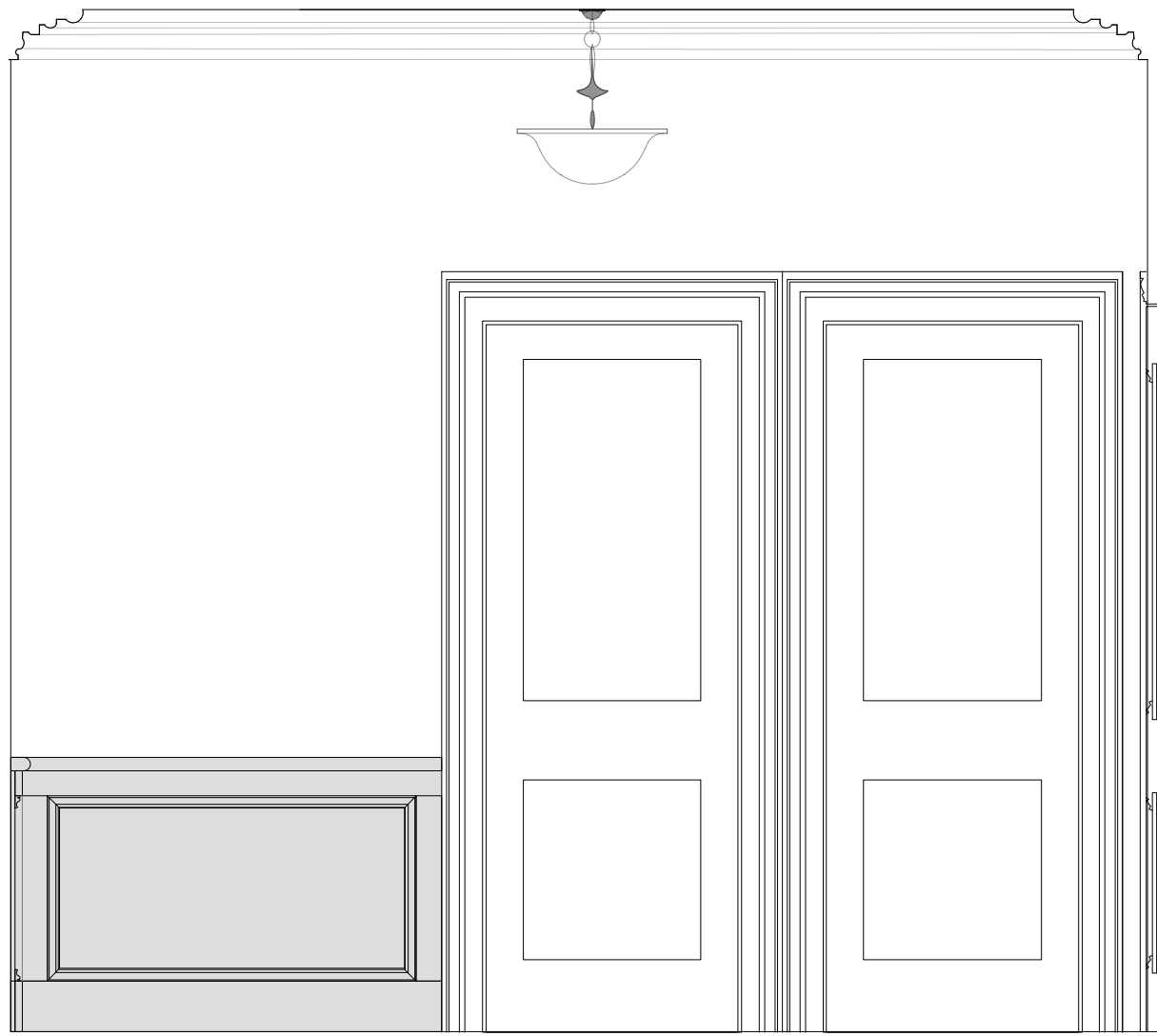

hazard: outline method statement

Interior  
minor dust hazards, removal of doorway infill  
using hand tools only to preserve lime plaster  
surrounding opening

refinishing of bath requires potential off-site removal  
note size and weight requires careful Risk Assessment  
and temporary protection for stairway walls and balustrade.  
On-site repolishing preferable if possible to mitigate risk  
to operatives and historic fabric.

Ensure no active decay is visible following intensive cleaning,  
use of fungicide to historic fabric requires preparation of RA  
in relation to PPE and ventilation.

bath side (window)

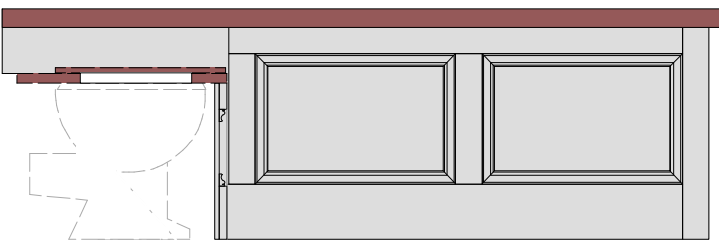
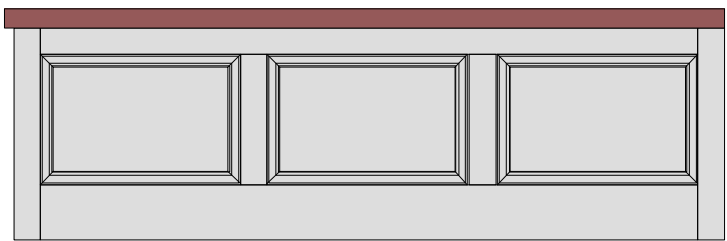

bath side (WC)

