

section AA

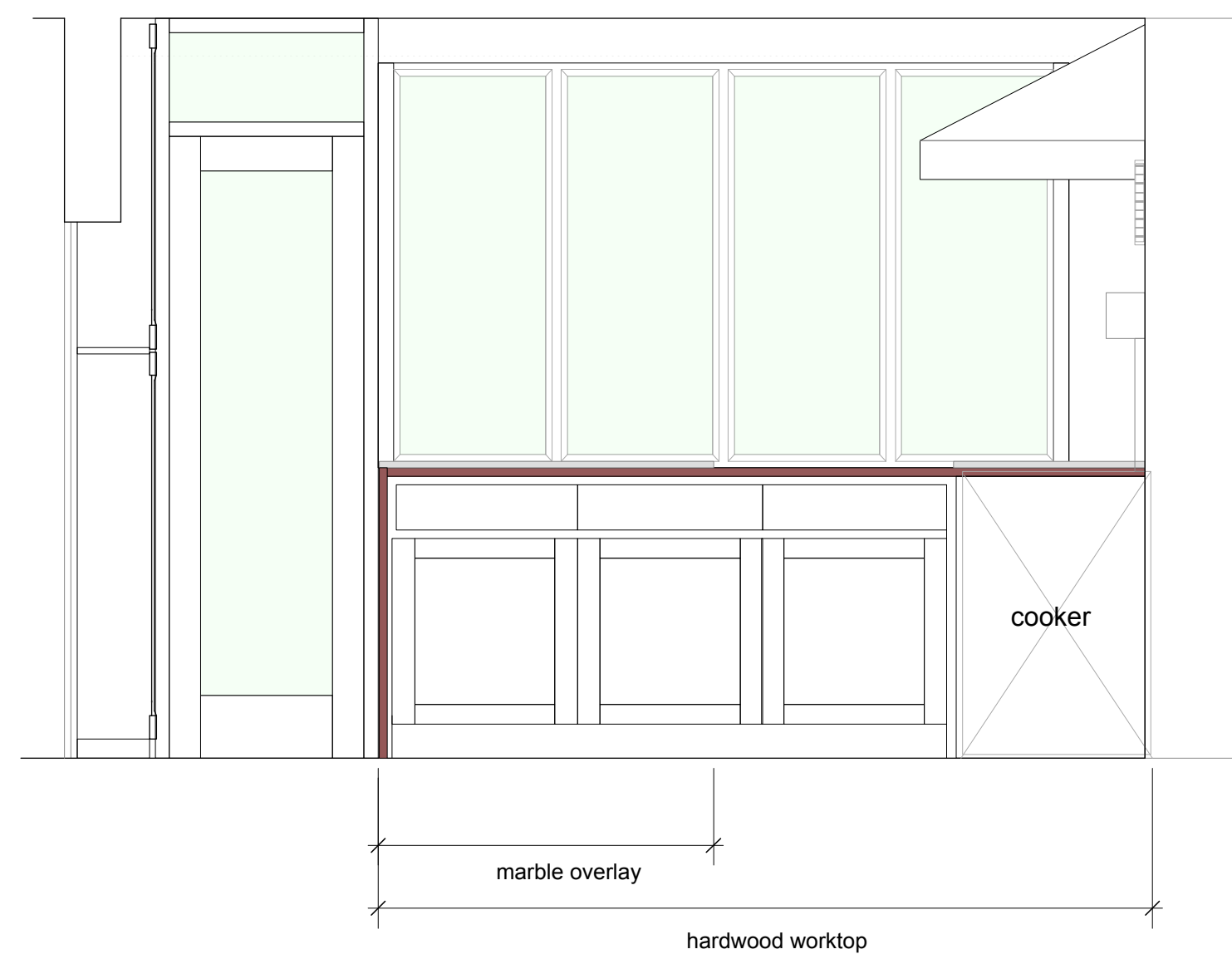

elevation A



elevation B



elevation C



kitchen infill photographed prior to unauthorized removals 2019

Note:

1. addition of glazed screen, arch infill door and cupboards documented by Alan Bennett as expedient installation to contain kitchen smells
2. dining room view showing expedient plywood infill
3. partly white painted timber joinery
4. no fire protection or compartmentation

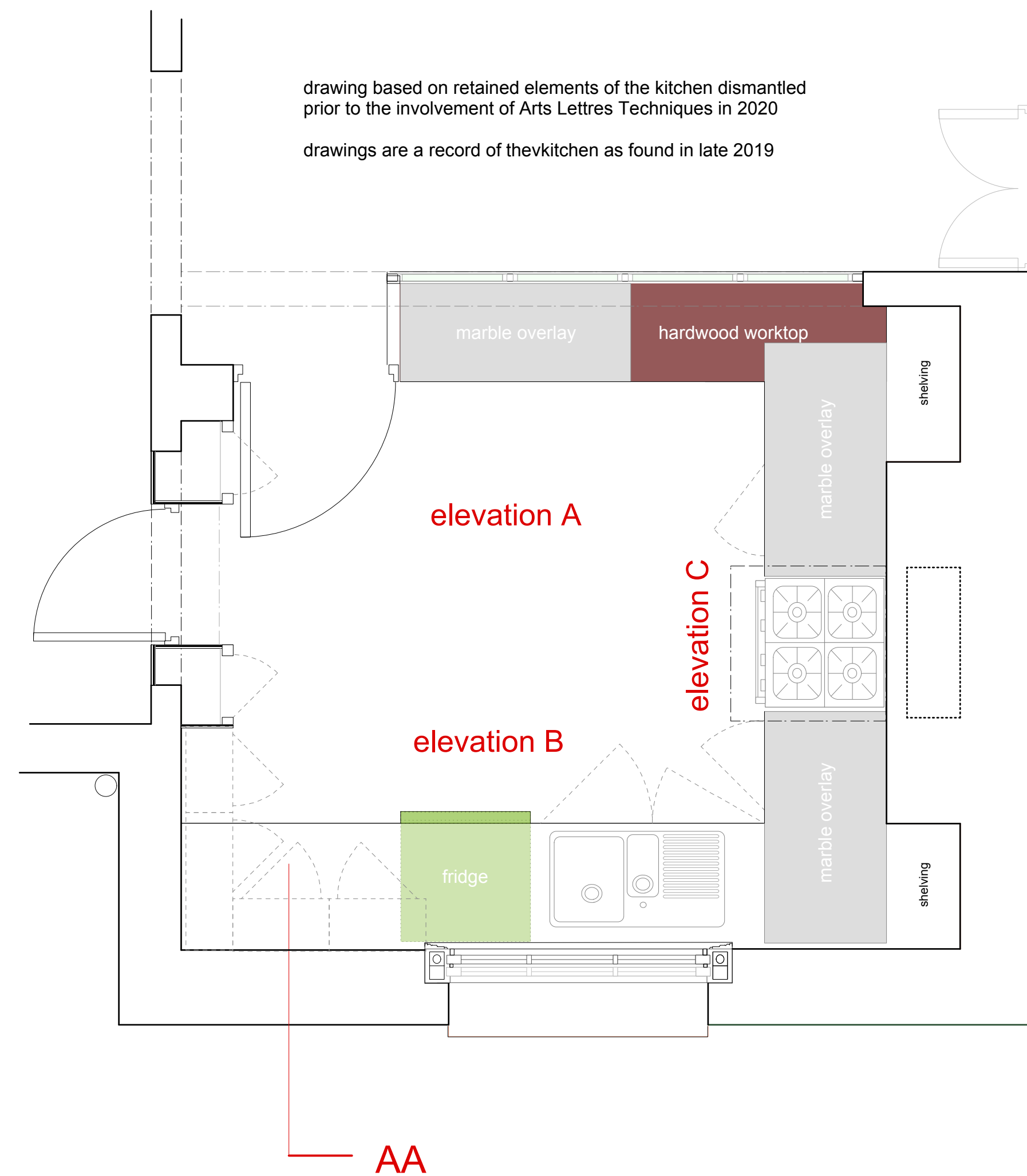

kitchen photographed prior to unauthorized removals 2019

Note:

1. replacement 2006+ 'Vola' style mixer tap with small double bowl sink
2. replacement white melamine sink worktop with two reclaimed hardwood worktops with Carrera marble overlay slabs
3. white painted timber joinery, omission of joinery adjacent to sink unit with modern green refrigerator
4. tiled walls c. 2006+ adjacent to gas cooker



kitchen photographed during Alan Bennett's residency est. 1990's

Note:

1. original 1969 mixer tap with stainless steel double bowl sink and drainer
2. reclaimed hardwood worktops throughout with reclaimed Carrera marble overlay slabs
3. stained natural timber joinery throughout
4. painted walls adjacent to gas cooker