

KEY

Existing to be removed Excavation

New walls

1 Proposed Section A
1:100 @ A3

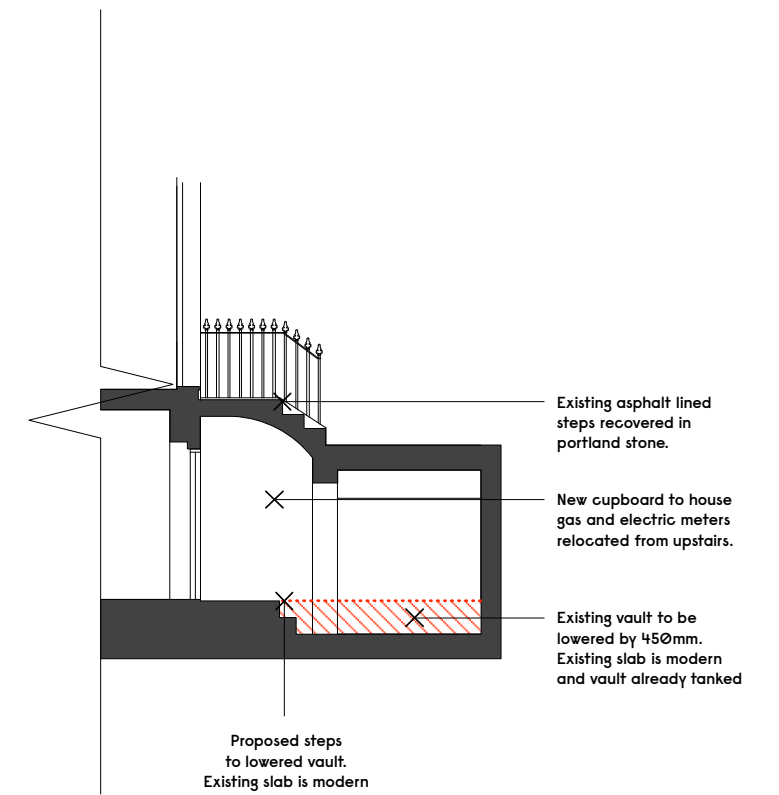

2 Proposed Section B
1:100 @ A3

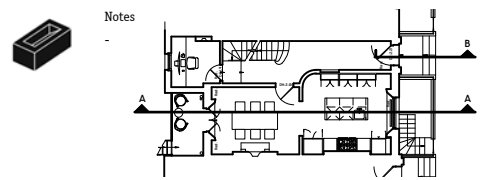
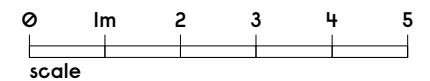

Revision	Date	Description

Gundry + Ducker
Gundry & Ducker Architecture Ltd
3 Garrick Street
London WC2E 9BF
t +44(0)203 417 4895
info@gundryducker.com

Project	3 Rothwell Street, London NW1 8YH		
Drawing title	Proposed Section A + B		
Scale	1:100 @ A3	Drwg. No.	Rev
Date	02/2020	405_GS_01	
Status	PROPOSED		

Do not scale. All dimensions to be confirmed on site.
Information contained in this drawing is the sole copyright of the designer and is not to be reproduced without permission.