

Notes

1. THE CONTRACTOR SHALL BE AWARE OF THEIR RESPONSIBILITIES WITH REGARD TO THE CONSTRUCTION (DESIGN AND MANAGEMENT) REGULATIONS AND SHALL UNDERTAKE THE DESIGN AND SUBSEQUENT INSTALLATION OF THESE SERVICES HAVING TAKEN DUE CONSIDERATION OF THESE REGULATIONS.
2. IN CONJUNCTION WITH THE INFORMATION DETAILED UPON THIS DRAWING THE CONTRACTOR SHALL FAMILIARISE THEMSELVES WITH ALL RELATED SERVICES AND TRADE DRAWINGS, SPECIFICATIONS AND SCHEDULES, ETC., ASSOCIATED WITH THESE WORKS. THIS SHALL INCLUDE, BUT NOT LIMITED TO, THE ELECTRICAL, MECHANICAL, PUBLIC HEALTH, ARCHITECTURAL AND STRUCTURAL WORKS.
3. THE CONTRACTOR SHALL FULLY COORDINATE ALL SERVICES USING THE COORDINATION AND INSTALLATION (WORKING) DRAWING PROCESS. THE CONTRACTOR SHALL COORDINATE WITH OTHER TRADES AND DISCIPLINES AND GENERAL COORDINATION WITH THE BUILDING FABRIC, STRUCTURE, ARCHITECTURAL FINISHES AND SPECIALIST TRADES.
4. INFORMATION AND DETAILS RELATING TO THIS DRAWING ARE FOR INFORMATION PURPOSES ONLY AND DO NOT CONSTITUTE THE EXTENT OF THE DESIGN INFORMATION OR ANY PART THEREOF. SIZES, DUTIES, RATINGS ETC. OF ANY PLANT OR EQUIPMENT DETAILED UPON THESE DRAWINGS ARE FOR GUIDANCE PURPOSES ONLY AND SHOULD BE CONFIRMED BY THE DESIGN AND BUILD CONTRACTOR.
5. THIS DRAWING IS NOT FOR CONSTRUCTION.

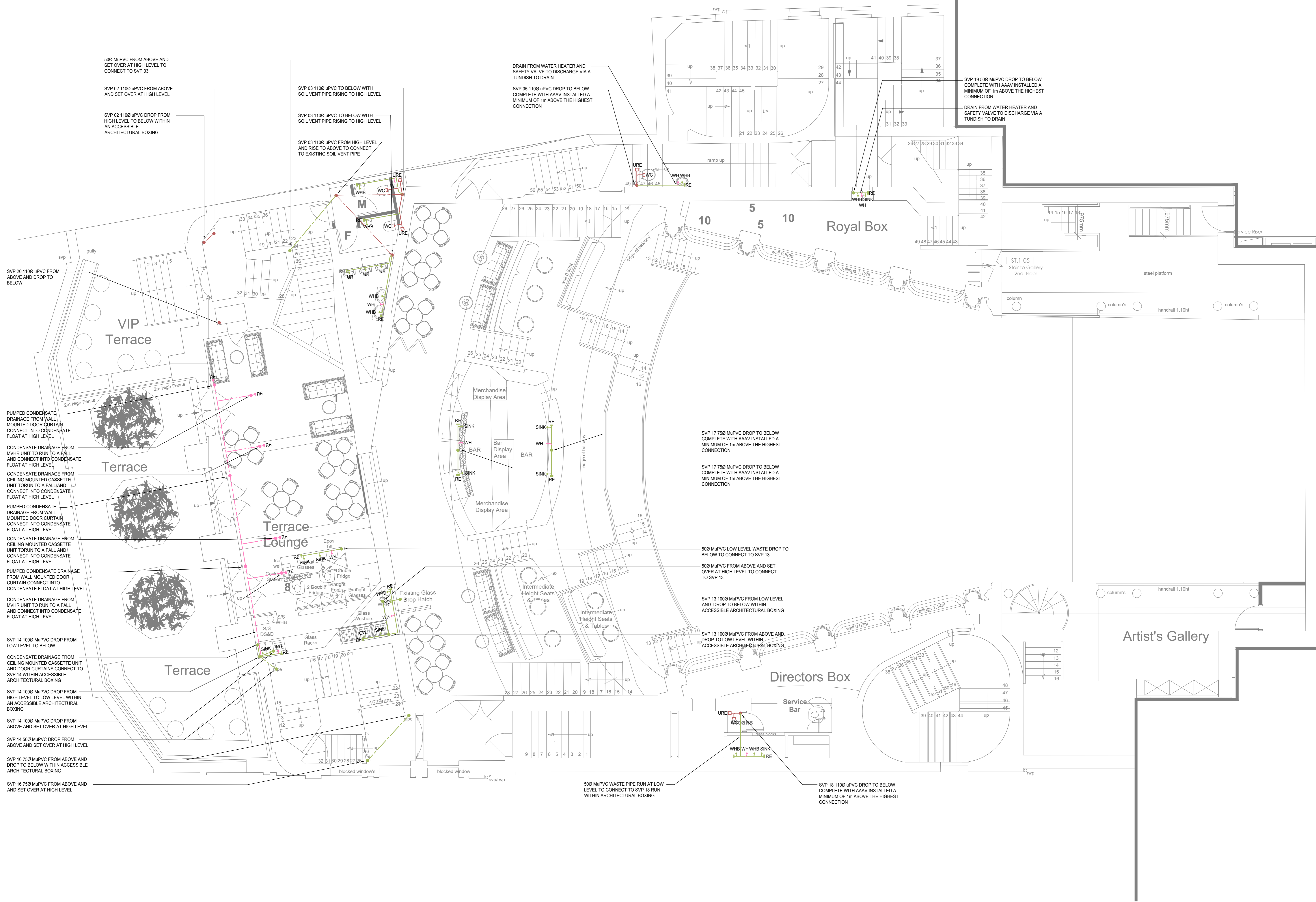

/ 18.09.2020 Stage 3 Issue	
Rev:	Date Details
Drawing Status	
STAGE 3	
Consulting Engineers Building Services	
SVM	
Berkhamstead	01442 869369
Architect	
Archer Humphryes Architects	
Structural Engineer	
Heyne Tillett Steel	
Quantity Surveyor	
Gardiner & Theobald LLP	
Project Name	
Koko Camden Palace	
Client	
The Mint Group	
Drawing Title	
First Floor Drainage Layout	
Scale	Date
1:50@A0	AUG 2020
Orig. By	Drawn By
KB	AL
Checked	Revision
CBD	/
Drawing Number	
3100.M6.130	