

Platform Lighting - Sheet 2 of 2
1 : 100

.MMD Lighting Column Schedule Setting out				
Mark	Comments	Height	Eastings	Northings
LC30	COL-L-0101 (6m)	6000	LG E 75843.006	LG N 39556.820
LC31	COL-L-0102 (6m)	6000	LG E 75856.982	LG N 39561.206
LC34	COL-L-0103 (6m)	6000	LG E 75874.062	LG N 39566.821
LC33	COL-L-0104 (6m)	6000	LG E 75886.303	LG N 39570.194
LC171	COL-L-0105 (4m)	4000	LG E 75891.675	LG N 39575.612
LC168	COL-L-0106 (4m)	4000	LG E 75899.941	LG N 39578.629
LC277	COL-L-0108 (4m)	4000	LG E 75920.882	LG N 39586.252
LC286	COL-L-0109 (4m)	4000	LG E 75934.496	LG N 39590.621
LC23	COL-L-0201 (6m)	6000	LG E 75827.54	LG N 39569.354
LC24	COL-L-0202 (6m)	6000	LG E 75840.712	LG N 39573.287
LC26	COL-L-0203 (6m)	6000	LG E 75856.399	LG N 39578.158
LC27	COL-L-0204 (6m)	6000	LG E 75869.807	LG N 39582.722
LC28	COL-L-0205 (6m)	6000	LG E 75881.800	LG N 39588.045
LC37	COL-L-0206 (4m)	4000	LG E 75888.879	LG N 39585.928
LC38	COL-L-0207 (4m)	4000	LG E 75896.524	LG N 39588.716
LC36	COL-L-0209 (6m)	6000	LG E 75914.401	LG N 39598.119

.MMD Lighting Column Schedule Setting out				
Mark	Comments	Height	Eastings	Northings
LC29	COL-L-0210 (6m)	6000	LG E 75922.540	LG N 39601.106
LC35	COL-L-0211 (6m)	6000	LG E 75935.190	LG N 39604.807
LC255	COL-L-0212 (5m)	5000	LG E 75933.120	LG N 39607.643
LC253	COL-L-0213 (5m)	5000	LG E 75913.622	LG N 39599.783
LC95	WHD-COL-S-0101	4500	LG E 75849.712	LG N 39558.921
LC110	WHD-COL-S-0102	4500	LG E 75866.692	LG N 39564.381
LC93	WHD-COL-S-0103	4500	LG E 75874.062	LG N 39566.821
LC90	WHD-COL-S-0201	4500	LG E 75833.043	LG N 39570.979
LC91	WHD-COL-S-0202	4500	LG E 75847.872	LG N 39575.498
LC226	WHD-COL-S-0203	4500	LG E 75861.406	LG N 39579.844
LC92	WHD-COL-S-0204	4500	LG E 75875.021	LG N 39585.169
LC116	WHD-COL-S-205	4500	LG E 75917.175	LG N 39599.154
LC111	WHD-COL-S-0206	4500	LG E 75931.221	LG N 39603.288
Grand total: 29				

Refer to lighting control schematics as follows:
 LSWH-EN31-ELL-DSC-BCK-00053 - Platform Indicative Lighting Control Schematic
 LSWH-EN31-ELL-DSC-BCK-00054 - Concourse Indicative Lighting Control Schematic (Sheet 1 of 2)
 LSWH-EN31-ELL-DSC-BCK-00055 - Concourse Indicative Lighting Control Schematic (Sheet 2 of 2)

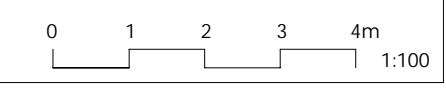
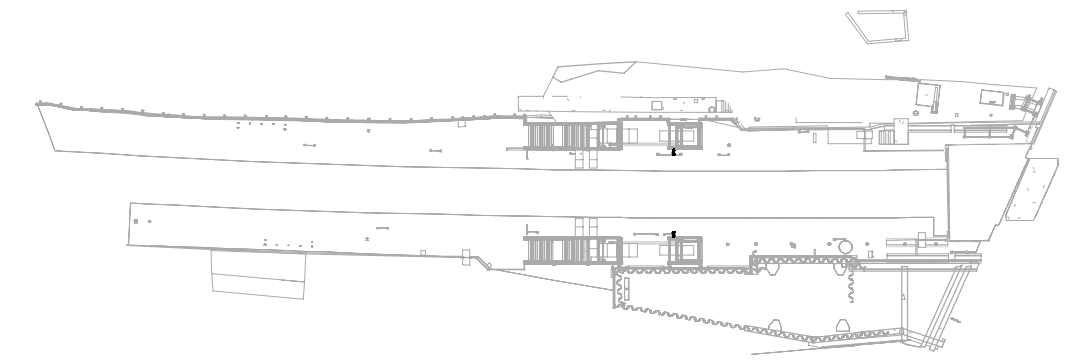

- NOTES - LEGEND:**
- All dimensions are in millimetres unless otherwise stated.
 - Do not scale any items or information from this drawing.
 - All works to be in accordance with BS7671 and Network Rail standards.
 - All lighting levels to be in accordance with Network Rail standards.
 - All equipment shall be suitable for the environment in which it is to be installed and installed in accordance with the manufacturers' recommendations.
 - All equipment shall be offered for approval of the engineer prior to installation.

- All exposed electrical containment systems to be fitted with covers fixed with vandal resistant fittings and fixings.
- This drawing is to be read in conjunction with West Hampstead Station Form B M&E (document ref: LSWH-EN31-EME-FOB-BCK-00051) and Form B addendum ref LSWH-EN31-EME-FOB-BCK-00052.
- This drawing is to be read in conjunction with the Mechanical and Electrical Specification.
- All platform lighting shall be controlled via a time switch and contactor arrangement.
- 50% of the general lighting is to be utilised for emergency lighting purposes. The luminaires designated for emergency use are to be back up with a BS 5266 central battery system. The wiring to these luminaires is to be FP 400.
- Contractor to liaise with supplier for required attachments.

<ul style="list-style-type: none"> ○ xx Recessed circular downlight (xx denotes type - see luminaire schedule) ○ xx Recessed circular spotlight (xx denotes type - see luminaire schedule) xx Recessed 600x600 luminaire (xx denotes type - see luminaire schedule) xx Column mounted luminaire (xx denotes type - see luminaire schedule) 	<ul style="list-style-type: none"> —○— Surface mounted linear luminaire ▭ Recessed linear luminaire ▭ Suspended linear luminaire ▭ Floodlight ▭ Distribution Board ▭ Single Phase Distribution Board ▭ Fire alarm beacons (not in service) F/A 	<ul style="list-style-type: none"> ○ Wall mounted luminaire ○ Recessed 200 x 200 luminaire ○ Xenon Beacon ○ Photocell ○ PIR ○ Lighting control module ○ LCM 	<ul style="list-style-type: none"> ○ lighting control switch n denotes number of gangs k denotes key switch to facilitate testing of the emergency luminaires M denotes key switch to isolate the luminaire for maintenance purposes ○ xx Bollard type external fitting (xx denotes type - see luminaire schedule) xx Illuminated hand rail lighting (xx denotes type - see luminaire schedule)
--	--	--	---

As built drawing prepared by Mott MacDonald based on information provided by Buckingham Contracting Group Ltd. Mott MacDonald accepts no liability for the accuracies and completeness of this drawing

COORDINATES TO LONDON SURVEY GRID PROJECT LEVEL DATUM IS 100 METRES BELOW NEWLYN DATUM		© CROWN COPYRIGHT AND DATABASE RIGHTS - 2012 ORDNANCE SURVEY - 100039971		DO NOT SCALE DISTORTION CAN OCCUR		TIL - CAD COMPLIANCE CHECK PASS or FAIL		PROJECT: LONDON OVERGROUND LOSTAT West Hampstead Station Redevelopment	
DATE: 14/02/20 TIME: As Built		PK BY: Z01 RC: As Built HT: DATE: 14/02/20 NM: APP:		NAME: P KENNY DATE: 11/11/19 CHECKED BY: R COLOMBY DATE: 11/11/19 DESIGNED BY: A DOWELL DATE: 11/11/19 APPROVED BY: H THOMAS DATE: 11/11/19		TITLE: PLATFORM LEVEL LIGHTING LAYOUT SHEET 2 OF 2 ELM: BOK2 MILEAGE: 2m 75ch DRAWING SHEET SIZE = A1 SCALE: 1:100		SUITABILITY: AB Z01 REVISION	
USER: A Dowell FILE: MMD-S66279-S-403-00-XX-V2016.rvt		LONDON OVERGROUND		DRAWING NUMBER: LSWH-EN31-ELL-DGA-BCK-00052		LONDON OVERGROUND		DRAWING NUMBER: LSWH-EN31-ELL-DGA-BCK-00052	