

O.S. Copyright Disclaimer Here...

This drawing should not be relied on or used in circumstances other than those for which it was originally prepared and for which Sweco was commissioned. Sweco accepts no responsibility for this drawing to any party other than the person by whom it was commissioned. This drawing has been prepared for the limited project or named part thereof and should not be relied upon or used for any other project without an independent check being carried out as to its suitability and price written authority of Sweco being obtained. Sweco accepts no responsibility or liability for the consequences of this drawing being used for a purpose other than those for which it was commissioned. Any person using or relying on this drawing for such other purpose agrees, and will by such use or reliance be taken to confirm his agreement, to indemnify Sweco for all loss or damage resulting therefrom.

KEY:

- ARTIFICIAL STONE PAVING
- GRANITE SETTS
- BUFF / RED TACTILE BLISTER PAVING
- GRANITE KERB
- OTHER EXISTING FEATURES
- BOLLARD
- BOLLARD
- PROPOSED GULLY
- EXTENTS OF NEWLY LAID FOOTWAY
- ROAD MARKINGS (newly laid)
- DOUBLE YELLOW MARKINGS
- SINGLE YELLOW MARKINGS
- HIGHWAY BOUNDARY
- BUILDING LINE
- ENERGY CENTRE CONNECTION (indicative)
- HIGHWAY LEVEL
- HIGHWAY LEVEL IN ABEYANCE
- EXISTING HIGHWAY LEVEL
- MAIL RAIL ENTRANCE
- POSTAL MUSEUM ENTRANCE
- ACCESS TO THE WALK
- ACCESS TO FUTURE DEVELOPMENT
- LIGHTING COLUMN

Current Issue Information:

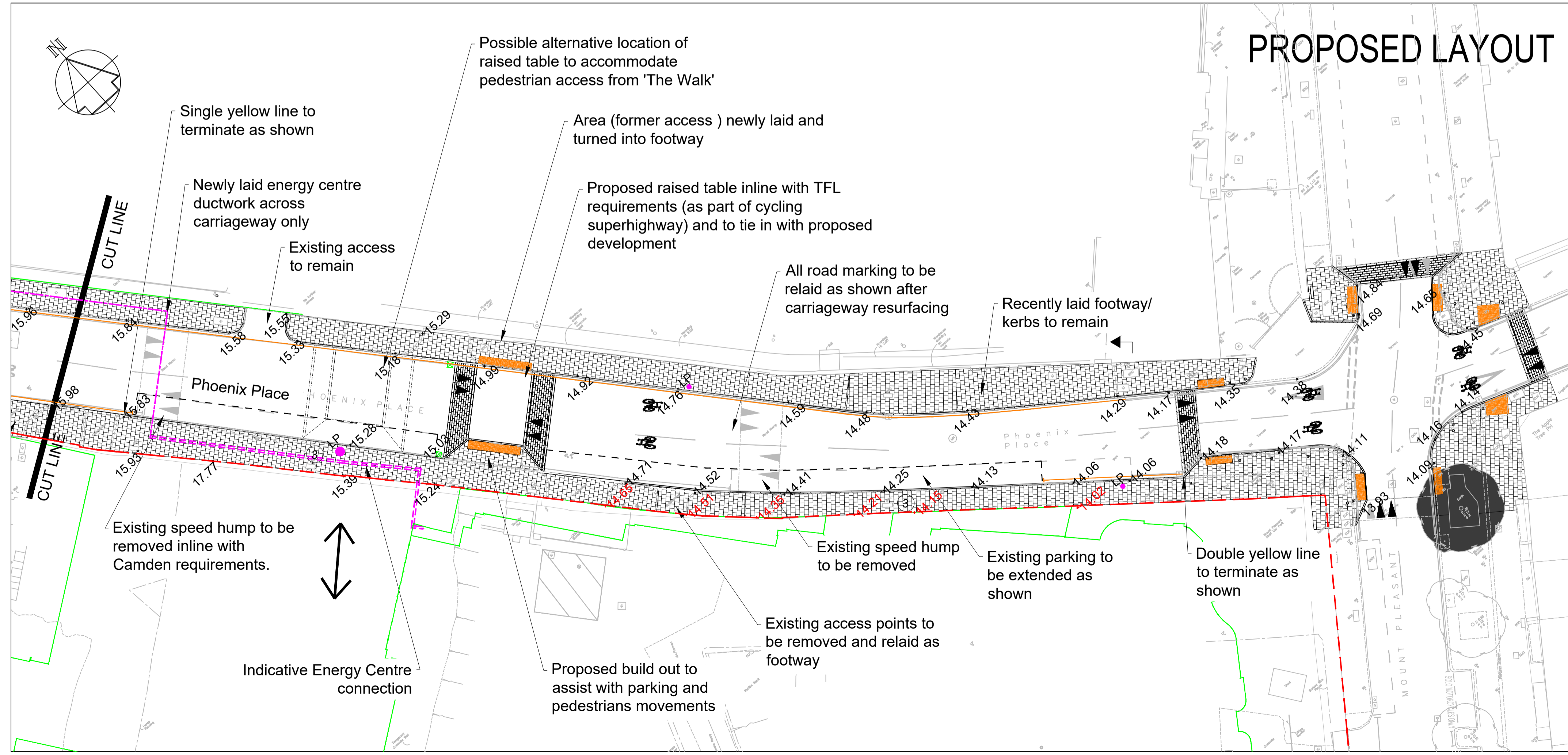

PROPOSED LAYOUT

- COMMENTS:**
- PROPOSED RAISED TABLE LOCATED TO ACCOMMODATE PEDESTRIAN MOVEMENTS. CONSIDERATION WILL NEED TO BE GIVEN TO DRAINAGE REQUIREMENTS. TBC.
 - ZEBRA CROSSING RELOCATED AS SHOWN. TACTILES TO BE IN LINE WITH CAMDEN REQUIREMENTS TO FACILITATE SHARED SPACE
 - HIGHWAY LEVELS THE HIGHWAY LEVELS ARE ASSUMED TO REMAIN AS EXISTING ALTHOUGH THOSE ALONG THE HIGHWAY BOUNDARY ARE IN ABEYANCE SUBJECT TO CAMDENS APPROVAL AND WILL NEED TO BE CONFIRMED AT DESIGN STAGE.

- NOTES:**
- ALL DIMENSIONS ARE IN METRES UNLESS OTHERWISE STATED.
 - DO NOT SCALE FROM THE DRAWING.
 - SWECO TAKES NO RESPONSIBILITY FOR THE ACCURACY OR COMPLETENESS OF INFORMATION SUPPLIED BY OTHERS.
 - EXTENT OF PROPOSED HIGHWAY WORKS SHOWN IS INDICATIVE ONLY, AND ASSOCIATED WORKS WILL BE REQUIRED OUTSIDE OF THE AREA SHOWN. EXISTING FOOTPATH UTILITY DEPTHS TO BE ESTABLISHED BY OTHERS
 - ALL PROPOSED MATERIALS ARE SUBJECT TO CAMDEN APPROVAL
 - ALL SIGNAGE TO BE REVIEWED IN LINE WITH HIGHWAY/TRO PROPOSALS.
 - INDICATIVE ENERGY CENTRE CONNECTION SUBJECT TO UNDERGROUND UTILITIES
 - GIVE WAY TRIANGLES HAVE BEEN REMOVED AS CURRENT PROPOSALS DO NOT REFLECT CURRENT STANDARDS FOR DISTANCE AND SIZE. TBC BY CAMDEN.
 - ALL MARKINGS TO BE REFRESHED AFTER CARRIAGWAY WORKS TO MATCH EXISTING UNLESS OTHERWISE STATED.

NO.	DESCRIPTION	DATE

SWECO
Harrover House
Queen Charlotte Street
Bristol
BS1 4EX
Tel: +44 (0)117 332 1100
www.sweco.co.uk

SWECO

Bristol . Cardiff . Edinburgh . Glasgow . Leeds . London
Maidenhead . Manchester . Newcastle . Peterborough . Solihull

CLIENT
TAYLOR WIMPEY CENTRAL LONDON

PROJECT
PHOENIX PLACE DEVELOPMENT

TITLE
PRELIMINARY DESIGN PHOENIX PLACE

STATUS
FOR INFORMATION

ORIGINATED	DRAWN	CHECKED	APPROVED

DATE	DATE	DATE	DATE

DRAWING SCALE @ A1: 1:250 ORIGINAL DRAWING SIZE: A1 - 841x594

DRAWING No: **119508-TP-MP-0003-2** REV: **0A**