



ARBORICULTURAL IMPACT ASSESSMENT REPORT FOR:

8 Inglewood Road
London
NW6 1QZ

INSTRUCTING PARTY:

lungo Studio
The Albion
102 Blundell Street
London
N7 9BL

REPORT PREPARED BY

Adam Hollis
MSc ARB MICFor FArbor A MRICS C Env

Ref: IGS/8IWR/AIA/01

Date: 3rd August 2020

The content and format of this report are for the exclusive use of the client in planning. It may not be sold, lent, hired out or divulged to any third party, not directly involved in the subject matter without Landmark Trees' written consent. This report is a draft copy intended for internal purposes only. Subject to client approval and invoice settlement, an external copy will be issued.

Web: www.landmarktrees.co.uk
e-mail: info@landmarktrees.co.uk
Tel: 0207 851 4544



London Office: Holden House, 4th Floor, 57 Rathbone Place London W1T 1JU

Registered Office: 15 Abbey Road, Oxford OX2 0AD

Landmark Trees is the trading name of Landmark trees Ltd. Registered in Wales. Reg No. 3882076



PART 1: MAIN TEXT

Section	Content	Page N°
1.0	SUMMARY	3
2.0	INTRODUCTION	4
3.0	SITE CHARACTERISTICS	8
4.0	DEVELOPMENT CONSTRAINTS	12
5.0	TABLE OF IMPACTS	15
6.0	ARBORICULTURAL IMPLICATIONS	16
7.0	CONCLUSION	17
8.0	RECOMMENDATIONS	18
9.0	COMPLIANCE	21
10.0	REFERENCES	22

PART 2 - APPENDICES

APPENDIX 1	Survey Data	25
APPENDIX 2	Trial Pit Findings	27

PART 3 - PLANS

PLAN 1	Tree Constraints Plan	33
PLAN 2	Impact Assessment Plan(s)	35

DOCUMENT HISTORY

Revision	Status	Comments	Date
Rev 0	Approved	For Full Application	

1. SUMMARY

- 1.1 The existing site is a residential property with large rear garden containing one tree that potentially constrains development. The proposal includes a basement extension into the rear garden.
- 1.2 There are 3 trees on the property and adjoining land outside of the application boundary that are within close proximity to the development and need to be assessed. 2 of these are judged as being of low quality with the third being moderate quality.
- 1.3 The report has assessed the impacts of the development proposals and concludes there would be at most a very low impact on the resource: no tree removal or pruning is necessary and a trial pit excavated found no rooting at the outer line of the proposed basement.
- 1.4 Notwithstanding the above assurances, the report sets out a series of recommendations prior and during construction that will ensure impacts to trees are minimised. These are detailed in sections 6.3 and 8 of this report.
- 1.5 In conclusion, the proposal, through following the above recommendations, will have no, or very limited, impact on the existing trees and is acceptable.

* British Standards Institute: Trees in relation to design, demolition and construction BS 5837: 2012 HMSO, London

2. INTRODUCTION

2.1 Terms of Reference

- 2.1.1 This Arboricultural Impact Assessment report has been prepared by Landmark Trees (LT) on behalf of lungo Studio (the Applicant's agent), to support a full planning application submitted to the London Borough of Camden ('LBC').
- 2.1.2 The application relates to the formation of a basement extension that extends into the rear garden.
- 2.1.3 This report will assess the impact on trees and their constraints, identified in our survey. Although the proposals were known at the time of the survey, Landmark Trees endeavour to survey each site blind, working from a topographical survey, wherever possible, with the constraints plan informing their evolution. The purpose of the report is to provide guidance on how trees and other vegetation can be integrated into construction and development design schemes. The overall aim is to ensure the protection of amenity by trees which are appropriate for retention.
- 2.1.4 Trees are a material consideration for a Local Planning Authority when determining planning applications, whether or not they are afforded the statutory protection of a Tree Preservation Order or Conservation Area. British Standard BS 5837:2012 Trees in Relation to Design, Demolition and Construction sets out the principles and procedures to be applied to achieve a harmonious and sustainable relationship between trees and new developments. The Standard recommends a sequence of activities (see Fig.1 overleaf) that starts in the initial feasibility and design phase (RIBA Stage 2 'Concept Design') with a survey to qualify and quantify the trees on site and establish the arboricultural constraints to development (above- and below-ground) to inform the design in an iterative process, and continues with an assessment of the arboricultural impacts of the final design and measures to mitigate such impacts should they be negative. Detailed technical specifications for mitigation and protection measures are devised in the design phase that follows (RIBA Stage 3-4 'Developed and Technical design'), and the sequence ends with the Implementation and Aftercare phase (RIBA Stages 5-7) with the implementation of those measures once planning permission is granted, guided by Arboricultural Method Statements (RIBA Stage 4-5, 'Technical Design and Construction) and professional guidance where appropriate.
- 2.1.5 **This report is produced to support the Design Team to the Scheme Design Approvals stage in the process chart overleaf.**

Figure 1 The design and construction process and tree care

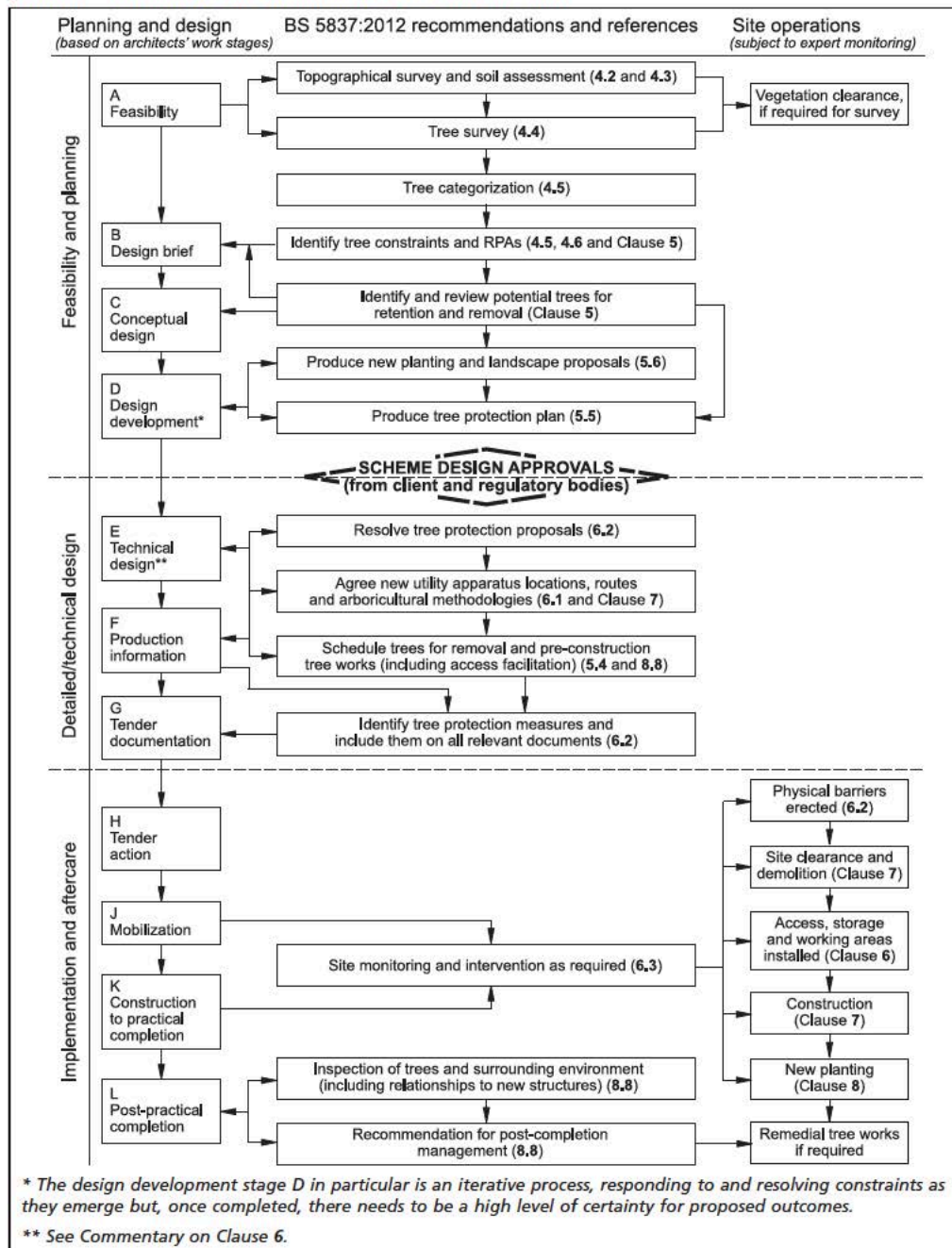

2.2 Drawings Supplied

2.2.1 The drawings supplied by the client and relied upon by Landmark Trees in the formulation of our survey plans are:

Existing site survey: Existing plans

Proposals: 046(P)021 Lower Ground Floor (B)

2.3 Scope & Limitations of Survey

2.3.1 As Landmark Trees' (LT) arboricultural consultant, I surveyed the trees on site on 14th July 2020, recording relevant qualitative data in order to assess both their suitability for retention and their constraints upon the site, in accordance with British Standard 5837:2012 Trees in relation to design, demolition and construction – Recommendations [BS5837:2012].

2.3.2 Our survey of the trees, the soils and any other factors, is of a preliminary nature. The trees were SURVEYED on the basis of the Visual Tree Assessment method expounded by Mattheck and Breloer (The Body Language of Trees, DoE booklet Research for Amenity Trees No. 4, 1994). LT have not taken any samples for analysis and the trees were not climbed but inspected from ground level.

2.3.3 The results of the tree survey, including material constraints arising from existing trees that merit retention, should be used (along with any other relevant baseline data) to inform feasibility studies and design options. For this reason, the tree survey should be completed and made available to designers prior to and/or independently of any specific proposals for development. Tree surveys undertaken after a detailed design has been prepared can identify significant conflicts: in such cases, the nature of and need for the proposed development should be set against the quality and values of affected trees. The extent to which the design can be modified to accommodate those trees meriting retention should be carefully considered. Where proposed development is subject to planning control, a tree survey should be regarded as an important part of the evidence base underpinning the design and access statement

2.3.3 A tree survey is generally considered invalid in planning terms after 2 years, but changes in tree condition may occur at any time, particularly after acute (e.g. storm events) or prolonged (e.g. drought) environmental stresses or injuries (e.g. root severance). Routine surveys at different times of the year and within two - three years of each other (subject to the incidence of the above stresses) are recommended for the health and safety management of trees remote from highways or busy access routes. Annual surveys are recommended for the latter.

2.3.4 The survey does not cover the arrangements that may be required in connection with the laying or removal of underground services.

2.4 Survey Data & Report Layout

- 2.4.1 Detailed records of individual trees are given in the survey schedule in Appendix 1.
- 2.4.2 A site plan identifying the surveyed trees, based on the Instructing Party's drawings / topographical survey is provided in Part 3 of this report. This plan also serves as the Tree Constraints Plan with the theoretical Recommended Protection Areas (RPA's), tree canopies and shade constraints, (from BS5837: 2012) overlain onto it. These constraints are then overlain in turn onto the Instructing Party's proposals to create a second Arboricultural Impact Assessment Plan in Part 3. General observations, discussion, conclusions and recommendations follow, below.

3.0 SITE CHARACTERISTICS

3.1 Property Description & Planning Context



Photograph 1: Aerial view of application site (Source: Google Earth)

- | | |
|-------|-----------------------------------------------------------------------------------------------------------------------------------------------------------------------------------------------------------------------------------------------------------------------------------------------|
| 3.1.1 | This property is located on the north side of Inglewood Road and comprises a terraced dwelling with an existing basement level. |
| 3.1.2 | The site is relatively flat throughout although there are a number of existing level changes in line with the built form. |
| 3.1.3 | We are not aware of the existence of any Tree Preservation Orders, but understand the site stands within the West End Green Conservation Area, which will affect the subject trees: it is a criminal offence to prune, damage or fell such trees without permission from the local authority. |
| 3.1.4 | Relevant local planning policies comprise Policy 7.21 of the London Plan 2016 and Policies A3, A5, D1 and D2 of the Camden Local Plan (adopted 3rd July 2017). |

3.2 Soil Description

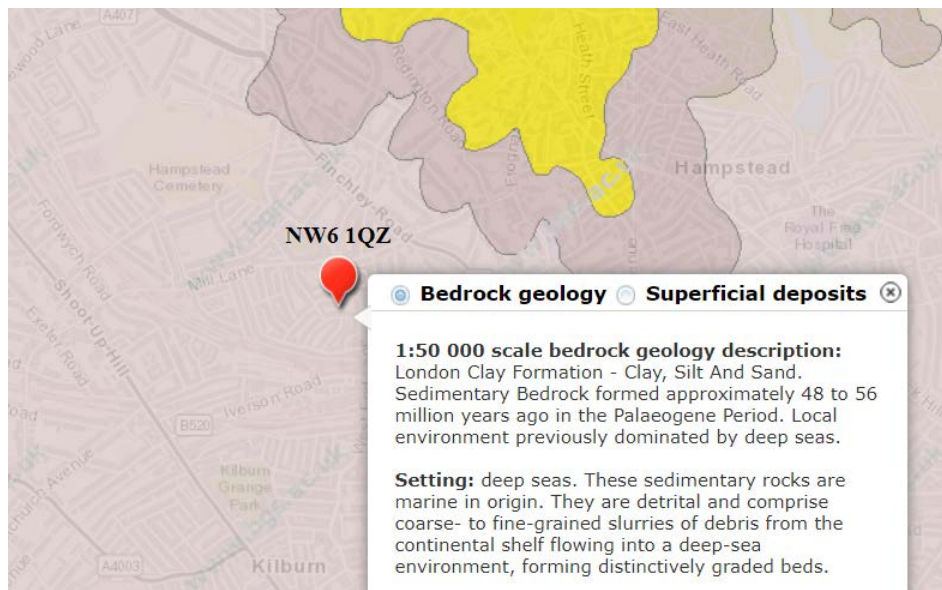

Figure 2: Extract from the BGS Geology of Britain Viewer

- 3.2.1 In terms of the British Geological Survey, the site overlies the London Clay Formation (see indicated location on Fig.1 plan extract above). The associated soils are generally, highly shrinkable clay; e.g. slowly permeable seasonally waterlogged fine loam over clay. Such highly plastic soils are prone to movement: subsidence and heave. The actual distribution of the soil series are not as clearly defined on the ground as on plan and there may be anomalies in the actual composition of clay, silt and sand content.
- 3.2.2 Clay soils are prone to compaction during development with damage to soil structure potentially having a serious impact on tree health. The design of foundations near problematic tree species will also need to take into consideration subsidence risk. Further advice from the relevant experts on the specific soil properties can be sought as necessary.

3.3 Subject Trees

- 3.3.1 Three trees were surveyed on and adjacent to the site, a mature, moderate quality sycamore standing in a small raised bed within the rear garden of the application site, a mature, low quality sycamore standing in the rear garden of the neighbouring property to the west and a mature, low quality pollarded Portuguese laurel that stands in the pavement in front of No. 8 Inglewood Road.

*page 9 of: [British Standards Institute: Trees in relation to design, demolition and construction BS 5837: 2012 HMSO, London](#)

- 3.2.4 Full details of the surveyed trees can be found in Appendix 1 of this report.



Photograph 2: Level changes within rear garden of application site



Photograph 3: T2 also growing in small raised bed



Photograph 4: Street tree T3

4.0 DEVELOPMENT CONSTRAINTS

4.1 Primary Constraints

- 4.1.1 A tree's primary constraint on development is the physical space it occupies or requires above and below ground on a given site. The current canopy spreads and heights are noted in our survey; allowance for further growth and broader aspects of juxtaposition are considered under secondary impacts below. With regard to root spread, BS5837 defines the Root Protection Area (RPA) as a layout design tool indicating the minimum area around a tree deemed to contain sufficient roots and rooting volume to maintain the tree's viability, and where the protection of the roots and soil structure is treated as a priority.
- 4.1.2 The individual RPA's are calculated in the Tree Schedule in Appendix 1 to this report, or rather the notional radius of that RPA, based on a circular protection zone. The prescribed radius is 12-x stem diameter at 1.5m above ground level, except where composite formulae are used in the case of multi-stemmed trees.
- 4.1.3 Circular RPA's are appropriate for individual specimen trees grown freely, but where there is ground disturbance, the morphology of the RPA can be modified to an alternative polygon, as shown in the diagram below (Figure 2). Alternatively, one need principally remember that RPA's are area-based and not linear – notional rather than fixed entities.

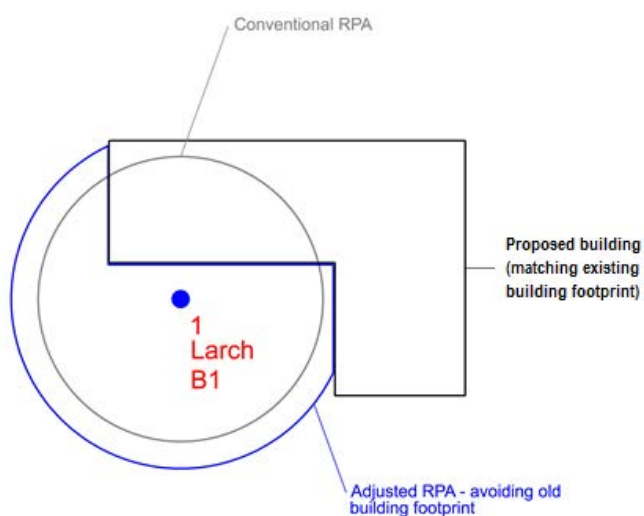

Figure 3– Generic BS 5837 RPA Adjustments (for fictitious site)

- 4.1.4 In BS5837, paragraph 4.6.2 states that RPA's should reflect the morphology and disposition of the roots; where pre-existing site conditions or other factors indicate that rooting has occurred asymmetrically, a polygon of equivalent area should be produced. Modifications to the shape of the RPA should reflect a soundly based arboricultural assessment of likely root distribution.

4.1.5 **No *a priori* modifications have been made in this instance as it is far from clear where T1 and T2 will be preferentially rooting given the level changes and existing built form around them. In any case, the precise distribution of these RPAs is rendered somewhat moot by the trial pit findings detailed in Appendix 2 which show no rooting at the outer line of the development footprint.**

4.1.6 In addition to these quantitative assessments, the quality of trees will also be a consideration: Category U trees are discounted from the planning process in view of their limited service life. Again, Category C trees would not normally prevent development individually, unless they provide some particular (screening) function. Nonetheless, they remain material constraints.

4.1.7 At paragraph 5.1.1. BS5837: 2012 notes that “Care should be exercised over misplaced tree preservation; attempts to retain too many or unsuitable trees on a site are liable to result in excessive pressure on the trees during demolition or construction work, or post-completion demands on their removal.”

4.1.7 Only moderate quality trees and above are significant material constraints on development. However, low quality trees comprise a constraint in aggregate, in terms of any collective loss / removal, where replacement planting is generally considered appropriate.

4.1.8 In this instance, the aforementioned trial pit findings demonstrate the moderate quality T1 poses no direct constraint to these proposals.

4.2 Secondary Constraints

4.2.1 The second type of constraint produced by trees that are to be retained is that the proximity of the proposed development to the trees should not threaten their future with ever increasing demands for tree surgery or felling to remove nuisance shading (Figure 3), honeydew deposition or perceived risk of harm.

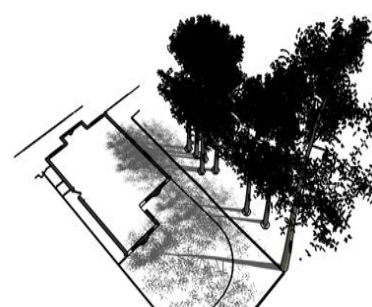
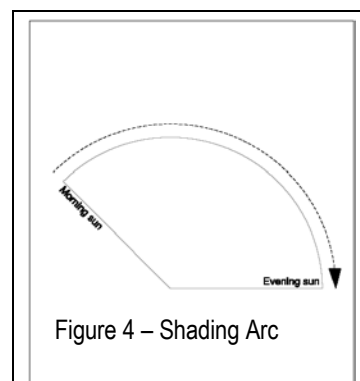

Figure 3 –
Generic Shading Constraints

4.2.2 The shading constraints are crudely determined from BS5837 by drawing an arc from northwest to east of the stem base at a distance equal to the height of the tree, as shown in the diagram opposite. Shade is less of a constraint on non-residential developments, particularly where rooms are only ever temporarily occupied.



4.2.3 This arc (see Figure 4) represents the effects that a tree will have on layout through shade, based on shadow patterns of 1x tree height for a period May to Sept inclusive 10.00-18.00 hrs daily.

4.2.4 Assuming that they will be retained, the orientation of the on- and off-site trees will ensure that shading constraints are minimal, with leaf deposition and honey-dew likely to be as it is today. The significance of these constraints will vary depending on the location and proximity to the proposed re-development which is considered below (in Sections 5 & 6). As specified by BS5837, this section (4) of the report considers only the site as it is, not in the light of pending proposals.

Note: Sections 5 & 6 below will now assess the impacts of the proposals upon constraints identified in Section 4 above. Table 1 in Section 5 presents the impacts in tabular form (drawing upon survey data presented in Appendices 1 & 2). Impacts are presented in terms of whole tree removal and the effect on the landscape or partial encroachment (% of RPA) and its effect on individual tree health. Section 6 discusses the table data, elaborating upon the impacts' significance and mitigation.

Table 1: Arboricultural Impact Assessment

(Impacts assessed prior to mitigation and rated with reference to Matheny & Clark (1998))

Ref: IGS_8IWR_AIA

B.S. Cat.	Tree No.	Species	Impact	Tree / RPA Affected	Age	Growth Vitality	Species Tolerance	Impact on Tree Rating	Impact on Site Rating	Mitigation
B	1	Sycamore	Basement Construction adjacent to RPA Construction Activities within RPA	m ² N/A %	Mature	Normal	Moderate	Very Low	Very Low	Hand dig top 750mm of basement line thro' RPA Ground protection

6.0 ARBORICULTURAL IMPLICATIONS

6.1 Rating of Primary Impacts

- 6.1.1 Whilst the proposed basement footprint is outside the conventional circular RPA of T1, it is unclear how accurate a depiction of the likely priority area to protect that represents. Accordingly, a trial pit was excavated in the location detailed in Appendix 2. This trial pit found only minor rooting of sub-10mm diameter and we therefore conclude that the proposed development footprint does not comprise a priority area to protect.
- 6.1.2 This assessment obviates the need to provide compensatory areas of RPA to replace those lost to encroachment and also the need to improve the soil environment that is used by the tree for growth.
- 6.1.3 In our view the tree is of a species, age and condition sufficient to remain viable in the circumstances, provided the series of mitigation measures outlined below are followed to reduce the immediate impact of working. Supervision and monitoring of such measures will also be essential. Subject to these provisos the net impacts are assessed as being very low.

6.2 Rating of Secondary Impacts

- 6.2.1 The subterranean nature of the proposals renders assessment of secondary impacts moot.

6.3 Mitigation of Impacts

- 6.3.1 The outer line of the basement foundations closest to T1 will be manually excavated to 750mm depth under arboricultural supervision; any roots encountered within the trenches / pits will be cleanly pruned back to an appropriate junction with a sharp pruning saw or secateurs back to a junction. Roots larger than 25mm diameter may only be cut in consultation with an arboriculturalist.

7.0 CONCLUSION

- 7.1 The potential impacts of development are very low with no tree removal necessary and no RPA encroachments of trees retained.
- 7.2 The potential wider construction impacts of the proposals can thus be largely mitigated through design and precautionary measures. These measures can be elaborated in Method Statements in the discharge of planning conditions.
- 7.3 The species affected are generally tolerant of root disturbance / crown reduction and the retained trees are generally in good health and capable of sustaining these reduced impacts.
- 7.4 Therefore, the proposals will not have any significant impact on either the retained trees or wider landscape thereby complying with Policy 7.21 of the London Plan 2016 and Policies A3, A5, D1 and D2 of the Camden Local Plan (adopted 3rd July 2017). Thus, with suitable mitigation and supervision the scheme is recommended to planning.

8.0 RECOMMENDATIONS

8.1 Specific Recommendations

8.1.1 Excavation and construction impacts within the RPA's of trees identified in Table 1 above, will need to be controlled by method statements specifying mitigation methods suggested in para 6.3 above and by consultant supervision as necessary. These method statements can be provided as part of the discharge of conditions.

8.2 General Recommendations for Sites Being Developed with Trees

8.2.1 Any trees which are in close proximity to the proposed development should be protected with a Tree Protection Barrier (TPB). Protective barrier fencing should be installed immediately following the completion of the tree works, remaining in situ for the entire duration of the development unless otherwise agreed in writing by the Council. It should be appropriate for the intensity and proximity of the development, usually comprising steel, mesh panels 2.4m in height ('Heras') and should be mounted on a scaffolding frame (shown in Fig 2 of BS5837:2012). The position of the TPB can be shown on plan as part of the discharge of conditions, once the layout is agreed with the planning authority. The TPB should be erected prior to commencement of works, remain in its original form on-site for the duration of works and be removed only upon full completion of works.

8.2.2 A TPB may no longer be required during soft landscaping work but a full arboricultural assessment must be performed prior to the undertaking of any excavations within the RPA of a tree. This will inform a decision about the requirement of protection measures. It is important that all TPBs have permanent, weatherproof notices denying access to the RPA.

8.2.3 The use of heavy plant machinery for building demolition, removal of imported materials and grading of surfaces should take place in one operation. The necessary machinery should be located above the existing grade level and work away from any retained trees. This will ensure that any spoil is removed from the RPAs. It is vital that the original soil level is not lowered as this is likely to cause damage to the shallow root systems.

8.2.4 Any pruning works must be in accordance with British Standard 3998:2010 Tree work [BS3998].

8.2.5 Where sections of hard surfacing are proposed in close proximity to trees, it is recommended that "No-Dig" surfacing be employed in accordance with BS5837:2012 and 'The Principles of Arboricultural Practice: Note 1, Driveways Close to Trees, AAIS 1996 [APN1]'.

8.2.6 If the RPA of a tree is encroached by underground service routes then BS5837:2012 and NJUG VOLUME 4 provisions should be employed. If it is deemed necessary, further arboricultural advice must be sought.

- 8.2.7 Numerous site activities are potentially damaging to trees e.g. parking, material storage, the use of plant machinery and all other sources of soil compaction. In operating plant, particular care is required to ensure that the operational arcs of excavation and lifting machinery, including their loads, do not physically damage trees when in use.
- 8.2.8 To enable the successful integration of the proposal with the retained trees, the following points will need to be taken into account:
- 1) Plan of underground services.
 - 2) Schedule of tree protection measures, including the management of harmful substances.
 - 3) Method statements for constructional variations regarding tree proximity (e.g. foundations, surfacing and scaffolding).
 - 4) Site logistics plan to include storage, plant parking/stationing and materials handling.
 - 5) Tree works: felling, required pruning and new planting. All works must be carried out by a competent arborist in accordance with BS3998.
 - 6) Site supervision: the Site Agent must be nominated to be responsible for all day-to-day arboricultural matters on site. This person must:
 - be present on site for the majority of the time;
 - be aware of the arboricultural responsibilities;
 - have the authority to stop work causing, or may cause harm to any tree;
 - ensure all site operatives are aware of their responsibilities to the trees on site and the consequences of a failure to observe these responsibilities;
 - arrange with the retained arboricultural consultant an initial pre-start briefing to inspect tree protection measures and agree a schedule of monitoring thereof on an initial monthly basis to be reviewed over the duration of works.
 - give advance notice (ideally 2 weeks) to retained arboricultural consultant to arrange for supervision of any excavation (especially for services and foundations) within RPA
 - make immediate contact with the local authority and/or a retained arboricultural consultant in the event of any tree related problems occurring.
- 8.2.9 These points can be resolved and approved through consultation with the planning authority via their Arboricultural Officer.

8.2.10 The sequence of works should be as follows:

- i) initial tree works: felling, stump grinding and pruning for working clearances;
- ii) installation of TPB for demolition & construction;
- iii) installation of underground services;
- iv) installation of ground protection;
- v) main construction;
- vi) removal of TPB;
- vii) soft landscaping.

9.0 COMPLIANCE: Trees and the Planning System

9.1 Under the UK planning system, local authorities have a statutory duty to consider the protection and planting of trees when granting planning permission for proposed development. The potential effect of development on trees, whether statutorily protected (e.g. by a tree preservation order or by their inclusion within a conservation area) or not, is a material consideration that is taken into account in dealing with planning applications. Where trees are statutorily protected, it is important to contact the local planning authority and follow the appropriate procedures before undertaking any works that might affect the protected trees.

9.2 The nature and level of detail of information required to enable a local planning authority to properly consider the implications and effects of development proposals varies between stages and in relation to what is proposed. Table B.1 provides advice to both developers and local authorities on an appropriate amount of information. The term “minimum detail” is intended to reflect information that local authorities are expected to seek, whilst the term “additional information” identifies further details that might reasonably be sought, especially where any construction is proposed within the RPA.

9.3 This report delivers information appropriate to a full planning application and to these specific proposals as per BS5837 Table B.1 below, providing both minimum details and further additional material in the form of general tree protection recommendations and constructional variation.

Table B.1 Delivery of tree-related information into the planning system

Stage of process	Minimum detail	Additional information
Pre-application	Tree survey	Tree retention/removal plan (draft)
Planning application	Tree survey (in the absence of pre-application discussions) Tree retention/removal plan (finalized) Retained trees and RPAs shown on proposed layout Strategic hard and soft landscape design, including species and location of new tree planting Arboricultural impact assessment	Existing and proposed finished levels Tree protection plan Arboricultural method statement – heads of terms Details for all special engineering within the RPA and other relevant construction details
Reserved matters/ planning conditions	Alignment of utility apparatus (including drainage), where outside the RPA or where installed using a trenchless method Dimensioned tree protection plan Arboricultural method statement – detailed Schedule of works to retained trees, e.g. access facilitation pruning Detailed hard and soft landscape design	Arboricultural site monitoring schedule Tree and landscape management plan Post-construction remedial works Landscape maintenance schedule

10.0 REFERENCES

- Barlow JF & Harrison G. 1999. Shade By Trees, Arboricultural Practice Note 5, AAIS, Farnham, Surrey.
- British Standards Institute. 2012. Trees in Relation to Design, Demolition and Construction - Recommendations BS 5837: 2012 HMSO, London.
- Centre for Ecology & Hydrology. 2006. Tree Roots in the Built Environment, HMSO, London.
- Helliwell R (1980) Provision for New Trees; Landscape Design; July/August issue
- International Society of Arboriculture (ISA). 1994. The Landscape Below Ground. ISA, Champaign, Illinois. USA.
- Lonsdale D 1999. Research for Amenity Trees No.7: Principles of Tree Hazard Assessment and Management, HMSO, London.
- Matheny, N; Clark, J. R.1998. Trees and Development: A Technical Guide to Preservation of Trees during Land Development. ISA, Champaign, Illinois. USA.
- Mattheck C. & Breloer H. 1994. Research for Amenity Trees No.2: The Body Language of Trees, HMSO, London.
- Thomas P, 2000 & 2014. Trees: Their Natural History, Cambridge University Press, Cambridge.
- Trowbridge J & Bassuk N (2004) Trees in the Urban Landscape: Site Assessment, Design, and Installation; J Wiley & Sons inc. NJ USA



Caveats

This report is primarily an arboricultural report. Whilst comments relating to matters involving built structures or soil data may appear, any opinion thus expressed should be viewed as qualified, and confirmation from an appropriately qualified professional sought. Such points are usually clearly identified within the body of the report. It is not a full safety survey or subsidence risk assessment survey. These services can be provided but a further fee would be payable. Where matters of tree condition with a safety implication are noted during a survey they will of course appear in the report.

A tree survey is generally considered invalid in planning terms after 2 years, but changes in tree condition may occur at any time, particularly after acute (e.g. storm events) or prolonged (e.g. drought) environmental stresses or injuries (e.g. root severance). Routine surveys at different times of the year and within two - three years of each other (subject to the incidence of the above stresses) are recommended for the health and safety management of trees remote from highways or busy access routes. Annual surveys are recommended for the latter.

Tree works recommendations are found in the Appendices to this report. It is assumed, unless otherwise stated ("ASAP" or "Option to") that all husbandry recommendations will be carried out within 6 months of the report's first issue. Clearly, works required to facilitate development will not be required if the application is shelved or refused. However, necessary husbandry work should not be shelved with the application and should be brought to the attention of the person responsible, by the applicant, if different. Under the Occupiers Liability Act of 1957, the owner (or his agent) of a tree is charged with the due care of protecting persons and property from foreseeable damage and injury.' He is responsible for damage and/or nuisance arising from all parts of the tree, including roots and branches, regardless of the property on which they occur. He also has a duty under The Health and Safety at Work Act 1974 to provide a safe place of work, during construction. Tree works should only be carried out with local authority consent, where applicable.

Inherent in a tree survey is assessment of the risk associated with trees close to people and their property. Most human activities involve a degree of risk, such risks being commonly accepted if the associated benefits are perceived to be commensurate.

Risks associated with trees tend to increase with the age of the trees concerned, but so do many of the benefits. It will be appreciated, and deemed to be accepted by the client, that the formulation of recommendations for all management of trees will be guided by the cost-benefit analysis (in terms of amenity), of tree work that would remove all risk of tree related damage.

Prior to the commencement of any tree works, an ecological assessment of specific trees may be required to ascertain whether protected species (e.g. bats, badgers and invertebrates etc.) may be affected.



PART 2 – APPENDICES

APPENDIX 1

TREE SCHEDULE

Botanical Tree Names

Laurel, Portuguese

: Prunus lusitanica

Sycamore

: Acer pseudoplatanus

Notes for Guidance:

1. Height describes the approximate height of the tree measured in metres from ground level.
2. The Crown Spread refers to the crown radius in meters from the stem centre and is expressed as an average of NSEW aspect if symmetrical.
3. Ground Clearance is the height in metres of crown clearance above adjacent ground level.
4. Stem Diameter (Dm) is the diameter of the stem measured in millimetres at 1.5m from ground level for single stemmed trees. BS 5837:2012 formula (Section 4.6) used to calculate diameter of multi-stemmed trees. Stem Diameter may be estimated where access is restricted and denoted by '#'.
5. Protection Multiplier is 12 and is the number used to calculate the tree's protection radius and area
6. Protection Radius is a radial distance measured from the trunk centre.
7. Growth Vitality - Normal growth, Moderate (below normal), Poor (sparse/weak), Dead (dead or dying tree).
8. Structural Condition - Good (no or only minor defects), Fair (remediable defects), Poor - Major defects present.
9. Landscape Contribution - High (prominent landscape feature), Medium (visible in landscape), Low (secluded/among other trees).
10. B.S. Cat refers to (British Standard 5837:2012 section 4.5) and refers to tree/group quality and value; 'A' – High, 'B' - Moderate, 'C' - Low, 'U' - Unsuitable for retention. The following colouring has been used on the site plans:
 - High Quality (A) (Green),
 - Moderate Quality (B) (Blue),
 - Low Quality (C) (Grey),
 - Unsuitable for Retention (U) (Red)
11. Sub Cat refers to the retention criteria values where 1 is Arboricultural, 2 is Landscape and 3 is Cultural including Conservational, Historic and Commemorative.
12. Useful Life is the tree's estimated remaining contribution in years.



Site: 8 Inglewood Road

Date: 14/07/2020

Appendix 1

Landmark Trees Ltd

020 7851 4544

Surveyor(s): Adam Hollis

Ref: IGS_8IWR_AIA

BS5837 Tree Constraints Survey Schedule

Tree No.	English Name	Height	Crown Spread	Ground Clearance	Stem Diamete	Age Class	Protection Radius	Growth Vitality	Structural Condition	B.S. Cat	Sub Cat	Useful Life	Comments
1	Sycamore	17	7986	4.0	850	Mature	10.2	Normal	Fair	B	2		Restricted rooting Entry wounds on stems Necrotic bark N at 1.2m above ground
2	Sycamore	15	3533	5.0	500	Mature	6.0	Normal	Fair	C	2	40+	Poor form Remote survey only (RS)
3	Laurel, Portugese	4	1	2.5	300	Mature	3.6	Moderate	Fair	C	2	40+	Pollarded

APPENDIX 2

TRIAL PIT FINDINGS

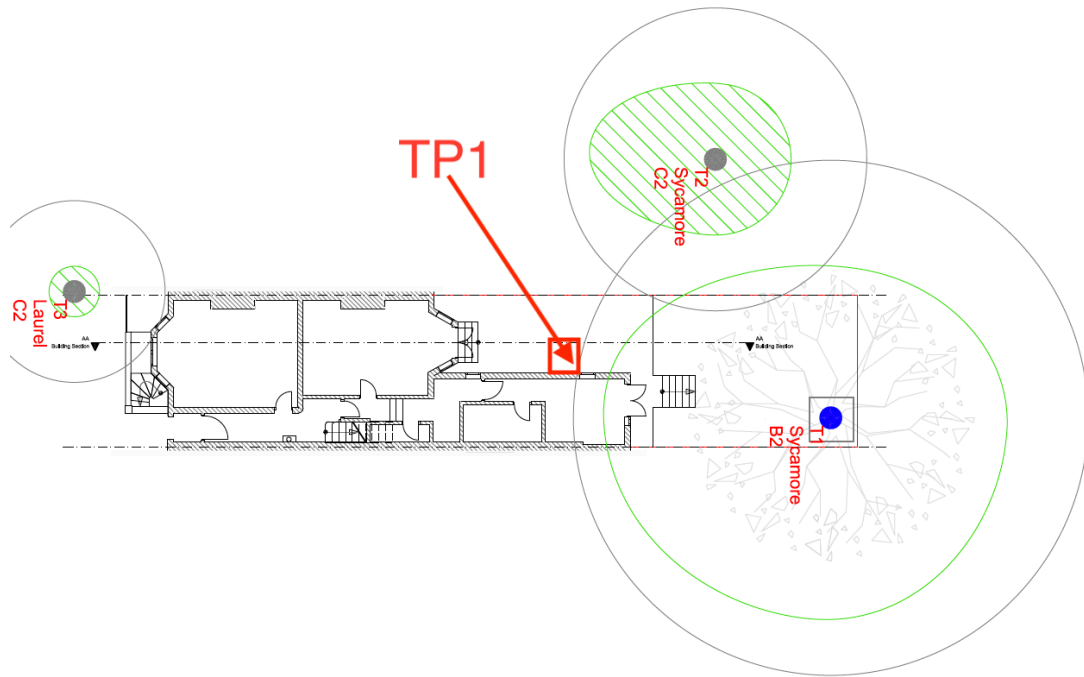

Figure A2.1: Approximate trial pit location



Photograph A2.1: No significant rooting in trial pit



Photograph A2.2: Closer view of trial pit

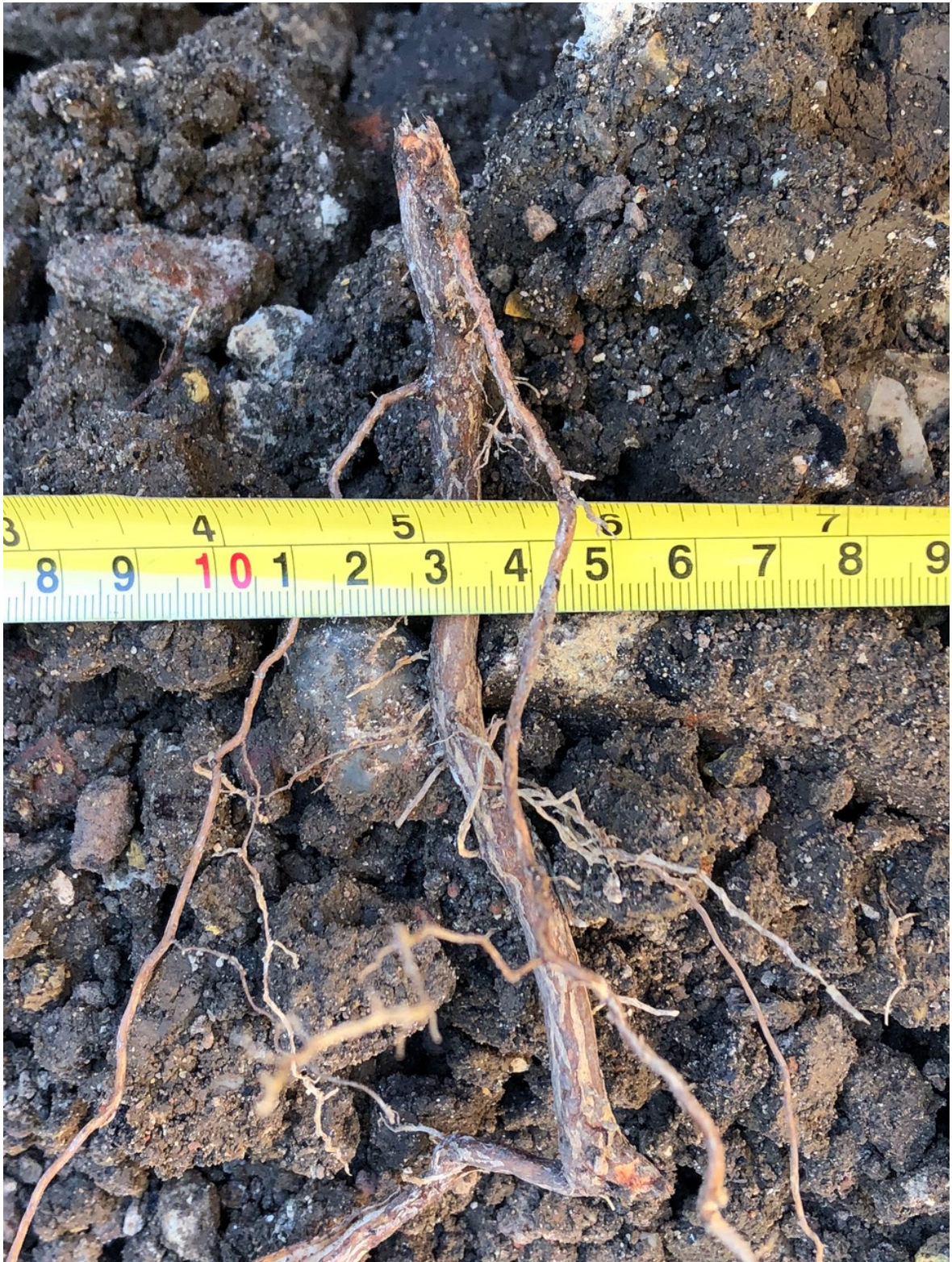

Photograph A2.3: Sample diameter of minor rooting encountered



PART 3 – PLANS

PLAN 1

TREE CONSTRAINTS PLAN

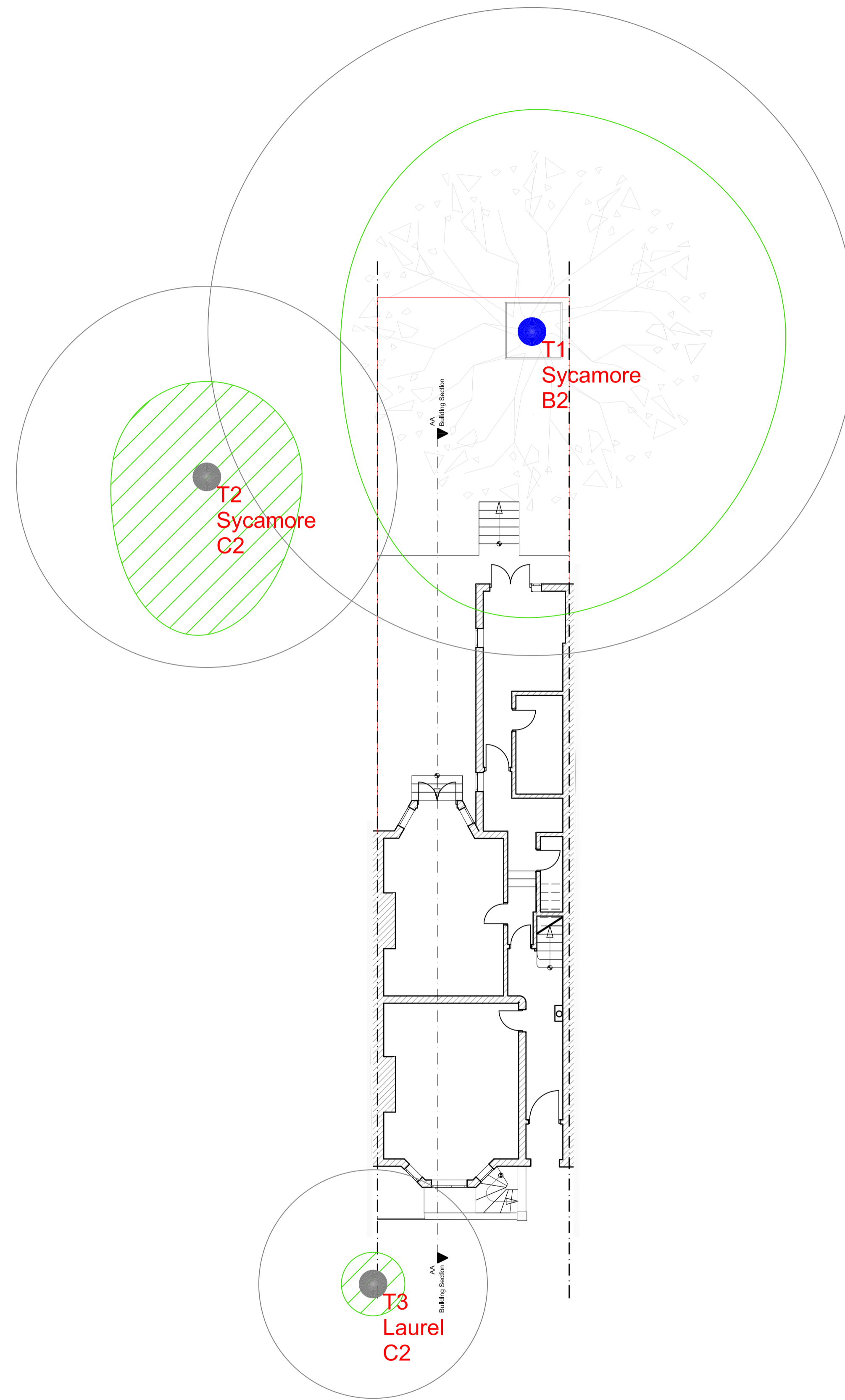

NOTE:
 This survey is of a preliminary nature. The trees were inspected from the ground only on the basis of the Visual Tree Assessment method. No samples were taken for analysis. No decay detection equipment was employed. The survey does not cover the arrangements that may be required in connection with the laying or removal of underground services.

Branch spread in metres is taken at the four cardinal points to derive an accurate representation of the crown.

Root Protection Areas (RPA) are derived from stem diameter measured at 1.5 m above adjacent ground level (taken on sloping ground on the upslope side of the tree base).

Landmark Trees
 Holden House, 4th Floor, 57 Rathbone Place, London W1T 4JU
 Tel: 0207 851 4544 Mobile: 07812 989928
 e-mail: info@landmarktrees.co.uk Web: www.landmarktrees.co.uk

Site: 8 Inglewood Road 1:100@ A1
 Drawing Title: Tree Constraints Plan July 2020

Key:

- Category A High Quality (Green circle)
- Category B Moderate Quality (Blue circle)
- Category C Low Quality (Grey circle)
- Category U Trees Unsuitable for Retention (Red circle)
- Crown Spread (Green outline)
- Tree Number (Number in circle)
- Species (Text label)
- Category (Text label)
- Root Protection Area (Red outline)
- Tree Position Approximate (not shown on original survey) (Hatched area)

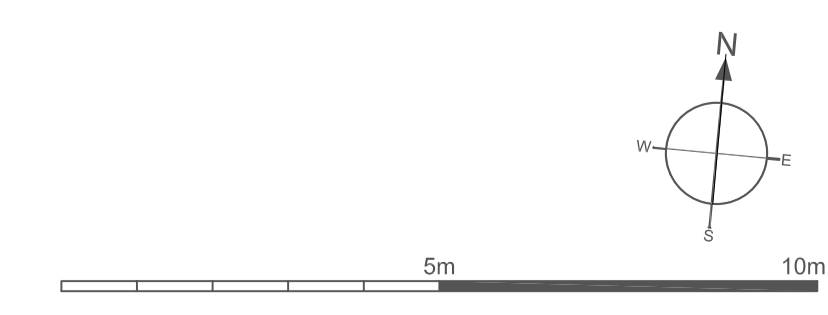

PLAN 2

ARBORICULTURAL IMPACT ASSESSMENT PLAN (S)

- i. Basement & Ground Floor

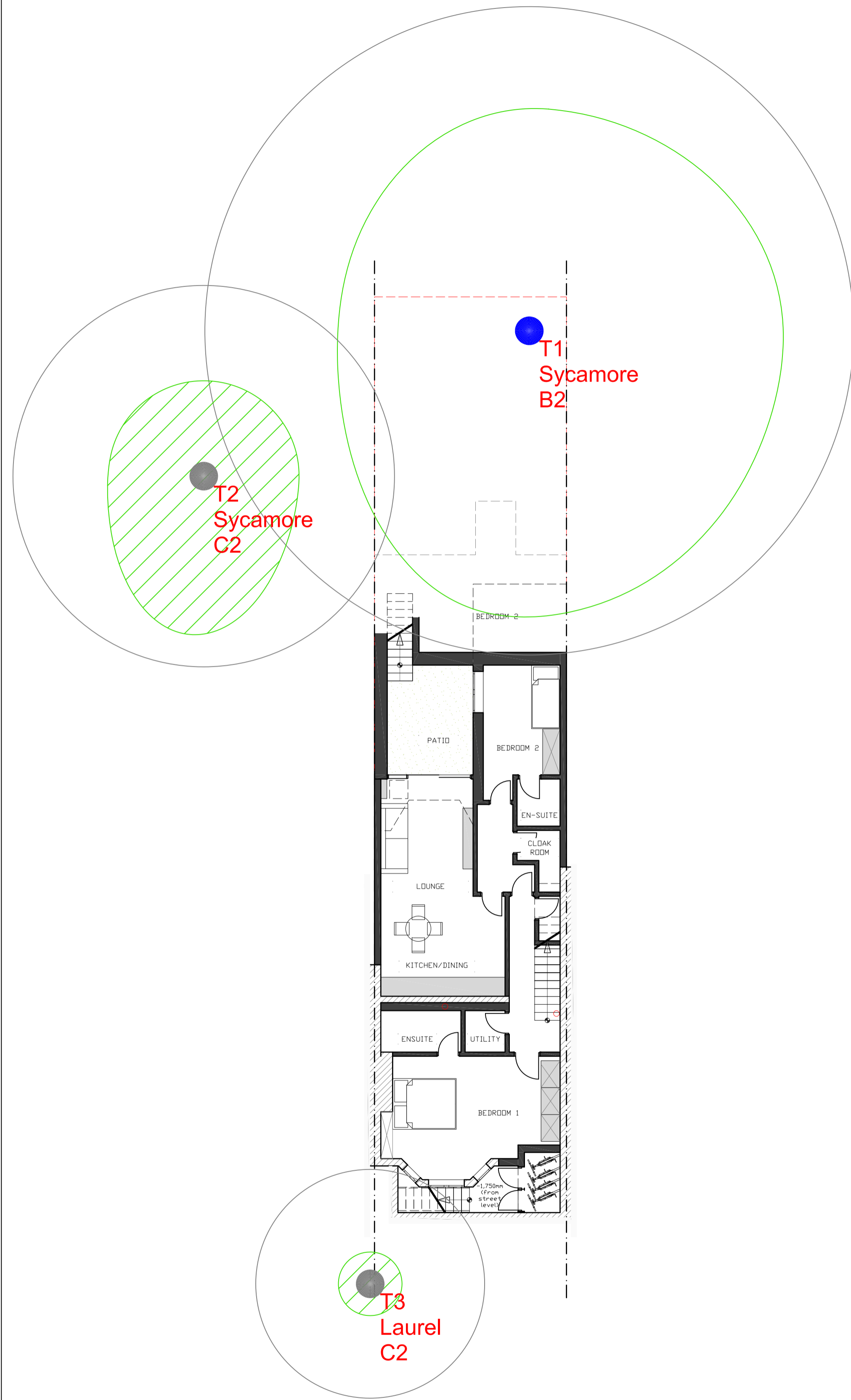

Proposed Basement Plan

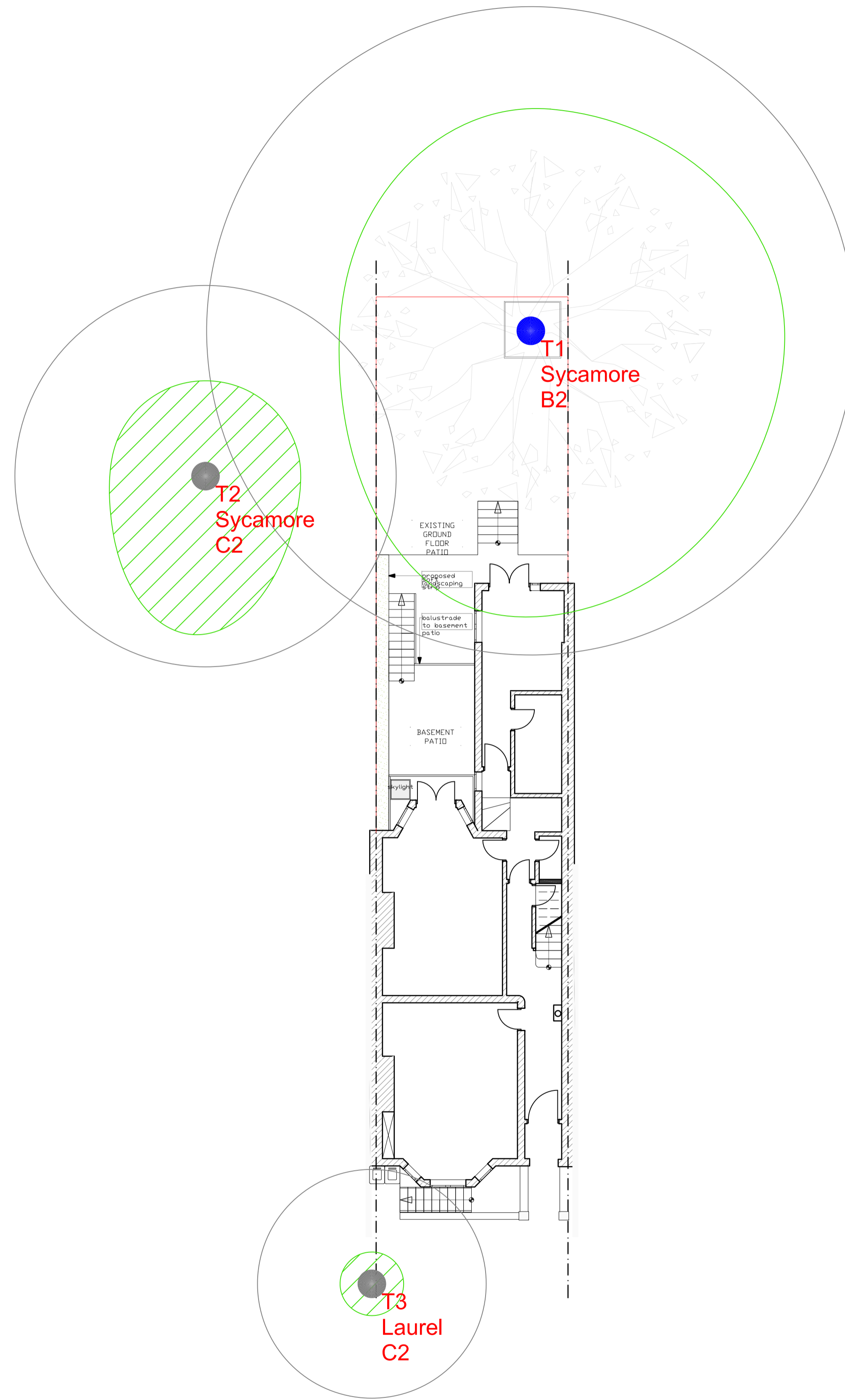

Proposed Ground Floor Plan

NOTE:
 This survey is of a preliminary nature. The trees were inspected from the ground only on the basis of the Visual Tree Assessment method. No samples were taken for analysis. No decay detection equipment was employed. The survey does not cover the arrangements that may be required in connection with the laying or removal of underground services.
 Branch spread in metres is taken at the four cardinal points to derive an accurate representation of the crown.
 Root Protection Areas (RPA) are derived from stem diameter measured at 1.5 m above adjacent ground level (taken on sloping ground on the upslope side of the tree base).

Landmark Trees
 Holden House, 4th Floor, 57 Rathbone Place, London W1T 4JU
 Tel: 0207 851 4544 Mobile: 07812 989928
 e-mail: info@landmarktrees.co.uk Web: www.landmarktrees.co.uk

Site: 8 Inglewood Road 1:100@A1
 Drawing Title: Arboricultural Impacts Assessment Plan July 2020

Key:

- Category A High Quality (Green circle)
- Category B Moderate Quality (Blue circle)
- Category C Low Quality (Grey circle)
- Category U Trees Unsuitable for Retention (Red circle)
- Crown Spread (Green hatched circle)
- Tree Number (Number in circle)
- Species (Text label)
- Category (Text label)
- Tree Position Approximate (not shown on original survey) (Green hatched circle)

