

Phase 1

1 : 10

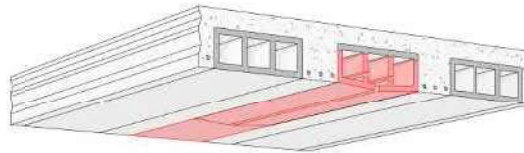

- Tap all adjacent pots to determine the extent of damage
- Remove broken sections of pot to expose vertical faces of beam

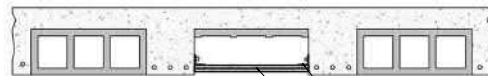

Phase 2

1 : 10

40x40x3 EA with Hilti HIT-V +
HIT-HY-200 at 300 crs (60mm
embedment)

Fireboard to architects
specification, fixed to EA

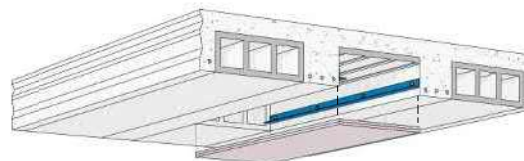

- Install 40x40x3 EA to support fireboard to u/s. Fireboard specification to architects specification



Phase 3

1 : 10

Finishes to architects
specification



- Apply plaster / filler material to provide a flush soffit and infill all joints

Rev	Date	By	Eng	Amendments

**HEYNE
TILLET
STEEL**

STRUCTURAL
ENGINEERS

hts.uk.com

Job Name

Drawing Title

**Repair Detail to Damaged
Clay Pot**

Purpose of Issue

Scale at A1

1 : 10

Dwg No **SH / 89 - A**

Rev

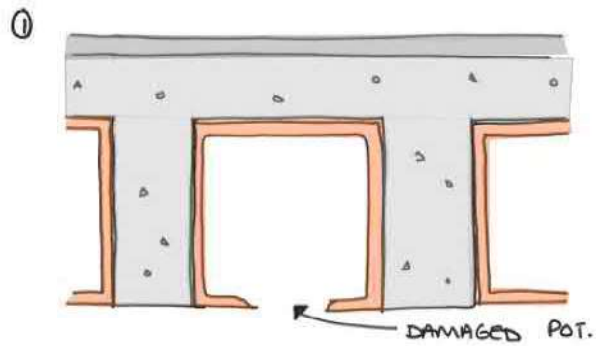

STEP 1 - EXISTING CASE OF POT

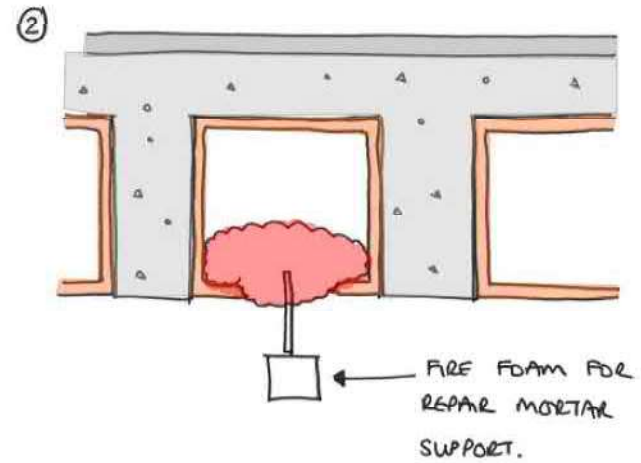

STEP 2 - INFILL WITH FIRE FOAM

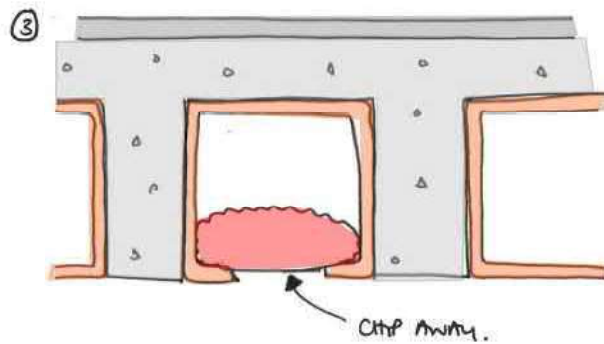

STEP 3 - PREPARE SURFACE OF FIRE FOAM

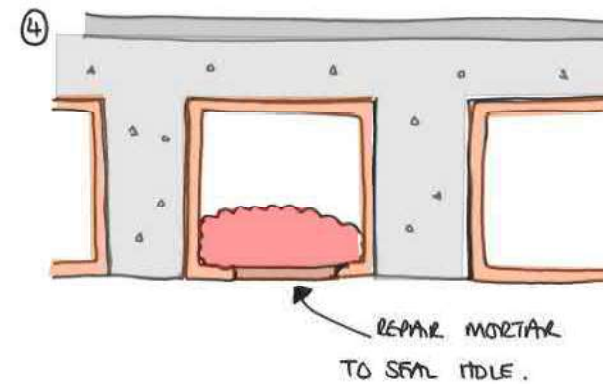

STEP 3 - SEAL SURFACE WITH A REPAIR MORTAR