



Site Investigation Report

Auger Ref:
99615.1.USI



Job Information	
Client	Crawford & Co
Visit date	12/11/2019
Report date	12/11/2019

Job Summary	
✓	2 trial holes undertaken. Read more.
✓	Requested soil samples taken. Read more.
✓	Requested root samples taken. Read more.



Job Information

Overview

Brief

Auger were commissioned by Crawford & Co to undertake a site investigation within the area of concern at the property.

Photographs

Trial Hole 1

Fig 1.1: Trial Hole 1 Location



Fig 1.2: Trial Hole 1 Footing



Trial Hole 2

Fig 2.1: Trial Hole 2 Location



Fig 2.2: Trial Hole 2 Footing



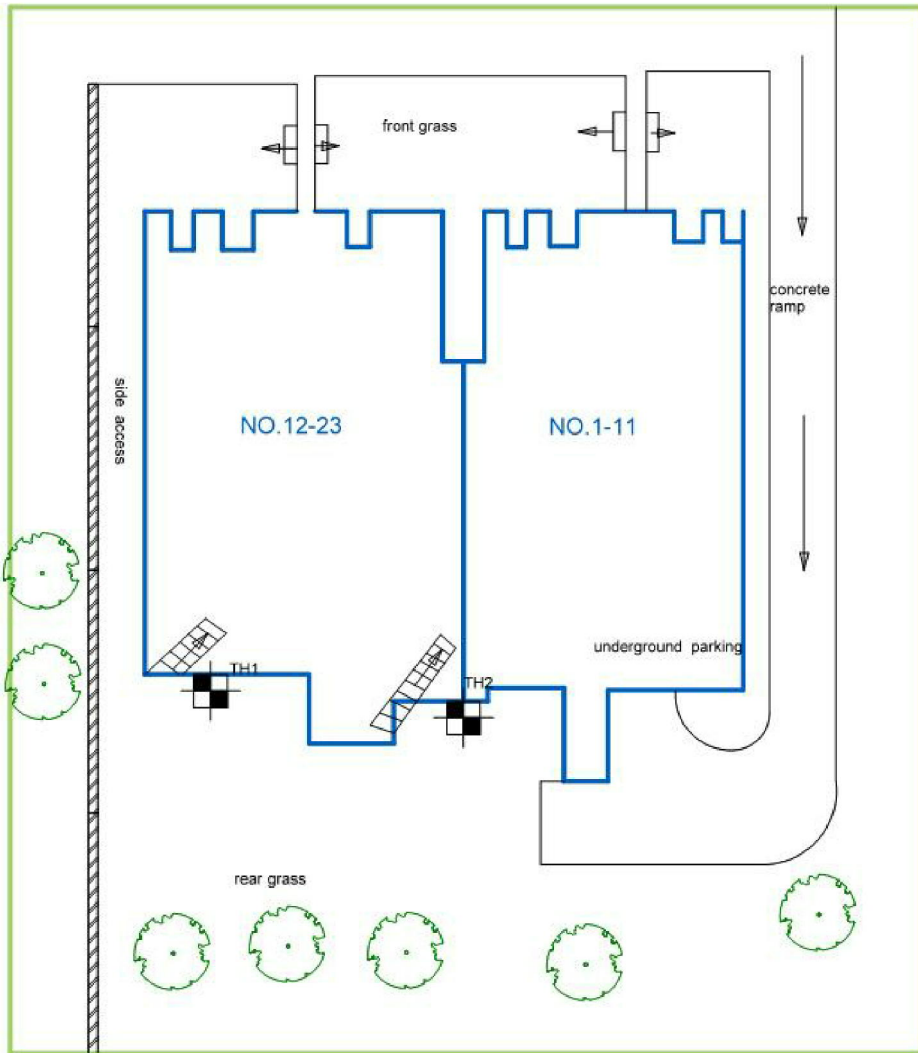

FRONT OF PROPERTY

This drawing should be used for diagrammatic purposes only. Auger are not responsible or liable for any 3rd party works undertaken using the details outlined in this drawing. Confirmation of the drainage configuration can only be confirmed by excavation or detailed technical survey.

LEGEND	
= Manhole	= Blockage
= Inspection Chamber	= svp/w/c
= Inspection Pot	= wg/fwg
= Trial hole	= Lines not camera surveyed
= Borehole	= Lines camera surveyed
= Direction of flow	= Assumed water mains feed
= Shrubs/bush	= Walls
= Hedge	= Fences
= Tree	= gate / door
	= Steps
	= Building Outline



Trial Hole Log No.1

Location: Rear left hand side of stair

Depth (m)	Symbolic Log	Strata Description	Insitu Tests		Soil Sample	Root Sample
			SV(19)			
0.0	<p>350mm Ground Level Brickwork Grass Concrete</p>					
1.0		Dry stiff Brown fine to medium gravelly silty CLAY	64kpa		Soil @ 1m	Root @ 1m
1.5		Dry stiff Brown silty CLAY	70kpa		Soil @ 1.5m	Root @ 1.5m
2.0		Dry stiff Brown fine to medium gravelly silty CLAY	134kpa		Soil @ 2m	
2.5		Dry stiff Brown silty CLAY	140kpa		Soil @ 2.5m	
3.0		TRIAL HOLE TERMINATED	140kpa		Soil @ 3m	



Trial Hole Log No.2

Location: Rear middle of stairwell

Depth (m)	Symbolic Log	Strata Description	Insitu Tests		Soil Sample	Root Sample
			SV(19)			
0.0	<p>200mm</p> <p>Ground Level</p> <p>Grass</p> <p>Brickwork</p> <p>Concrete</p>					
1.0		Dry stiff Brown sandy silty CLAY	60kpa		Soil @ 1m	Root @ 1m
1.5		Dry stiff Brown fine to medium gravelly silty CLAY	75kpa		Soil @ 1.5m	Root @ 1.5m
2.0		Dry stiff Brown fine gravelly silty CLAY	120kpa		Soil @ 2m	
2.5		Dry stiff Brown fine to medium gravelly silty CLAY	140kpa		Soil @ 2.5m	
3.0		TRIAL HOLE TERMINATED	140kpa		Soil @ 3m	