



origin

DOORS AND WINDOWS

# Bi-fold Door Specification File





# Contents

Specification Overview	04
Security	08
Bi-fold Door Make Up	09
Performance & Limitations	10
Master Configurations	12
Technical Drawings	26
Handles	49
All Configurations	57
Warranty	73
Installation Guide	80

# Specification overview

## Thermally Broken Aluminum Bi-folding Door

External view of  
bi-folding doors

---



Internal view of  
bi-folding doors

---



## Profile specification

Outer Frame Depth	3"
Sash Depth	2 1/4"
Sash Sightline	2 3/4"
Track Height (not including rebate)	2"

## Features

- ▶ 10 year warranty
- ▶ The doors are bottom running and incorporate a unique free glide carriage assembly, which uses acetal rollers with sealed SKF stainless steel bearings on a hardened stainless steel axle
- ▶ Chamfered bead internally and externally
- ▶ Packaged in kit form for easy transportation and installation
- ▶ Industry unique 8-point locking system for supreme security, which includes chamfered 0.8" linear bolts and deep throw 1" security hooks
- ▶ Each door comes with three solid zinc security hinges

## Options and extras

- ▶ Single, French, Bi-fold and Moving Corner Bi-Fold Doors are available
- ▶ Accommodates double, triples and laminated glazing with glass thickness of 1", 1 1/8" and 1 1/4"
- ▶ Weathered or non-weathered thresholds are available
- ▶ Open in or open out options
- ▶ Sill options available are 6 1/8" and 8 7/8"
- ▶ Available in over 150 different RAL colors, woodgrain effects or in AAMA 2605 (Kynar 500® or Hylar®)
- ▶ Trolley colors include black, white, stainless steel finish or color coded options
- ▶ Standard, 1 star or 3 star keyed cylinder options
- ▶ Hinges can be specified in a stainless steel finish or in any color
- ▶ Gaskets are available in 7 different colors: black, white, light gray, graphite gray, light oak, bronze, chestnut brown
- ▶ Comprehensive handle range, including color matched options

## Available in the following color finishes

The Origin Bi-fold Door can be manufactured in over 150 different RAL colors, as well as a split color option.

Additionally, Origin products are also available in AAMA 2605 (Kynar 500®) or (Hylar®) finishes.

To the right demonstrates our most popular colors and authentic woodgrain effects.

If you choose to order your doors in either Patio White, Slate Gray, Southern Bronze, Jet Black, Clear Anodized and Bronze Anodized, these are available on an industry-leading 2-week lead time.

For the full range, please visit [originbifolds.com](http://originbifolds.com)



Bronze Anodized (MX5)



Jet Black (9005M)



Slate Gray (7015M)



Clear Anodized (AA25)

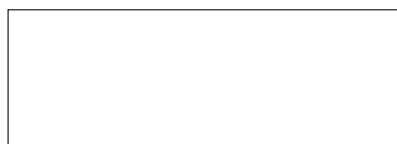

Patio White (YA103E)



Southern Bronze (YL222E)



Natural Oak

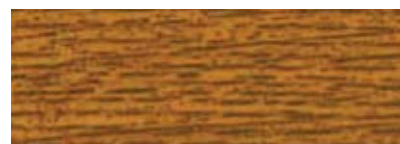

Golden Oak



Mahogany



Walnut



With our custom door system, even the gaskets are down to your specification. The below are our recommendations.

Door Color	Recommended Q-Lon Color
A. Walnut	Bronze
B. (9005M) and (YL222E)	Black
C. (7015M) and (MX5)	Graphite Gray
D. (AA25)	Light Gray
E. (YA103E)	White
F. Natural Oak and Golden Oak	Light Oak
G. Mahogany	Chestnut Brown



## White Glove Delivery Service



One of our priorities is the safe delivery of our products to you. With this in mind, we introduced our White Glove Delivery Service. This is designed to operate as follows:

- The delivery driver will unload freight from their trailer via lift gate (pending it fits onto the gate)
- Delivery driver will take freight inside a residence or business, place it where it belongs, and unwrap it if specified by the customer
- This service usually comes with a guaranteed transit if that is necessary
- We can generally get a rate to have the driver handle a forklift if there is one on site. Some LTL carriers will comply with driving a forklift, but almost all truckload carriers will drive a forklift at the site(s)
- Freight is always loaded and unloaded with extra care so as to not break or get damaged while in transit. Extra attention is spent on loading and unloading with Origin's White Glove Delivery Service
- All door and window glass panels are individually packaged so as to keep it protected during transit and while at the jobsite or stored in the warehouse

# Security

## Origin's Multi-Point Lock

All lead doors greater than 44" tall contain the Origin Multi-Point Lock

The Origin Multi-Point Lock offers 8 points of locking and is part of the reason our overall door system passed the forced entry resistance test in compliance with AAMA 1304-02 and TAS 202

In the image opposite, you will see the 8 points of locking on one of our Mid-rail options. Included in this are shoot bolts that go into the top and bottom track, deep throw security hooks and lock.



The Origin Bi-fold Door is one of the select few doors of its kind to pass Florida's rigorous High Velocity Hurricane Zone (HVHZ) testing standards.

## Barrels

We offer 2 types of locking barrel/cylinder in addition to our standard barrel.

The ATK barrel is certified to 3 Star British Kite Mark TS007:2014

Our most secure locking barrel is a 3 Star British Kite Mark TS007:2014, with coded magnetic keys

Standard Barrel  
– 3 Star ATK

3 Star British  
Kite Marked ABS  
Barrel with coded  
magnetic keys





# Bi-fold Door Make-Up

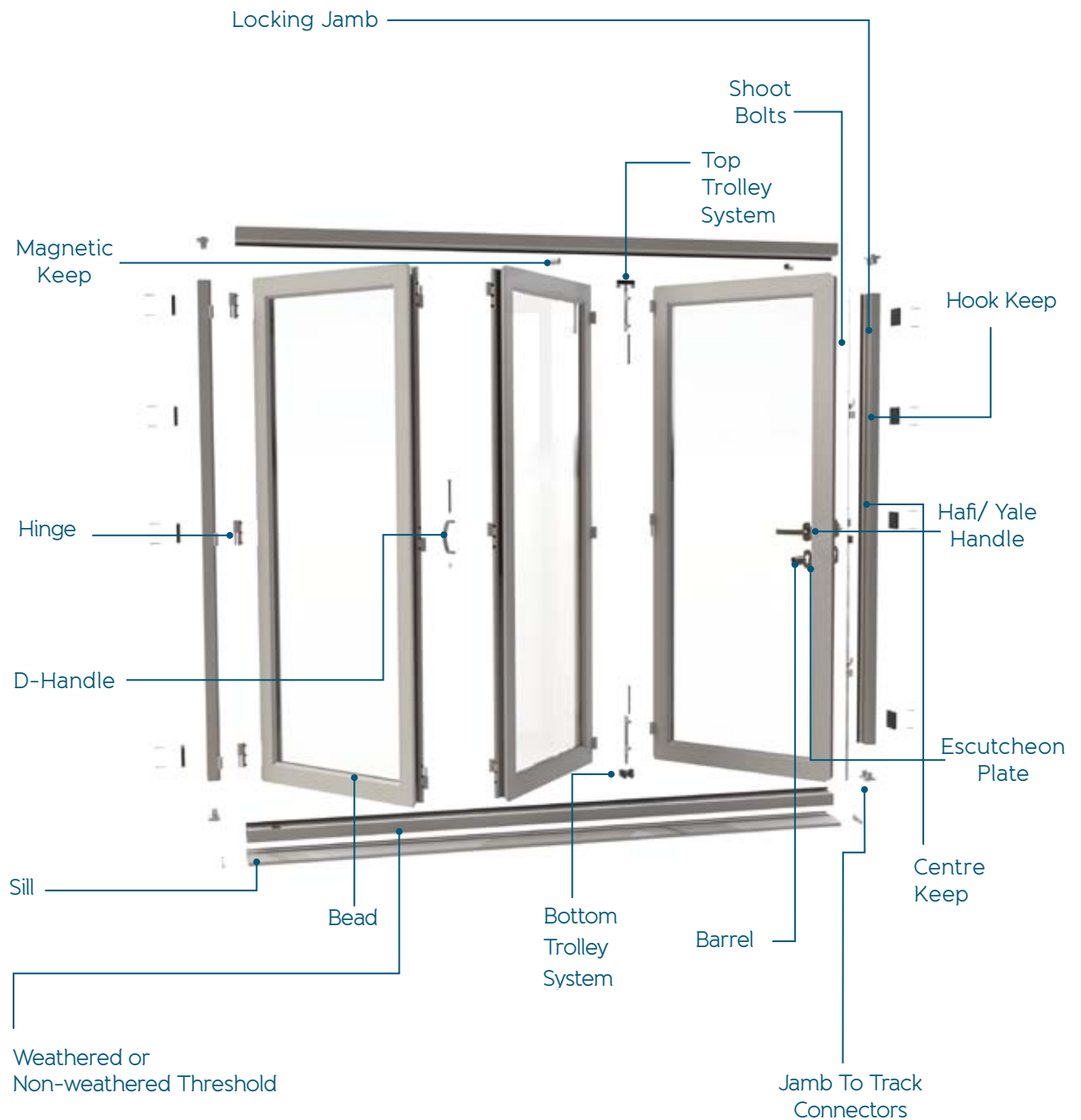

# Performance & Limitations

## Size Limitations

Maximum door panel size for hurricane zones

36 3/4" x 96"

Maximum door panel size for non-hurricane zones

Most width or length combinations that equal or are less than 24 1/2 square feet.

## Configurations

Open out ☒

Open in ☒

Limitless span ☒

90° corner ☒

135° corner\* ☒

\*Available in most states

## Best Thermal Performance

Hurricane Impact

U-Factor

0.33

SHGC

0.17

Non-impact

0.28

0.15



## Glass Options

Tints ☒

Internal Grids ☒

Muntins ☒

## Structure

Design Pressure	+50/-55
Air	0.10 cfm/ft <sup>2</sup>
Water	7.52 psf

## Threshold Options

Weathered: Maximum weather protection with ½" riser (2" bottom track)

ADA: Non-Weathered Threshold – minimal threshold (2" bottom track)

Low Threshold track is ADA compliant when recessed



# Master Configurations

## Master Configuration 3 Door Left

Master drawing and all technical detail drawings are also applicable to the following configurations: 5+0, 7+0

See Configuration Key for section detail ►

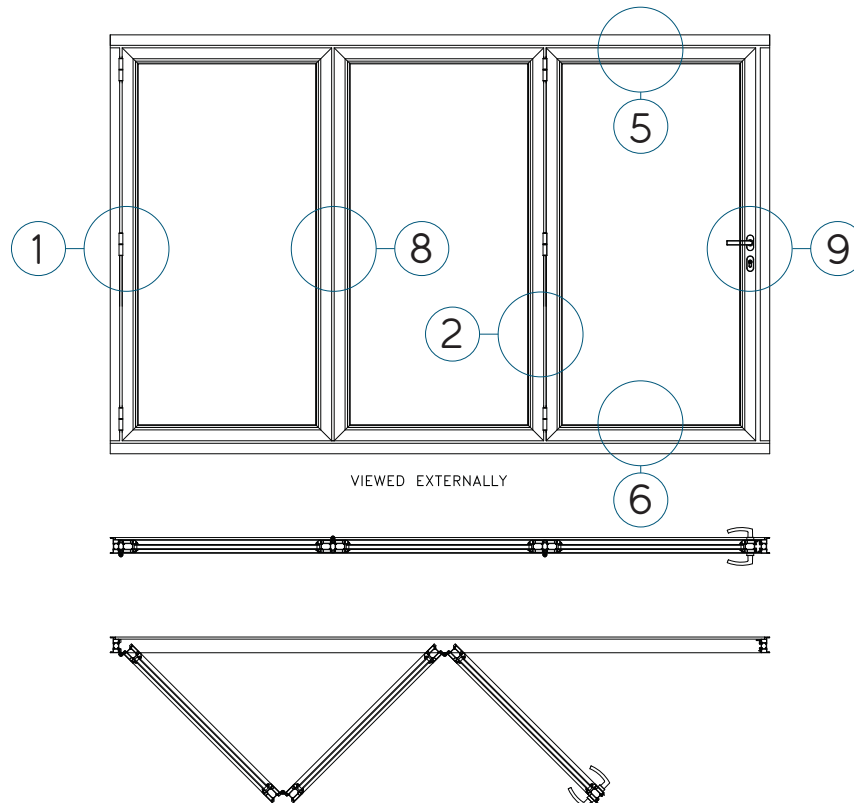

3 Door Left



5+0



7+0

### Key features

- Origin 8 point locking system
- Everyday access door
- All doors open in the same direction

See page 57 for configurations

## Configuration key

### 1 - Hinge Jamb Detail

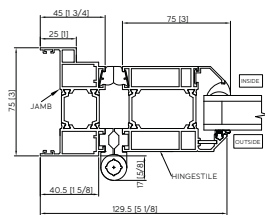

See page 26

### 2a, 2b - Opening Stiles

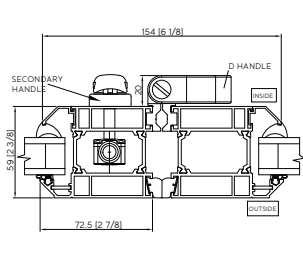

See page 27

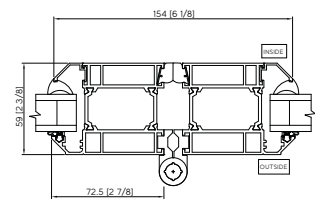

### 5 - Top Track Detail

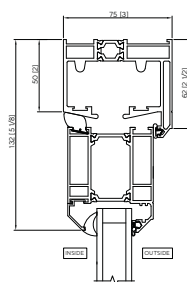

See page 30

### 6a-6d - Bottom Track Detail

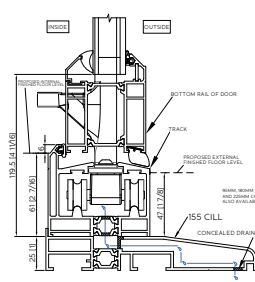

See pages 31-33

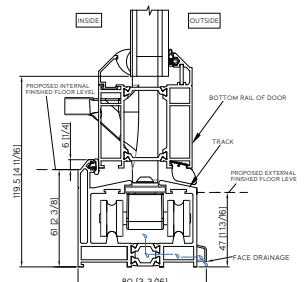

### 8 - Secondary Handle Layout

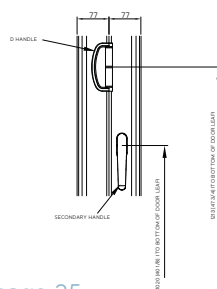

See page 35

### 9 - Locking Secondary Detail

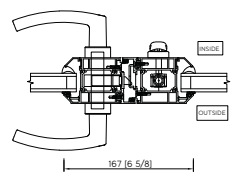

See pages 36