

NOTE:

Architectural Information - the level of detail shown on the drawings is relative to the submission of a PLANNING APPLICATION.

The drawings should therefore not be used for any other purpose without both the prior agreement of the architect, and subsequent checking / development by others.
Dimensions and setting out - should be checked on site; see above

Structure & Construction - these drawings, unless expressly noted otherwise, have not been fully coordinated with a Structural Engineer's input and show indicative construction build-up only

Building Control - the client / the contractor will liaise directly with Local Authority to ensure the project is completed in accordance with the Building Regulations

Planning - the client/ the contractor will ensure that the project is completed in accordance with the approved Planning drawings and take responsibility for the discharge of any planning conditions

Party Walls & Rights to Light - the client/ the contractor will ensure that any notices and consents required are obtained before work commences

Freshholder / Leaseholder / Restricted covenants / Easement approvals - the client will ensure that any notices and consents required are obtained before work commences

Archaeological & Ecological - the client/ the contractor will ensure that any notices and consents required are obtained before work commences

Glazing Allowances will need to be negotiated with Building Control as per Approved Document L1B Conservation of Fuel and Power

Areas provided on drawings are rounded to the nearest whole unit. Measurements are based upon received survey information and as such a reasonable allowance should be made for discrepancies or deviations that may occur during construction.

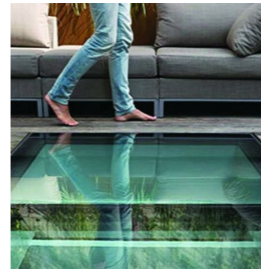
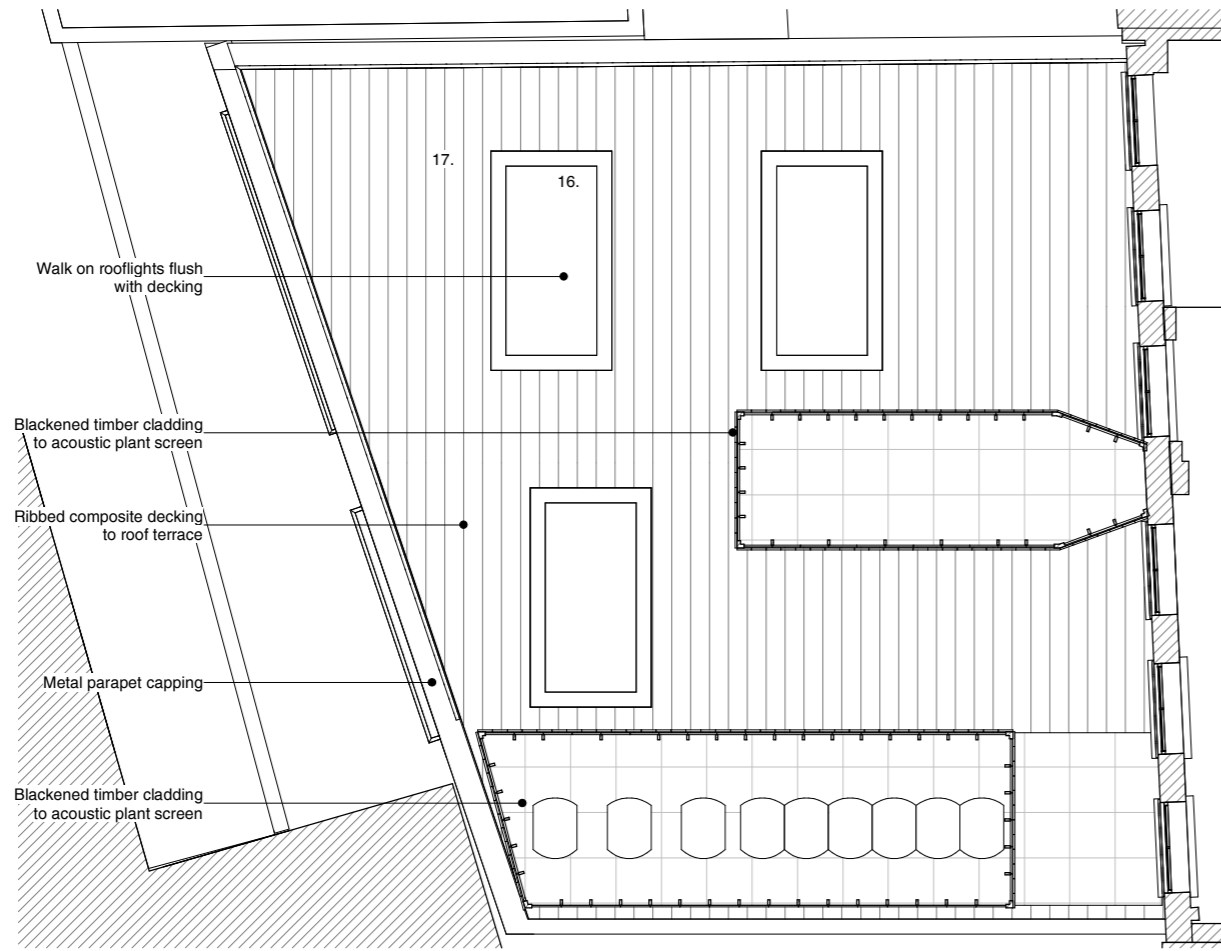

Material 13

Spec: Thermally broken, aluminium, walk on roof light
Supplier: GlazingVision
Finish: Aluminium Polyester Powder Coated
Colour: TBC
Details: See Drawing Number P039 for further detail drawings



Material 14

Spec: T Deck Composite Decking
Supplier: The Timber Group
Finish: Ribbed / Grooved
Colour: Ebony



Revisions

No.	Description	Date
A	Discharge of material conditions relating to application 2019/4362/P	03.09.2020

PLANNING

Note: Do not scale from this drawing. All dimensions to be checked on site by the contractor and to be his responsibility.

HÛT Architecture
 Studio 408
 134-146 Curtain Road
 London
 EC2A 9AR
 T 020 7399 8880
 E info@hutarchitecture.com



Project Name: Farringdon Road
 Project Number: H501
Drawing Name
 Condition 4C - Material Specification - Terrace
Drawing No
 P056
Revision
 A
Scale
 1:50 @ A1, 1:100 @ A3

