

Rev	Date	Description	Drawn	Checked
P1	06.08.18	For Comment	RS	CG
P2	29.10.18	For Comment	RS	CG
P3	07.03.19	For Comment	ES	CG
P4	05.04.19	Updated	ES	CG

Stage 3 Drawing

NOTES:
This scheme is based on limited opening up works of the existing structure. All assumptions subject to confirmation during next stage

Proposed Beam Schedule	
Ref.	Serial Size
B1	203x133x25 UKB
B2	356x171x45 UKB
B3	457x191x74 UKB
B4	533x210x92 UKB
B5	203x203x46 UKC
B6	254x254x89 UKC
B7	305x305x118 UKC
B8	356x368x177 UKC
B9	356x406x467 UKC
B10	152x152x30 UKC
B11	200x90x30 PFC

Key:

- Indicates line of structure under
- ↖ Indicates approximate position of crank in steelwork
- ESB Indicates an Existing Steel Beam 381x127 (BSB 25)
- ETB Indicates an Existing Timber Beam 300x100 centre, 225 x 100 otherwise
- ↗ Indicates existing 150x50mm ceiling joists at 355mm centres
- Unless noted otherwise, allow for 450x215x215mm deep mass concrete padstones under all beams
- M&E Allow for new steelwork to support new mechanical plant on existing roof. Allow 250kg

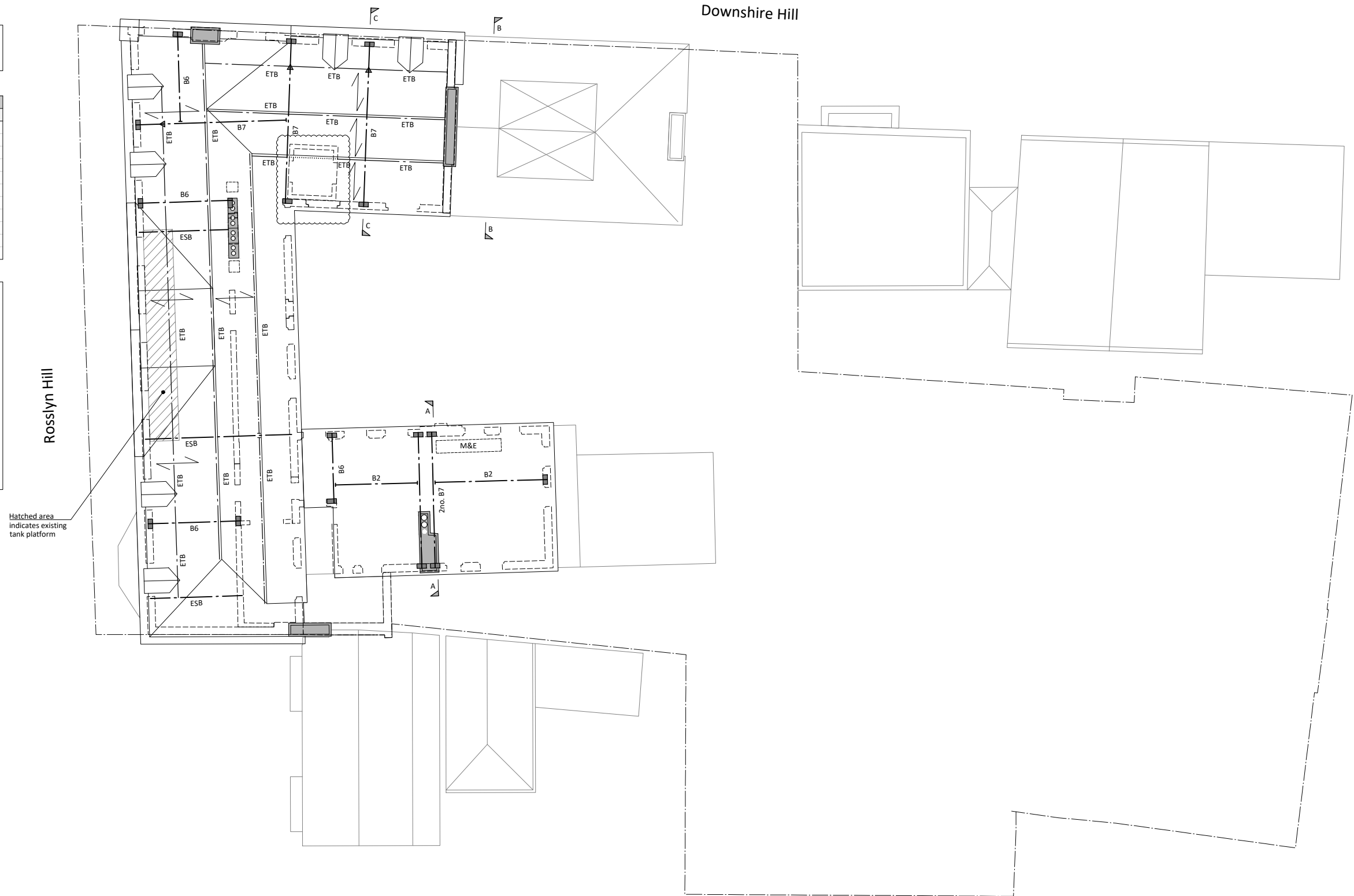

PRELIMINARY
NOT FOR CONSTRUCTION

Title
Roof Structural Engineering Plan
Project
Abacus Betsize Primary School, NW3

Client
ESFA
Job No.
4343
Drawing No.
104
Revision
P4
Scale
1:100 at A1