

Notes:
 Drawings are based on survey data and may not accurately represent what is physically present.
 Do not scale from this drawing. All dimensions are to be verified on site before proceeding with the work.
 All dimensions are in millimeters unless noted otherwise.
 Purcell shall be notified in writing of any discrepancies.

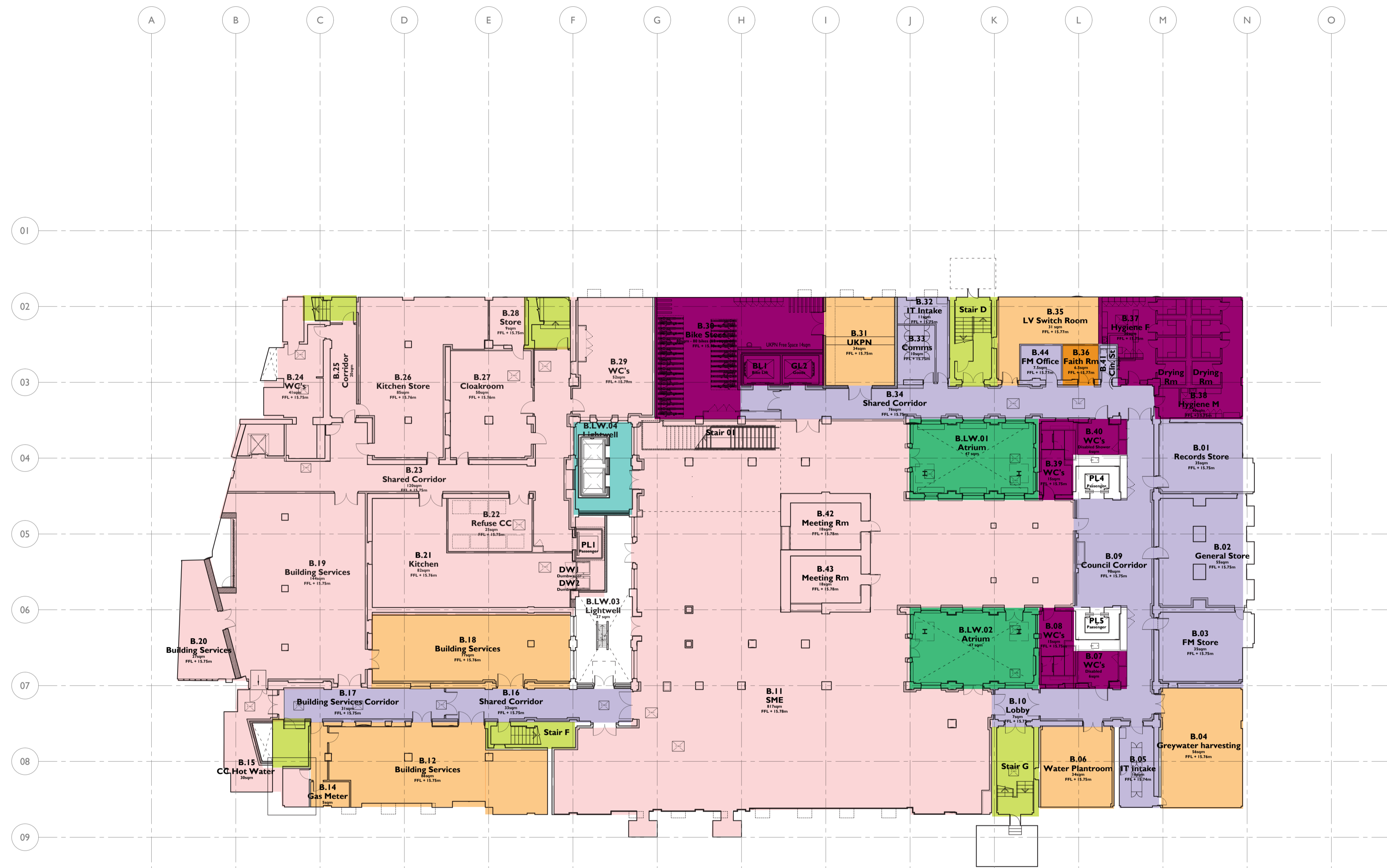

Floor Build-Up Key

FL-02	FN-04 Clear Floor Paint (M12-110A) on New Slab
FL-03	FN-05 Anti-Slip Floor Paint (M12-110B) on Existing Slab
FL-04	FN-07 Carpet (M51-110A) on Existing Parquet
FL-05A	FN-08 Carpet Tiles (M50/130A) on New/Existing Slab
FL-05B	FN-08 & FN-10 Carpet Tiles (M50-130A/B) on Existing Parquet
FL-06A	FN-06 Rubber (M50-150A) on New/Existing Slab
FL-06B	FN-06 Rubber (M50-150A) on Existing Parquet
FL-07	FN-01 Timber Effect Vinyl (M50-110A) on Existing Parquet
FL-08	FN-45 Porcelain Tile (Q25-310A) on Existing Slab
FL-09A	FN-03 & FN-39 Porcelain Tile (M40-110A) on Existing Slab
FL-09B	FN-48 Porcelain Tiles (M40-110C) on New Slab
FL-09C	FN-03 Porcelain Tiles (M40-110A) on Existing Parquet
FL-10A	FN-11 Barrier Matting (N10-290) on New Slab
FL-10B	FN-11 Barrier Matting (N10-290) on Existing Slab
FL-11A	FN-49 Levelling Compound (M10-130A) on Existing Slab
FL-11B	FN-50 Bonded Screed (M10-194B) on Existing Slab
FL-12	New Slab - To be finished by tenant
FL-13	Removal of Existing Finishes - retain Parquet where present
FL-14	Existing Finish Retained - For conservation repairs to existing finishes refer to Internal Conservation Schedule of Works CTH-PUR-XXX-RP-08-A-7003
FL-15	Reclaimed Parquet (CS1-275) on New Slab

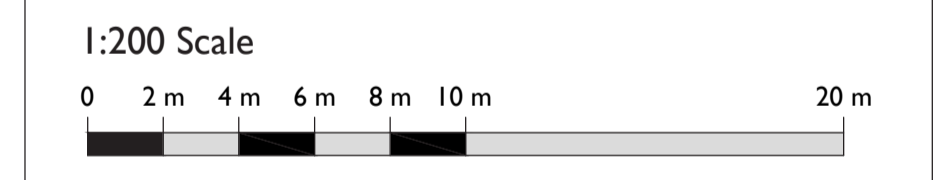

T01	13 Jan 2020	OB	JE
T00	27 Sep 2019	oliverbeddard	

First Issue 27 Sep 2019 oliverbeddard JE

ISSUE	DATE	DRAWN	CHECKED	DESCRIPTION
DRAWING TITLE	FLOOR BUILD UPS & FINISHES BASEMENT FLOOR			
DRAWING NO.	CTH-PUR-80-DR-43-A-5500			
REVISION	T01			
SIZE & SCALE	A1L 1:200			
DRAWING STATUS	ISSUED FOR TENDER			

CLIENT	Lendlease	
PROJECT	Camden Town Hall	
JOB NUMBER	238664	

I BASEMENT LEVEL PLAN - FLOOR BUILD-UPS & FINISHES
 5500 1:200 @ A1

