

- No. Note
- All dimensions to be verified on site by GENERAL CONTRACTOR prior to any work, setting out or shop drawings being prepared.
 - The contractor not to scale the drawings. Work to figured dimensions only.
 - © copyright SAUNDERS BOSTON LIMITED. All rights reserved. This drawing remains the property of SAUNDERS BOSTON LIMITED at all times and may not be reproduced or copied in whole or in part without their prior written consent.
 - This drawing and related specifications are for use only in the stated location.
 - This drawing is to be read in conjunction with all other Consultants drawings and specifications.
 - Drainage has not been surveyed and any/all pipe locations and below ground drainage runs are indicative.
 - It is assumed that all works will be carried out by a competent contractor who will be working, where appropriate, to an approved method statement.

- KEY**
- Rotafix Aquachem Primer + 2 coats aquachem grey lapped up to DPC (injected) **M60/180**
 - Tanking cavity drain system **J40/290**
 - Sikamur injectocream diffusion chemical damp proof course system (to dashed areas) **C45/220**
 - Waterproofing render system **M20/161**

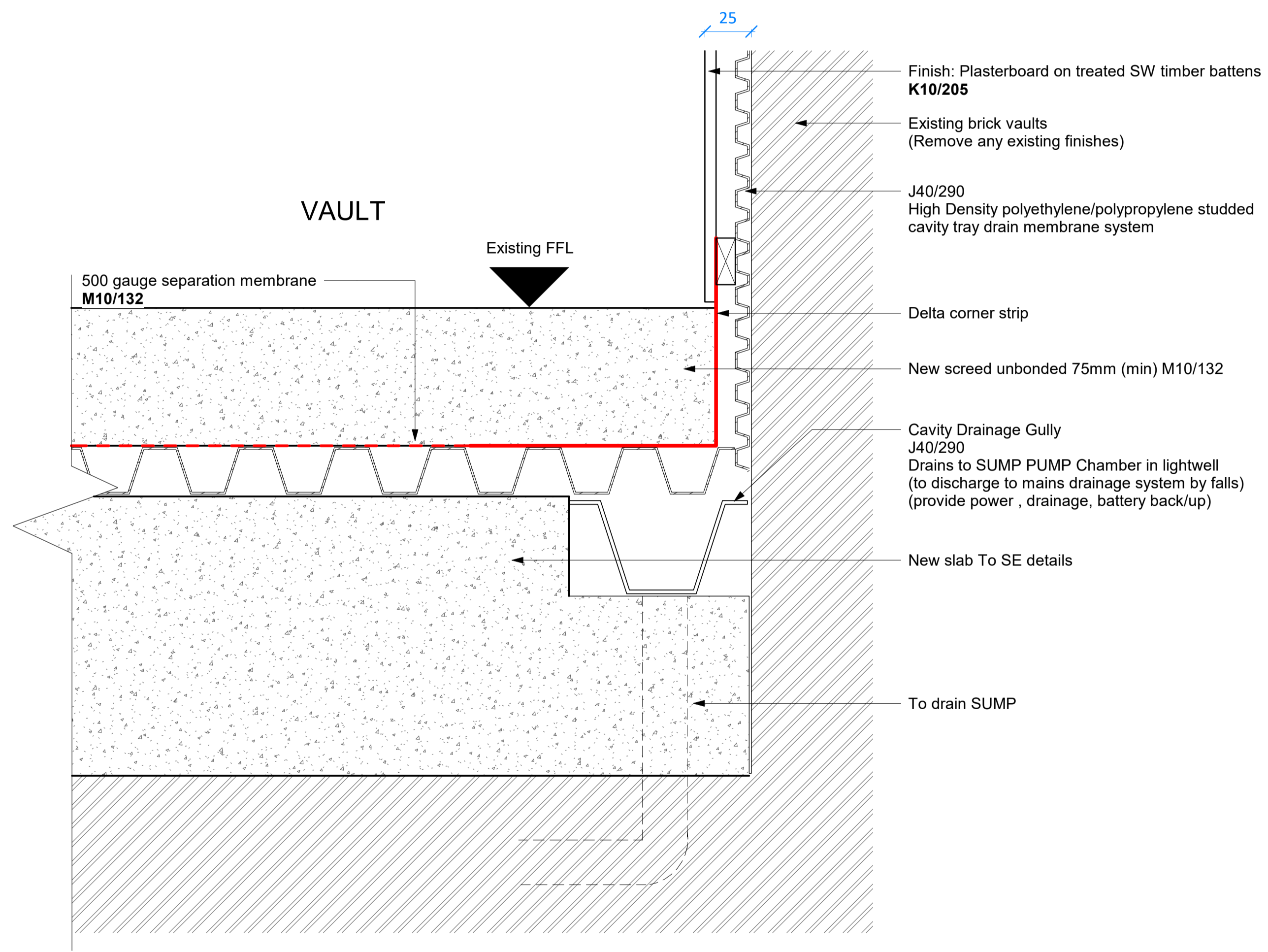
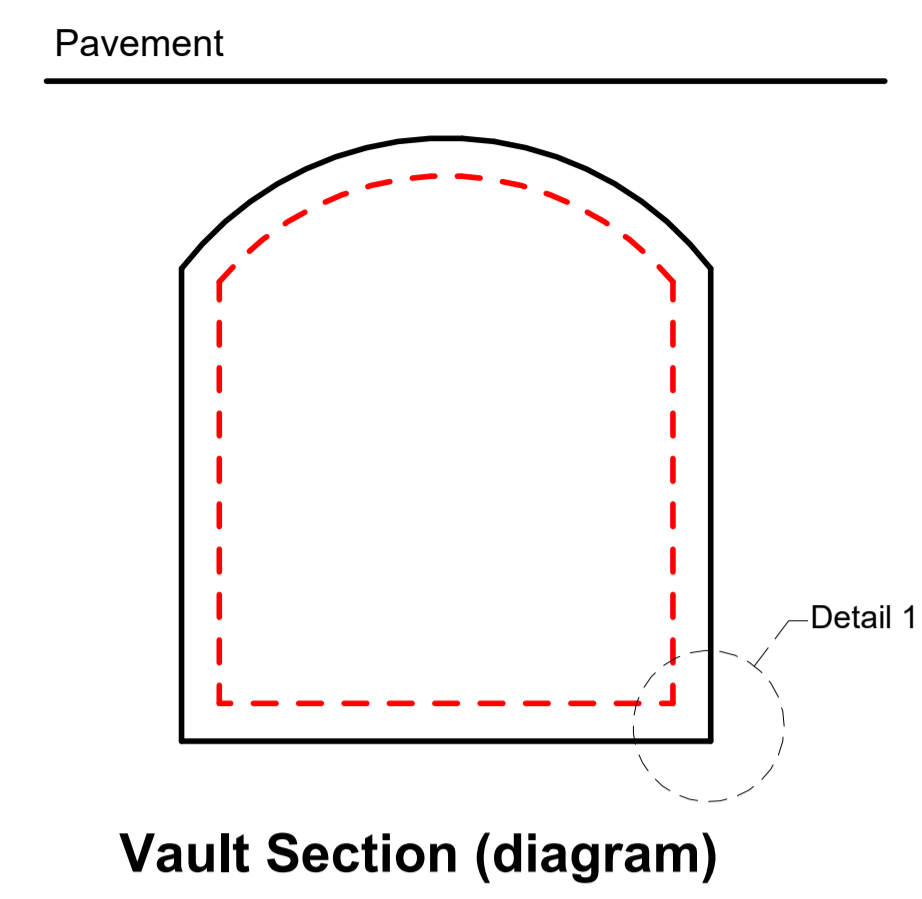
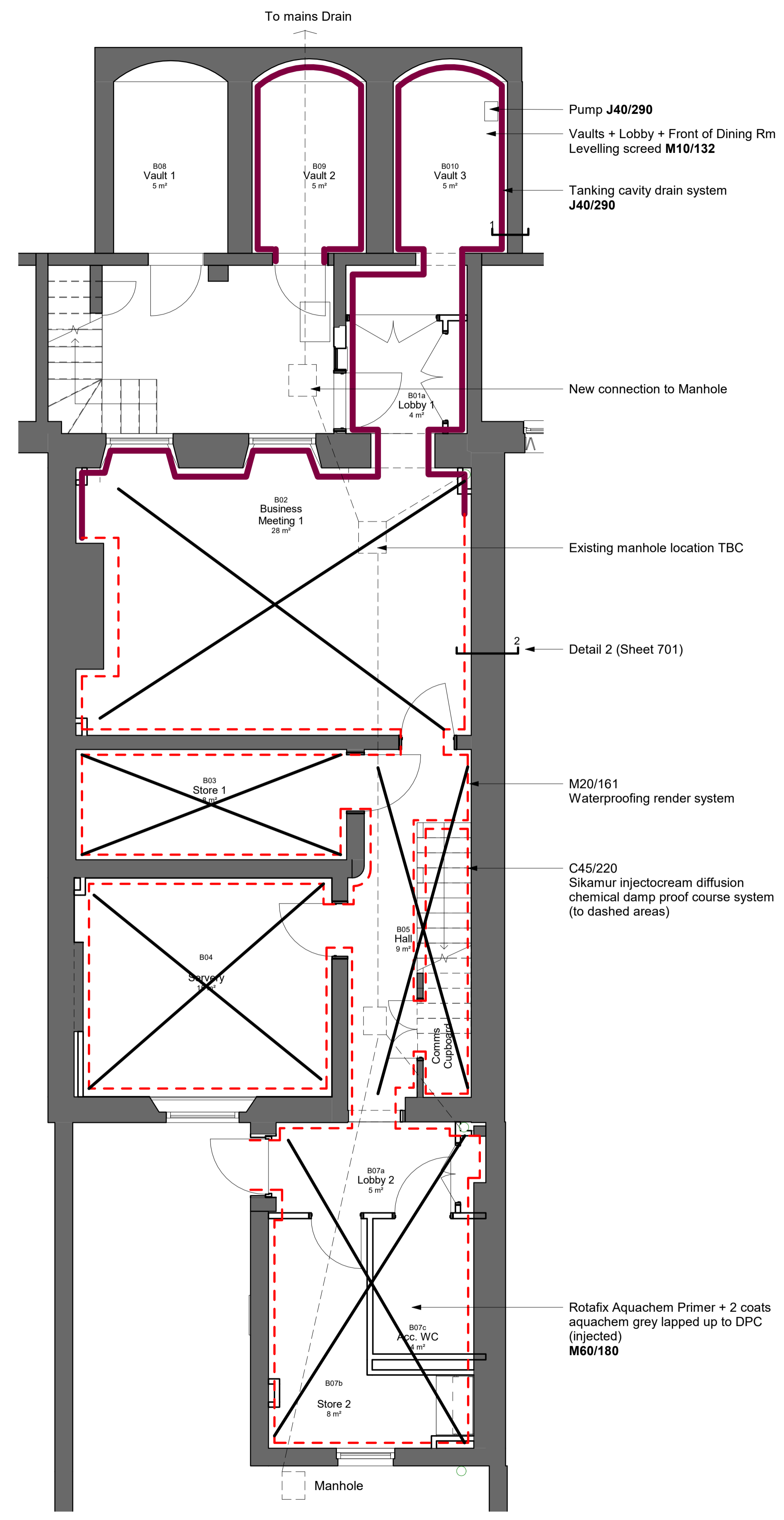

No.	Revision	Date	Checked	Auth.
P3	Updated Planning Issue	03/09/20	SBA	RJB
P2	Planning Issue	27/08/20	SBA	RJB
P1	Stage 4	21/08/20	SBA	AA
No.	Revision	Date	Checked	Auth.

Saunders Boston Architects

Eastern Gate House, 119 Newmarket Road, Cambridge CB5 8HA
T: 01223 367733
office@saundersboston.co.uk

The Generator, The Gallery, King's Wharf The Quay, Exeter EX2 4AN
T: 01392 349621
www.saundersboston.co.uk

University College London

Job: 14 Endsleigh Street

Drawing: B0 Waterproofing Vaults

Scale: As indicated @A1

Revision: **P3**

SBA Project Code: 1802	Drawn: SBA	Date: 08/19/20	Checked: AA	Suitability Code:
STAGE 4		project: 1802		
originator: SBA		zone: -SBA-XX-B0	level: -DR-A-	type: 700