

FIRST FLOOR AS APPROVED

Door to access the bedroom 02 to be removed & relocated
 New cupboard for bedroom 01 over the existing stairs. H=1420 mm S=1000 mm
 Door to access the bedroom 01 to be removed & relocated
 All new materials to match existing

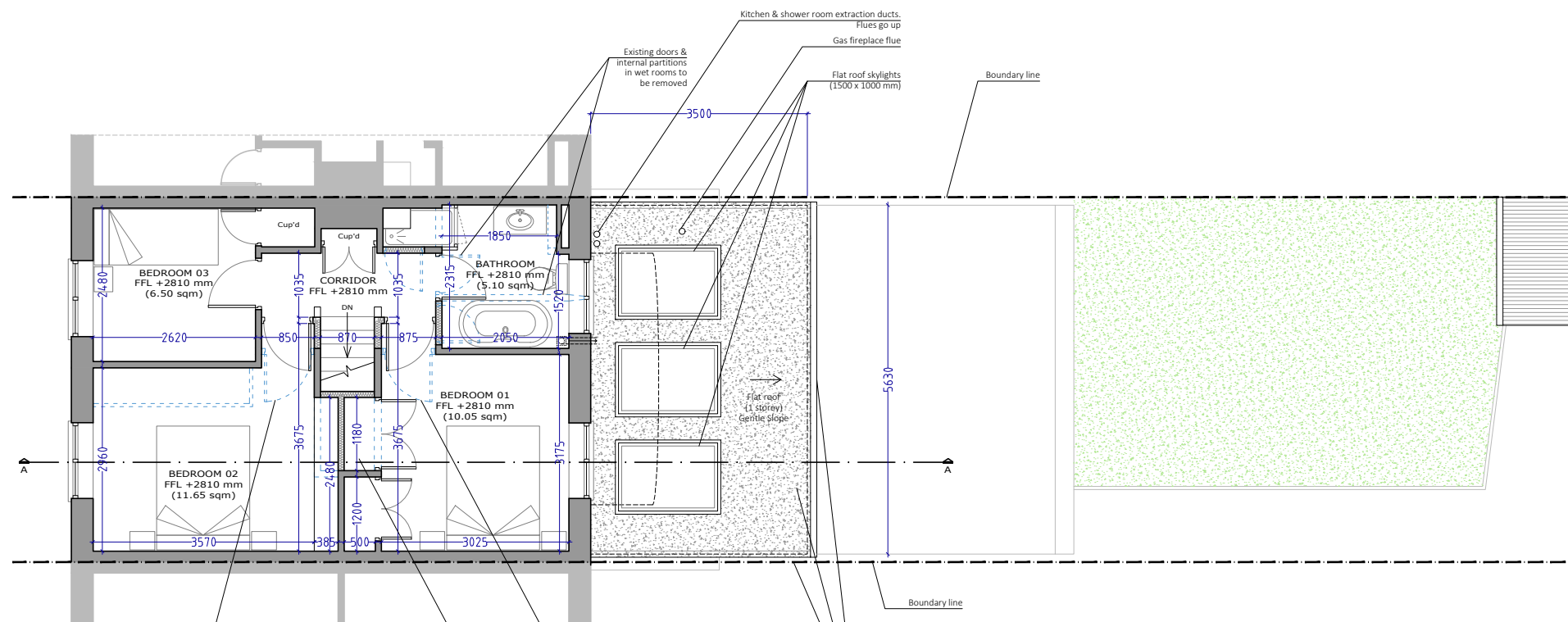

PROPOSED FIRST FLOOR

Door to access the bedroom 02 to be removed & relocated
 New cupboard for bedroom 01 over the existing stairs. H=1420 mm S=1000 mm
 Door to access the bedroom 01 to be removed & relocated
 All new materials to match existing



	EXISTING WALL
	DEMOLISHED WALL
	PROPOSED NEW CAVITY WALL
	PROPOSED STUD WALL
	PROPOSED BLOCK WALL
	BOUNDARY LINE

PROJECTION ARCHITECTS
 7, 30 GLOUCESTER CRESCENT
 LONDON
 NW1 7DL
 TEL. 02078 134592
 ARCHITECT@PROJECTIONARCHITECTS.COM
 WWW.PROJECTIONARCHITECTS.COM

RIBA  **ARB** 
 Chartered Practice Architects Registration Board

PLEASE NOTE
 1. All dimensions to be verified on site.
 2. All dimensions are in millimeters.
 3. No work shall commence until all approvals and agreements have been obtained. These include, Planning, Building Regulations, Thames Water and party Wall.
 4. The Copyright of this drawing belongs to Projection Architects Ltd.

CLIENT
 MS. SEI HOWE

PROJECT
 SINGLE STOREY
 REAR EXTENSION
 & INTERNAL ALTERATIONS

ADDRESS
 51 Dobson Close
 London
 NW6 4RU

TITLE
 First Floor plans

DATE 02/09/20	PROJECT NUM: P-20.020
SCALE 1/100 (@ A3)	DRAWING NUM: A-02
REV. B	STATUS PL