

Roof 75825
 Sixth Floor 72575
 Fifth Floor 69350
 Fourth Floor 66125
 Third Floor 62900
 Second Floor 59675
 First Floor 56450
 Ground Floor 52400
 Loading Bay 51200

Roof 85250
 Eighth Floor 81650
 Seventh Floor 78050
 Sixth Floor 74450
 Fifth Floor 70850
 Fourth Floor 67250
 Third Floor 63650
 Second Floor 60050
 First Floor 56450
 Ground Floor 52400



1 EAST ELEVATION - PROPOSED
 Scale: 1:125

GENERAL NOTES:
 Do not scale from this drawing.
 Check drawing on receipt and immediately report any discrepancies to the Architect.
 Verify all dimensions and levels on site prior to construction.
 The contents of this drawing are Stiff + Trevillion Architects Ltd copyright and shall not be re-used without their written permission.

Revisions	Rev.	Date	Note	Approved

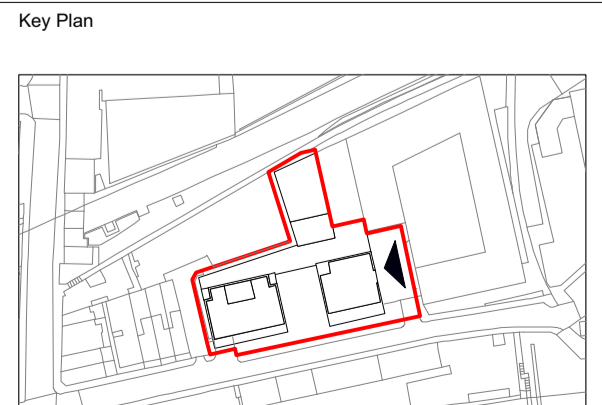

Stiff + Trevillion
 Stiff + Trevillion Architects Ltd
 16 Woodfield Road
 London W9 2BE
 T +44(0)20 8960 5550
 mail@stiffandtrevillion.com
 www.stiffandtrevillion.com

Client
 GP
 Project No. 4153
 Project BLACKBURN ROAD
 NW6 1RZ
 Drawing Title
 EAST ELEVATION
 PROPOSED

Drawing Status
STAGE 2
 Date JUNE 2020
 Scale @ A1 1:125
 Scale @ A3 1:250
 Drawing No. ST-PR-03-101
 Revision 2A