

MATERIALS SPECIFICATION

- EXISTING BUILDING REPAIRS**
1. GENERALLY, ALL REPAIRS TO USE TRADITIONAL MATERIALS AND DETAILS TO MATCH EXISTING ELEMENTS
 2. RETAINED FACADES ARE TO BE REPAIRED.
 - BROKEN/DAMAGED BRICKS AND
 - BROKEN AND DAMAGED TERRACOTTA/FAIENCE AND STONEMORY TO BE REPLACED
 - MASONRY TO BE CLEANED AND WHERE NECESSARY, REPOINTED
 - LEAD FLASHINGS TO BE REPLACE
 - REMOVAL OF ALL NON ORIGINAL CABLING AND SERVICES
 - RAINWATER GOODS TO BE REPLACED WITH NEW CAST IRON PIPES AND HOPPERS
 3. EXISTING ROOF FINISHES TO BE REPLACED WITH NATURAL WELSH SLATE AND LEAD WEATHERINGS
 4. EXISING WINDOWS AND FRENCH DOORS TO BE REPLACED WITH PAINTED HARDWOOD CASEMENT WINDOWS WITH SLIMLINE SEALED DOUBLE GLAZED UNITS
 5. DORMER WINDOWS TO BE REPAIRED AND REDECORATED

- EXISTING BUILDING ALTERATIONS AND ADDITIONS**
1. ALL ALTERATIONS AND ADDITIONS TO USE TRADITIONAL MATERIALS AND DETAILS TO MATCH EXISTING ELEMENTS
 2. FACADES TO BE IN HANDMADE RED-MULTI FACING BRICKWORK LAID IN FLEMISH BOND USING LIME MORTAR.
 3. ARCHITECTURAL FEATURES TO BE IN TERRACOTTA / FAIENCE AND STONE (DEPENDING ON LOCATION) TO MATCH EXISTING
 4. CAST IRON RAINWATER PIPES AND HOPPER HEADS
 5. PAINTED HARDWOOD DORMER WINDOWS TO MATCH EXISTING
 6. ROOF FINISH - NATURAL WELSH SLATE WITH LEAD WEATHERINGS
 7. PAINTED HARDWOOD CASEMENT WINDOWS AND FRENCH DOORS WITH SLIMLINE SEALED DOUBLE GLAZED UNITS

- NEW BUILDINGS**
1. FACADES TO BE IN HANDMADE RED-MULTI FACING BRICKWORK LAID IN FLEMISH BOND USING LIME MORTAR.
 3. ARCHITECTURAL FEATURES TO BE IN RECONSTITUTED STONE OR NATURAL STONE
 4. CAST IRON RAINWATER PIPES AND HOPPER HEADS
 5. HARDWOOD DORMER WINDOWS
 6. ROOF FINISHES: GENERALLY HANDMADE CLAY ROOF TILES WITH LEAD TOP AND WEATHERINGS. ROOF FINISH TO NEW SOUTH EASTERN BUILDING TO BE NATURAL WELSH SLATE WITH LEAD WEATHERINGS
 7. WINDOWS TO BE SLIM STEEL FRAMED DOUBLE GLAZED UNITS, SUCH AS CRITALL OR SIMILAR
 8. PAINTED HARDWOOD FRENCH DOORS WITH SLIMLINE SEALED DOUBLE GLAZED UNITS



6 PROPOSED EAST ELEVATION - GATE HOUSE
 Scale: 1:100



5 PROPOSED NORTH ELEVATION
 Scale: 1:100



3 PROPOSED EAST ELEVATION
 Scale: 1:100



7 PROPOSED NORTH - WEST ELEVATION
 Scale: 1:100

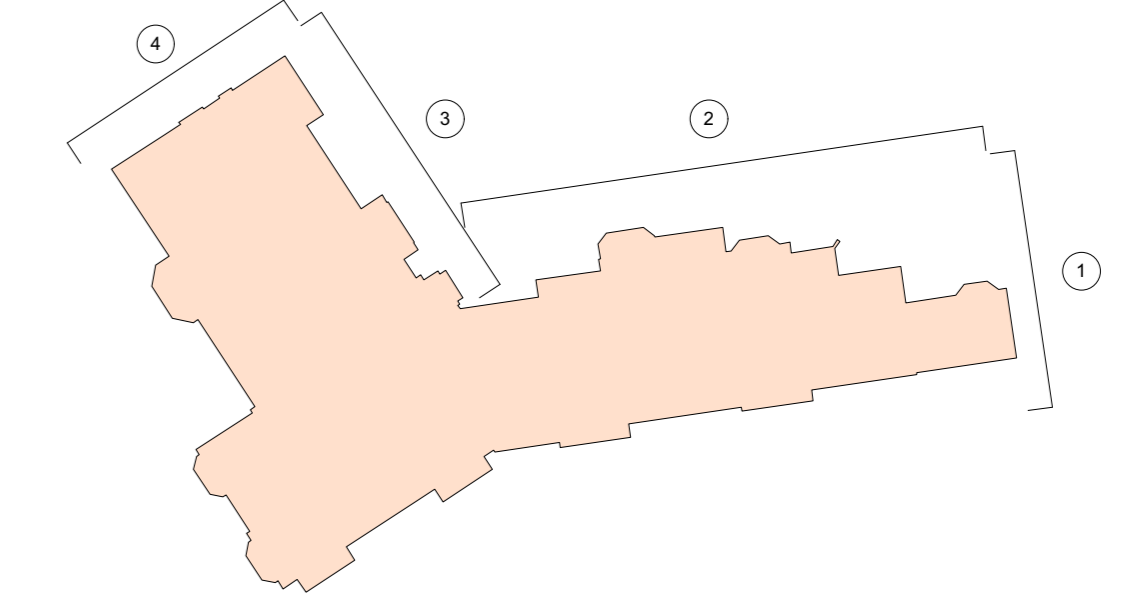

REV	DATE	DESCRIPTION
P05	22/08/20	CHIMNEY IN NORTH WEST ELEVATION UPDATED
P04	15/06/20	FLAT 30 ROOF AND CHIMNEY UPDATED
P03	27/05/20	FLAT 30 ROOF AND CHIMNEY UPDATED. TWO DORMERS ADDED IN NORTH ELEVATION
P02	06/05/20	ELEVATIONAL CHANGES OF DOORS AND CHIMNEYS. FOOTPRINT UPDATED
P01	21/02/20	ELEVATION CHANGES AND ADDITIONAL DETAILS

**BRANCH HILL HOUSE
 LONDON**

PROPOSED EAST, NORTH AND
 NORTH - WEST ELEVATIONS

DRNG No	SCALE	DATE
PL-24 P05	1:100 @ A0 1:200 @ A2	FEB 2020



5 ST JAMES'S SQUARE
 LONDON SW1Y 4JU
 T 020 7451 0955 mail@stanhopegate.co.uk
 www.stanhopegatearchitecture.com