



Do not scale. All dimensions to be confirmed on site. Information contained in this drawing is the sole copyright of Orms designers + architects ltd and is not to be reproduced without permission.

The setting out and dimensions of any existing building elements shown are based on collated archive information, measured surveys and site investigations as available. If there is any reasonable doubt in relation to position of existing building fabric which affects costs or final construction details the contractor should undertake relevant surveys to verify the information, and any changes discovered should be notified to the architect.

This drawing should be read in conjunction with all other project information prepared by Orms and design consultants. In the event of any conflicts between information on this drawing and other project information that may be contained on models, specifications, schedules, etc. seek clarification with Orms.

Please note that dwg or other cad formats provided in addition to pdf documentation are issued to aid co-ordination only. Use of written dimensions and levels is permitted, but all other dimensions extracted from the digital content are not to be relied upon. Data should always be checked against pdf information.

Drawings issued with construction record status or revision are not surveys and are to be verified on site prior to making any use of them. Orms do not take responsibility for any discrepancies between the drawings and actual as built condition.

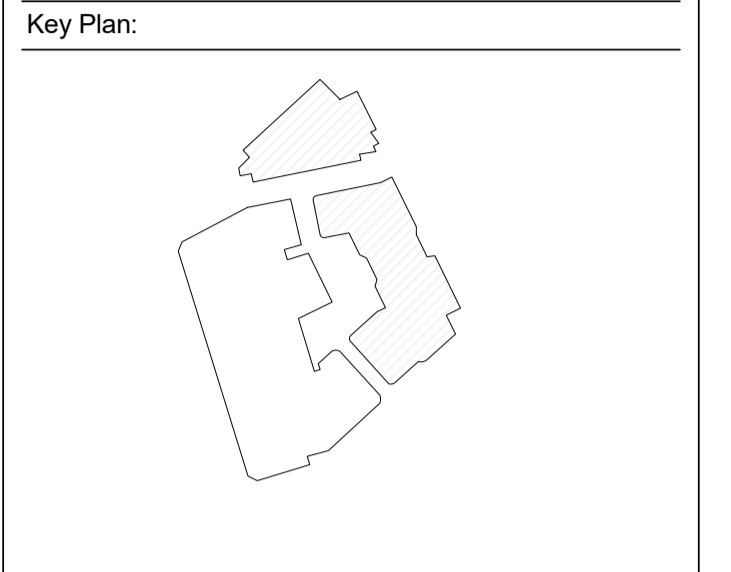

CDM risks relevant to this drawing:

Notes:

NOTE: Internal layouts are indicative only

Courtyard furniture and planter design is indicative only and subject to design development.

- Existing building fabric
- Proposed building fabric
- Site Ownership Line

P01	20.03.20	Draft Planning Issue
P02	20.04.20	Planning Issue
P03	24.08.20	Fisher Street Elevation Update - Planning Issue
Rev.	Date	Description

Issued for:
PL - Planning

Orms

1 Oliver's Yard
55-71 City Road
London
EC5Y 1HQ
0207 833 8533
orms@orms.co.uk
orms.co.uk

Project:
The Former Central St. Martin's Site

Drawing title:
Proposed
General Arrangement Plans
Ground Floor Plan

Scale@A1	Project No.
1 : 200	2233
Drawing Number	Rev.
GSM-ORM-ZZ-00-DR-A-12200	P03

