



Method statement for the avoidance of physical damage to roots during boundary wall demolition & construction at 73-75 Avenue Road London NW8 6JD

- The brick built boundary walls at 73-75 Avenue Road are to be removed and replaced-see detail in Appendix A of this briefing note. The new wall on Queens Grove will be shifted 500mm away from the retained trees and the walls on the boundary with 38 Queens Grove & 77 Avenue Road will be replaced on their existing lines. The wall beside Queens Grove has been removed carefully to ground level by Knight Build, working off adjoining hard standing and with due care.
- Planned works are for the footings of the old walls to be removed and for a new replacement walls to be constructed on the line shown at Appendix A or on existing lines. The intention is to establish positions for 200mm diameter mini piles located to avoid significant roots (>25mm diameter), which will be retained and spanned/bridged as required.
- Soft ground within the root protection areas (RPA) of retained trees close to boundary walls must be protected through the course of wall demolition/construction/reconstruction. A 150mm layer of composted bark mulch will improve soil condition in the medium term and this can be spread and overlaid with ground protection such as Ground Guard or Eve Trakway sheets or similar-subject to approval from the Camden tree officer. Details can be provided if required.
- The removal of existing walls and footings must be carried out carefully by hand using hand held tools only & by an appropriately qualified operative. The excavation of any trenches or mini pile locations (to a minimum depth of 600mm) within RPAs must be carried out using compressed air soil displacement-by an appropriately qualified & briefed operative. Trenches must be kept as narrow as possible and soil must be removed extremely carefully from around any roots encountered and root bark must be retained undamaged.
- If exposed roots of greater than 25mm diameter are encountered in proposed mini pile locations these must be retained intact and the advice of the project arboriculturist sought. After consultation with the Camden tree officer the relevant roots will either be removed or an alternative arrangement made i.e. a different pile location chosen.
- Smaller diameter roots (<25mm diameter) encountered can be removed making clean cuts using a sharp tool e.g. secateurs or a hand saw, except where they occur in clumps. Retained exposed roots must be wrapped or covered e.g. with dry hessian sacking to avoid desiccation and to protect from rapid temperature changes.



- Excavated topsoil/subsoil should be stored separately. Prior to backfilling retained significant roots must have their protective wrapping removed and can then be surrounded with topsoil/subsoil or uncompacted sharp sand or other loose inert granular fill material N.B builder's sand must **not be** used as it contains salt, which is toxic to roots. This fill must also be free of contaminants and other loose foreign objects potentially injurious to tree roots.
- All works must be supervised by carried out by appropriately briefed operatives. The project arboriculturist will be available on request or will supervise if required by Camden Council.

James Bell

Arbortrack Systems Ltd

07986122074

Email james@arbortrackservices.com

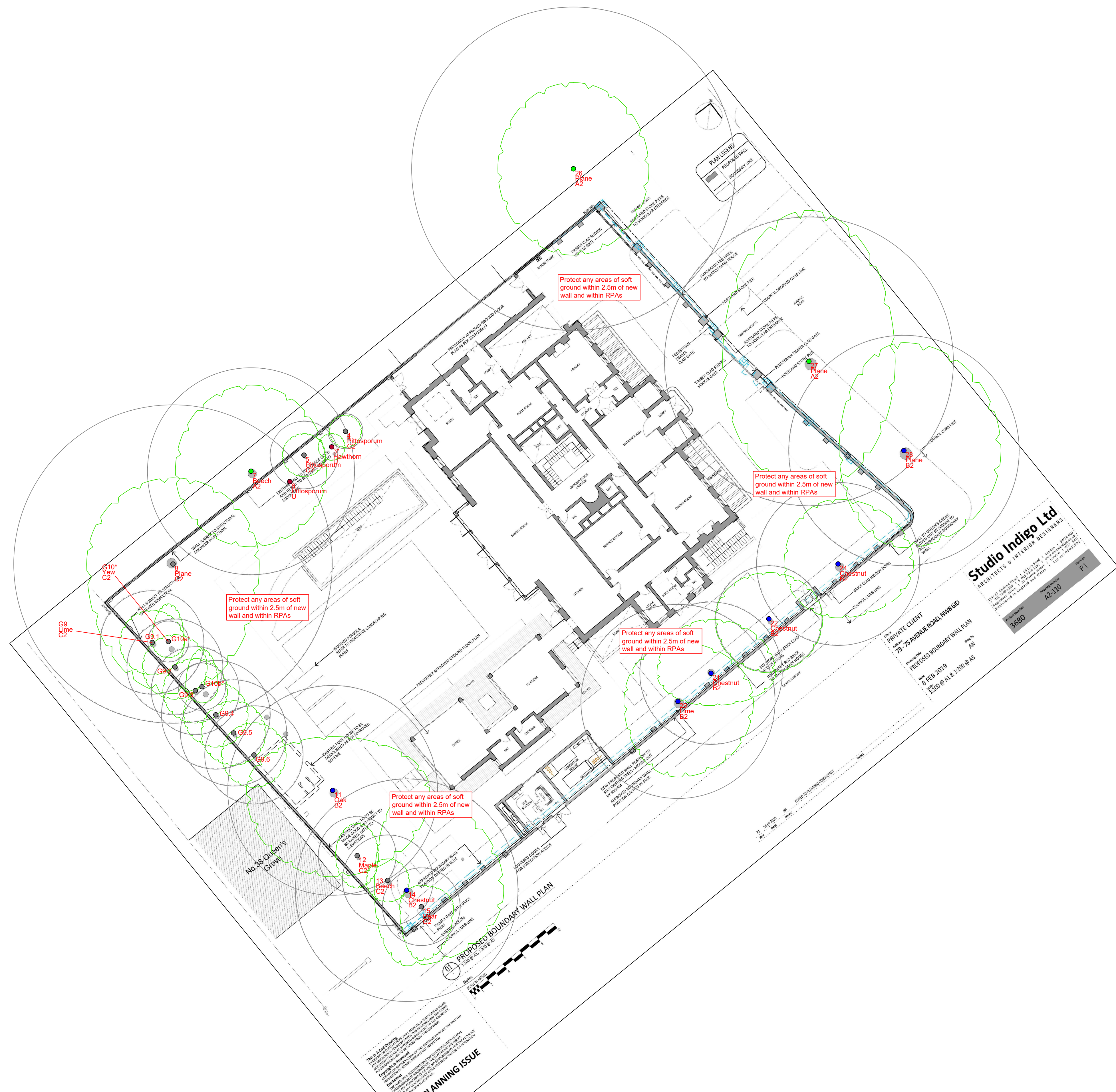

Arbortrack Systems Ltd

The Granary Studio, Crewe Lane, Kenilworth, CV8 2LA
07986 122074 / james.bell@arbortrack.com

Site: 73-75 Avenue Road

Drawing Title: Arboricultural Impact Assessment

1-200@A1

Appendix: A

Aug 2020

Key:

