



DISCLAIMER:
 DO NOT SCALE FROM THESE DRAWINGS. FOR ACCURACY, ALL DIMENSIONS AND SPECIFICATIONS MUST BE CONFIRMED AT THE SITE AND WITH RELEVANT TECHNICAL DRAWINGS.
 TO BE READ IN CONJUNCTION WITH STRUCTURAL ENGINEER'S DRAWINGS AND SPECIFICATIONS.
 TO BE READ IN CONJUNCTION WITH SERVICE ENGINEER'S DRAWINGS AND SPECIFICATIONS.
 ANY DISCREPANCY BETWEEN DRAWINGS AND DIMENSION ON SITE ARE TO BE BROUGHT TO THE ATTENTION OF THE ARCHITECT PRIOR TO CONSTRUCTION.

 TO BE REMOVED - SECTION
 TO BE REMOVED - VIEW

2020 © CHARLES TASHIMA ARCHITECTURE. ALL RIGHTS RESERVED.
 NO REPRODUCTION OR DESIGN CONTAINED WITHIN THIS DOCUMENT SHOULD BE COPIED OR REPRODUCED WITHOUT THE CONSENT OF CHARLES TASHIMA ARCHITECTURE.

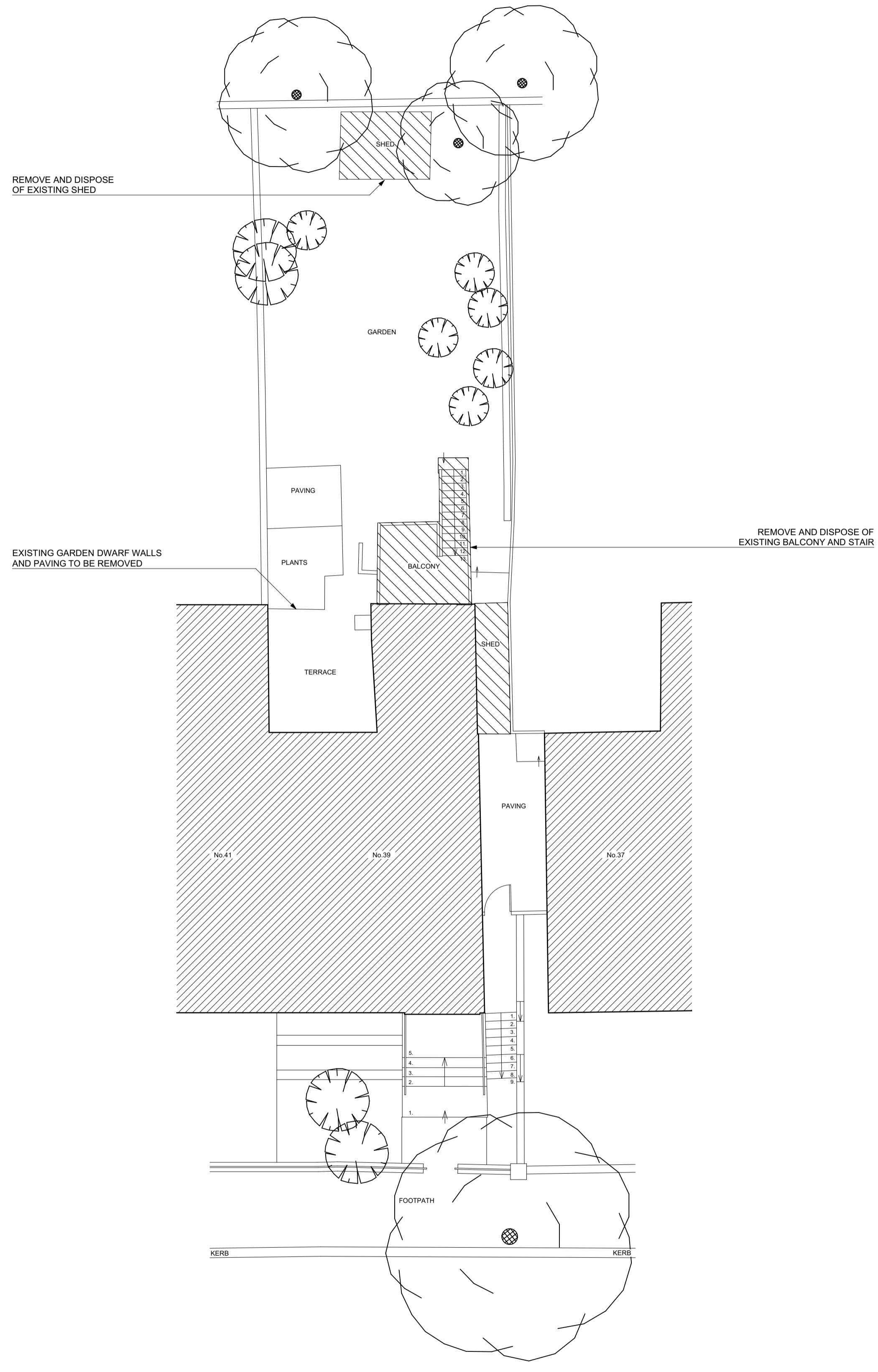

EXISTING

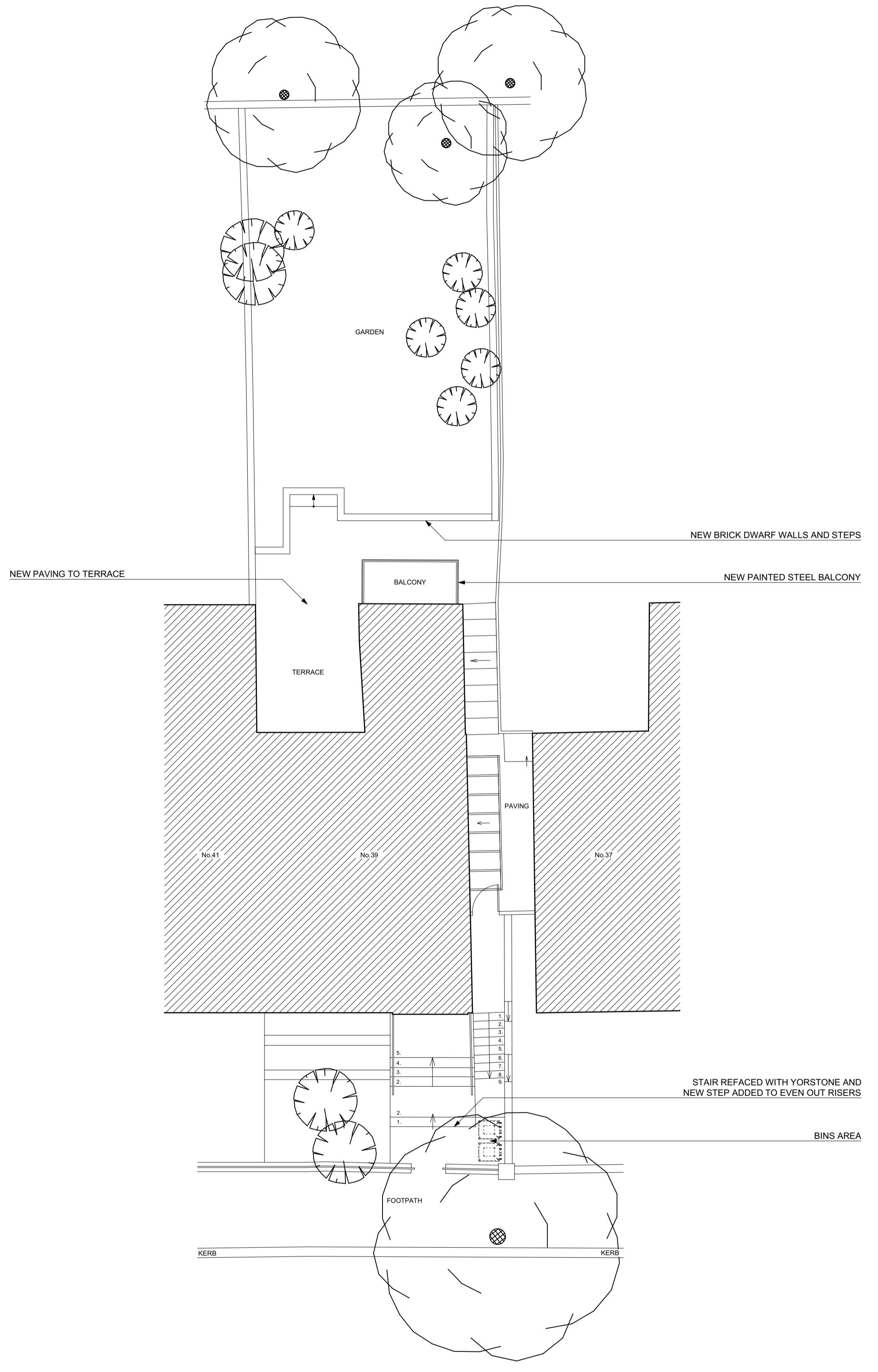

PROPOSED

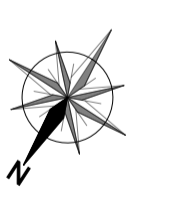

PLANNING

PROJECT: 39 DARTMOUTH PARK ROAD LONDON NW5 1SU	
PROJECT NUMBER:	1100
PROJECT STAGE:	PLANNING
ISSUE DATE:	AUGUST 2020
SCALE:	1:100 @ A1 1:200 @ A3
DOCUMENT NUMBER:	002
REVISION:	A

SUBJECT: EXISTING AND PROPOSED GARDEN PLAN	
CLIENT:	GEORGINA & NOEL CASEY
CHARLES TASHIMA ARCHITECTURE 12A Blackstock Mews London N4 2BT Landline: +44(0)20 7251 2351 Email: info@ct-arch.co.uk Website: www.ct-arch.co.uk	

