

1 EXISTING TOTTENHAM COURT ROAD ELEVATION
Scale: 1:100

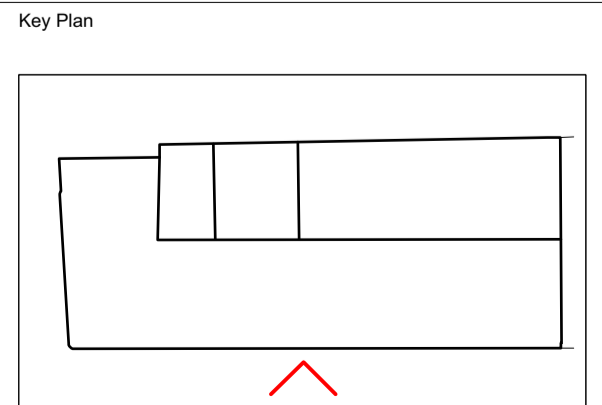

GENERAL NOTES:
Do not scale from this drawing.
Check drawing on receipt and immediately report any discrepancies to the Architect.
Verify all dimensions and levels on site prior to construction.
The contents of this drawing are Stiff + Trevillion Architects Ltd copyright and shall not be re-used without their written permission.

Revisions	Rev.	Date	Note	Approved



Stiff + Trevillion

Stiff + Trevillion Architects Ltd
16 Woodfield Road
London W9 2BE
T +44(0)20 8960 5550
mail@stiffandtrevillion.com
www.stiffandtrevillion.com

Client
Prudential UK Real Estate
Nominee 1 Ltd & Prudential
Real Estate Nominee 2 Ltd

Project No. 4486 Project 247 Tottenham Court Road,
W1T 7QZ

Drawing Title
EXISTING TOTTENHAM
COURT ROAD ELEVATION

Drawing Status
PLANNING

Date
03.07.2020

Scale @ A1 1:100 Scale @ A3 -

Drawing No.
EX-03-100

Revision
-