

2 EXISTING BAYLEY STREET ELEVATION  
Scale: 1:100

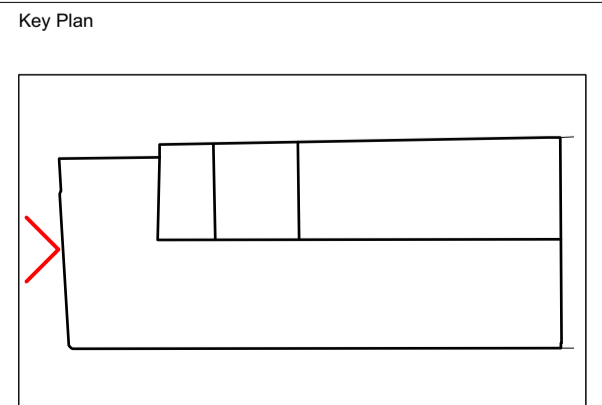

**GENERAL NOTES:**  
Do not scale from this drawing.  
Check drawing on receipt and immediately report any discrepancies to the Architect.  
Verify all dimensions and levels on site prior to construction.  
The contents of this drawing are Stiff + Trevillion Architects Ltd copyright and shall not be re-used without their written permission.

Revisions	Approved
Rev. Date	Note



**Stiff + Trevillion**

Stiff + Trevillion Architects Ltd  
16 Woodfield Road  
London W9 2BE  
T +44(0)20 8960 5550  
mail@stiffandtrevillion.com  
www.stiffandtrevillion.com

Client  
Prudential UK Real Estate  
Nominee 1 Ltd & Prudential  
Real Estate Nominee 2 Ltd

Project No. 4486 Project 247 Tottenham Court Road,  
W1T 7QZ

Drawing Title  
EXISTING BAYLEY ST  
ELEVATION

Drawing Status  
**PLANNING**

Date  
03.07.2020

Scale @ A1 1:100 Scale @ A3 -

Drawing No.  
EX-03-101

Revision  
-