



EXISTING FRONT VIEW OF 51 UPPER PARK RD



PROPOSED FRONT VIEW OF 51 UPPER PARK RD

KEY PLAN 1:500

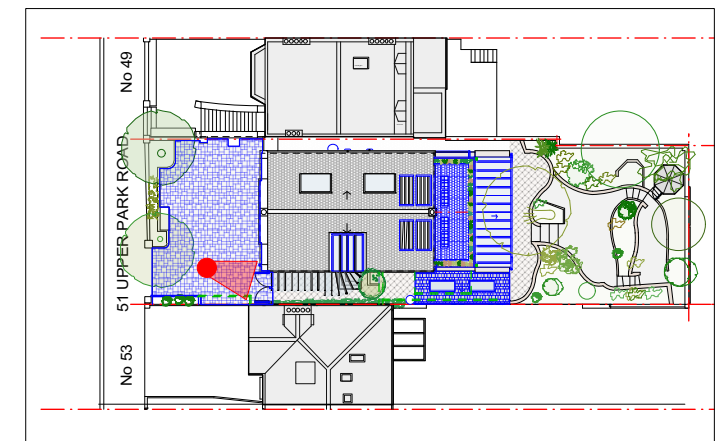

**EXISTING & PROPOSED VIEWS 01 - FRONT VIEW OF 51 UPPER PARK RD**

REV.	DATE	DESCRIPTION	REV.	DATE	DESCRIPTION	REV.	DATE	DESCRIPTION	NOTE:	CLIENT:	PROJECT:	SIMON MILLER ARCHITECTS		DATE:
									FOR THE PURPOSE OF PLANNING <u>ONLY</u> DRAWINGS CAN BE SCALED OFF.	ROSE-LEE LEVY	GROUND FLOOR SIDE EXTENSION. NEW WINDOWS AND NEW EXTERNAL PAVING. NEW SOLAR PANELS	info@simonmillerarchitects.com simonmillerarchitects	486 PV01	JULY 2020
									ALL DIMENSIONS ARE IN MILLIMETERS. INCONSISTENCIES ARE TO BE REPORTED TO THE ARCHITECT IMMEDIATELY.	SITE:	DRAWING TITLE:	T+44 (0)20 8201 9875	REVISION:	-
									COPYRIGHT IS HELD BY SIMON MILLER ARCHITECTS LTD.	51 UPPER PARK ROAD LONDON NW3 2UL	EXISTING & PROPOSED VIEWS 01 - FRONT VIEW OF 51 UPPER PARK RD	11 Portsdown Mews Temple Fortune London NW11 7HD		

**PRE PLANNING APPLICATION TO CAMDEN PLANNING DEPARTMENT**