

PROPOSED RAMP SECTION A
SCALE 1:20

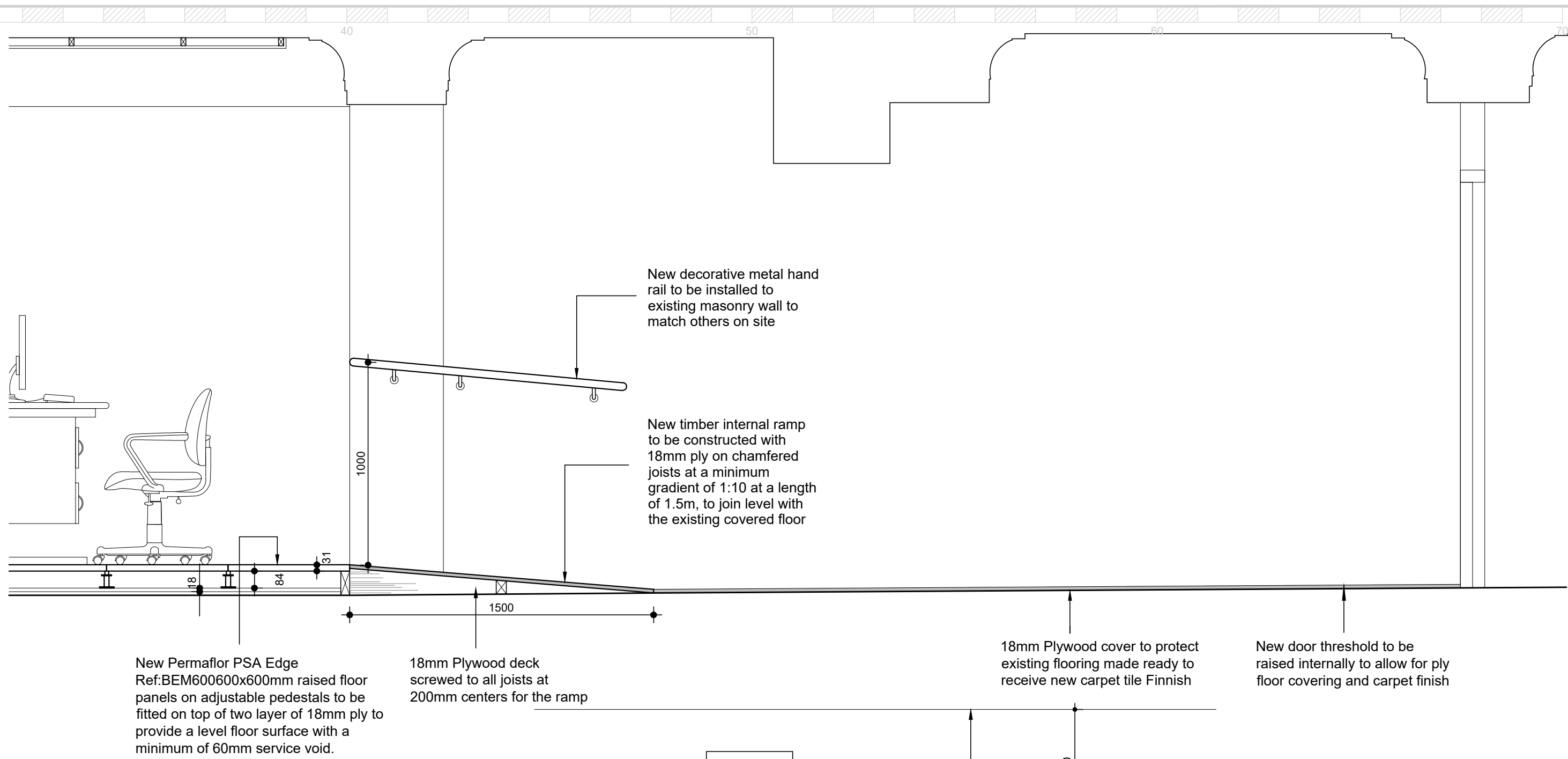

PROPOSED RAMP SECTION B
SCALE 1:20



Permaflor PSA Edge system

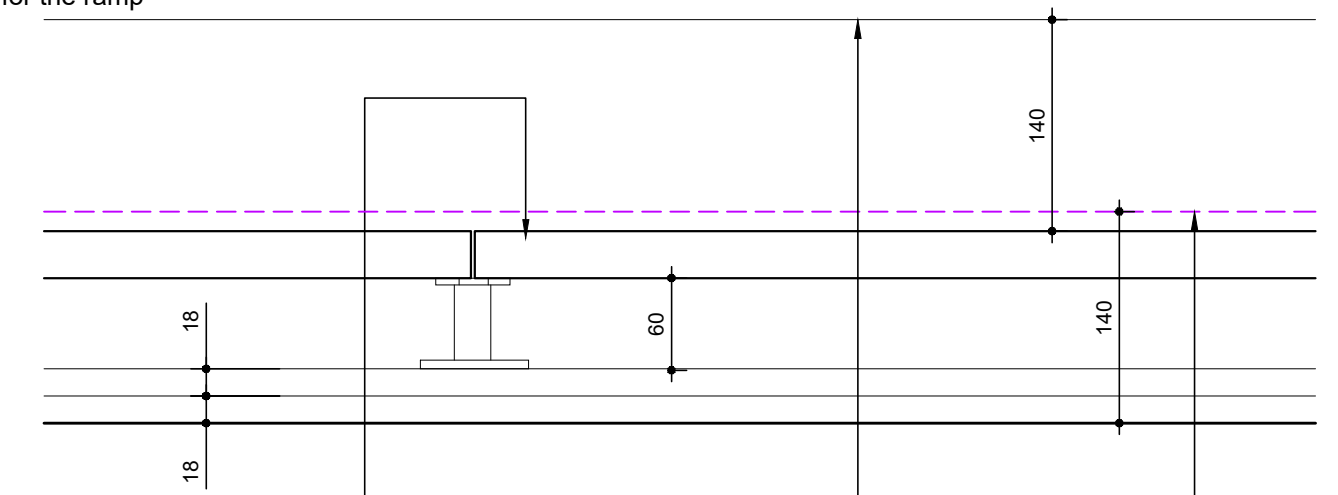

PROPOSED FLOOR DETAIL
SCALE 1:5

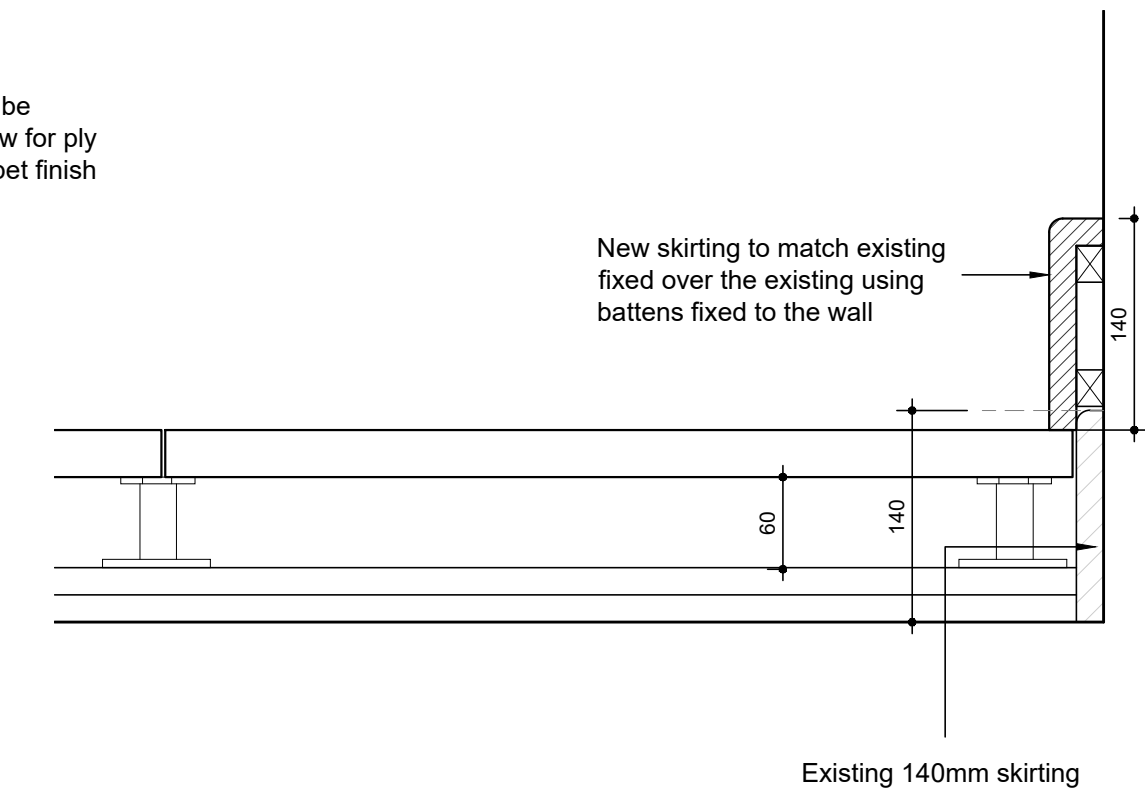

PROPOSED SKIRTING DETAIL
SCALE 1:5

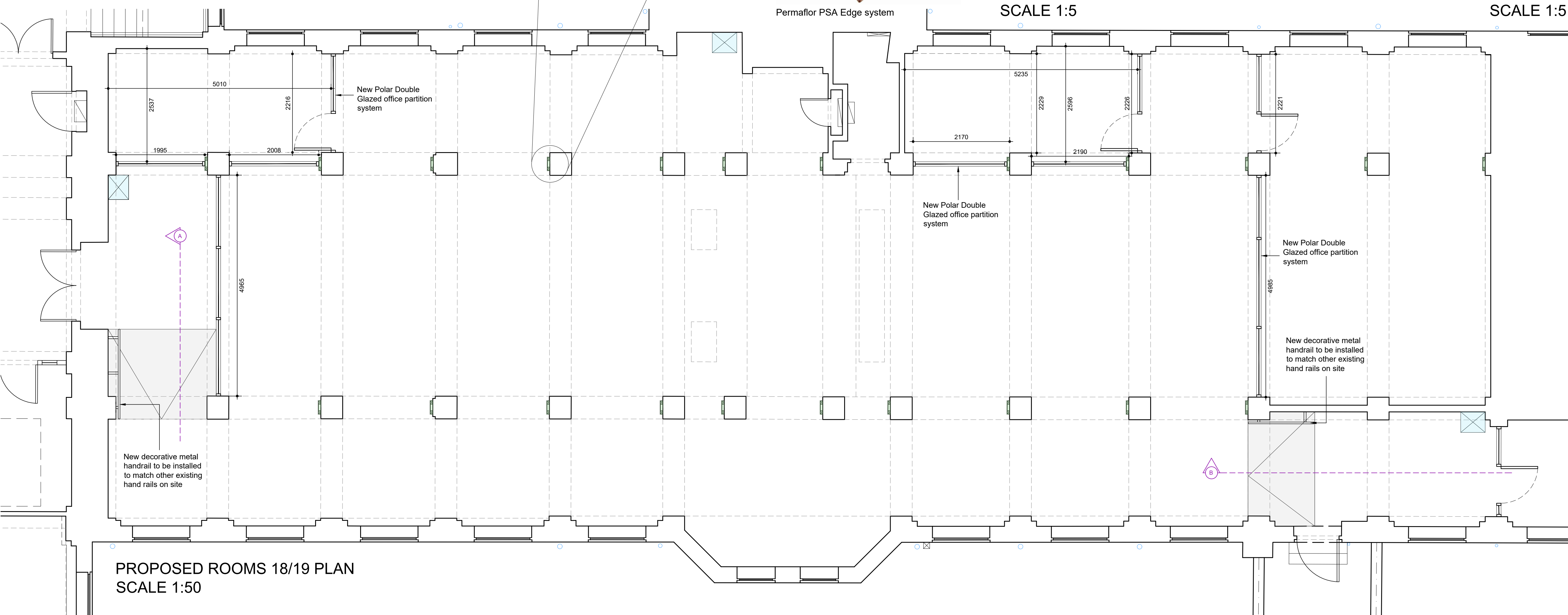

PROPOSED ROOMS 18/19 PLAN
SCALE 1:50

This drawing is copyright and must not be reissued, loaned or copied without the written consent of this practice, all dimensions must be checked on site before proceeding and any discrepancies notified immediately.

All drawings to be read in conjunction with consultant structural engineers, mechanical and electrical consultants, acoustic engineers, energy consultants, etc. design calculation sheets, specifications and drawings plus any accompanying product literature, accredited details, etc.

© Copyright Livmore



| Planning Issue | | |
|----------------|-----------|------|
| Rev. | Amendment | Date |
| | | |



| | | |
|-------------|---|--------------------|
| Client | UNITED GRAND LODGE OF ENGLAND | |
| Project | FREEMASONS HALL GREAT QUEEN STREET WC2 REFURBISHMENT OF LODGE ROOMS | |
| Title | PROPOSED UPPER GROUND LEVEL ROOMS 18/19 SETTING OUT PLAN | |
| Drawn by: | AG | Date: 17-06-20 |
| Checked by: | DE/RH | |
| Scale @ A1: | 1:20/50 | Drg. No.: 16911-11 |