

Extracted diagram from: M4(2) Category 2: Accessible and Adaptable dwellings

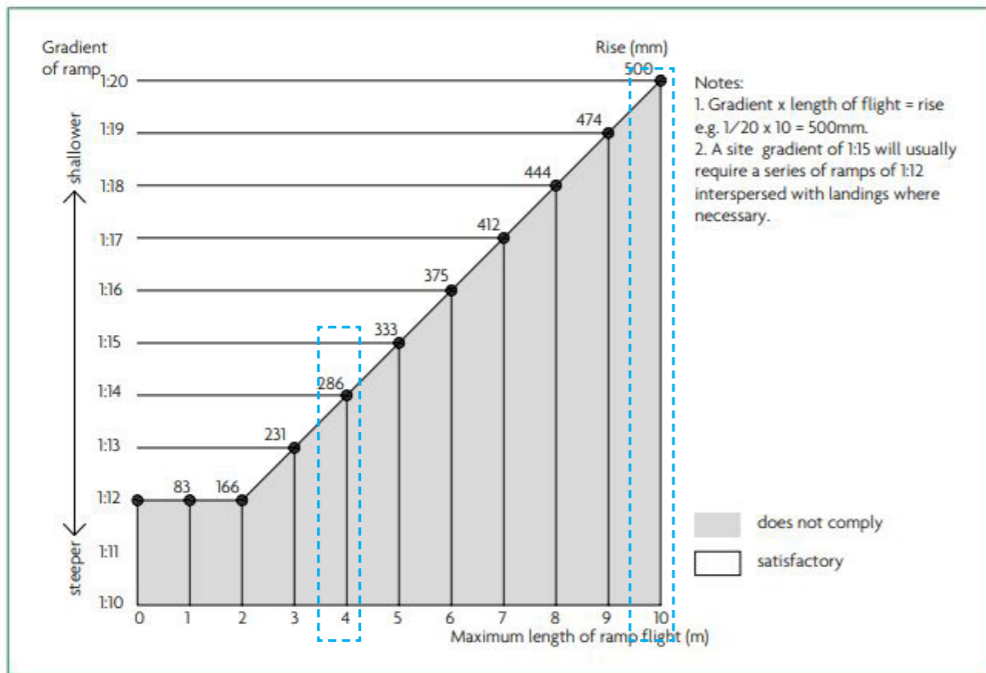

Diagram 2.1 Maximum length of ramp at a given gradient

Front Garden External Ramp

- Entry point into the site boundary is 71.89m AOD
- Entry point into the proposed flat is 72.66m AOD
- The difference in elevation is 0.77m requires an approximate **14m** ramp that is compliant to Building Regulations Part M(1)
- The distance between the site boundary and the proposed point of entry is 8.54m, therefore cannot accommodate a straight accessible ramp that is compliant to Part M



Proposed North Elevation

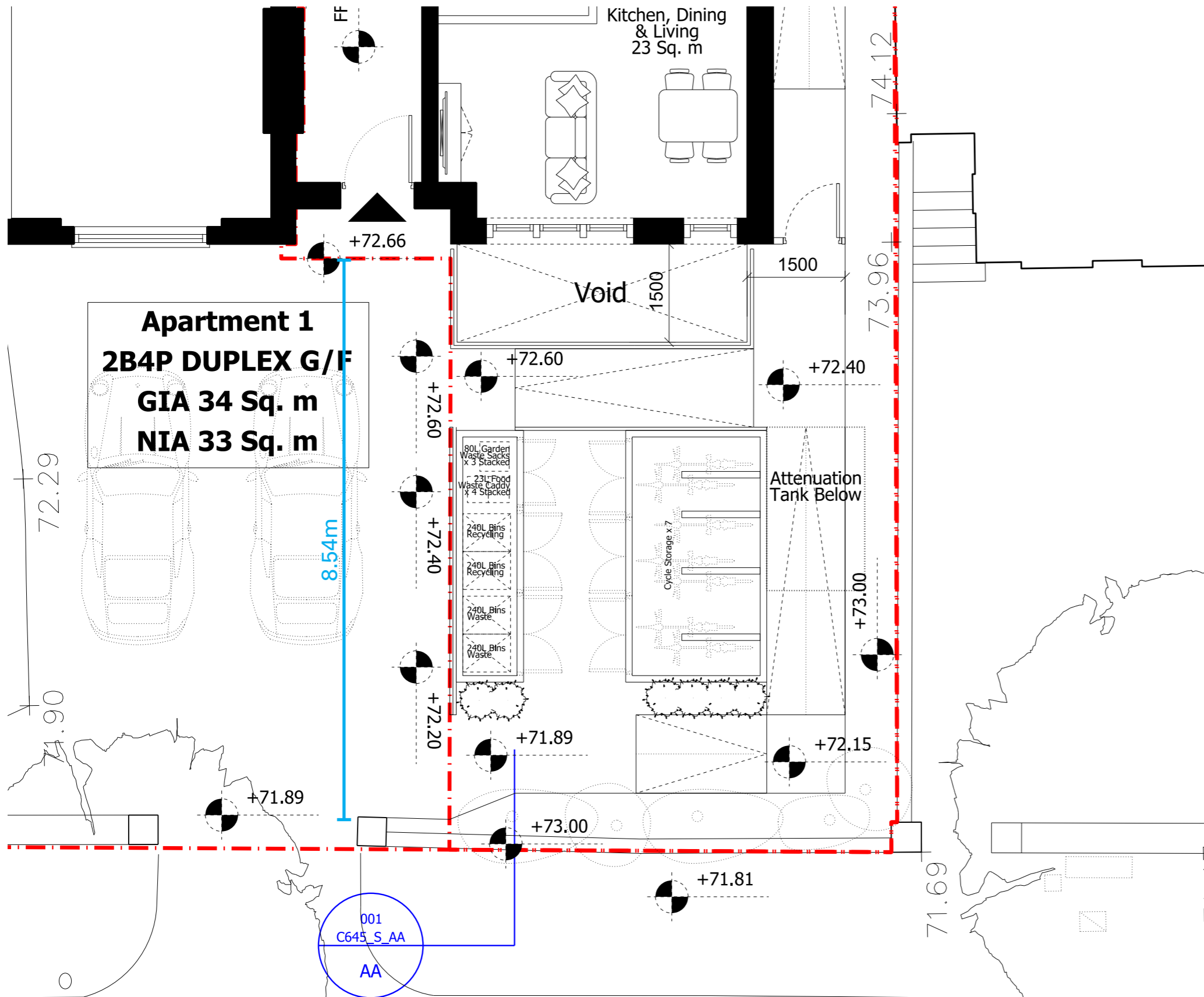

Revised - Ground Floor Plan