

General notes:
This drawing is copyright of KSR architects. This drawing must be read in conjunction with the Designer's Risk Assessment, specification and all other relevant documentation and drawings. KSR architects accept no liability for any expense, loss or damage of whatsoever nature and however arising from any variation made to this drawing or in the execution of the work to which it relates which has not been referred to them and their approval obtained.
Do not scale from this drawing or the digital data, only figured dimensions are to be used. For Planning refer to linear scale.
Check all dimensions on site prior to carrying out any work to avoid any discrepancy

XCO₂

15/05/2020

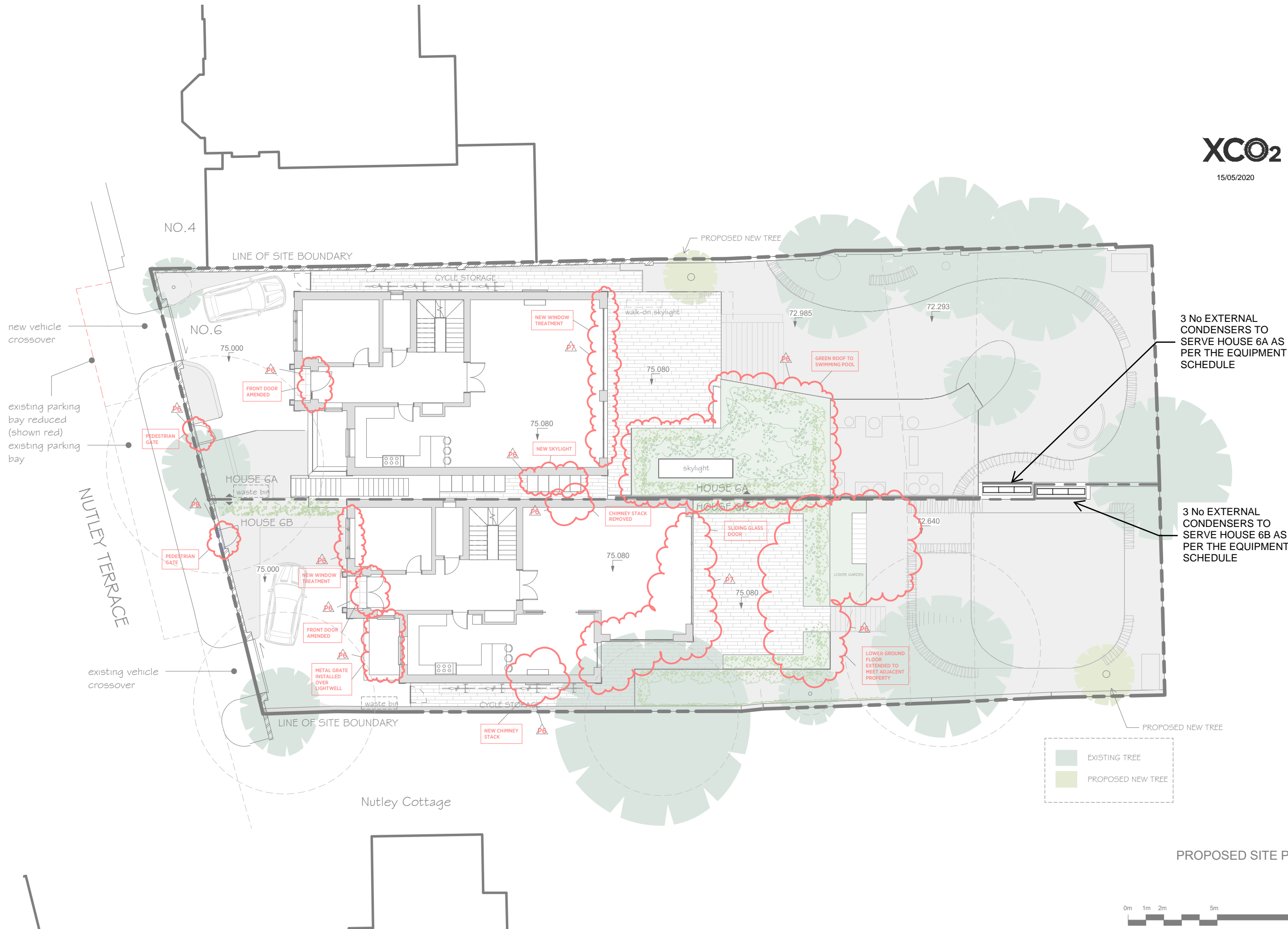

3 No EXTERNAL
CONDENSERS TO
SERVE HOUSE 6A AS
PER THE EQUIPMENT
SCHEDULE

3 No EXTERNAL
CONDENSERS TO
SERVE HOUSE 6B AS
PER THE EQUIPMENT
SCHEDULE

P8	Minor Material Amendment Application	11/07/18	DC
P7	Minor Material Amendment Application	20/06/18	DC
P6	Minor Material Amendment Application	09/02/18	DC
P5	Detail Note added for Code for Sustainable Homes compliance	18/10/12	RS
P4	Condenser reference omitted	02/10/12	RS
P3	Revised to comply with Lifetime Homes Standard	06/09/12	RS
P2	Entrance canopy design change (House A)	20/07/12	RS
P1	Planning Application Submission	08/05/12	RS

Rev	Description	Date	Child
-----	-------------	------	-------

© KSR Architects

Stamp

PLANNING



KSRARCHITECTS
KSR Architects LLP
14 Gower Street
London WC1E 6BT
t: +44 (0)20 7885 5500
e: info@ksrarchitects.com
www.ksrarchitects.com

Project:
6 NUTLEY TERRACE

Title:
PROPOSED SITE PLAN

Date:	FEB 2018	Drawn By:	RL	Checked:	DC
Scale:		Status:			

Project Ref:	000	Drawing No:	P8
--------------	-----	-------------	----