

01 General Arrangement - Proposed Plan  
1:200 @ A1

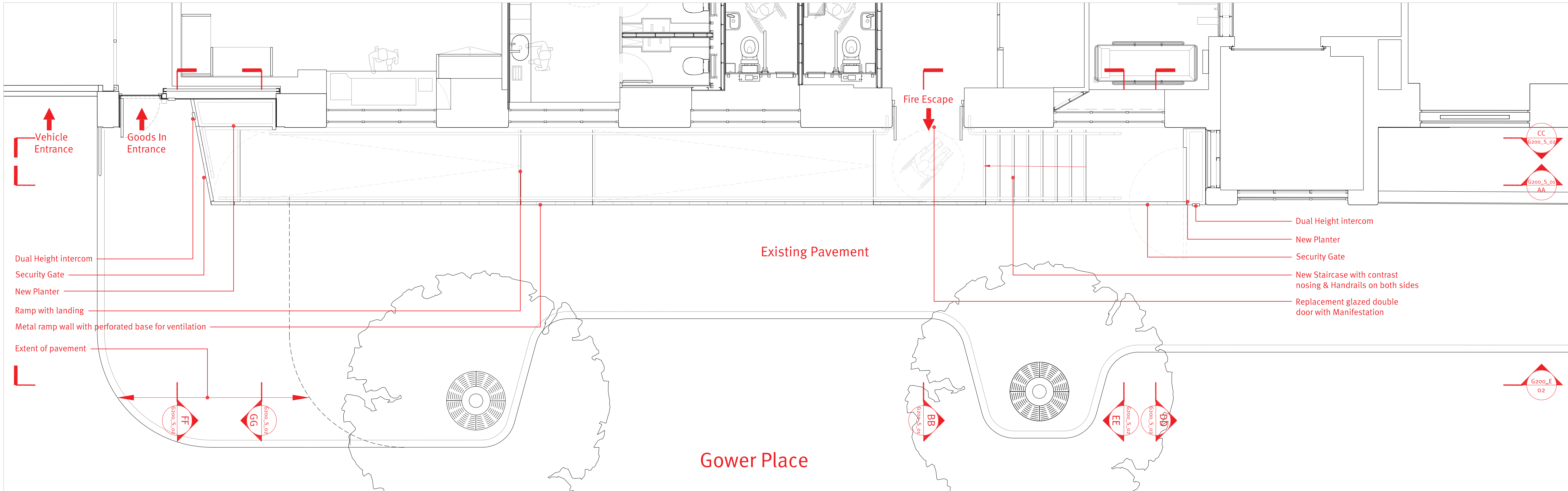

02 Proposed Detail Plan  
1:50 @ A1

Proposed

KEY

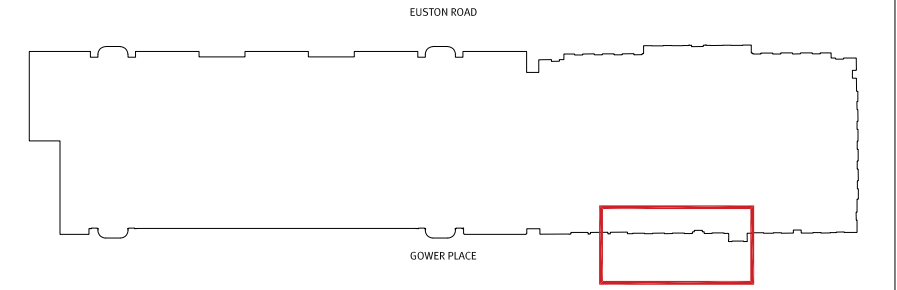

DISCLAIMER:  
This drawings is based on CAD drawings from a third party, as such 3|10 Studio cannot guarantee its accuracy.  
Do not scale dimensions off drawings. Use written or calculated dimensions. The contractor is responsible for checking dimensions before ordering or starting work.  
This document contains confidential and proprietary information that cannot be reproduced or divulged, in whole or in part, without written authorisation from 3|10 studio ltd.  
DRAWINGS NOT FOR CONSTRUCTION PURPOSED

KEY

Boundary - Extent of site proposed works

REV	DATE	COMMENT
P	17.07.2020	Planning Application Issue

STATUS: Planning Application Submission

DATE:	DRAWING TITLE:	SCALE:
06.07.2020	General Arrangement Proposed plan	Varies

PROJECT NAME:	DRAWING NUMBER	REVISION
Wellcome Collection 183 Euston Road Gower Place Accessible Ramp	Lo67_A_G200_P	P

CLIENT:	
The Wellcome Trust 215 Euston Road London NW1 2BE	

3 10 studio architecture	
Brightbow Workspace 62 Bedminster Parade Bristol BS3 4HL	Chartered Practice
TEL 0117 223 0078 info@310studio.co.uk www.310studio.co.uk	