

HAG G1-HD Roller shutters

BOUYGUES
UK

The roller shutters are inset 9.5 metres within the depth of the building and will be barely visible from the Gough Street. The grilles were selected for:

- The “large free air” allowance required for the life safety smoke evacuation systems in the basement below
- The minimalist look the grilles have and the vertical emphasis the pattern gives to match the general aesthetic of the metalwork to the rest of the development.

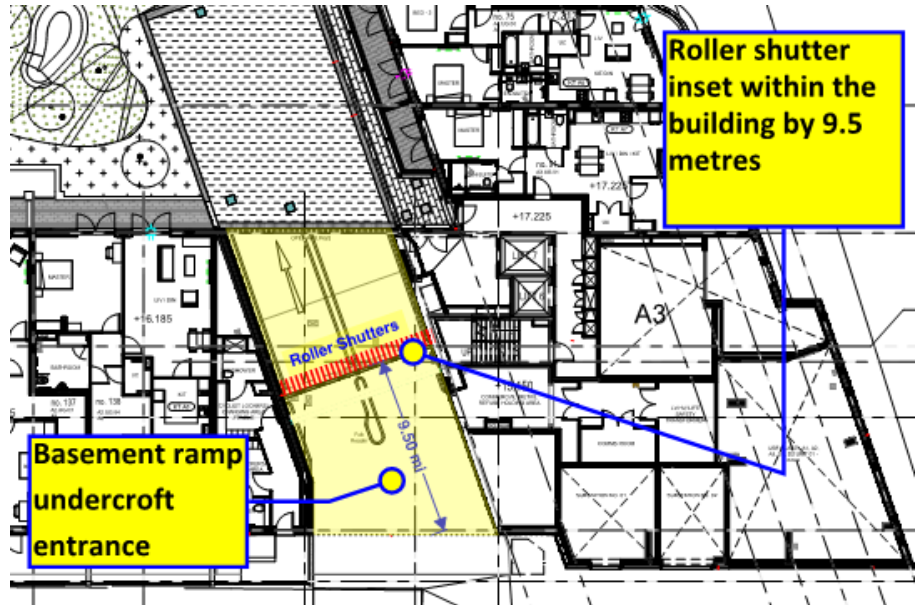

Part Plan of Ramp entrance

The photo below illustrates a recently installed set of roller shutter grilles on a completed high end development in Kensington. The proposed Mount Pleasant Phase 1 (MP1) grilles are from the same manufacturer – HAG and are the same shutters (G1-HD from the HAG Alulink range). The grilles in photo have the basic milled aluminium finish, however the MP1 grilles will have a metallic bronze polyester powder coat finish. (Akzo Nobel, Interpon D2525, Anodic III, Y2217F, Steel Bronze 2) To match the anodised aluminium finish of windows and PPC finish of aluminium copings within the MP1 development.

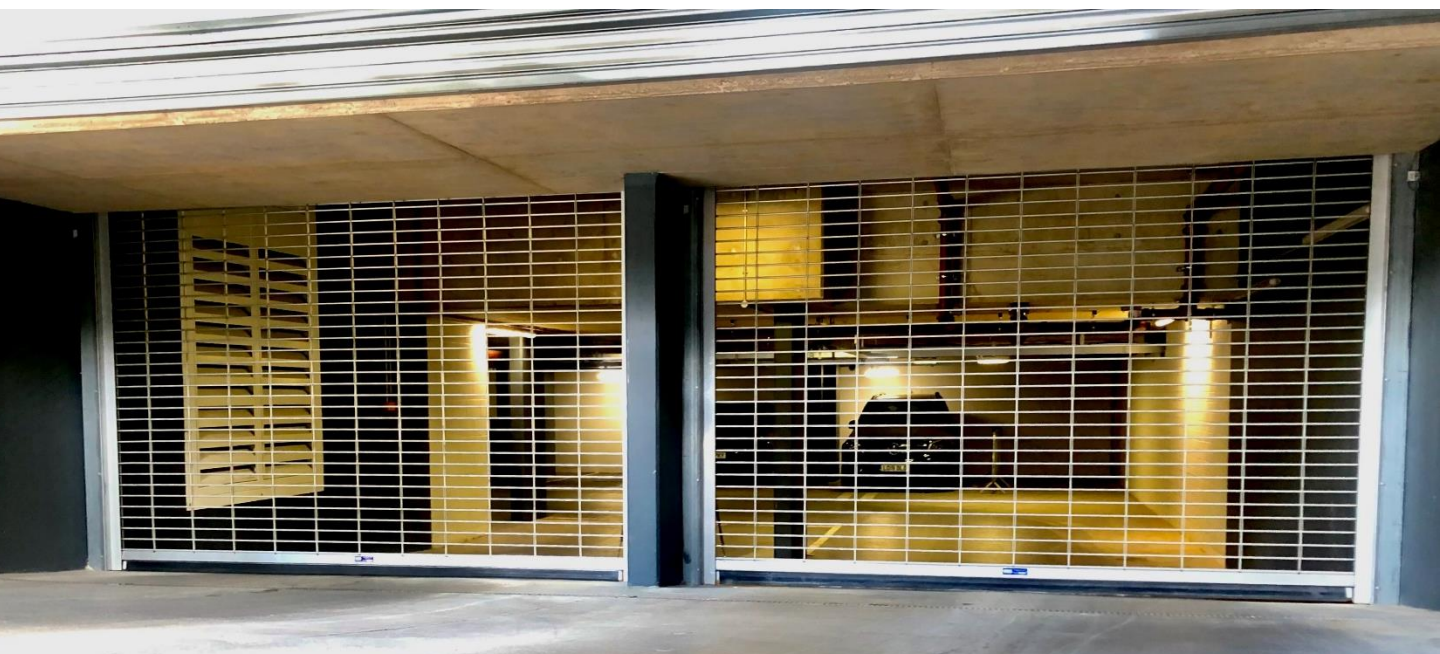

Recently installed roller shutters to an apartment block underground car park in Kensington