

t: 07914 660223
e: hello@tanyajonesstudio.com

Flat 2, 52 HILLFIELD ROAD
NEW EXTENSION
EXISTING & PROPOSED
RIGHT ELEVATION

PROPOSED & EXISTING REAR RIGHT
ELEVATION

Date: 26/06/20 **Drawn:** TJ

Scale: 1:50 @ A3

Drg title: TJS- HILLFIELD_EXISTING &
PROPOSED_REAR RIGHT ELEVATION

Drg Ref:

Date	Description	Initials

1.1 This clause applies to any drawings produced as part of the Services (Drawings).
1.2 You must not scale from any Drawings and we shall not be liable for the accuracy of their dimensions.
1.3 Where you or any other person not employed or engaged by us are carrying out any installation work from the Drawings, you or they must, prior to installation:
(a) verify all dimensions on site;
(b) ensure that the relevant site has sufficient access to allow all components to be delivered;
(c) verify any increased loadings with a qualified structural engineer for suitability and context;
(d) verify the compatibility of the site's services and utilities with the products to be installed; and
(e) verify all tile quantities.
1.4 Unless indicated otherwise, all details shown on Drawings are for approval purposes only.
1.5 All Drawings are produced for your own use and we shall have no liability to any third party in respect of them.

The drawing shows a cross-section of a building extension and roof details. Key elements include:

- Bay Window:** A window with a decorative frame, labeled "Bay Window".
- New Flat Roof Detail:** A detailed cross-section of the roof showing:
 - 1.) 12.5 Plasterboard
 - 2.) 8" Ceiling Joists at 200mm centres with insulation inbetween
 - 3.) 18mm Ply
 - 4.) 3 Layer Felt approx. 10mm
 - 5.) Roof Breather Vent
- NEW MASTER BEDROOM:** A room with a bay window, labeled "NEW MASTER BEDROOM".
- NEW KITCHEN (old master bedroom):** A room labeled "NEW KITCHEN (old master bedroom)".
- NEW EXTENSION:** A new extension labeled "NEW EXTENSION" with a "DAMP COURSE TO NEW EXTENSION TO MATCH EXISTING" and "NEW FOUNDATIONS".
- EXISTING TERRACE:** An existing terrace labeled "EXISTING TERRACE".
- 2770:** A large number "2770" indicating a level or height.
- 228:** A number "228" indicating a level or height.
- Parapet Height:** A label "Parapet Height Above Flat Roof" with a dimension line.
- Existing Bay 4 x Tile Courses:** A label "Existing Bay 4 x Tile Courses to Remain to Lead Flashing" with a dimension line.
- Existing Lead Flashing:** A label "Existing Lead Flashing" with a dimension line.
- New Lead Flashing:** A label "New Lead Flashing To Dress Bottom of Bay to New Roof Felt" with a dimension line.
- New Joists Tie to Existing Insulation:** A label "New Joists Tie to Existing Insulation Between" with a dimension line.
- Existing Joints:** A label "Existing Joints 203mm approx" with a dimension line.
- New Steel Downstand & Supporting Nib:** A label "New Steel Downstand & Supporting Nib" with a dimension line.
- PROPOSED:** A large, bold, italicized word "PROPOSED" at the bottom right.

PROPOSED

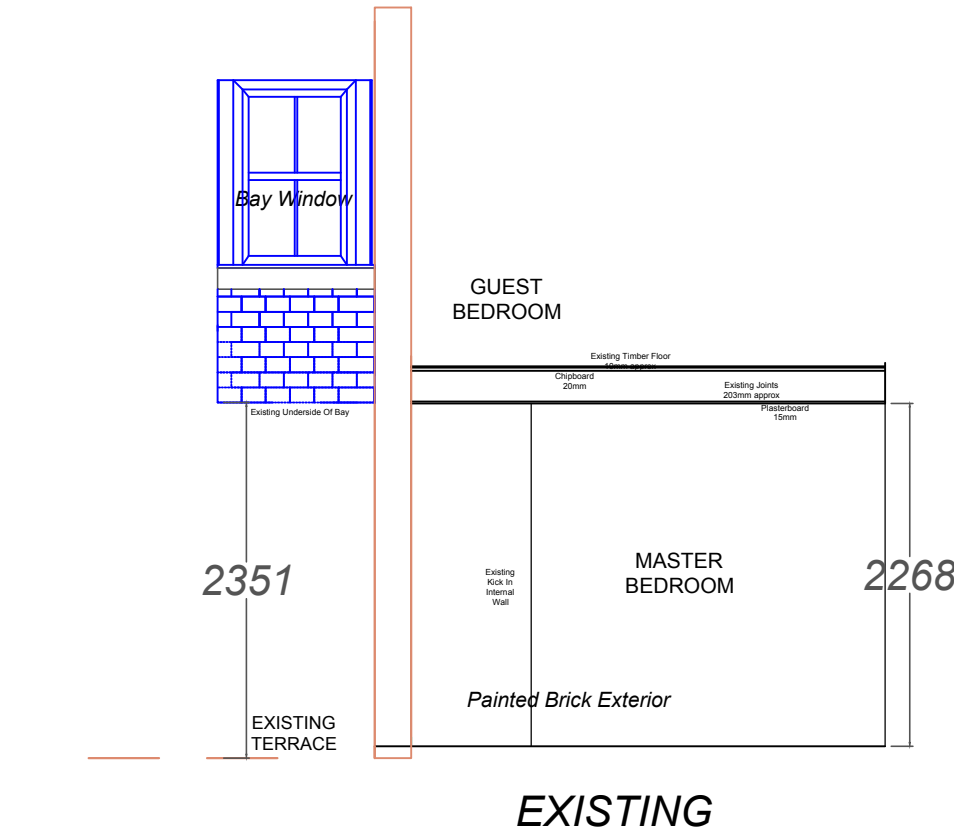

EXISTING

