

SECOND FLOOR PLAN
As Proposed

Legend:

- Denotes existing features retained.
- Denotes proposed new structure
- Denotes structure to be removed

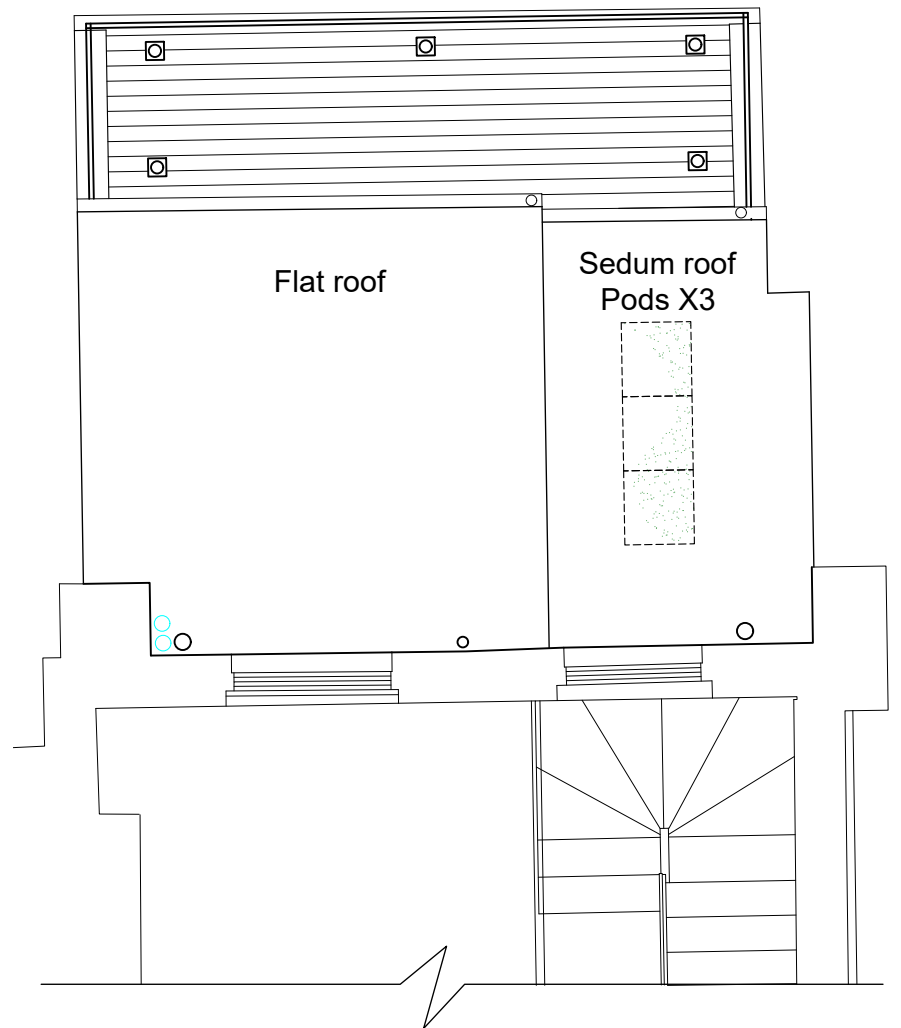
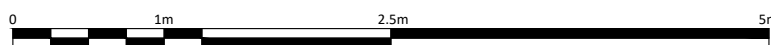

THIRD FLOOR/ROOF PLAN
As Proposed

THIS IS A CAD DRAWING
Under no circumstances shall manual alterations be made. Any discrepancy found between this drawing and any other document should be referred immediately to the architect. No dimensions are to be scaled from this drawing and all measurements should be checked on site. Copying or reproduction of this drawing without the written permission of Fresson and Tee is not permitted.
Copyright is Reserved

Disclaimer
The hard copy accompanying the electronic data is legal transmission of information. The electronic copies are issued only for convenience of use. No responsibility for the accuracy or for any consequence resulting from the use or alteration of information is accepted.

FRESSON AND TEE
6th Floor Queens House
55-56 Lincoln's Inn Fields
LONDON WC2A 3LJ
020 7391 7100 www.fandt.com

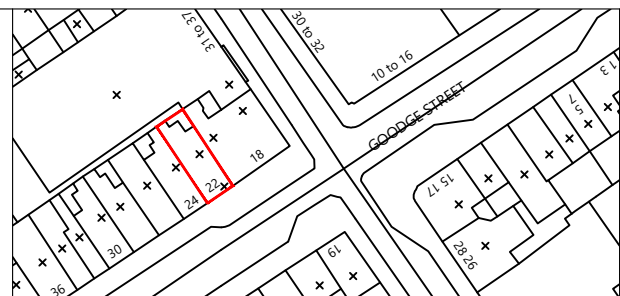

NOTES:
LOCATION PLAN @ 1:1250 and NORTH UP
ALL SCALES/DIMENSIONS TO BE CHECKED ON SITE.

REV	D.B.	Description	Date
B	DMV	Revised as per planner comments	18/06/2020
A	DMV	Revised as per planner comments	28/05/2020

DRAWING TITLE	Second Floor & Roof Plan As Proposed		JOB NO.	24749
PROJECT NAME	Second Floor Rear Extension & Internal Modifications		DRAWING NO.	01-P
ADDRESS	22 Goodge Street London W1T		SCALE	1:50 @A3
CLIENT	Shaftesbury CL Ltd		DATE	Jan. 2020
			DRAWN BY	KK
			CHECKED BY	KK